

Notes:
This drawing is for Refrigeration design only.
It should be read in conjunction with all standard details and specifications.
All dimensions to be checked on site and any discrepancy to be verified before commencement of work.
All works to comply with current building regulations/health and safety standards.

Internal Plant
Green&Cool Pack
Model: Crystal CO2vin Pack EM2700H 1239M
Dimensions: 2450mm(w) x 650mm(d) x 1950mm(h)
TP&N supply to the unit
36.24amp Nominal Current
55.3amp Max Current

External Plant
Green&Cool Gas Cooler
Model: GASCO.AL91 CO2 2MSD EC M2 SV
Weight: 500kg
Dimensions: 4170mm(L) x 1137mm(D) x 1530mm(H)
Sound pressure : 14dB(A) @10m

Managers office AC unit
Model: RXS3SL
Dimensions: 765mm(w) x 285mm(d) x 550mm(h)
Sound power level: 61dB(A)
(Unit only operational during store trading hours)
TP&N supply to the unit
4.10amp running current
10amp fuse rating

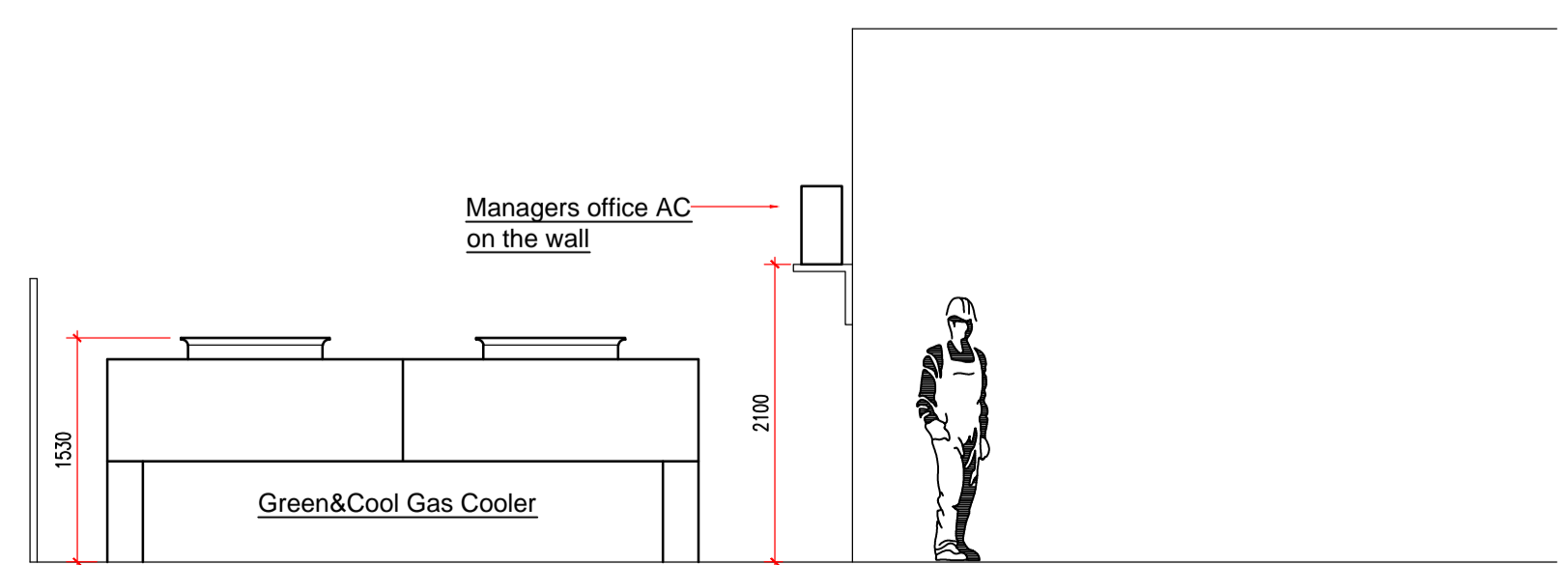
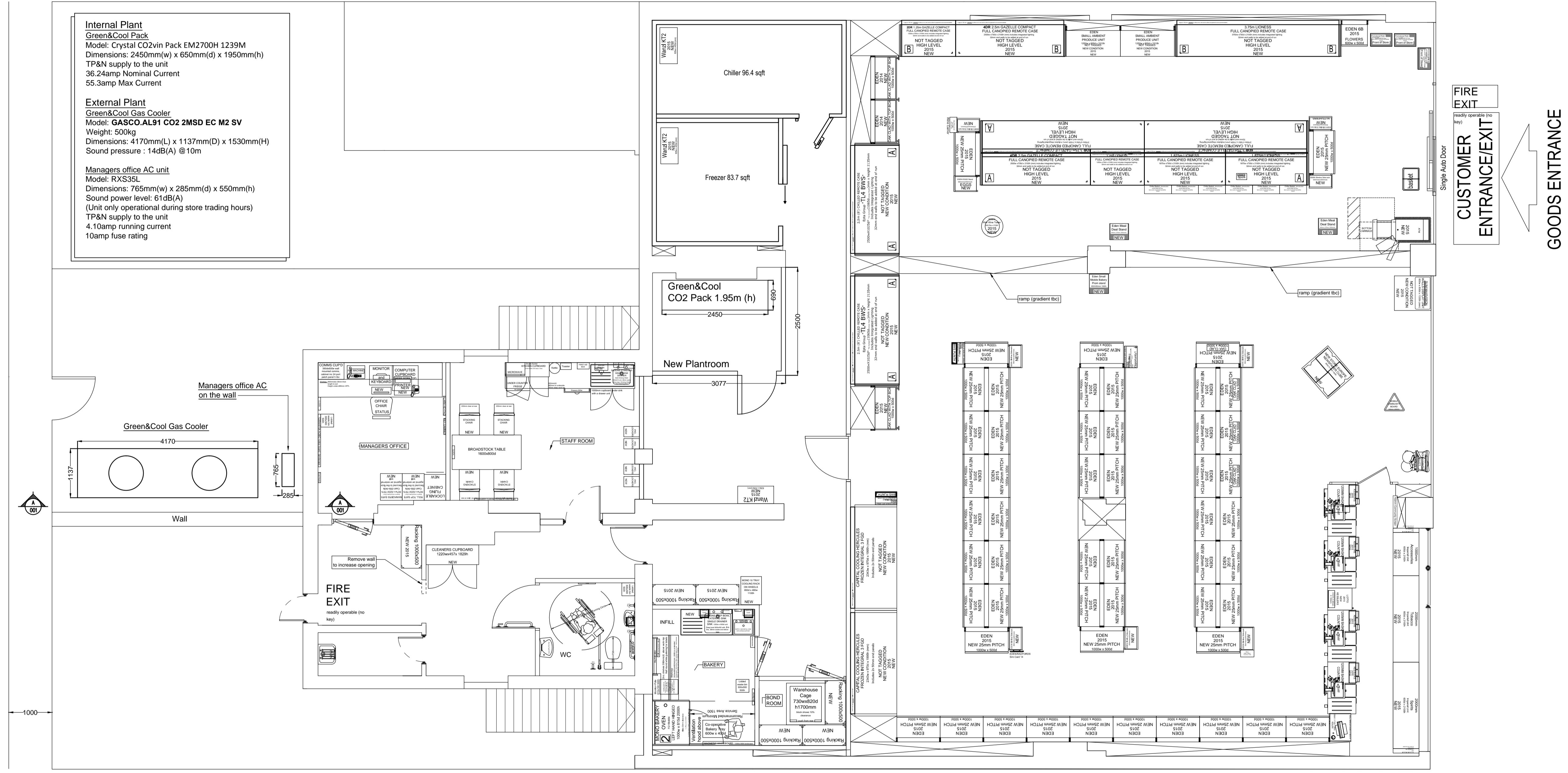

SECTION A-A
SCALE 1:50@A1

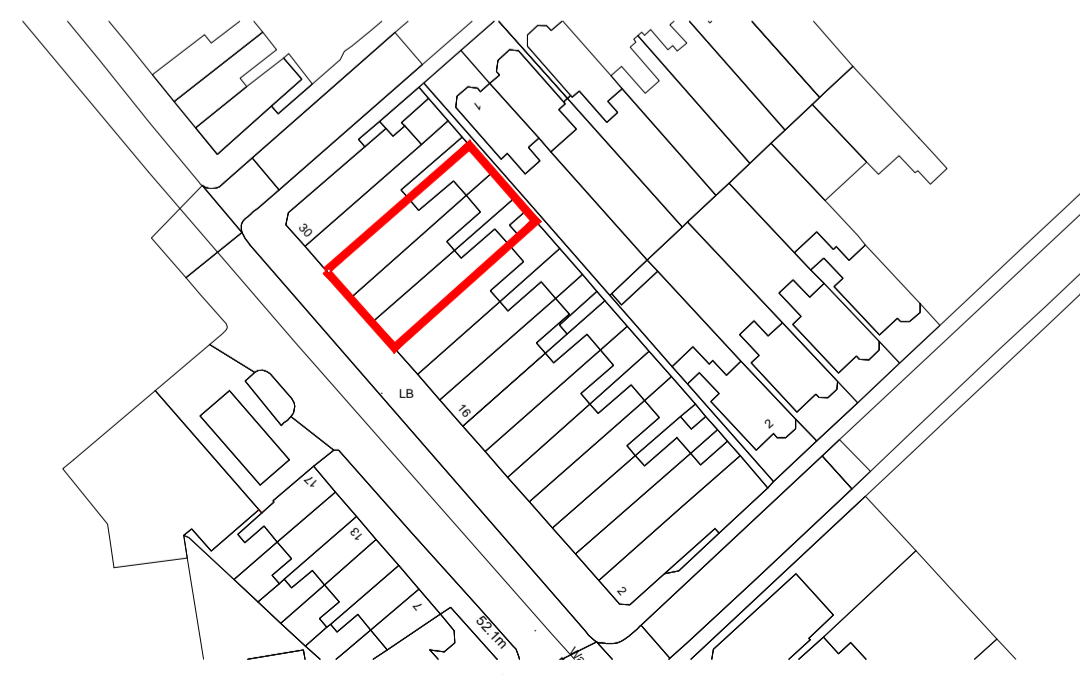

O/S MAP
SCALE 1:1250@A1

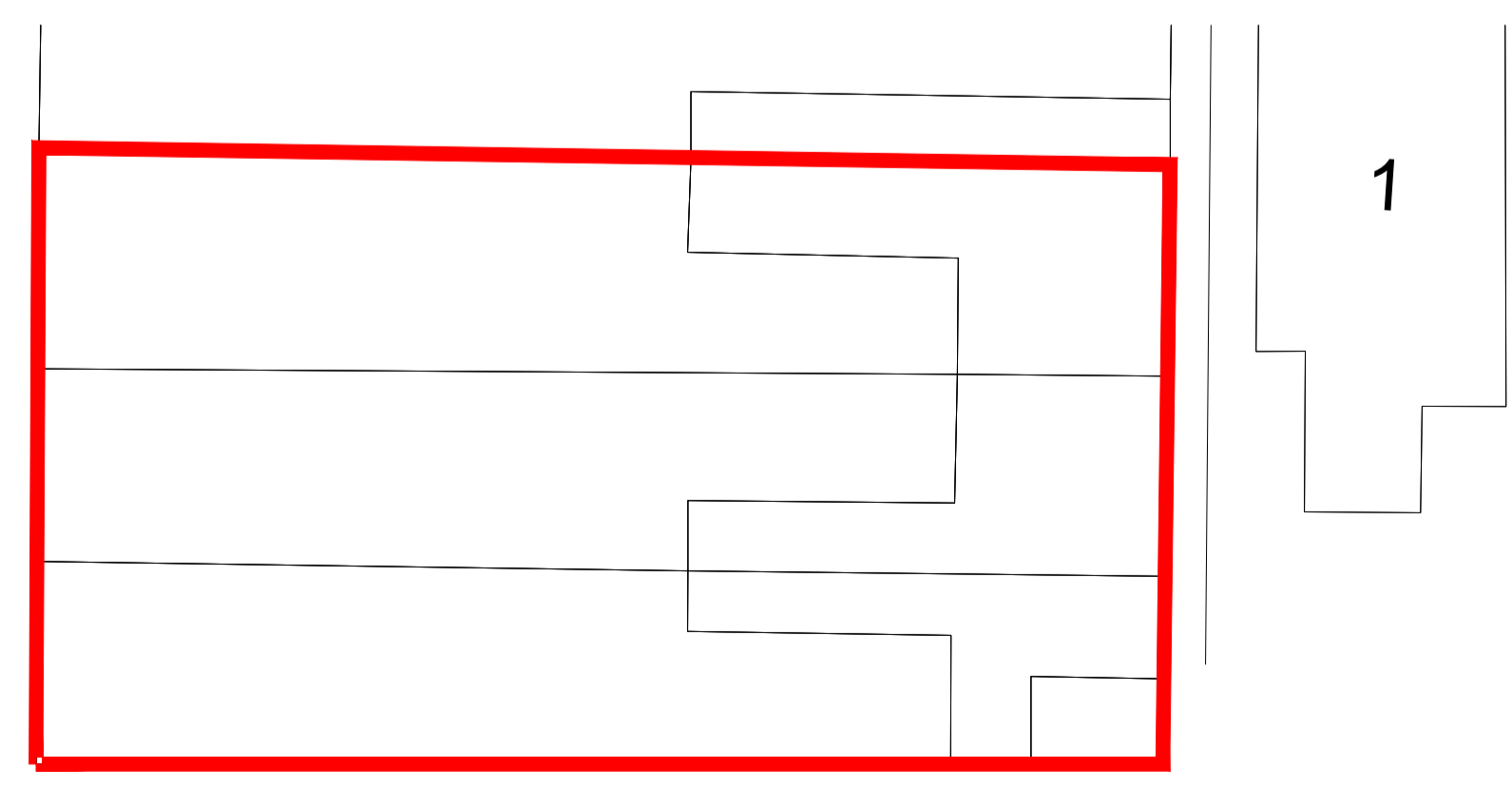

BLOCK PLAN
SCALE 1:200@A1

DRAWING STATUS
APPROVAL ISSUE

REV.	DESCRIPTION	DATE	BY
P1	PLANT APPLICATION	11/03/15	NM
REV.	DESCRIPTION	DATE	BY



CLIENT
The co-operative food

PROJECT
24-26 CRICKLEWOOD BROADWAY
LONDON SE12 OAE

DRAWING TITLE
GENERAL LAYOUT OF REFRIGERATION

SCALE 1:50@A1	DRAWN BY CK
DATE 15/07/15	CHECKED BY CND

DRAWING No.
CN-2015010074-01

REV.
P1