

# 11 POND STREET NW3 - AS FOUND AUG 2015

1:50 @ A2

THIS DRAWING IS TO BE READ IN CONJUNCTION WITH ALL OTHER PLANNING & LISTED BUILDING APPLICATION DRAWINGS & DOCUMENTATION, AND IS TO BE USED FOR PLANNING & LISTED BUILDING APPLICATION PURPOSES ONLY

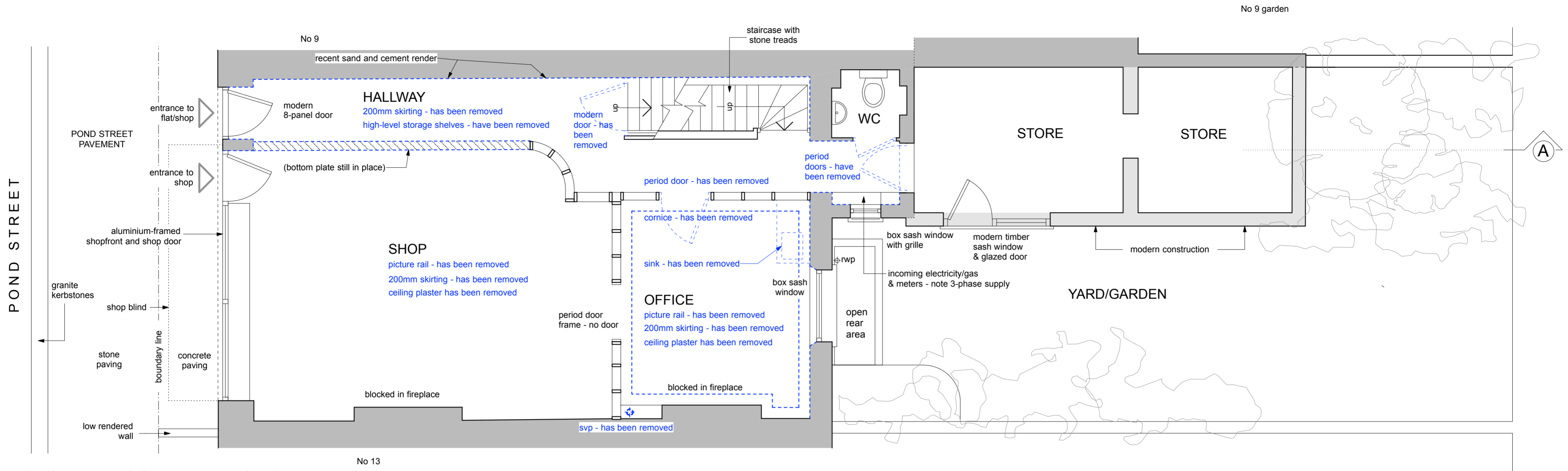

GROUND FLOOR PLAN - AS FOUND AUG 2015

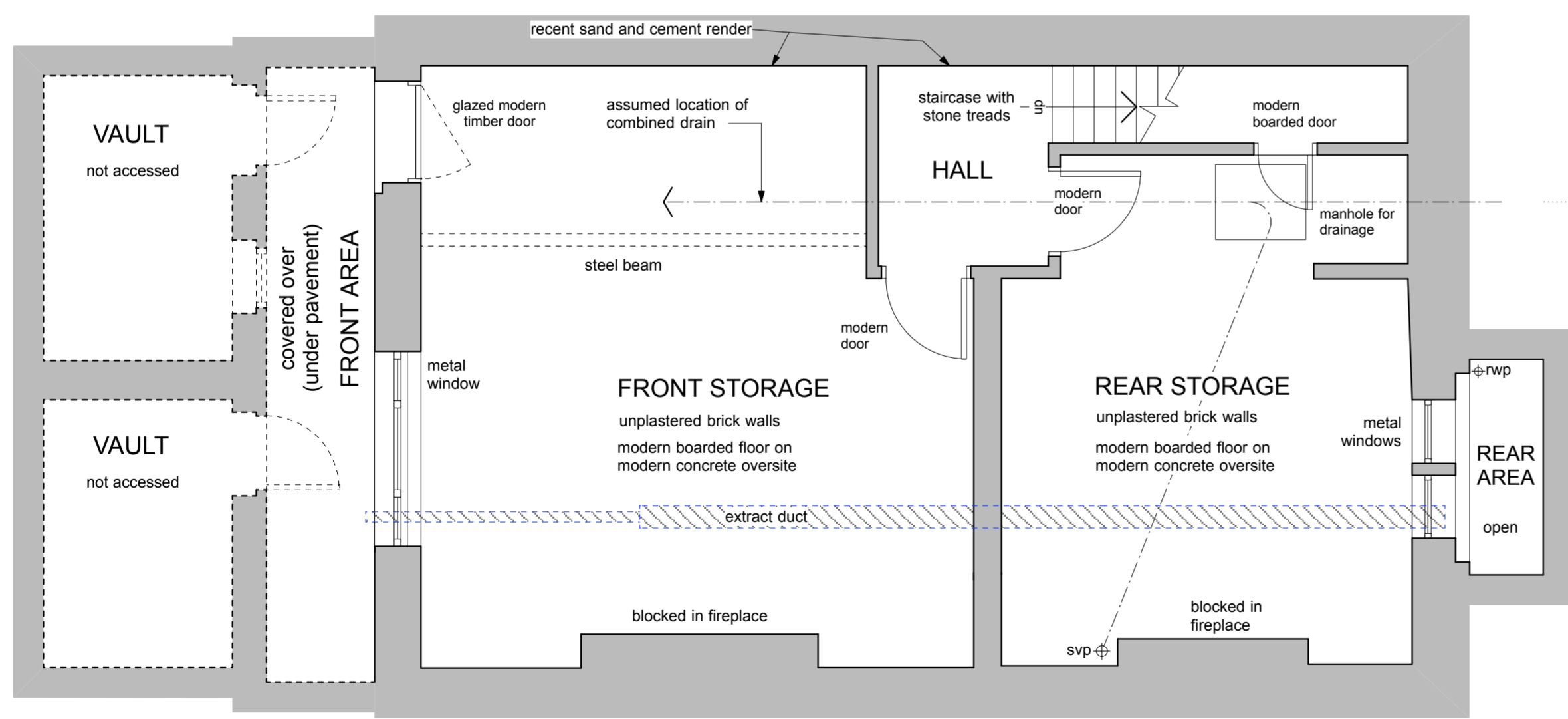

BASEMENT - AS FOUND AUG 2015



	Items of previously existing fabric that have been removed/demolished.
	Walls where the previously existing plaster has been removed
	Studwork walls which have been retained but lath and plaster has been removed (stud positions shown diagrammatically only)

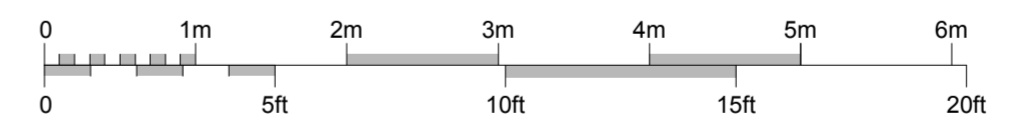

REVISION A - 27th November 2014  
Section A-A lines added

**Architects**  
BROD WIGHT

81 Haverstock Hill London NW3 4SL --- 020 7722 0810 --- office@brodwight.co.uk --- www.brodwight.co.uk

11 POND STREET - LONDON NW3  
GROUND FLOOR & BASEMENT PLANS - AS FOUND **1039-AP401**

Date August 2015 This drawing is copyright 1:50@A2 Scale