

09-01 EXISTING EXTERIOR ELEVATION A
Scale: 1:20 @A1, 1:40@A3

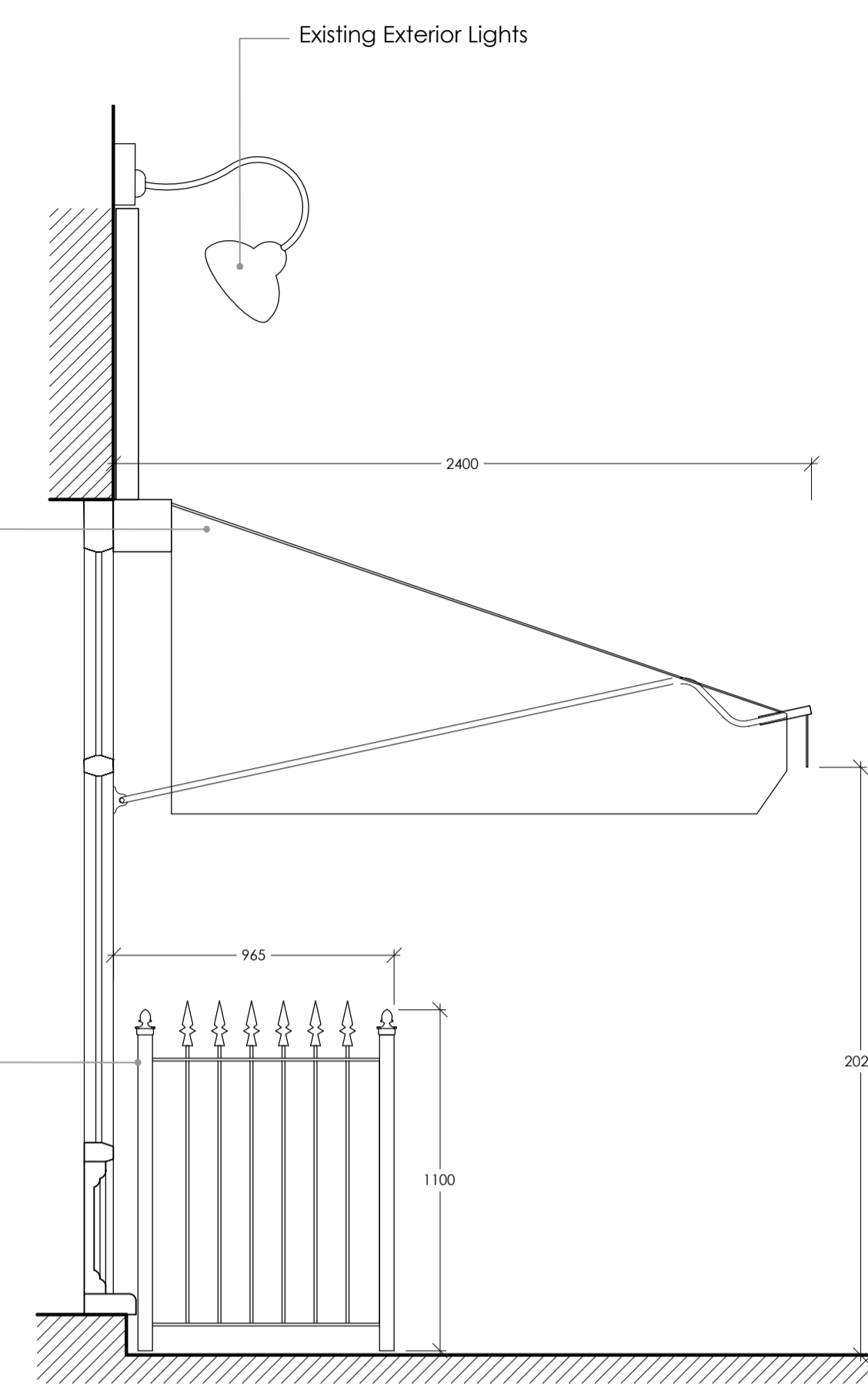

09-01 EXISTING EXTERIOR SECTION B
WITH CANOPY PULLED OUT Scale: 1:20 @A1

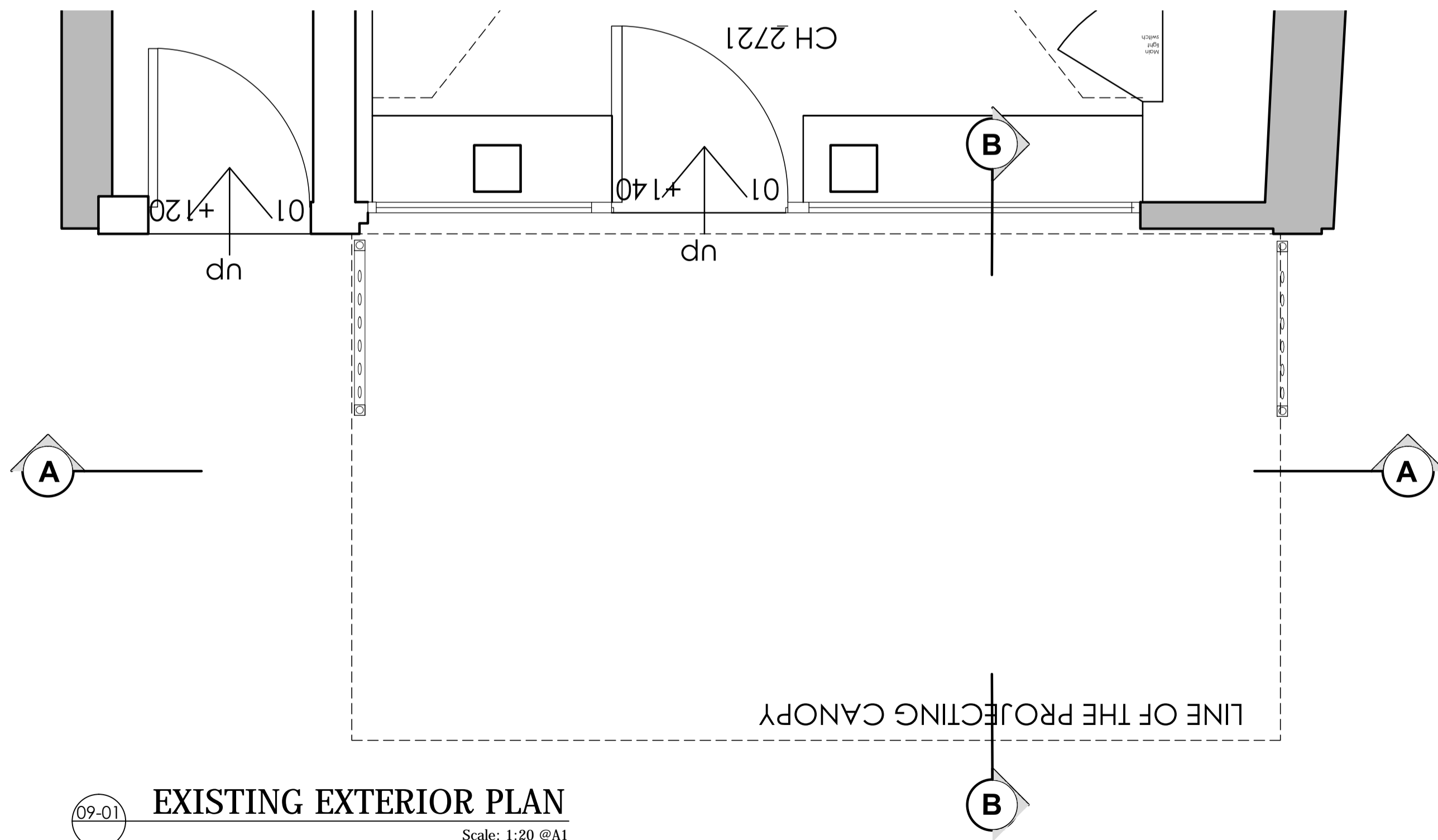

09-01 EXISTING EXTERIOR PLAN
Scale: 1:20 @A1

GENERAL NOTES

1. ALL FINISHES ARE TO CONFORM TO THE REQUIRED CURRENT BUILDING REGULATIONS IN THE APPLICABLE COUNTRY (IN A RESTAURANT ALL FINISHES ARE TO BE CLASS 1 OR EQUIVALENT).
2. CONTRACTOR MUST VERIFY ALL SITE DIMENSIONS, DRAWINGS, DETAILS AND SPECIFICATIONS AND REPORT ANY DISCREPANCIES TO BLENHEIM DESIGN BEFORE PROCEEDING WITH ANY WORK.
4. ALL REQUESTED DRAWINGS SHOWING FIXINGS AND CONSTRUCTION DETAILS ARE REQUIRED TO BE APPROVED BY BLENHEIM DESIGN PRIOR TO COMMENCEMENT OF WORK.
5. ALL SPECIFIED ITEMS ARE TO BE INSTALLED IN ACCORDANCE WITH THE MANUFACTURERS RECOMMENDATIONS.
6. CONTRACTOR TO PROVIDE A WORKING ENVIRONMENT WHICH CONFORMS TO THE CURRENT HEALTH AND SAFETY AT WORKS CONDITIONS AND LOCAL AUTHORITY REGULATIONS.
7. ALL FINISHES ARE TO BE CARRIED OUT TO A HIGH STANDARD.
8. ANY DIMENSIONS ARE TO BE TAKEN FROM THE SETTING OUT PLAN ONLY AND ARE NOT TO BE SCALED FROM THE DRAWINGS.
9. IT IS THE CONTRACTORS RESPONSIBILITY TO UNDER TAKE AND ENSURE THAT ANY BUILDING IS CARRIED OUT UNDER THE LOCAL AUTHORITY REQUIREMENTS.
10. THE CONTRACTOR IS TO CHECK AND APPRAISE ALL DESIGN SHOP FITTING AND CONSTRUCTION DETAILS AND OFFER ALTERNATIVES TO THE DESIGNER FOR APPROVAL.
11. IN THE EVENT THAT DRAWING INFORMATION IS NOT THE SAME, AND IF THE DESIGNER AND OR SUPERVISING OFFICER ARE UNAVAILABLE FOR COMMENT, THE PROPOSED PLAN IS TO BE READ AS CORRECT.
12. THIS DRAWING IS TO BE READ IN CONJUNCTION WITH THE OTHER RELEVANT CONSULTANTS DRAWINGS.
13. COPYRIGHT OF BLENHEIM DESIGN, NOT TO BE REPRODUCED

REVISION	DATE	ITEM
A	26/10/2015	first floor windows added

- INFORMATION ONLY
- APPLICATION FOR LOCAL AUTHORITY
- TENDER
- CONSTRUCTION

PROJECT SHORYU
35 GREAT QUEEN STREET, WC2

TITLE EXISTING EXTERIOR

DRAWN	DATE	SCALE	CHECKED
MS	JULY 2015	shown	
PROJECT	NUMBER	REVISION	
BD 1578	09-01	A	

BLENHEIM DESIGN ...
Restaurant Interior Designers

t: 01273 380001
info@blenheimdesign.com
www.blenheimdesign.com