

Proposed Lower Ground Floor Plan

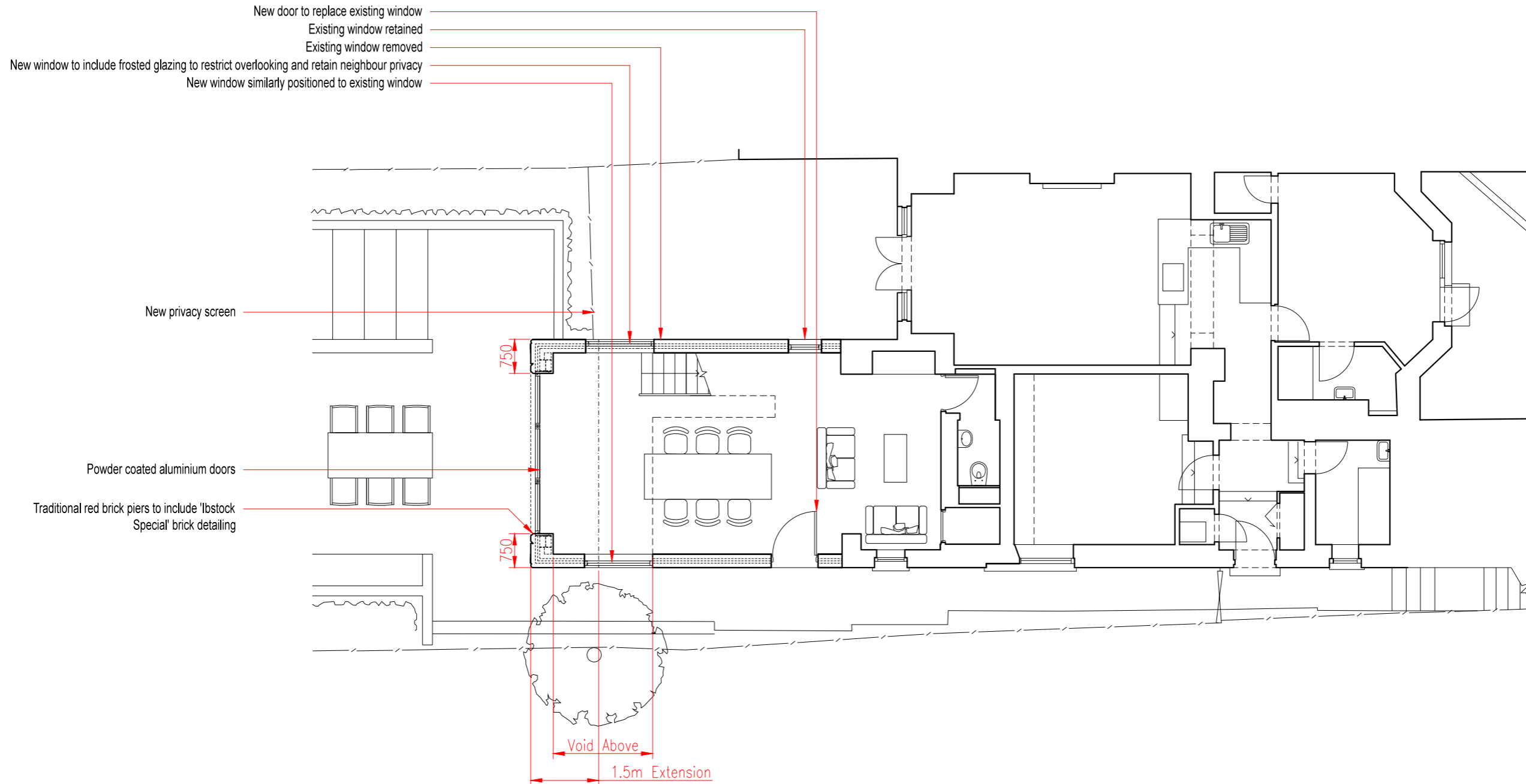

Working Notes
1. Do not scale from these drawings for construction purposes.
2. These are not construction drawings and are for illustrative purposes only.
3. The contractor is responsible for checking all dimensions on site prior to commencement of works with any errors being reported to the AO immediately.
4. The contractor, not AO, is responsible for the proper performance of the construction work and shall be liable for ensuring that all work is completed to the satisfaction of the named building control officer and in accordance with current building regulation standards.
5. Any construction work carried out prior to receiving all necessary approvals and consents including planning and building regulation approval is entirely at the clients risk.

Copyright Notes
This document is confidential. The document copyright and any design right therein are the property of Alexander Owen Ltd, unless otherwise specified on this document. The document and any information therein may not be used, copied or disclosed to any third party without prior written authorisation of Alexander Owen Ltd.
1:100 1 2 3 4 5 6 7 8 9 10m
1:50 1 2 3 4 5m
SCALE

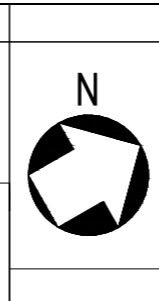

Project Title	Martin and Anne-Marie's Place
Client	Mr and Mrs Malley
Site Address	14 Hollycroft Avenue London NW3
Drawing Number	PR06
Revision	00
Date	15/10/19
Scale	1:100 @ A3
Status	Stage 2 Design

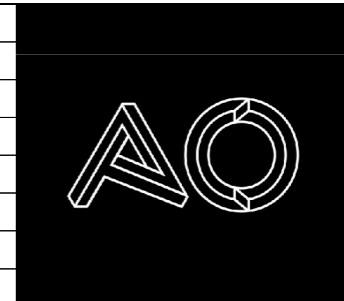

Martin and Anne-Marie's Place
14 Hollycroft Avenue London NW3
 c: Alexander Owen Ltd
 a: 6 Lordship Lane London SE22 8HN
 t: 020 8693 5075
 e: info@aoarchitecture.co.uk