

REVISION DETAILS		DATE	DRW	CHK
A	Planning Details Issued to IPS	23.03.15	KM	DMA
B	Discharge of Planning Condition 2	09.04.15	KM	DMA
C	Revised Details for Discharge of Planning Condition 2a+b	13.10.15	KM	DMA

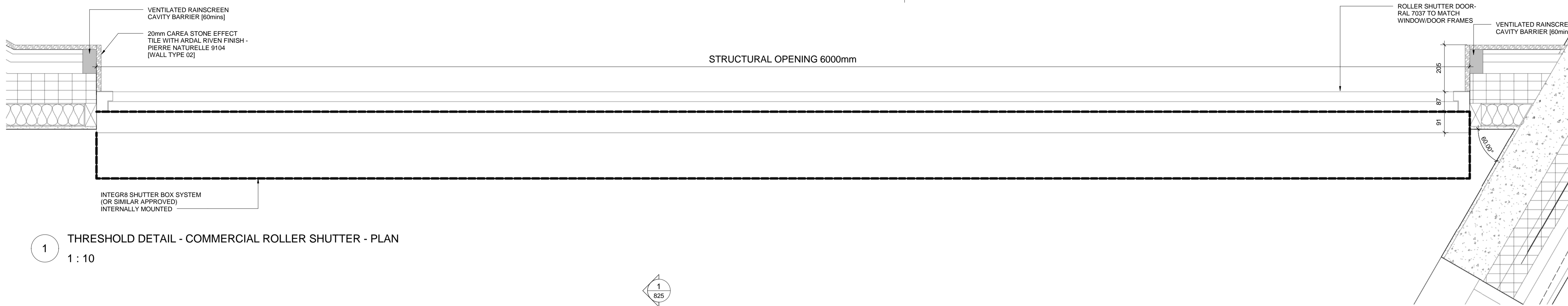

1 THRESHOLD DETAIL - COMMERCIAL ROLLER SHUTTER - PLAN
1 : 10

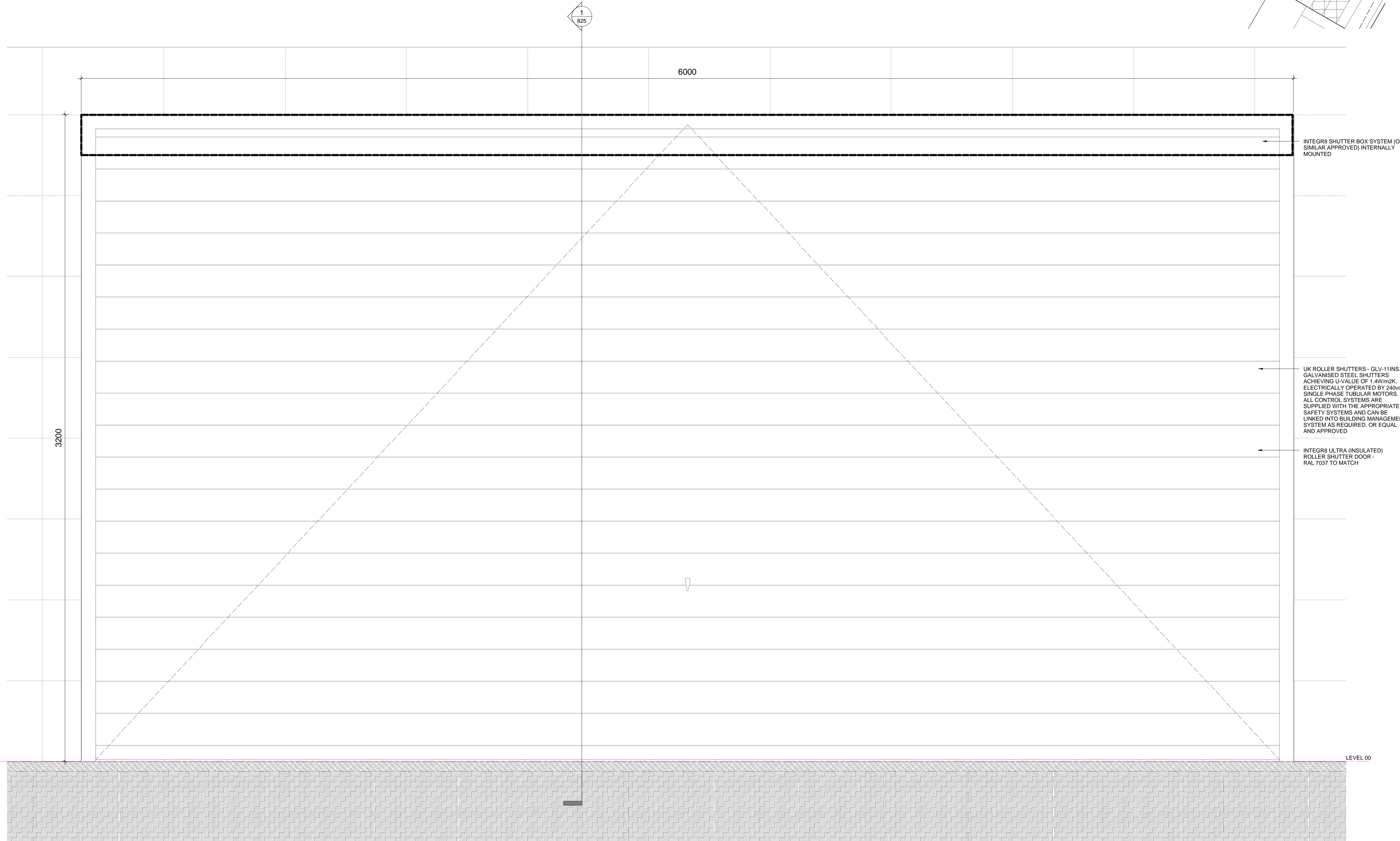

INTEGR8 SHUTTER BOX SYSTEM (OR SIMILAR APPROVED) INTERNALLY MOUNTED

UK ROLLER SHUTTERS - GLV-11INS. GALVANISED STEEL SHUTTERS ACHIEVING U-VALUE OF 1.4W/m2K. ELECTRICALLY OPERATED BY 240VOLT SINGLE PHASE TUBULAR MOTORS. ALL CONTROL SYSTEMS ARE SUPPLIED WITH THE APPROPRIATE SAFETY SYSTEMS AND CAN BE LINKED INTO BUILDING MANAGEMENT SYSTEM AS REQUIRED. OR EQUAL AND APPROVED

INTEGR8 ULTRA (INSULATED) ROLLER SHUTTER DOOR - RAL 7037 TO MATCH

NOTE: DRAWINGS TO BE READ IN CONJUNCTION WITH SHEET 825

KEY	RESIDUAL RISK

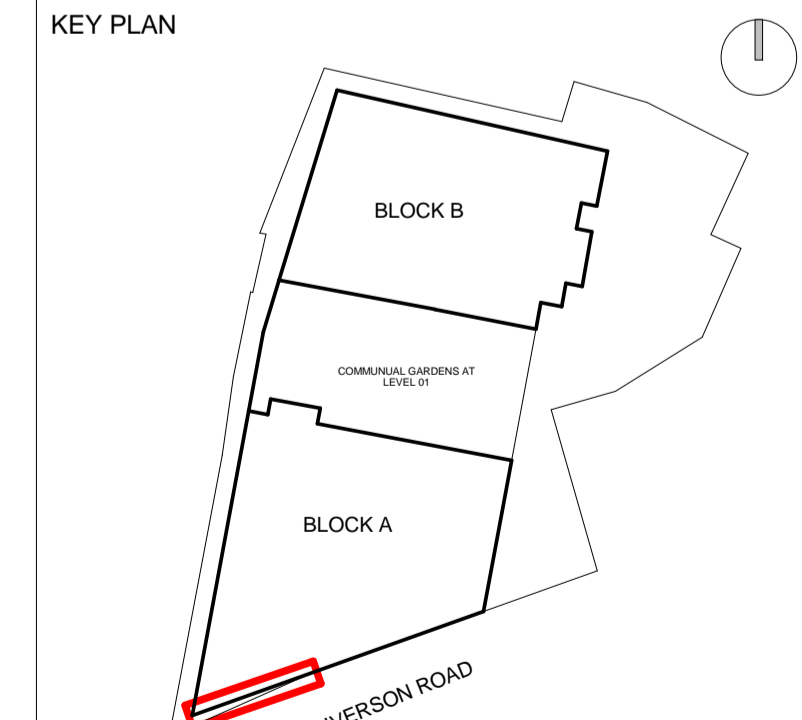

ORIGINATOR davidmillerarchitects WWW.DAVID-MILLER.CO.UK	DRAWING TITLE COMMERCIAL ROLLER SHUTTER DETAIL (1)
JOB TITLE 159-161 IVERSON ROAD, WEST HAMPSTEAD, LONDON, NW6 2RB	JOB NO 335 SCALE 1 : 10 @A1
PROJECT IVR	STATUS FOR INFORMATION DATE 03/03/15
ORIGIN DMA	CHECKED KM
ZONE ALL	APPROVED DMA
LEVEL SL	SEQ NO A3
TYPE DET	REV 824
ROLE A3	CHK C

3 THRESHOLD DETAIL - COMMERCIAL ROLLER SHUTTER - ELEVATION
1 : 10

