

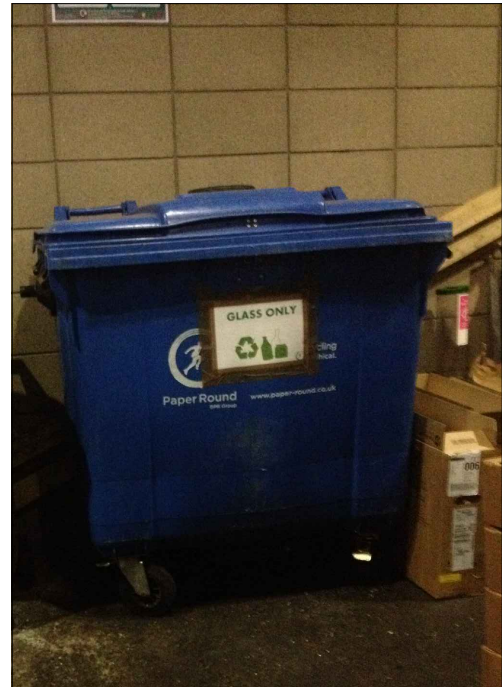

1. plastic, paper, mixed waste



2. food waste



3. glass

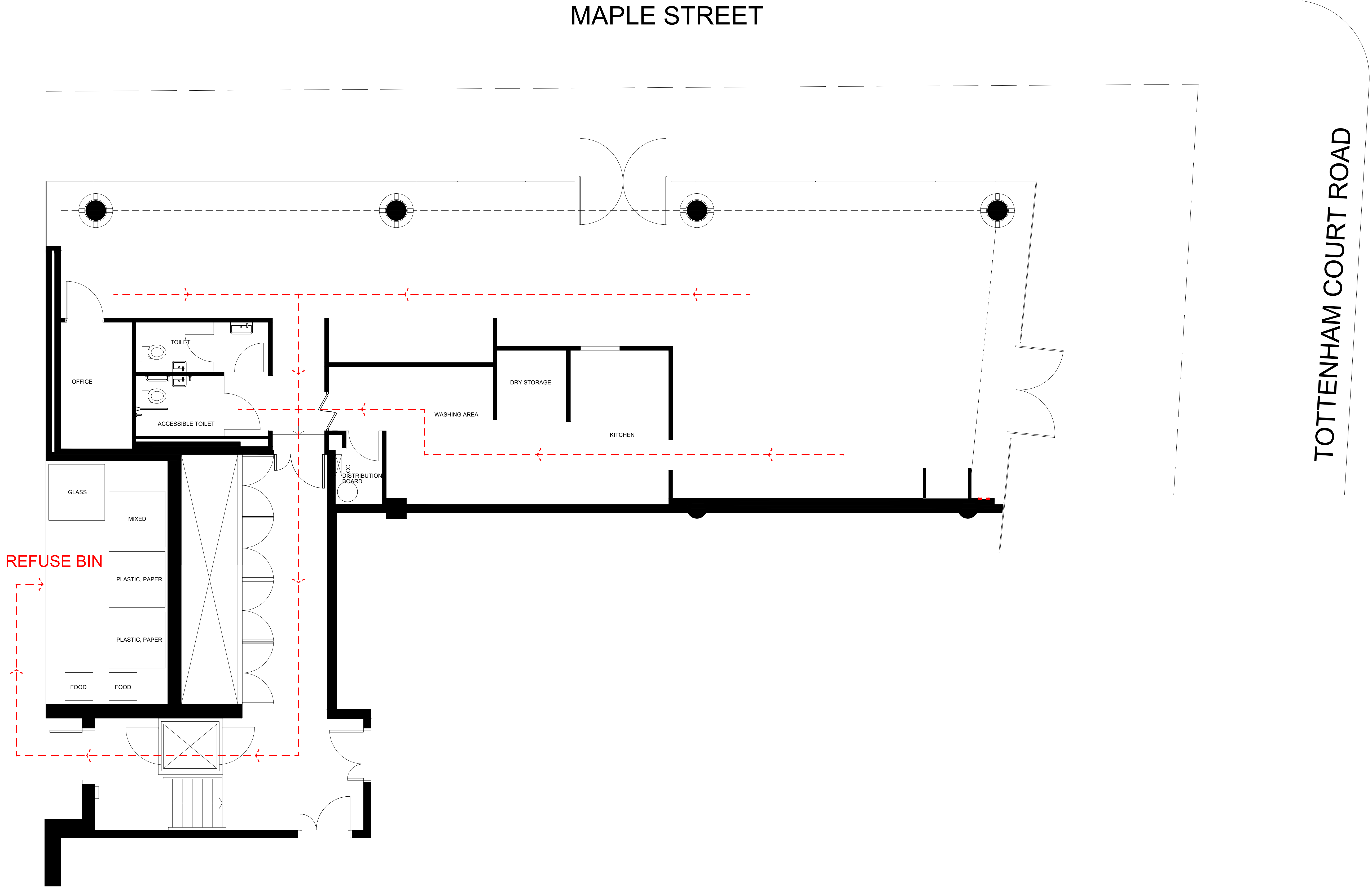

rev	date	by	revisions
-----	------	----	-----------

legend

--- refusal daily flow

notes

There is a bin store behind in rear of Cypress Place that all shops use and rubbish is collected daily by company Paper Round.

The area is always open and there are 3 different bins:
- "Waste food" we throw general rubbish like food refuse, etc.
- "Only glass" we throw bottles and broken glass, etc.
- "Waste General" we throw plastic and paper like napkins, paper cups, plastic bags, etc.
Empty paper boxes don't have a specific bin, we just leave them next to the "waste general" bin so the collection will be easier.

The disposal of rubbish, especially noisy disposal of bottles, outside the premises should not take place between 10.00pm and 8.00am and not before midday on Sundays & Bank/Public Holidays.

During the day from the restaurant to the bins we carry the rubbish in three different bags, We pass throw the back door that it is also an Emergency exit.
In the restaurant, especially Kitchen, we always keep 3 bins.

project by

Migeca Spa

project

Ca'puccino, London

drawing title

Refusal flow

client

Migeca Spa

scale at A1

1:50

scale at A3

1:100

drawn

MMP

date

09/15

drawing

rev.
