

Notes:

EXISTING FRONT ELEVATION

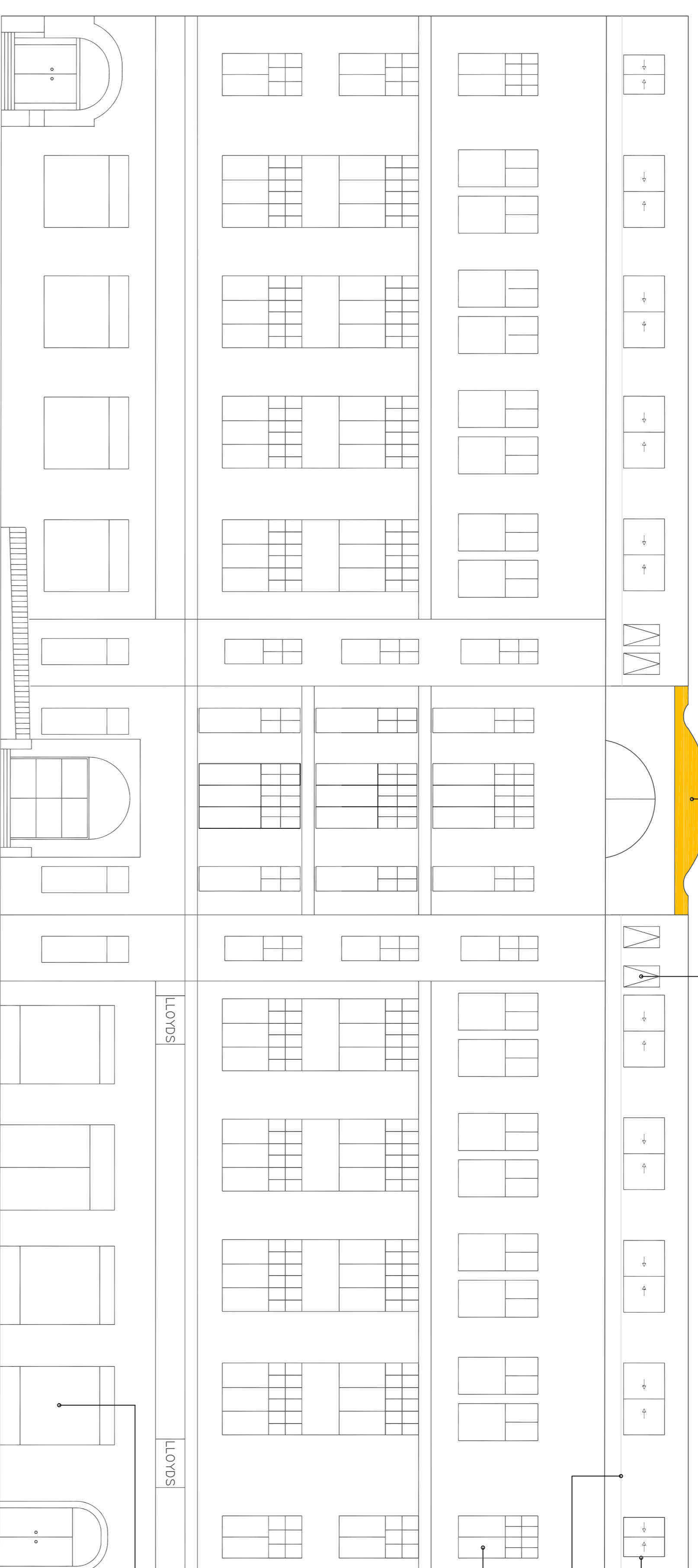

Existing rendered brickwork

4no. existing velux windows

10no. existing aluminium sliding windows to 4th floor mansard areas

Existing parapet wall to 4th floor

Timber sliding sash windows to 1st, 2nd and 3rd floors

Mixture of powder coated aluminium and timber shopfront windows at ground floor level

PROPOSED FRONT ELEVATION

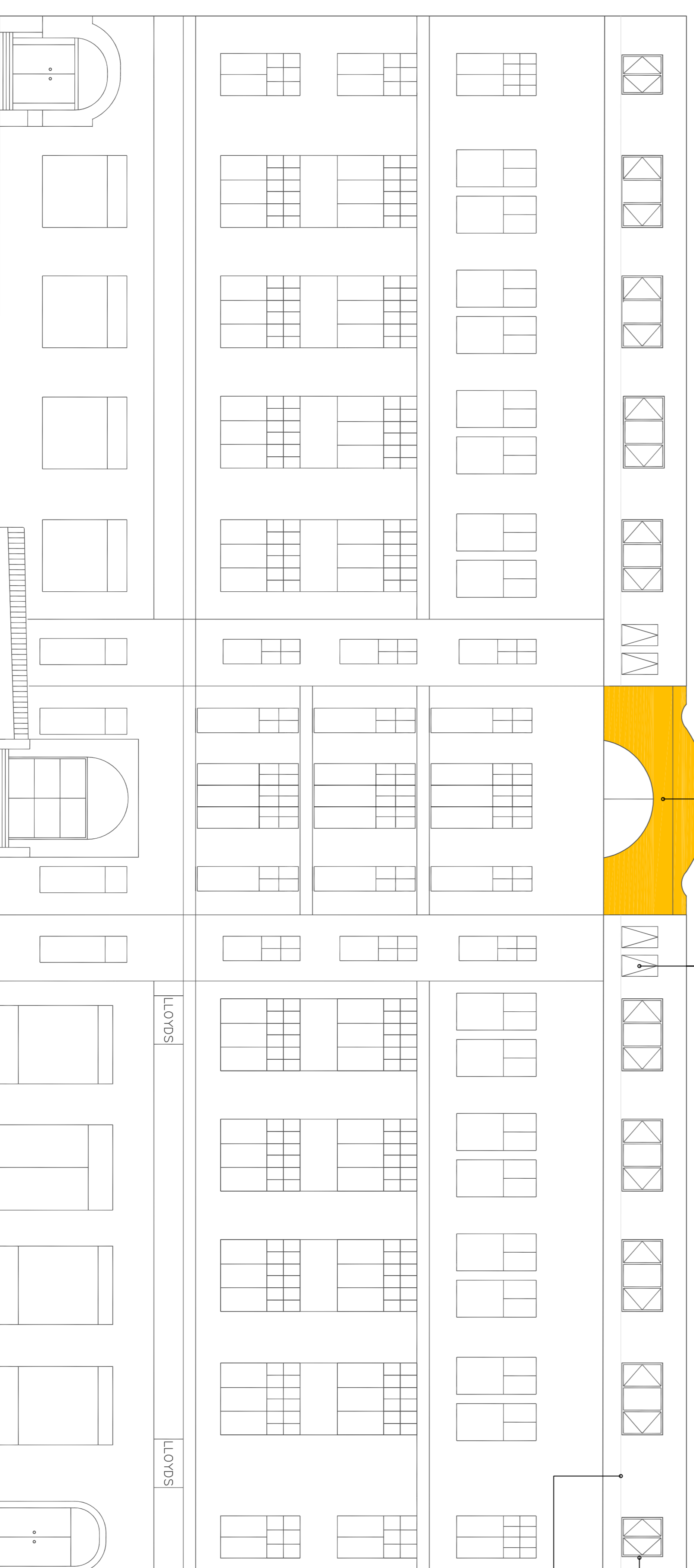

Proposed extension of rendered brickwork to match existing to protect frost-shattered brickwork to arched window surround

4no. velux windows to be renewed on a like for like basis due to want of repair

10no. sliding windows to be replaced with sliding aluminium finished white in accordance with drawings GRAY-EL-01 and GRAY-EL-02

Existing parapet wall to 4th floor

Rev. Description	Date
------------------	------



Paragon
7 Swallow Place, London, W1B 2AG
Tel: +44 (0)207 125 0112
Fax: +44 (0)207 125 0113
www.paragonbc.co.uk
info@paragonbc.co.uk

Client:
Regus
Project Address:
344-354 Grays Inn Road
London

Drawing Title:
Front elevation as existing and proposed - 4th floor window replacement

Project Number: 15.0224
Drawing Number: 003
Revision: -
Drawing Status: PLANNING

Scale: 1-100 @A1
Date: Oct 2015
Drawn By: MB
Checked By: DB

All dimensions are in millimetres unless otherwise stated.
Copyright of Paragon Building Consultancy Ltd. All rights reserved.
Drawing not to be reproduced without permission.