

Tree schedule

Tree No	Species	Category	RPA Radius	Tree Works
T1	Birch	B	6.6	-
T2	Purple plum	C	3	-
T3	Weeping birch	C	3	-
T4	Pear	U	4.8	Fell for management
T5	Pear	B	4.8	-
T6	Elder	C	2.4	-
H7	Leyland cypress	C	1.2	-
T8	Pear	B	6	-
T9	Pear	C	3	-
T10	Ash	B	7.2	-
T11	Fruit	U	3.6	-
T12	Oak	C	0.6	-
T13	Rhododendron	C	1.2	-
H14	Leyland cypress	C	1.8	-
T15	Rhododendron	C	1.2	Fell
T16	Laurel	C	3	Fell
T17	Crab apple	C	2.4	Fell
T18	Pear	C	3.6	Fell
T19	Pear	C	4.2	Fell
T20	Birch	C	6.6	Fell
T21	Pyracantha	C	3	-
T22	Yew	C	3	-
T23	Cherry	C	2.4	-
T24	Oak	B	8.4	-
T25	Elm sp	C	4.8	-
T26	Elm sp	C	3.6	-
T27	London plane	B	7.2	-

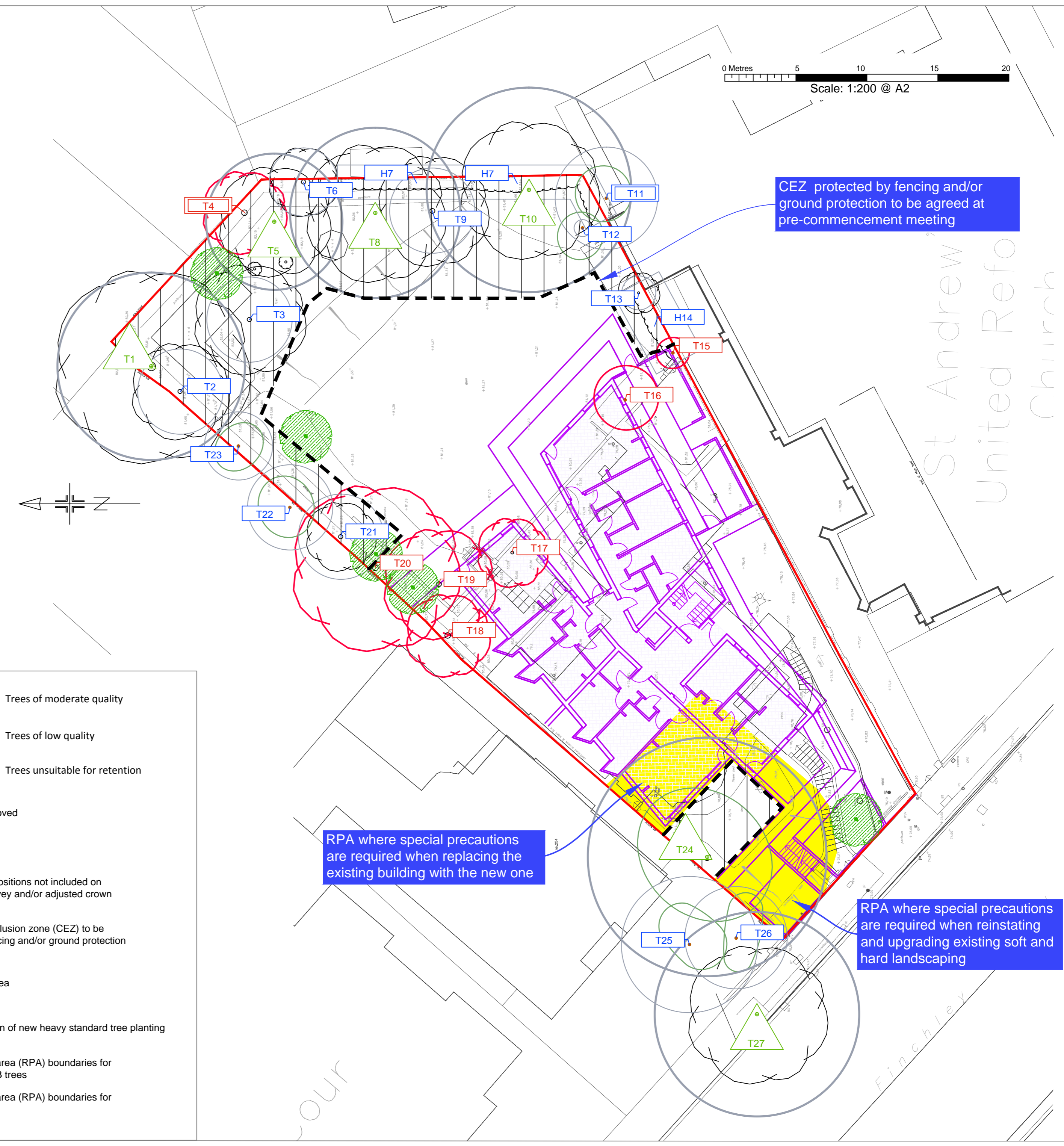
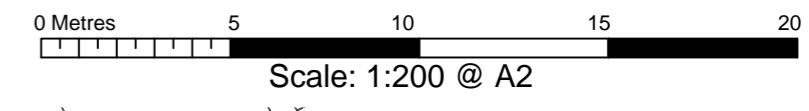

- BS category B Trees of moderate quality
- BS category C Trees of low quality
- BS category U Trees unsuitable for retention
- Trees to be removed
- Proposed layout
- Estimated tree positions not included on original land survey and/or adjusted crown spreads
- Construction exclusion zone (CEZ) to be protected by fencing and/or ground protection
- Precautionary area
- Proposed location of new heavy standard tree planting
- Root protection area (RPA) boundaries for category A and B trees
- Root protection area (RPA) boundaries for category C trees

Tree protection plan
 Location of trees, categorisation & protection/management proposals at 252 Finchley Road, Camden, London

Permission is granted to scale from this drawing for Local Authority Planning Approval purposes relating to tree protection measures only. Where applicable this drawing is to be read in conjunction with the arboricultural report. This drawing is the copyright of Barrell Tree Consultancy 2015. ©

This drawing to be reproduced in colour only.

Barrell Plan Ref: 15073-BT1

Provided Plan Refs: A-015 & FCH252_proposed ground floor.dwg

barrell
 TREE CONSULTANCY

Field House, Fordingbridge Business Park,
 Ashford Road, Fordingbridge SP6 1BY
 Tel: 01425 651470 Fax: 01425 653449
 www.barrelltreecare.co.uk