

Tree Constraints Plan

(Existing Layout)

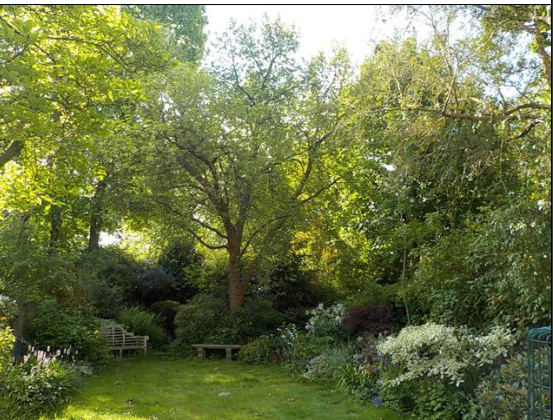

Photo 1

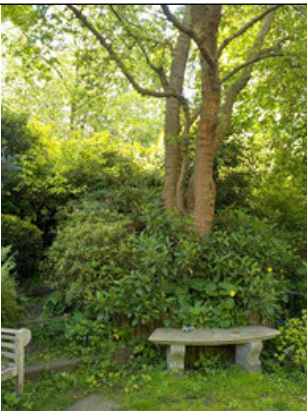

Photo 2



Photo 3

See the accompanying report for more photographs

Tree Ref.	Species	Height (m)	Root Protection Area		
			Radius (m)	m²	Square (m)
T1	Mulberry	9	5.5	96	9.8
T2	Small Leaved Azara	7.5	2.4	18	4.3
T3	Oak	23	9.0	254	16.0
T4	Magnolia	6	2.2	15	3.8
T5	Cherry	4	4.1	52	7.2
T6	Judas Tree	6	2.9	26	5.1
T7	Lilac	2.5	1.3	5	2.3
G8	Lime	15	4.2	55	7.4
T9	Purple Beech	16	9.0	254	16.0
T10	Lilac	3	1.1	4	1.9
T11	London Plane	13	6.7	142	11.9
T12	Platanus X Hispanica	3.5	1.7	9	3.0
T13	Shrub	4.5	2.4	18	4.3

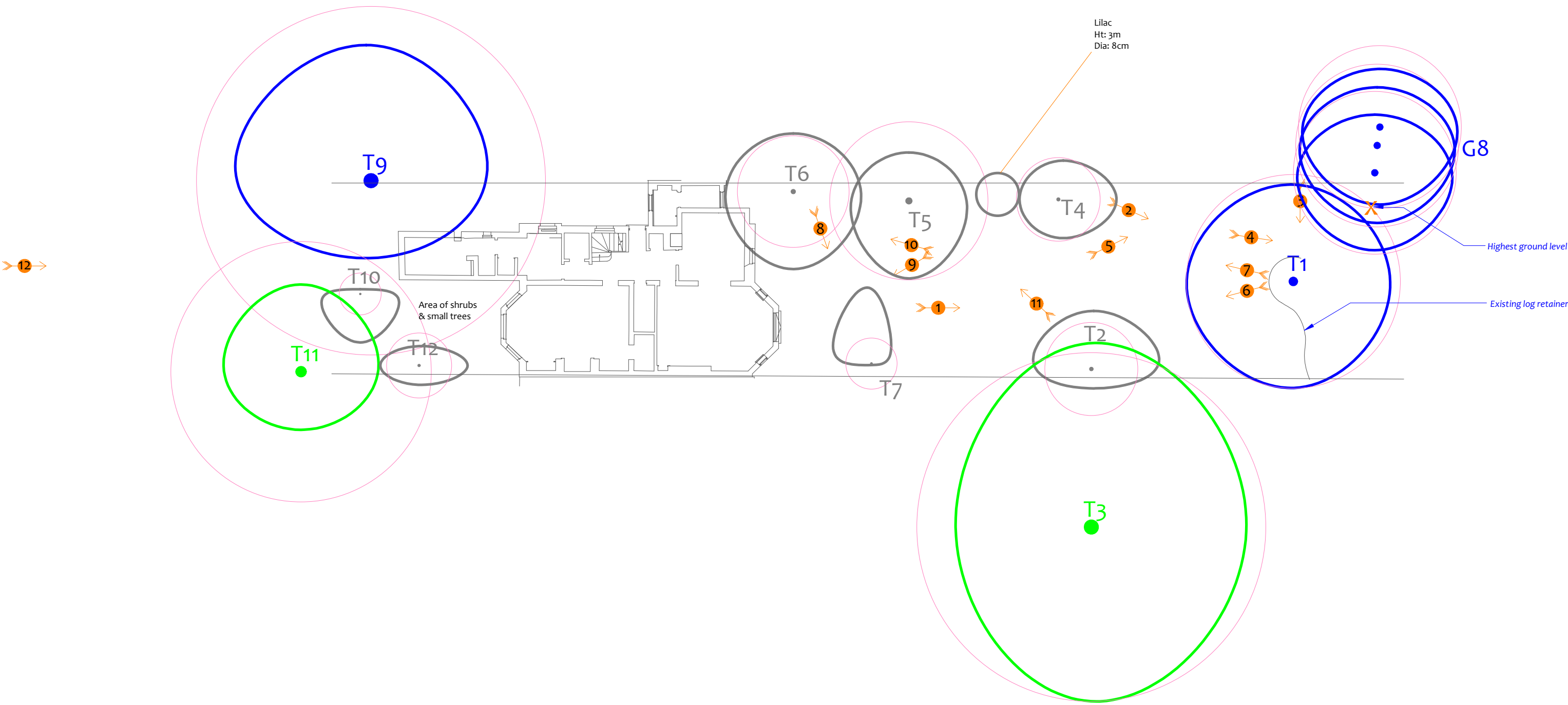

Drawing No: CCL 09320 / TCP Rev: 1

Title: Tree Constraints Plan (Existing Layout)

Site: 13 Elsworthy Road NW3 3DS

Scale: 1:200 Paper Size: A2



Tree Retention Categories

- Category A tree
- Category B tree
- Category C tree
- Category U tree

- Trees of high quality with an estimated life expectancy of 40+ years. Usually large trees with significant presence or smaller trees with excellent form. Retention of these trees is highly desirable.
- Trees of moderate quality with a life expectancy of 20+ years. Usually maturing trees, or younger trees with good form. Retention of these trees is desirable though less than Category A trees
- Unremarkable trees of low quality and merit. Individual specimens are not considered to be a material planning consideration.
- Trees unsuitable for retention due to their very poor condition.

Tree Constraints Plan

- BS 5837 Root Protection Area (radius = 12xstem diameter)
- Root Protection Area needing amendment due to site conditions, e.g. presence of existing road or building.
- Root Protection Area having been amended to account for site conditions

Photo 1

MN = Measured North:  
Canopy spreads are sometimes measured to an approximate N defined by site features. Often more accurate, especially where rows of trees are not aligned N-S or E-W.

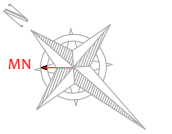

Impact Assessment Plan  
(Existing Layout with Proposals Overlaid)

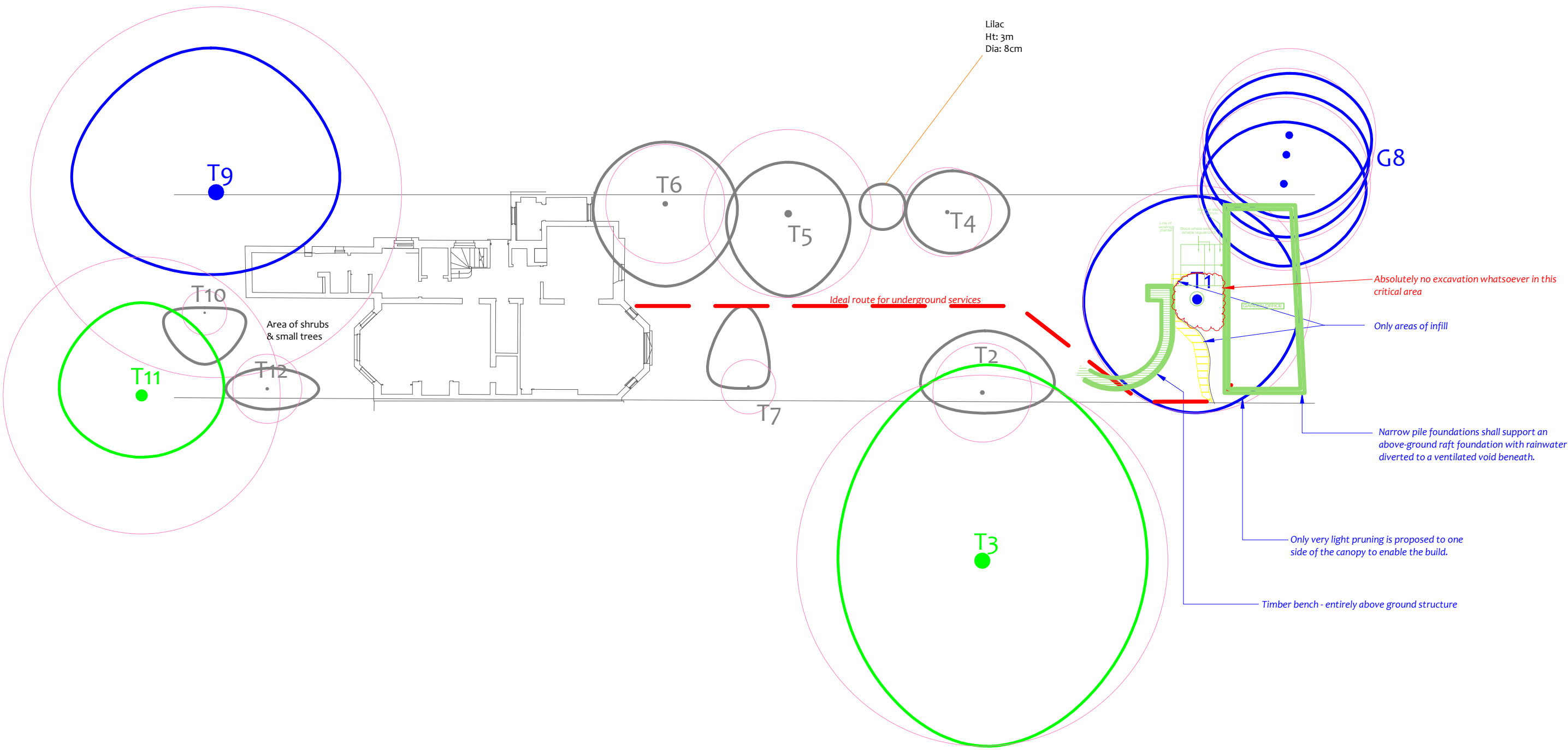
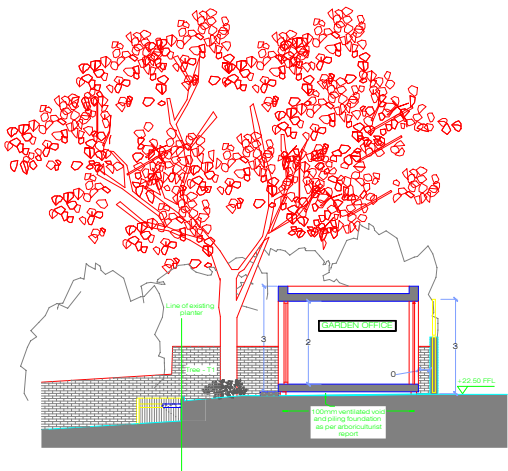

Drawing No: CCL 09320 / IAP Rev: 1

Title: Impact Assessment Plan  
(Existing Layout with Proposals Overlaid)

Site: 13 Elsworthy Road  
NW3 3DS

Scale: 1:200

Paper Size: A2

CROWN  
Arboricultural Consultants  
01422 316660

Tree Retention Categories  
Stems & canopies shown

- Category A tree
- Category B tree
- Category C tree
- Category U tree

- Trees of high quality with an estimated life expectancy of 40+ years. Usually large trees with significant presence or smaller trees with excellent form. Retention of these trees is highly desirable.
- Trees of moderate quality with a life expectancy of 20+ years. Usually maturing trees, or younger trees with good form. Retention of these trees is desirable though less than Category A trees
- Unremarkable trees of low quality and merit. Individual specimens are not considered to be a material planning consideration.
- Trees unsuitable for retention due to their very poor condition.

Impact Assessment Plan

- BS 5837 Root Protection Area (radius = 12xstem diameter)
- Root Protection Area needing amendment due to site conditions, e.g. presence of existing road or building.
- Root Protection Area having been amended to account for site conditions

T1 = Tree No 1    G2 = Group No 2    H3 = Hedge No 3

- Tree to be removed to facilitate the proposal
- Tree to be removed due to its low quality
- Proposed pruning

MN = Measured North:  
Canopy spreads are sometimes measured to an approximate N defined by site features. Often more accurate, especially where rows of trees are not aligned N-S or E-W.

Tree Ref.	Species	Height (m)	Root Protection Area		
			Radius (m)	m²	Square (m)
T1	Mulberry	9	5.5	96	9.8
T2	Small Leaved Azara	7.5	2.4	18	4.3
T3	Oak	23	9.0	254	16.0
T4	Magnolia	6	2.2	15	3.8
T5	Cherry	4	4.1	52	7.2
T6	Judas Tree	6	2.9	26	5.1
T7	Lilac	2.5	1.3	5	2.3
G8	Lime	15	4.2	55	7.4
T9	Purple Beech	16	9.0	254	16.0
T10	Lilac	3	1.1	4	1.9
T11	London Plane	13	6.7	142	11.9
T12	Platanus X Hispanica	3.5	1.7	9	3.0
T13	Shrub	4.5	2.4	18	4.3