

Soft landscaping with planting TBC between SUDS paving and brick facade, with mulching or gravel to mitigate splashing on brickwork

NOTES:
 Do not scale off this drawing.
 All Trade Contractors to be responsible for taking & checking their own site dimensions. Any errors or omissions to be reported to inside out architecture ltd immediately, prior to work being carried out.
 All site dimensions shown are based upon the measured survey of the property carried out by independent surveyors. The accuracy of this information is not the responsibility of inside out architecture ltd
 inside out architecture ltd also accept no responsibility for the accuracy of any Structural and Servicing information shown on this drawing. This information is shown for guidance purposes only, and where applicable - is based on information provided by the consulting Structural Engineers, consulting M&E Engineers, client representatives, and/or specialist subcontractors respectively. Reference should always be made to Engineers & Subcontractors current drawings & specifications.
 This drawing and design is the copyright of inside out architecture ltd and is not to be used for any purpose without their consent.

1 Courtyard Bench Plan
 803 1:10

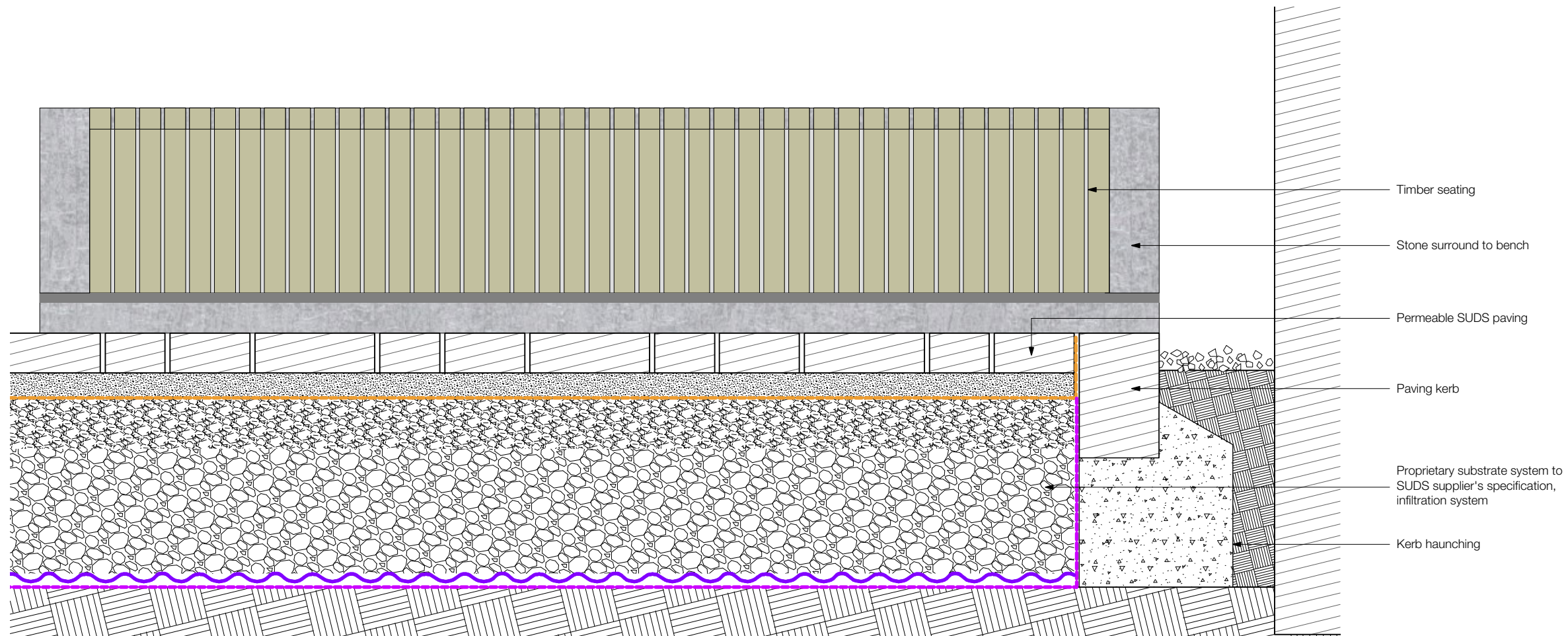

Timber seating
 Stone surround to bench
 Permeable SUDS paving
 Paving kerb
 Proprietary substrate system to SUDS supplier's specification, infiltration system
 Kerb haunching

DISCHARGE OF CONDITIONS

insideout
 architecture

6-8 Cole Street London SE1 4YH
 t 020 7367 6831 w www.io-a.com

Project:
 248 Kilburn High Road
 London NW6

Client:
 Studio 246 Media Ltd

Drawing:
 Courtyard Bench Details

Drawing Number: P1112_PC_803 Rev:

Date: June 2015 Scale: 1:10@A3

2 Courtyard Bench Elevation B
 803 1:10