

EXISTING LOWER GROUND FLOOR

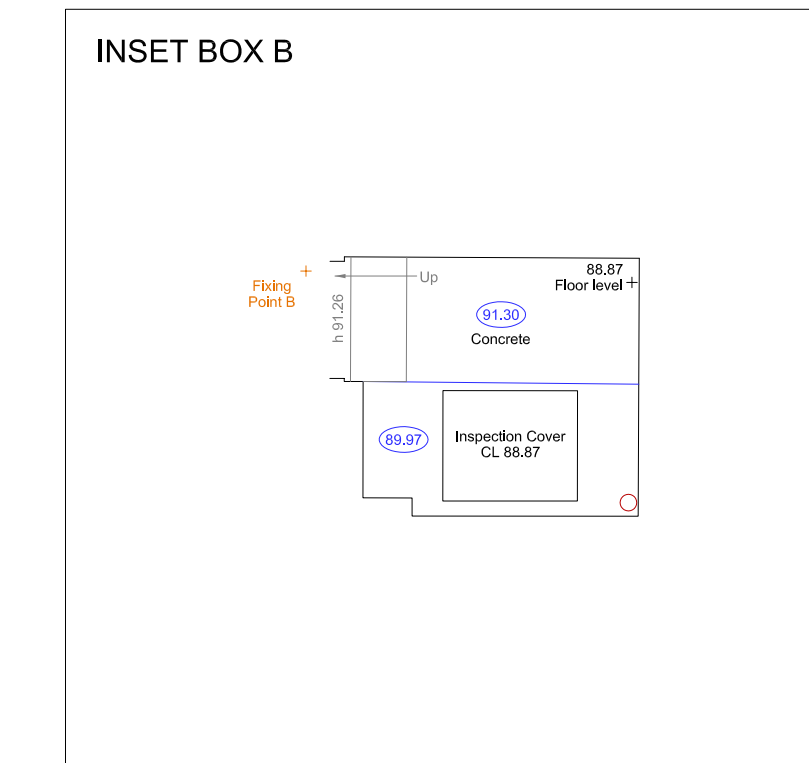

- NOTES**
- LEVELS ARE RELATED TO OSBM LOCATED ON WALL OF NO. 28 / 30 REDINGTON ROAD, LEVEL GIVEN AS 98.033 METRES.
 - SURVEY HAS BEEN CARRIED OUT TO AN ACCURACY COMMENSURATE WITH A 1:50 SCALE DRAWING.
- ABBREVIATION LIST**
- AC AIR CONDITIONING VENTS OR EQUIPMENT
 - BSU BEAM SLOPED UP
 - CSU CEILING SLOPED UP
 - DF DOWN SLOPE
 - ESL EMERGENCY LIGHT SWITCH
 - ET ELECTRIC POINT
 - EM ELECTRIC METER
 - EMR ELECTRIC METER ROOM
 - FA FIRE ALARM
 - FL FLOOR LEVEL
 - FS FUSES/ELECTRIC SWITCH
 - GL GALLERY
 - LC LEFT CALL BUTTON
 - LS LIGHT SWITCH
 - LSR LEFT CALL BUTTON
 - MP MAIN PLUMB
 - TOP OF COLUMN
 - TOP OF WALL
 - WC WALL LIGHT
- WHERE THESE ARE FOLLOWED BY A MEASUREMENT THIS IS THE HEIGHT MEASURED FROM THE FLOOR.
- GENERAL**
- AC AIR CONDITIONING VENTS OR EQUIPMENT
 - GS GALLERY
 - IC INSPECTION COVER
 - IN INLET
 - MP MAIN PLUMB
 - ST STAIR
 - SWP SOLID WOOD VENT PIPE
 - 1.00 BAL LEVEL
 - 1.000 FLOOR LEVEL
 - 100.130 LEVEL OF UNDERSIDE OF BEAM
 - 100.130 LEVEL OF UNDERSIDE OF RAOCTING
 - 100.130 LEVEL OF UNDERSIDE OF PIPE
 - 100 UNDERSIDE LEVEL
 - 100.00 CEILING LEVEL
 - 100.00 FALSE CEILING LEVEL

EXISTING GROUND FLOOR

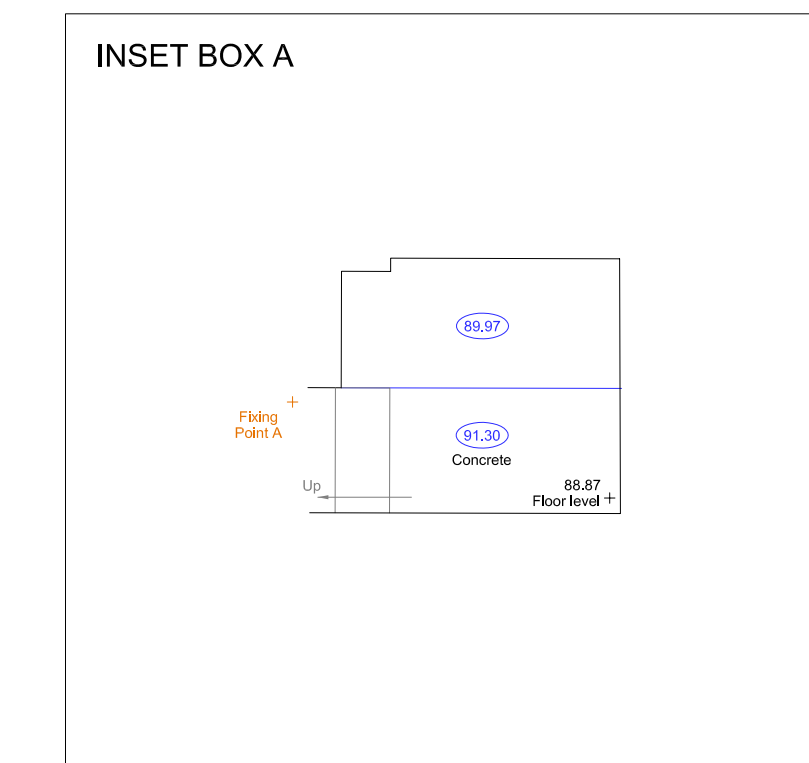
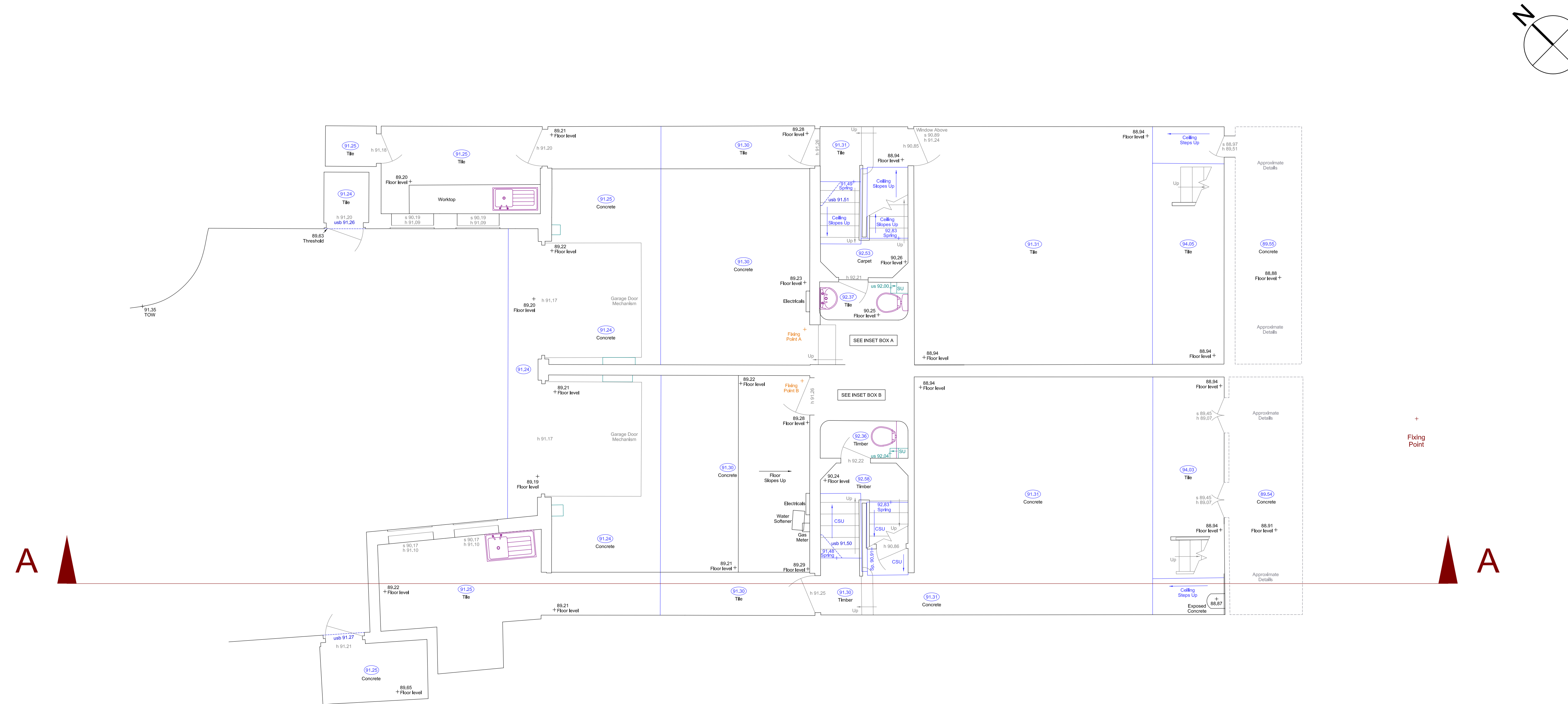
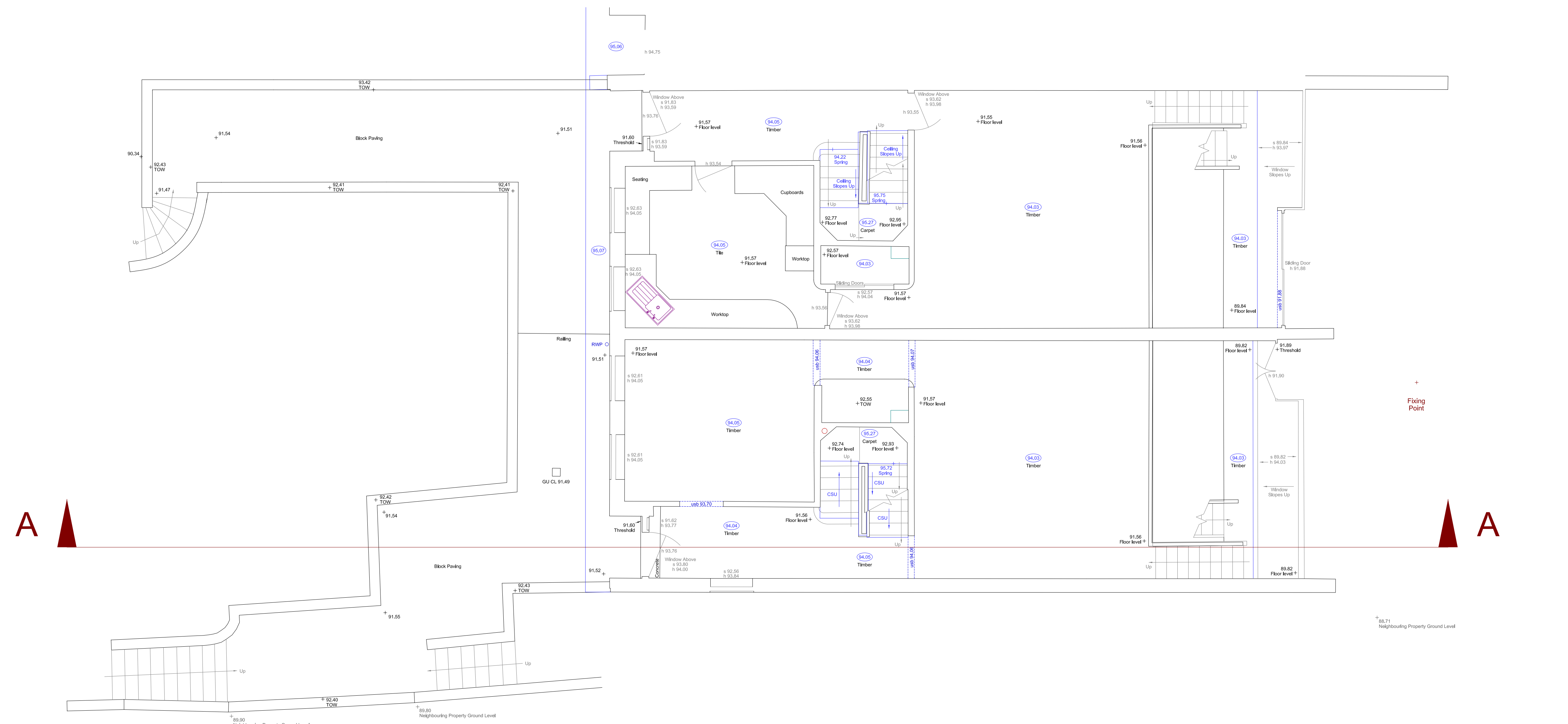

NO.	DATE	DETAILS

REVISIONS

74 WATCHET LANE
HOLMER GREEN
HIGH WYCOMBE
BUCKINGHAMSHIRE
HP12 6UD

TEL: 01494 718653
FAX: 01494 717276
EMAIL: enquiry@kndsurveys.com

CLIENT

MRS VALERIE WONG
&
MR KEVIN BROWN

JOB TITLE

1C - 1D OAKHILL AVENUE
NWS 7RD

DRAWING TITLE

FLOOR PLANS

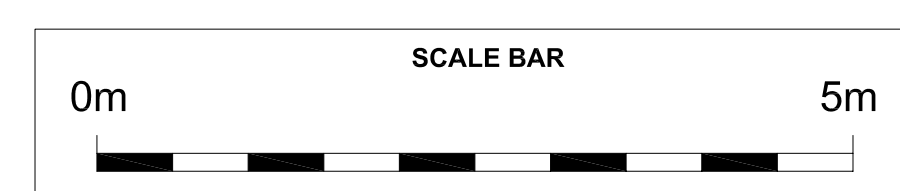

DRAWING No. K 12 14 - BG	DRAWN BY JS	DATE 27 NOV 2014
SURVEYED BY JS / AJF	SCALE 1:50@A0	