



# Tree Survey with Theoretical Radial Root Protection Area Plan & Site Specific Adapted Theoretical Root Protection Area (where used)

Theoretical Radial Root Protection Areas showing RPA of Retained Trees Only

Tree Protection Plan showing location of Tree Protection Fencing/Barriers and Ground Protection (if and when existing paving is removed)

Section 2.

Section 2.

Section 2.

Section 2.

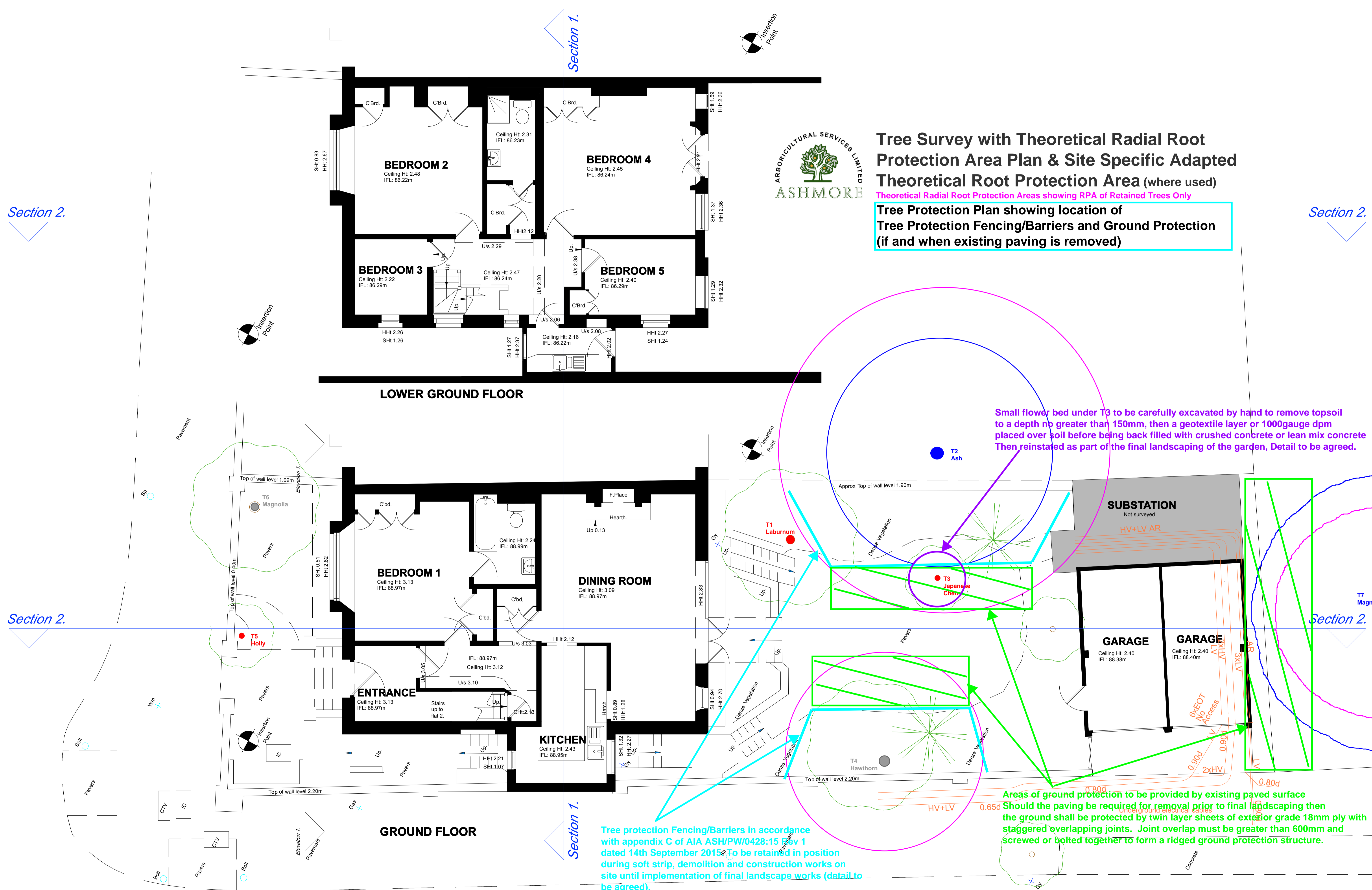

Small flower bed under T3 to be carefully excavated by hand to remove topsoil to a depth no greater than 150mm, then a geotextile layer or 1000gauge dpm placed over soil before being back filled with crushed concrete or lean mix concrete. Then reinstated as part of the final landscaping of the garden, Detail to be agreed.

Tree protection Fencing/Barriers in accordance with appendix C of AIA ASH/PW/0428:15 Rev 1 dated 14th September 2015. To be retained in position during soft strip, demolition and construction works on site until implementation of final landscape works (detail to be agreed).

Areas of ground protection to be provided by existing paved surface. Should the paving be required for removal prior to final landscaping then the ground shall be protected by twin layer sheets of exterior grade 18mm ply with staggered overlapping joints. Joint overlap must be greater than 600mm and screwed or bolted together to form a ridged ground protection structure.

<p>North point</p>	<p>Sign off</p>	<p>Issued dates</p> <p>Planning Building control Tender Construction Contract As built</p>	<p>Survey carried out by</p>	<p>Scale Bar</p> <p>0m 5m 10m</p>	<p>Dwg No: <b>TPP1/ASH/PEW/REV1</b> Date: <b>14/09/2015</b> Annotated By: <b>Philip Wood</b></p> <p>Indicative Plan: Do Not Scale, Check all Measurements on site Against Schedule in the Appendix B.</p>	<p>T7 Tree Number</p> <ul style="list-style-type: none"> <li>Tree Canopy</li> <li>Category B Trees</li> <li>Category C Trees</li> <li>Category U Trees</li> <li>Radial Theoretical Tree Root Protection Area</li> <li>Site Specific Adapted Theoretical Root Protection Area (where used)</li> </ul>	<p>Legal notes</p> <p>The contractor is to verify all dimensions and conditions on site. This drawing is the property of Hodgkinson Design and they reserve the copyright. It is issued on the understanding that it will not be copied, reproduced or disclosed in whole or in part to any unauthorised party without written permission from Hodgkinson Design.</p>	<p>Client: MR &amp; MRS NELL</p> <p>Project: 18 LINDHURST ROAD LONDON NW3</p> <p>Drawn: CKP</p>	<p>Drg: FLOOR PLANS AS EXISTING</p> <p>Status: PLANNING</p> <p>Date: FEB 2015</p> <p>Job No: 1547/00</p> <p>Scale: 1:50/A1</p> <p>Drg No: P.003</p>	<p><b>HODGKINSON DESIGN</b></p> <p>ARCHITECTURE INTERIOR DESIGN CORPORATE IDENTITY</p> <p>29 Alexander Street London W2 5NU T 020 7221 7557 F 020 7221 6336 E info@hodgkinson-design.co.uk www.hodgkinson-design.co.uk</p>
--------------------	-----------------	--	------------------------------	-----------------------------------	---	--	---	---	---	--