

Notes

These drawings are strictly copyright and are not to be used, printed or copied in any form unless expressly permitted by ASB Architects. Any scale indicated on the drawing is only correct provided the drawing is printed at the original "Sheet Size" field. This is typically A1 or A3, printed without reduction, @ 100%

This drawing may include information shown in colour as indicated by the "Printing" field. If the drawing is received incorrectly please refer to the sender or Architects.

Do not scale from these drawings. Refer to figured dimensions only and, where these are missing or cannot be inferred from the given dimensions, refer to the Architect for instruction.

Inform the Architect as soon as possible of any discrepancies found on site.

This drawing is to be read in conjunction with the structural engineers' drawings, all other layout and detail drawings together with the Schedule of Works and Specification.

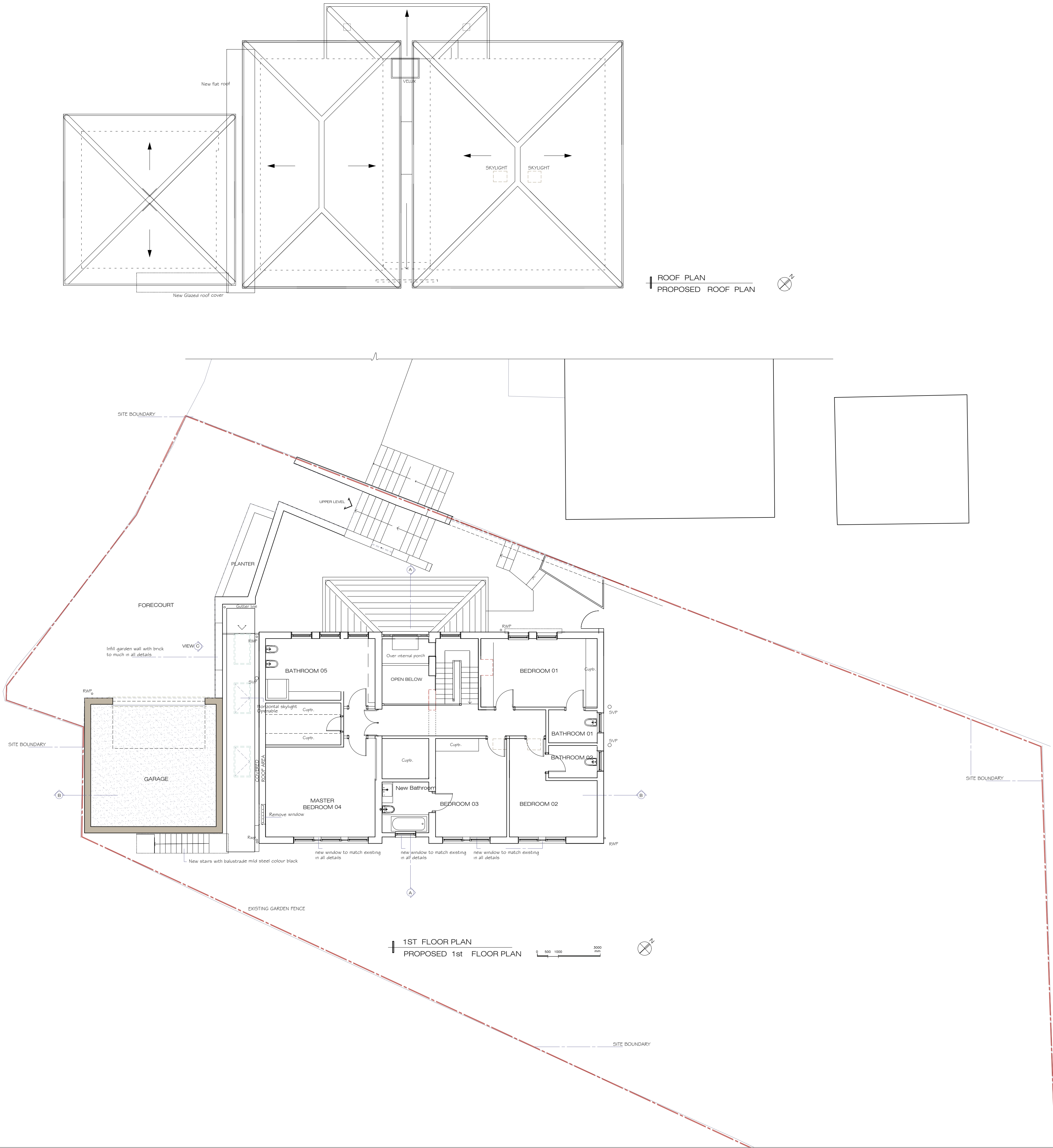

| REVISION | |
|--|--|
| PLANNING SET Date 18 AUGUST 2015 | |
| A - 29th SEPTEMBER 2015 DRAWING AMENDED | |

| Rev. | Date | Notes |
|------|------|-------|
| | | |

| ASB ARCHITECTS | |
|--|--------------------------------------|
| 215 West End Lane West Hampstead London NW6 1XJ T: 020 7431 5221 F: 02074315114 E: amos@asbarchitects.com | |
| Project | 20 HIGHFIELDS GROVE LONDON N6 6HN |
| Drawing | PROPOSED 1ST & ROOF PLAN |
| Dwg status | - |
| Date © | AUGUST 2015 |
| Project Ref | 299/ A1 |
| Printing | - |
| SCALE | 1: 100 |
| Sheet size | A1 |
| Drg No | Rev. |
| 011 | A |