



AcuityBrands.
Expanding the boundaries of lighting™



D-SERIES

D-Series





D-SERIES



Thermal Management
System Longevity
Striking Style
Fully Controllable



DSX2



DSX1





The modern styling of the **D-Series** is striking yet unobtrusive - making a bold, progressive statement as it blends seamlessly with its environment. **D-Series** takes all the benefits of LED technology and moulds it into a high performance, high efficacy and long life area lighting luminaire.

With its exceptional 'finned' thermal management system, D-Series is capable of delivering over 100,000 hours LED module life. Offering a wide range of lumen packages and optical distributions, D-Series delivers optimised lighting application designs.

With the integrated DALI option D-Series delivers a controllable luminaire that helps you realise energy consumption goals and demonstrate environmental responsibility. With its unique optics placed below each LED it ensures light is delivered where it needs to be, providing a uniform Nighttime Friendly environment with minimal light pollution.

optics / light source

- > 30, 60 & 100 LED options available.
- > Fully soak tested light engines ensuring LED reliability and eliminating early failures.
- > 4000°K colour temperature.
- > Six lumen packages available (4,000, 6,000, 9,000, 11,000, 17,000 & 22,000).

approvals

Complies with EN60598



IP IP65 luminaire and LED optic

Ta -40°C to +40°C

For further information please visit the Holophane website
www.holophane.co.uk



Typical Luminaire Performance

Configuration	Delivered Lumens	Power Consumption	Drive Current	Rated Life of LED Module (L70F50 @Tq 20°C)*
DSX1.L044	4695	56W	525mA	100,000+ hrs
DSX1.L064	6034	75W	700mA	100,000+ hrs
DSX1.L094	9204	106W**	525mA	100,000+ hrs
DSX1.L114	11983	142W	700mA	100,000+ hrs
DSX2.L174	17435	175W**	525mA	100,000+ hrs
DSX2.L224	21325	218W**	700mA	100,000+ hrs

Note: Data is correct at time of print.

* For other life metric data in line with IEC PAS62722-2-1 and 62717 contact your Holophane Representative for details.

** Estimated at time of print.

specification

Single-piece die-cast aluminium housing, that conforms to EN1706 AC-46500, with integral heat sink fins to optimise thermal management through conductive cooling. LED modules are IP65 with individual lenses, and high grade aluminium housing to transfer heat away from the LEDs and dissipate through the finned housing for cooling. The LED driver is mounted in direct contact with the finned housing for cooling to promote low operating temperature and long system life. Housing is completely sealed against moisture and environmental contaminants (IP65). Installation is via the integrated mounting block and integral arm that facilitate a quick and easy installation.

light distribution

Symmetric

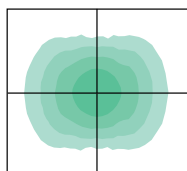

Asymmetric

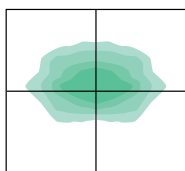

Forward Throw

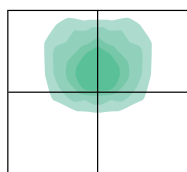

features and benefits

System Longevity

- > The D-Series's diecast aluminium housing acts as its primary heat sink. Its longitudinal fins employ conductive cooling techniques to dissipate heat away from the key LED components and driver that extends the life of the luminaire.
- > Light engine(s) consist of either 20 or 30 high efficacy LEDs (subject to chosen configuration) mounted to a metal-core circuit board to maximize heat dissipation and promote long life.

Exceptional Performance

- > Offering six lumen packages ranging from 4000 lm to 22000 lm with efficiencies of up to 99 lpw (Lumens Per Watts).
- > Three optimised distributions (asymmetric, symmetric and forward throw) delivered by quality LEDs and bespoke UV stabilised optics.
- > LED light engines with 0% ULOR ensuring night time friendly.

Complete Light Package

- > Available with DALI compatible driver and photocell options enabling control compatibility.
- > Fully integrated into Holophane standard column range.

applications

Landscaped areas
Car parks
Amenity areas
Town squares
Retail parks
Entrance roads
Parks



dimensions in mm

D-Series 1

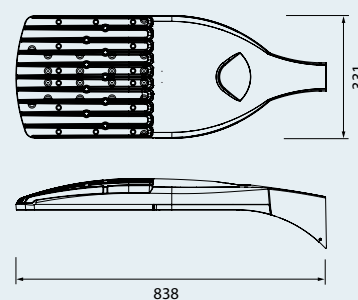

D-Series 2

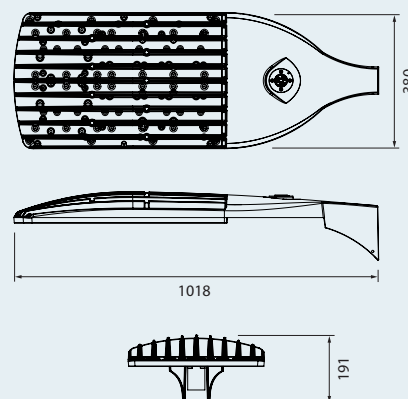

weight (with control gear)

DSX 1	12.2kg
DSX 2	17.7kg

windage (effective projected area)

DSX1	0.07m ²
DSX2	0.18m ²

TA

-40°C to 40°C



Holophane Conical Column

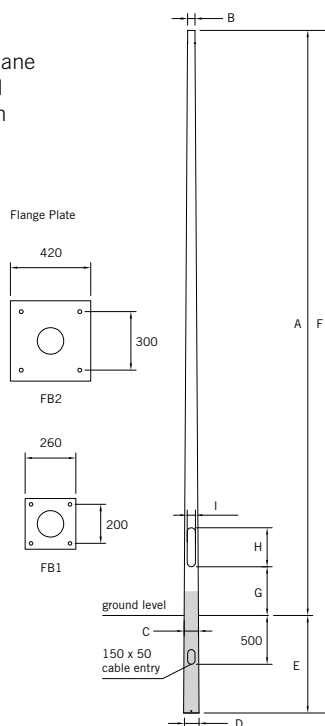

Holophane Tubular Column

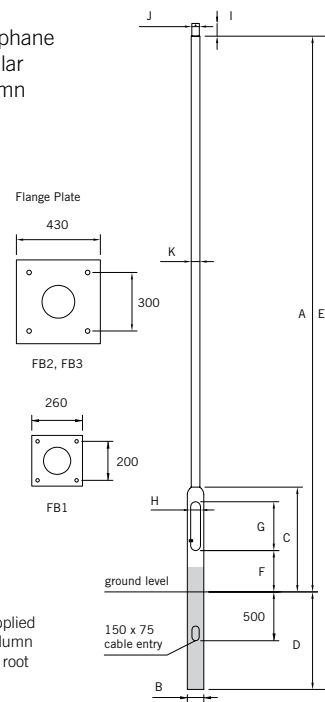

All columns are supplied with Earthing on column doors and Bitumen root as a standard.

Holophane Conical Column

	Height (m)	Nominal Height	Top Diameter	Base Diameter	Root End Diameter	Planting Depth	Overall Length	Door to Ground	Door Opening Length	Door Opening Width	Weight kg*	Bending Moment Nm
drawing ref	A	B	C	D	E	F	G	H	I	J	K	L
5m std	5000	76	136	146	800	5800	500	500	100	46.30	4900	
5m hd	5000	76	161	175	800	5800	500	500	100	52.60	6960	
6m std	6000	76	148	160	1000	7000	500	500	100	65	5800	
6m hd	6000	76	178	195	1000	7000	500	500	100	65	8070	
8m std	8000	76	171	186	1200	9200	500	600	115	88	11920	
8m hd	8000	76	212	232	1200	9200	500	600	115	110	18000	
10m std	10000	76	196	214	1500	11500	500	600	115	174	TBC	
10m hd	10000	76	246	271	1500	11500	500	600	115	208	TBC	

Code	Height	Flange Plate	Bolt
HEL.C.FS1	3-5m Poles	FB1	M18 x 400
HEL.C.FS2	6m Poles	FB1	M24 x 500
HEL.C.FS3	8-10m Poles	FB2	M24 x 500

* Exclusion TBC

Holophane Tubular Column

	Height (m)	Nominal Height	Base Diameter*	Base Height	Planting Depth	Overall Length	Door to Ground	Door Opening Length	Door Opening Width	Spigot Length*	Spigot Diameter*	Shaft Diameter*	Weight kg*	Bending Moment Nm
drawing ref	A	B	C	D	E	F	G	H	I	J	K	L	M	N
5m std	4700	140	1075	800	5500	425	500	100	100	130	76	89	36.13	6200
5m hd	4700	168	1075	800	5500	425	500	100	100	130	76	89	50.7	9865
6m std	5700	140	1075	1000	6700	425	500	100	100	130	76	89	42.69	6000
6m hd	5700	168	1075	1000	6700	425	500	100	100	130	76	89	60.07	9550
8m std	7700	168	1250	1200	8900	500	600	115	115	250	102	114	77.30	10100
8m hd	7700	168	1250	1200	8900	500	600	115	115	250	102	114	96.32	14000
10m std	9700	168	1250	1500	11200	500	600	115	115	250	102	114	142.10	TBC
10m hd	9700	194	1250	1500	11200	500	600	115	115	250	102	114	141.61	TBC
12m std	11700	194	1250	1700	13400	500	600	115	115	250	102	114	165.58	TBC

Code	Height	Flange Plate	Bolt
HELB.FS1	3-5m Poles	FB1	M18 x 400
HELB.FS2	6m Poles	FB1	M18 x 400
HELB.FS3	6m hd-12m Poles	FB2	M24 x 500

* Exclusion TBC

Note: The specifications of the Holophane luminaire and columns represents typical values. All descriptions, illustrations, drawings and specifications in the Holophane catalogue and website represent only general particulars of the goods to which they apply and shall not form part of any contract. The company reserves the right to change specifications at its discretion without prior notification or public announcement.

Flange Plate and J-Bolt information will be confirmed at time of order due to the necessity in ensuring the correct plate and J-Bolts are supplied.

std = Standard **hd** = Heavy Duty

Column type to be confirmed at time of order as this is based on luminaire weight, windage and geographical location.

ordering details - luminaire

Code

DSX1 D-Series 1 Luminaire

Code	Lamp Type (required)	
.L044	LED light engine producing c 4,000 lumens with a nominal 4000°K colour temperature	
.L064	LED light engine producing c 6,000 lumens with a nominal 4000°K colour temperature	
.L094	LED light engine producing c 9,000 lumens with a nominal 4000°K colour temperature	
.L114	LED light engine producing c 11,000 lumens with a nominal 4000°K colour temperature	
Code	Light Distribution	
.AY	Asymmetric	
.SY	Symmetric	
.FWC	Forward throw	
Code	Colour	
.C1	White RAL9016	
.C4	Graphite RAL7011	
.C6	Grey RAL7035	
.C7	Black RAL9005	
.C9	Metallic Silver RAL9006	
.RAL****	RAL Colour (customer choice)**	
Code	Options	
.C	Enhanced Paint Finish	
.T1	Complete with NEMA socket. (To accept standard NEMA Photocell, available from Holophane)	
.T	Mini Photocell	
.TLS	Tool-less Entry Trigger Latch	
.D2	DALI HF Electronic Control Gear	

Example

DSX1 .L114 .AY .C7 .T

Code

DSX2 D-Series 2 Luminaire

Code	Lamp Type (required)	
.L174	LED light engine producing c 17,000 lumens with a nominal 4000°K colour temperature	
.L224	LED light engine producing c 22,000 lumens with a nominal 4000°K colour temperature	
Code	Light Distribution	
.AY	Asymmetric	
.SY	Symmetric	
.FW	Forward throw	
Code	Colour	
.C1	White RAL9016	
.C4	Graphite RAL7011	
.C6	Grey RAL7035	
.C7	Black RAL9005	
.C9	Metallic Silver RAL9006	
.RAL****	RAL Colour (customer choice)**	
Code	Options	
.C	Enhanced Paint Finish	
.T1	Complete with NEMA socket. (To accept standard NEMA Photocell, available from Holophane)	
.T	Mini Photocell	
.TLS	Tool-less Entry Trigger Latch	
.D2	DALI HF Electronic Control Gear	

Example

DSX2 .L224 .AY .C7 .T

ordering details - columns and brackets

To find out more
please visit
www.holophane.co.uk

Code

DSX1B	D-Series 1 Tubular Compartment Column
DSX1C	D-Series 1 Conical Steel Column
DSX2B	D-Series 2 Tubular Compartment Column
DSX2C	D-Series 2 Conical Steel Column

Code	Luminaire Mounting Height
.5	5 metres*
.6	6 metres*
.8	8 metres
.10	10 metres
.12	12 metres**
Code	Brackets
.1A	Single head short bracket
.2A	Single head long bracket
Code	Column Category
.LMZ	For light & medium area wind zones
.HVZ	For heavy area wind zones
.HEZ	For extra heavy area wind zones
Code	Colour
.C1	White RAL9016
.C4	Graphite RAL7011
.C6	Grey RAL7035
.C7	Black RAL9005
.C9	Metallic Silver RAL9006
.RAL****	RAL Colour (customer choice)**
Code	Optional Base Type
.FB1	Flange base
.FB2	Flange base
Code	Optional Column Finish
.P1	Black undercoat primed
Code	Optional Paint Finish (bracket only)
.C	Enhanced paint finish

Example

DSX1B	.8	.1A	.LMZ	.C7	.FB1	.P1	.C
-------	----	-----	------	-----	------	-----	----

* Only available with DSX1. ** Only available with DSX1B and DSX2B.

Full details of Holophane columns can be found on our website www.holophane.co.uk

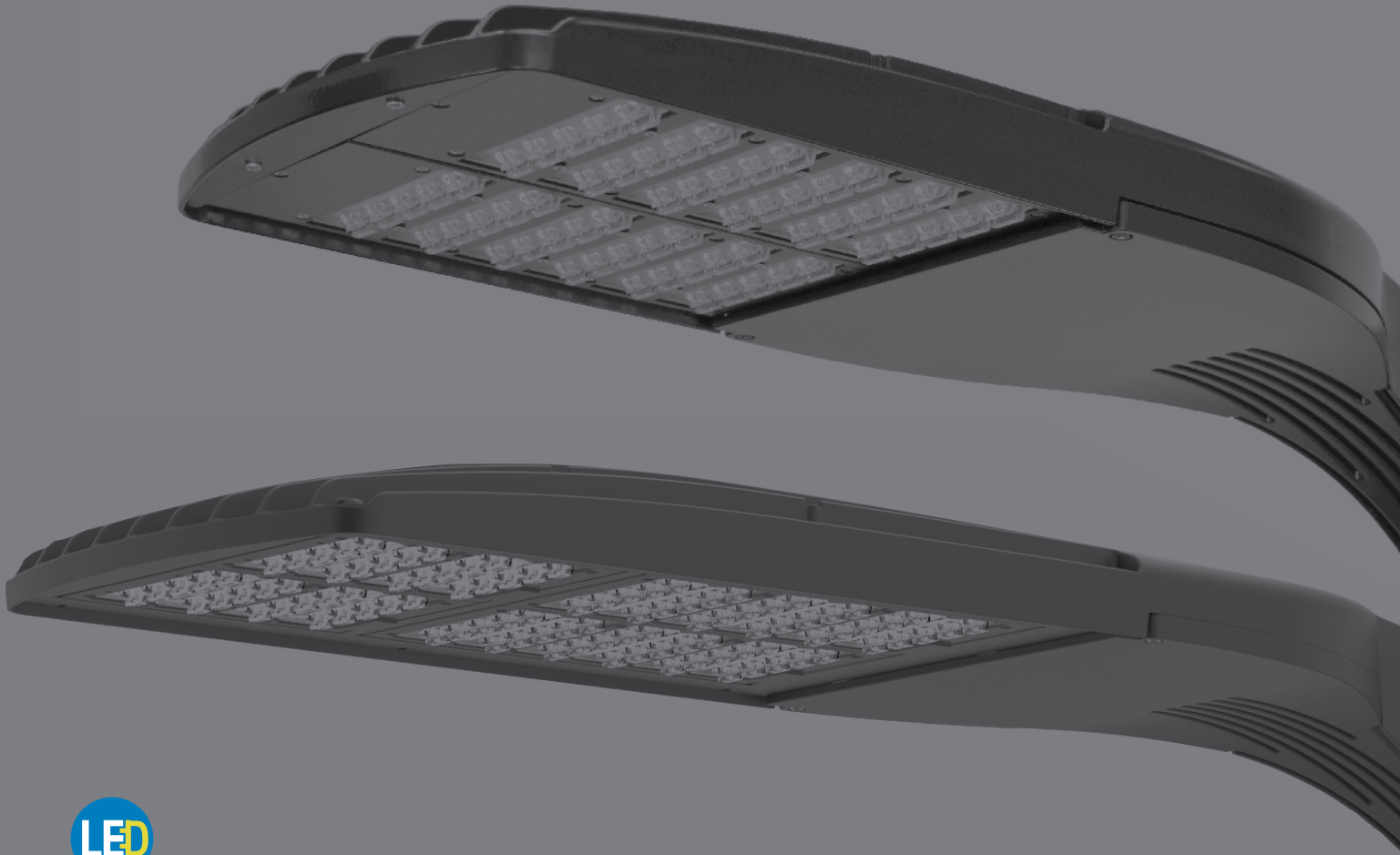

J-SERIES

Holophane Europe Limited
Bond Avenue, Bletchley, Milton Keynes MK1 1JG United Kingdom
Telephone: +44 (0) 1908 649292 UK Fax: +44 (0) 1908 367618
International Fax: +44 (0) 1908 272029
E-mail: info@holophane.co.uk
www.holophane.co.uk



Get the free mobile app at
<http://gettag.mobi>

