

NOTE/S :

THIS DRAWING IS BASED ON DIMENSIONS OBTAINED ON SITE WITH LIMITED ACCESS. WITHOUT FULL ACCESS TO PARTS OF THE SITE OPENING OF SURFACES WERE NOT POSSIBLE INSPECTION BEHIND FINISHES WERE NOT POSSIBLE.

THIS DRAWING REPRESENTS THE PROPOSED GENERAL ARRANGEMENT OF THE BUILDING AND THE SITE.

CYCLE STORAGE - MAISONETTE 1.  
LOCATED AT REAR PATIO  
IN UNDER COVER AREA  
WITH DIRECT LEVEL ACCESS  
TO STREET.

CYCLE STORAGE - MAISONETTE 2.  
LOCATED AT FRONT AREA  
WITH BRACKETS OFF EXISTING WALL  
AND WITH DIRECT ACCESS  
TO STREET.

REFUSE & RECYCLING AREA.  
LOCATED BEHIND EXISTING LOW WALL  
TO STREET FRONTAGE.

EXISTING BINS ARE LOCATED IN THE FRONT AREA.

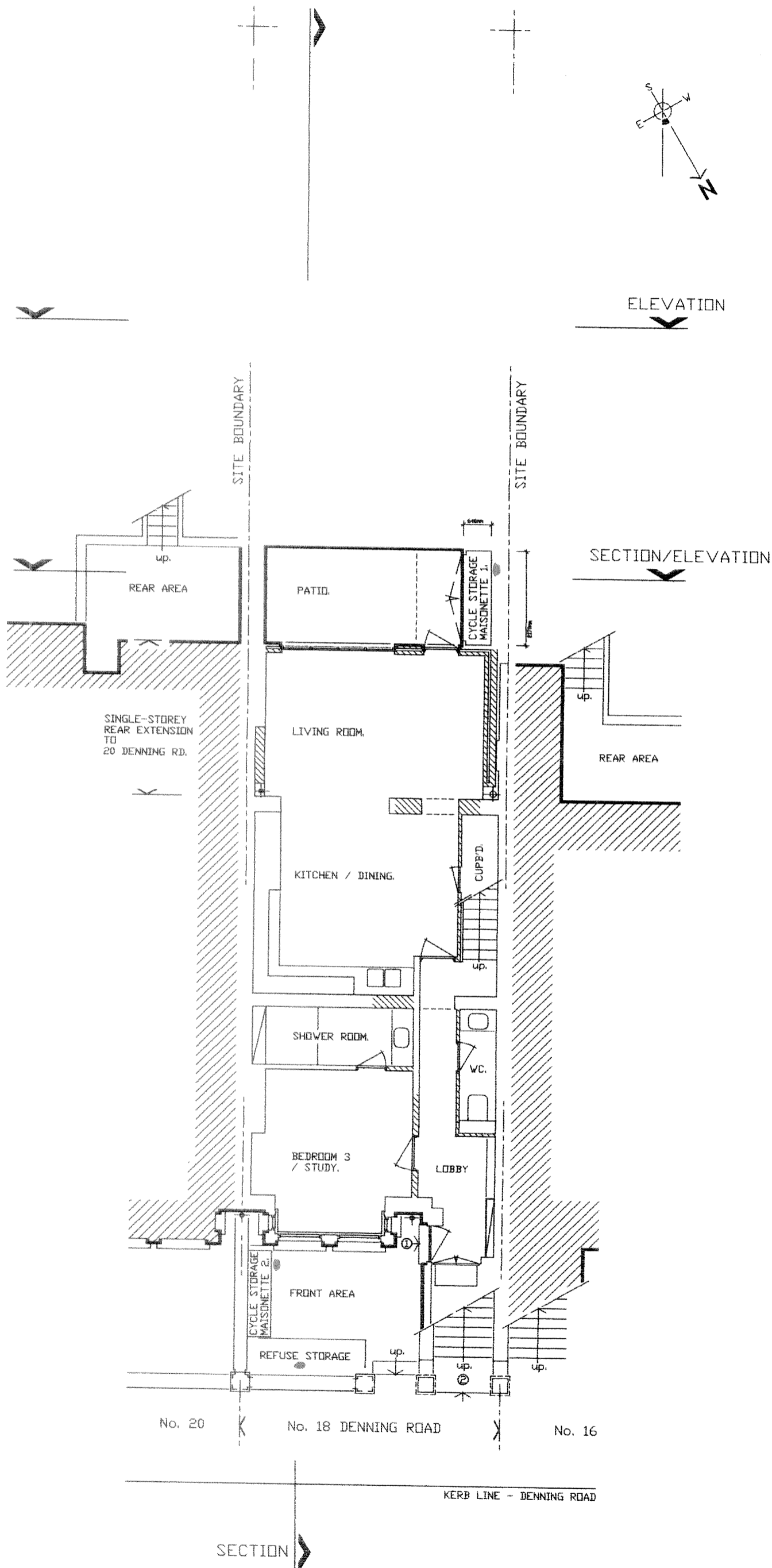

|                                                                         |                                                                   |
|-------------------------------------------------------------------------|-------------------------------------------------------------------|
| PROJECT                                                                 | 18 DENNING ROAD<br>LONDON<br>NW3 1ST                              |
| DRW. TITLE                                                              | PROPOSED PLAN<br>LEVEL 1.<br>CYCLE STORAGE<br>&<br>REFUSE STORAGE |
| SCALE                                                                   | 1/100 on A3                                                       |
| DATE                                                                    | SEPT 2015                                                         |
| STATUS                                                                  | PL.                                                               |
| REV.                                                                    | -                                                                 |
| DRW. NO.                                                                | MM1403 / 021                                                      |
| MD+CD architecture + design<br>© COPYRIGHT ALL RIGHTS RETAINED BY MD+CD |                                                                   |