

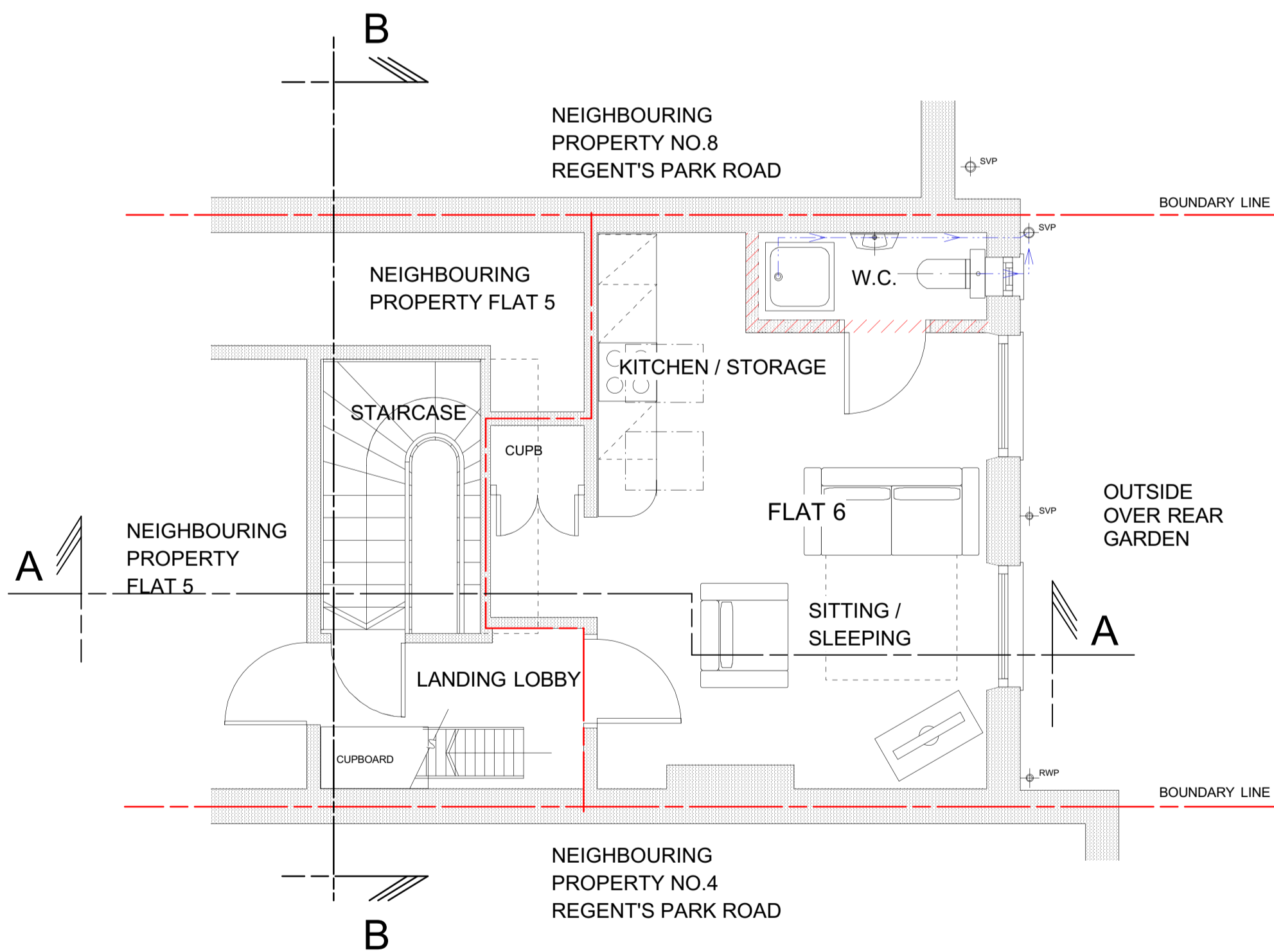

PART ROOF PLAN AS EXISTING

1 : 50



PART SECOND FLOOR PLAN AS EXISTING

1 : 50

KEY  
 Existing construction to be demolished

**JAMES RICHARDSON**  
 design consultancy  
 5 Albert Road, Stamford, Lincolnshire PE9 2EA  
 Tel 01780 482 866 Mobile 07711690 925  
 jamesrdesign2@aol.com

**Notes**  
 1. All dimensions are in millimetres  
 2. All dimensions to be checked on site prior to construction  
 3. Copyright of this drawing is the property of James Richardson

**Job**  
 6 Regents Park Road  
 London  
 Top Flat

**A2**

**Drawing**  
 Part Second Floor  
 Plan as existing and  
 Roof plan as existing

**Status**  
 Preliminary  
 Planning  
 Tender  
 Building Regs  
 Construction

**Scale**  
 1: 50

**Date**  
 10.09.15

**Drawn by**  
 E.T.

**Approved by**  
 J.R.

**Drawing No.**  
 562/103

**Issue**

