

**A. GLAZING ADAPTER BALUSTRADE**  
1.1M HEIGHT TO BE 12MM CLEAR GLAZING -  
TOUGHTENED LAMINATE

**B. GLAZING DOUBLE ADAPTER BALUSTRADE**  
1.8M HEIGHT TO BE 15MM OBSCURE GLAZING -  
TOUGHTENED LAMINATE

**B**

GLASS BALUSTRADE SYSTEM

GLAZING PANEL - 12MM TOUGHENED GLASS CLEAR

GLAZING PANEL - 15MM TOUGHENED GLASS OBSCURE

STAINLESS STEEL CURVED CAP

1100

1650

950

403

DECKING



This is to be used on the 1.8m high glazing due to additional support and strength required.

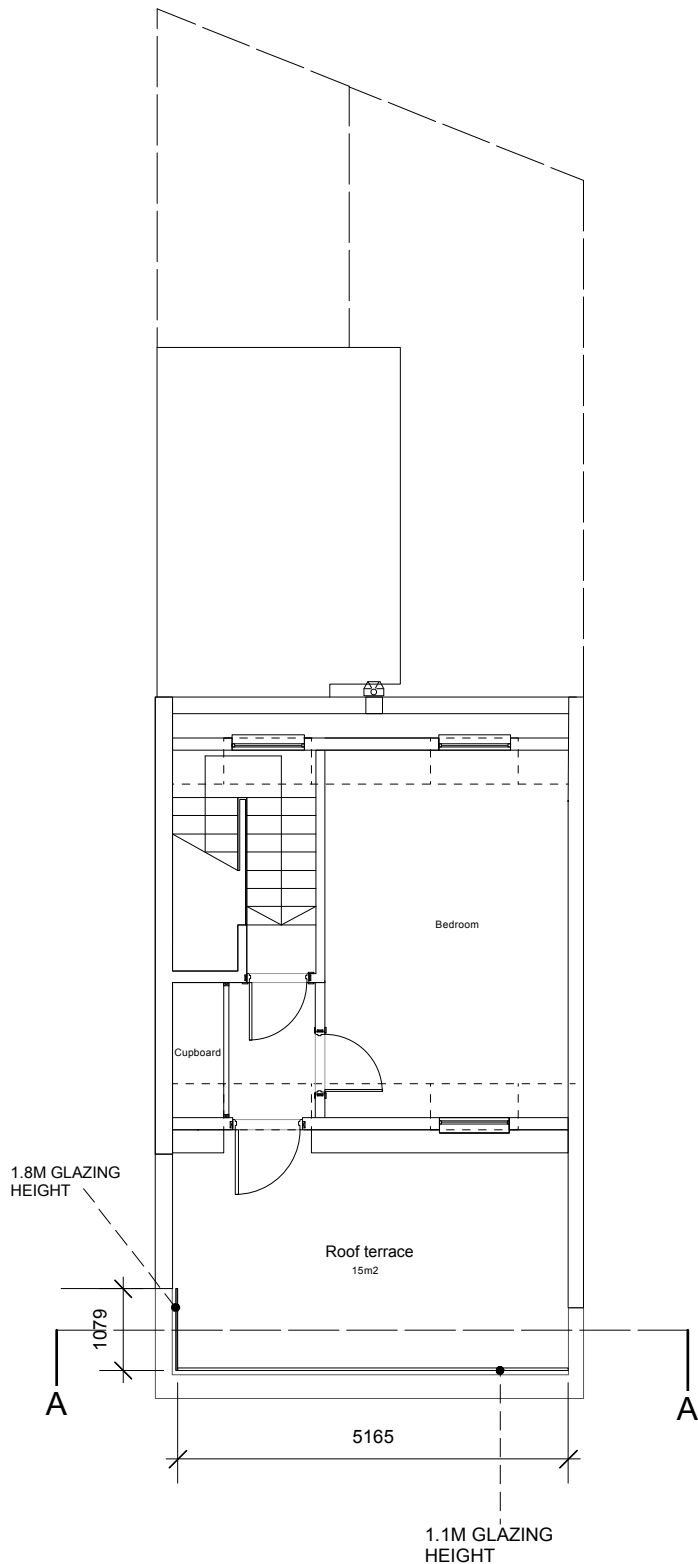

<b>Project:</b>	<i>LYME TERRACE</i>	<b>REVISION</b>	<b>DATE</b>	Note:
<i>CONDITION - GLAZING SCREEN</i>				
<b>Drawing No:</b>	<b>Con2</b>			
<b>Scale:</b>	<b>Drawn</b>			
<i>1:100 @ A4 Size</i>	<i>INFORMATION ONLY</i>			

FOR INFORMATION  
PURPOSES ONLY  
PROPERTY OF NIVEDA  
REALTY