



NOTES

NOT FOR CONSTRUCTION

NOTE : THESE DRAWINGS ARE FOR PLANNING PURPOSES ONLY AND SHOULD NOT BE USED FOR DETAILED BUILDING METHODS.

LEGEND

NOTES

drawing status: **P L A N N I N G**

revision:	description:	date:
P.01	Issued for Information	11.09.15

P L A N N I N G

SADAarchitecture

P : Suite 14, Arquen House, 4-6 Spicer St, St Albans, AL3 4PQ.

E : letterbox@sada-architecture.com

W : www.sada-architecture.com

T : 01727 860810

project:	15-015	Alma Street
drawing:	Existing Roof Plan	
date:	11/09/15	drawn by: MP
scale:	1:50@A3	check: CC
	dwg no.: 104	rev. no.: P.01

© Copyright: This drawing or design may not be reproduced without permission.

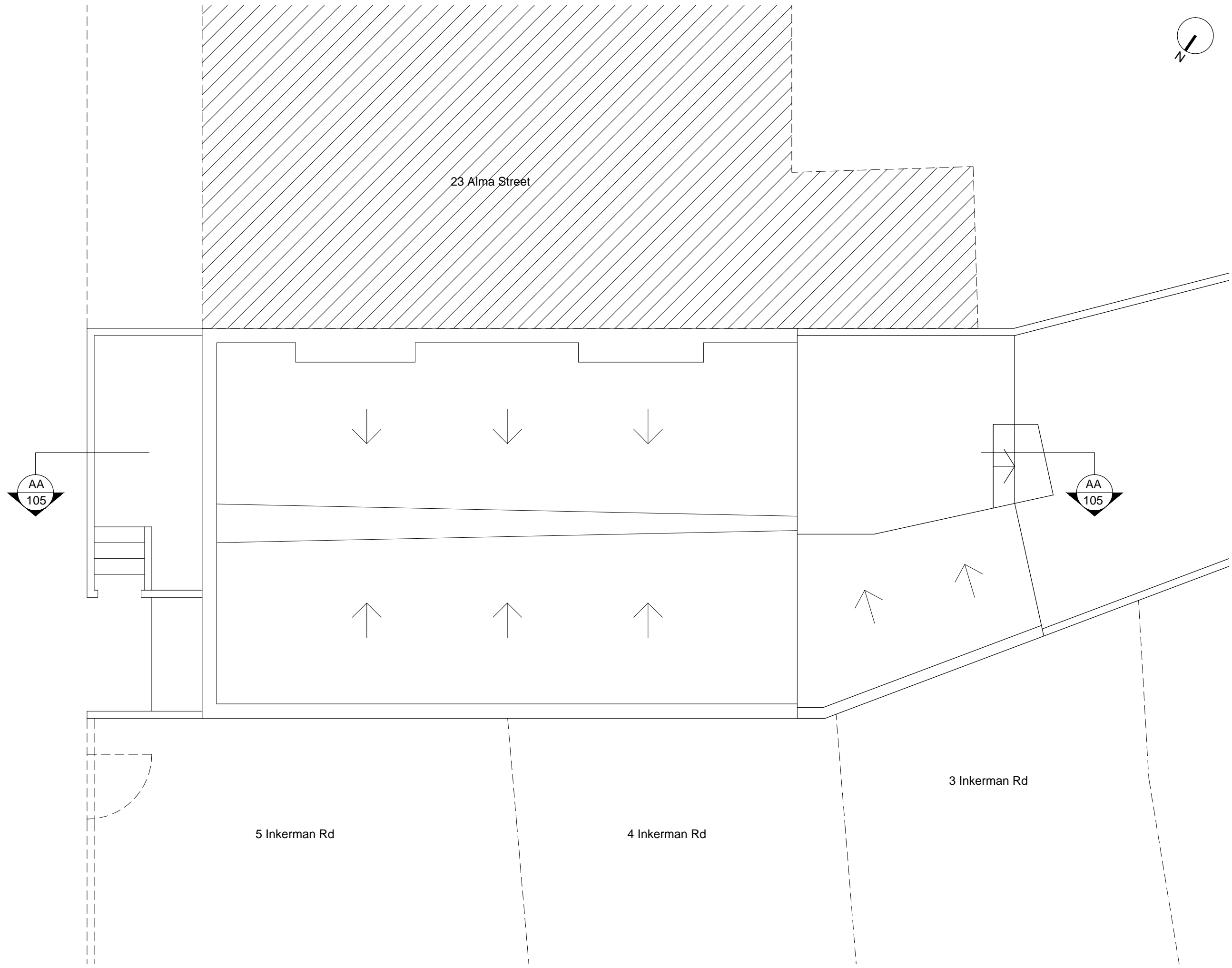

Existing Roof Plan

