

- RC downstand location
- SS single leaf inlet
- Precast concrete coping

REV	DATE	DESCRIPTION
C00	10.07.2015	Stage 2 Design Issue

CONSULTANTS	
CLIENT:	Stanley Sidings
SCHOOL CLIENT TEAM:	Hawley School
	SCABAL
	Camden Children, Schools and Families
CONTRACTOR:	McLaughlin & Harvey
COST CONSULTANT:	Gardiner and Theobald
STRUCTURAL ENGINEER:	Walsh Group
MECHANICAL ENGINEER:	Kane Group
PUBLIC HEALTH ENGINEER:	Kane Group
ELECTRICAL ENGINEER:	Playfords

- NOTE
- Do not scale from this drawing.
 - All dimensions to be checked on site by the contractor and such dimensions to be his responsibility.
Report all drawing errors, omissions and discrepancies to the architect.
 - This document may be issued in an uncontrolled CAD format to enable others to use it as background information to make alterations and/or additions. In that instance the file will be accompanied by a PDF version. It is for those making such alterations and additions to ensure that they make use of current background information.
 - AHMM Ltd accepts no liability for any such alterations or additions to the background information or arising out of changes to background information which occur prior to alterations of additions being made.

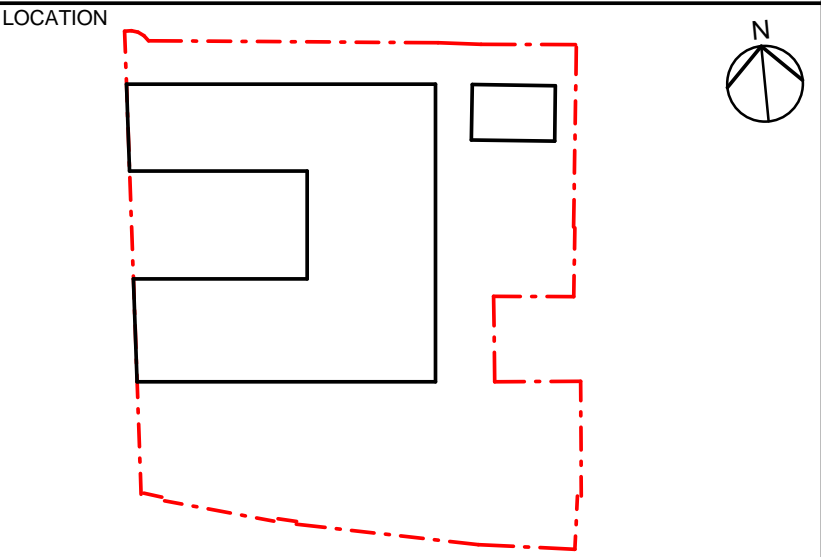

ALLFORD HALL MONAGHAN MORRIS					
ARCHITECTS Ltd MORELANDS, 5-23 OLD STREET LONDON EC1V 9HL TEL 020 7251 5261 FAX 020 7251 5123 WEB WWW.AHMM.CO.UK					
job title Hawley Primary School					
drawing title / location West Elevation Brickwork Setting out 2-2					
drawn by HC	checked DM	scale 1 : 50 @ A1	status FOR INFORMATION		
project HISC	number AHMM 01	ZZZ	DR	A	800 0058
					revision C00