

REV	DATE	DESCRIPTION
C00	10.07.2015	Stage 2 Design Issue

CONSULTANTS	
CLIENT:	Stanley Sidings
SCHOOL CLIENT TEAM:	Hawley School
	SCABAL
	Camden Children, Schools and Families
CONTRACTOR:	McLaughlin & Harvey
COST CONSULTANT:	Gardiner and Theobald
STRUCTURAL ENGINEER:	Walsh Group
MECHANICAL ENGINEER:	Kane Group
PUBLIC HEALTH ENGINEER:	Kane Group
ELECTRICAL ENGINEER:	Playfords

NOTE

- Do not scale from this drawing.
- All dimensions to be checked on site by the contractor and such dimensions to be his responsibility.
- This document may be issued in an uncontrolled CAD format to enable others to use it as background information to make alterations and/or additions. In that instance the file will be accompanied by a PDF version. It is for those making such alterations and additions to ensure that they make use of current background information.
- AHMM Ltd accepts no liability for any such alterations or additions to the background information or arising out of changes to background information which occur prior to alterations or additions being made.

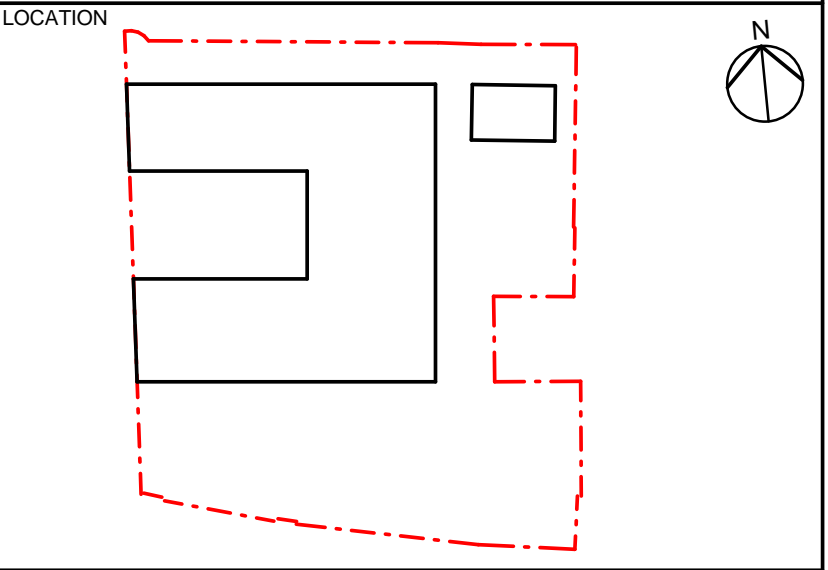

ALLFORD HALL MONAGHAN MORRIS	
ARCHITECTS Ltd MORELANDS, 5-23 OLD STREET LONDON EC1V 9HL TEL 020 7251 5261 FAX 020 7251 5123 WEB WWW.AHMM.CO.UK	
job title Hawley Primary School	
drawing title / location East Elevation Brickwork Setting out 1-2	
drawn by HC	checked DM
scale 1 : 50 @ A1	status FOR INFORMATION
project HISC	number AHMM 01
revision ZZZ	revision DR
revision A	revision 800
revision 0055	revision C00