

CONSULTANTS	
CLIENT:	Stanley Sidings
SCHOOL CLIENT TEAM:	Hawley School
	SCABAL
	Camden Children, Schools and Families
LANDSCAPE ARCHITECT:	Fabrik
PLANNING CONSULTANT:	Gerald Eve
STRUCTURAL ENGINEER:	Walsh Group
MECHANICAL ENGINEER, FIRE, BREEAM, ENERGY, ACOUSTICS:	Waterman Building Services
COST CONSULTANT:	Gardiner and Theobald
TRANSPORT CONSULTANT	Arup
CDM CORDINATOR	Waterman Building Services

01	17/07/15	For Construction
00	10/07/15	Stage 2 Design Issue

REV	DATE
NOTE	
1. Do not scale from this drawing, other than for Planning purposes.	
2. All dimensions to be checked on site by the contractor and such dimensions to be his responsibility.	
3. Report all drawing errors, omissions and discrepancies to the architect.	
4. This document may be issued in an uncontrolled CAD format to enable others to use it as background information to make alterations and/or additions. In that instance the file will be accompanied by a PDF version. It is for those making such alterations and additions to ensure that they make use of current background information. AHMM Ltd accepts no liability for any such alterations or additions to the background information or arising out of changes to background information which occur prior to alterations of additions being made.	

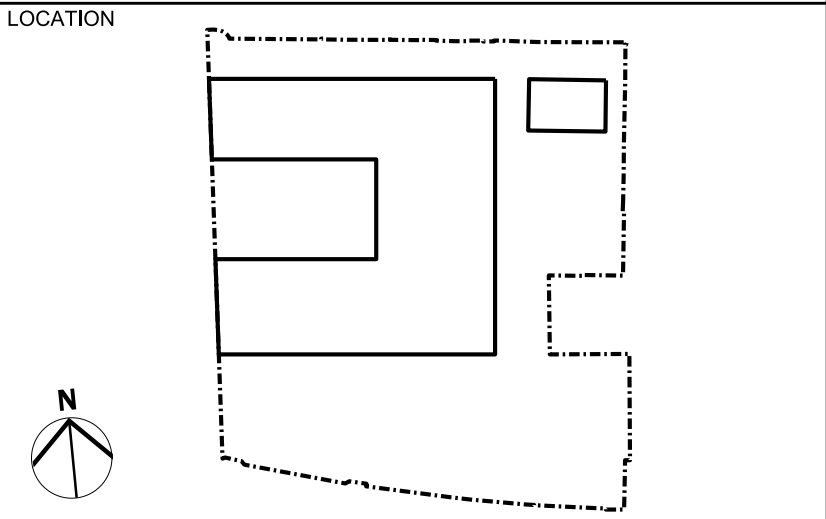

**ALLFORD HALL MONAGHAN MORRIS**  
ARCHITECTS Ltd  
MORELANDS, 5-23 OLD STREET LONDON EC1V 9HL  
TEL 020 7251 5261 FAX 020 7251 5123 WEB WWW.AHMM.CO.UK

job title  
HAWLEY PRIMARY SCHOOL

drawing title / location  
EXTERNAL BRICKWORK DETAILS  
SHEET 2

drawn by	checked	scale	status
DM		1:5@A1; 1:10@A3	CONSTRUCTION

project	number	revision
HISC	AHMM 00 ZZZDR 800 0004	C01