



Plot A - North Elevation

- Contract value engineered proposal
- - - Proposal approved Aug 2014
- - - Existing site level
- Existing buildings

Notes
 Check this drawing is the latest revision.
 Do not scale from this drawing.
 Do not use the information on this drawing without checking all dimensions on site.
 Do not use any areas indicated for either valuation, purchase, sale or any other form of legally binding contract.
 Do not reproduce any part of this drawing without prior written consent.

- Habitat boxes Plot A**
- Sparrow boxes 16 no.
 - Swift boxes 4 no.
 - Black Redstart boxes 2 no.
 - Bat boxes 5 no.
- Plot A total: 27 no.**

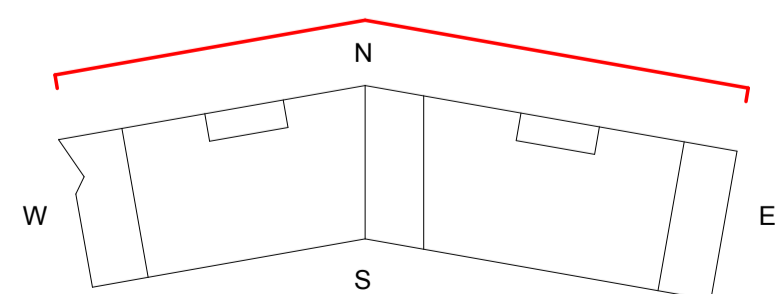

NOTE: Box locations and specification as per ER's

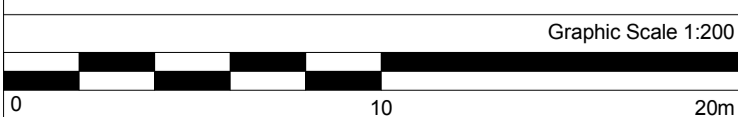

| Rev | Date | Description | Drawn | Checked |
|-----|----------|---|-------|---------|
| D | 10.07.15 | Update of bird / bat box locations on planning drawings | IC | CD |
| C | 12.06.15 | Updating of planning drawings to reflect the Contract Value Engineered Schedule | AP | EB |
| B | 02.09.14 | All information shown is in line with Stage E Tender drawings. Revision clouds indicate changes from previously approved planning drawings. | HFB | |
| A | 24.02.14 | Levels to terrace W2 corrected / Green roofs added to part of terrace | HFB | |



| | | | |
|-----------|---|------------|----------|
| Project | Agar Grove Block A | | |
| Client | Hill Partnership Ltd for Camden Council | | |
| Dwg Title | Plot A - North Elevation | | |
| Dwg no. | 1423_DWG_PL_A_00_250 | Revision | D |
| Scale | 1:100 @ A1 | Date | Dec 2013 |
| Drawn by | AP | Checked by | EB |

FOR PLANNING