

NE
IN

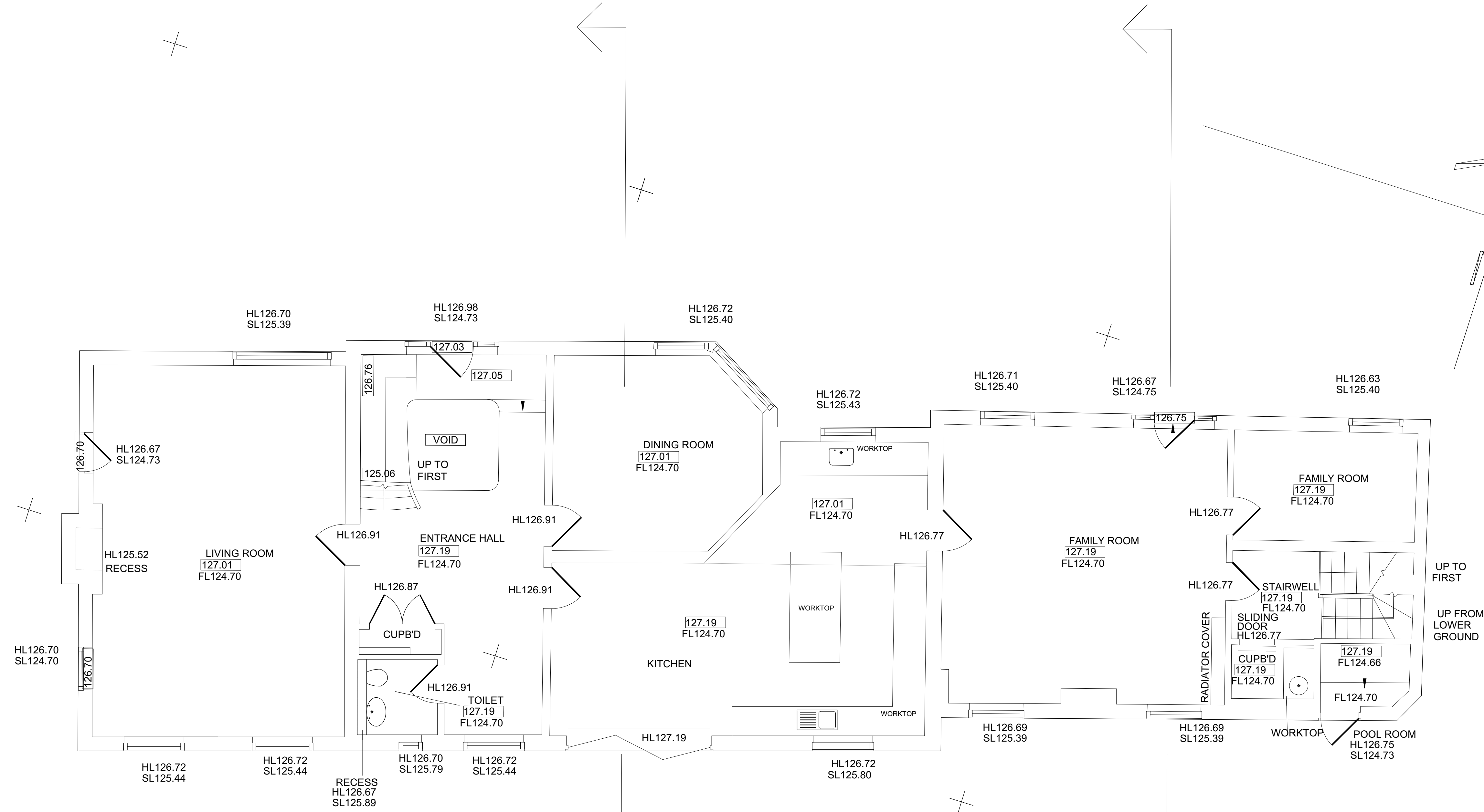

+ 526100n
185990m

+ 526100mE
185980mN

+ 526070mE
185960mN

+ 526080mE
185960mN

+ 526100mE
185970mN

+ 526090mE
185960mN

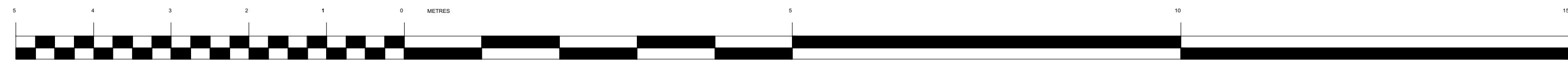

Charlton
Brown
Architects

1 Oak Hill Way, Hampstead, NW3 1275/S 02
GF existing plan

The Old Chapel, Shepherds Walk, Hampstead, London, NW3 6UE Scale 1:100 @ A3
T 020 7794 1234 F 020 7435 5085 E offices@charltonbrown.com This drawing is copyright
Please follow the drawings exactly. If you find errors or omissions ask for clarification. Do not proceed without revised instructions. No dimensions to be scaled