

01 WIN - 600

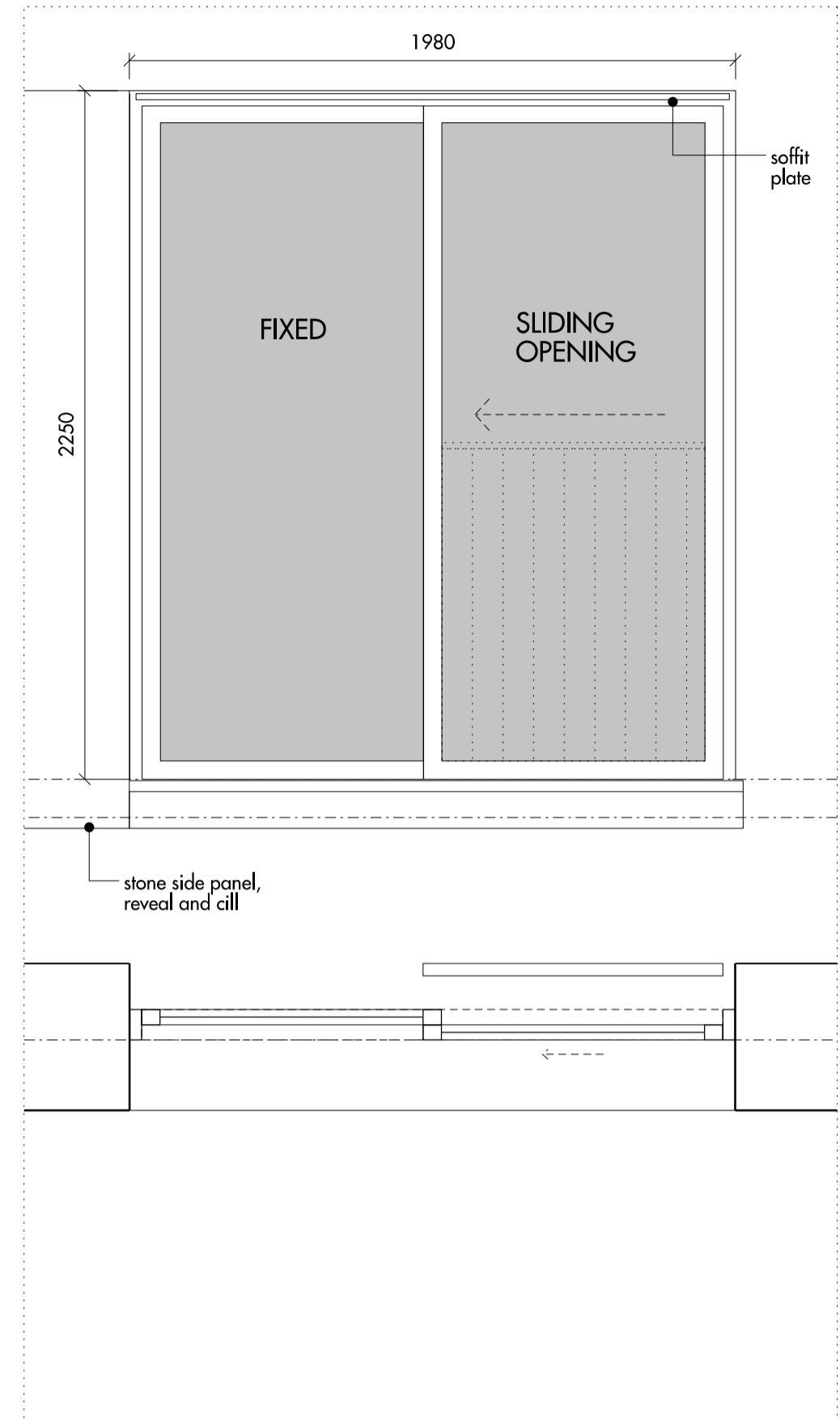

02 WIN - 601

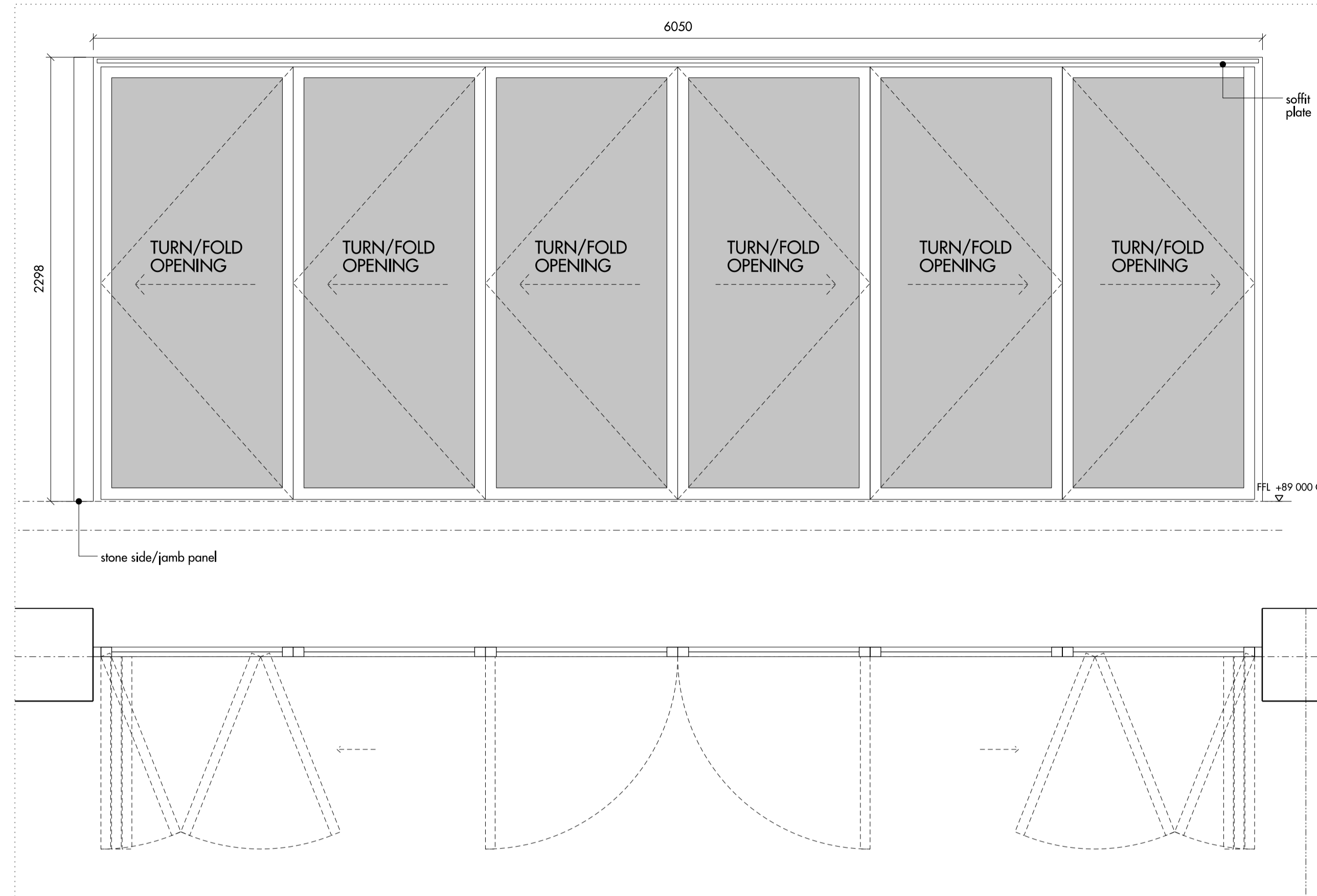

03 WIN - 602

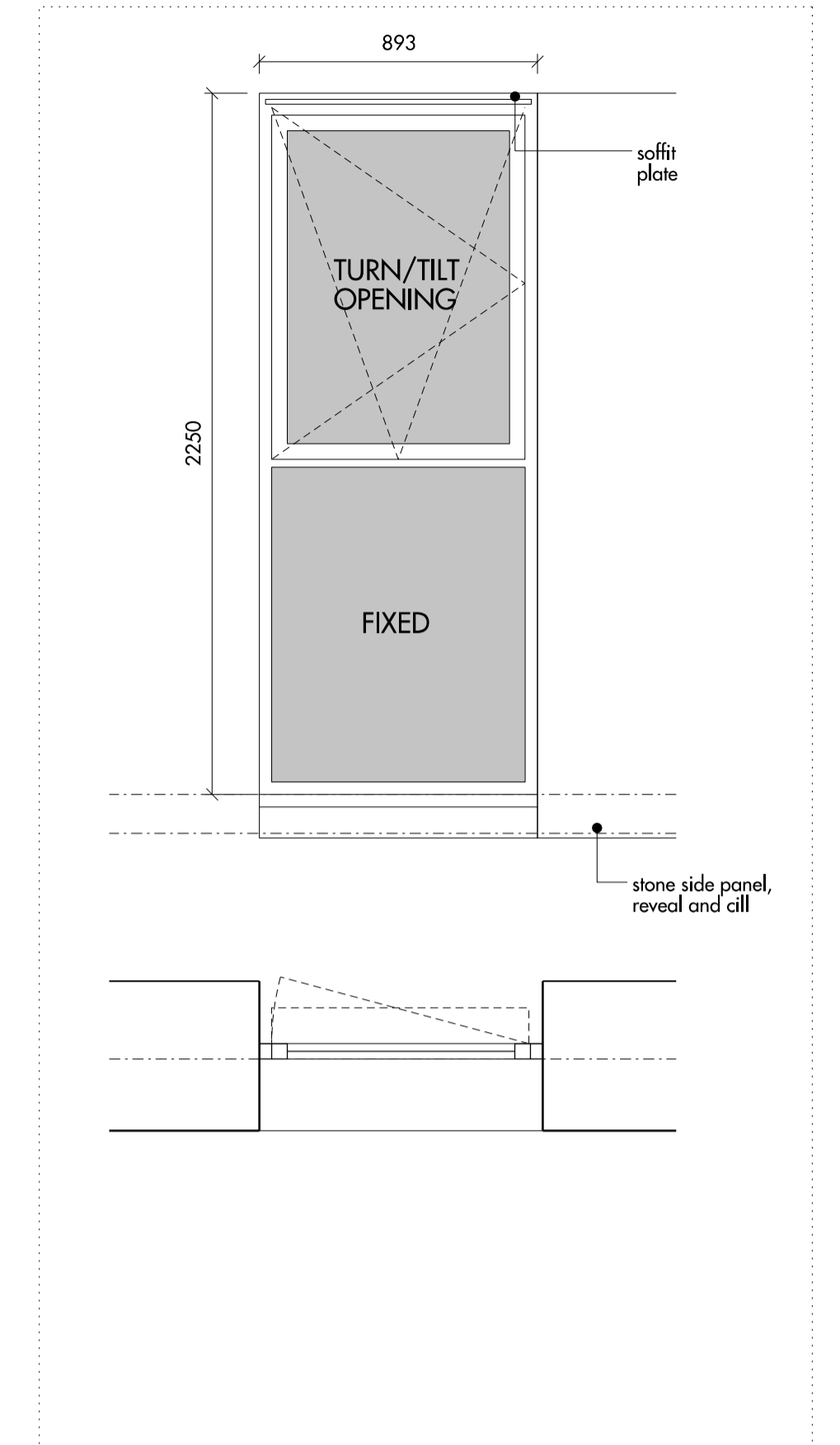

04 WIN - 603

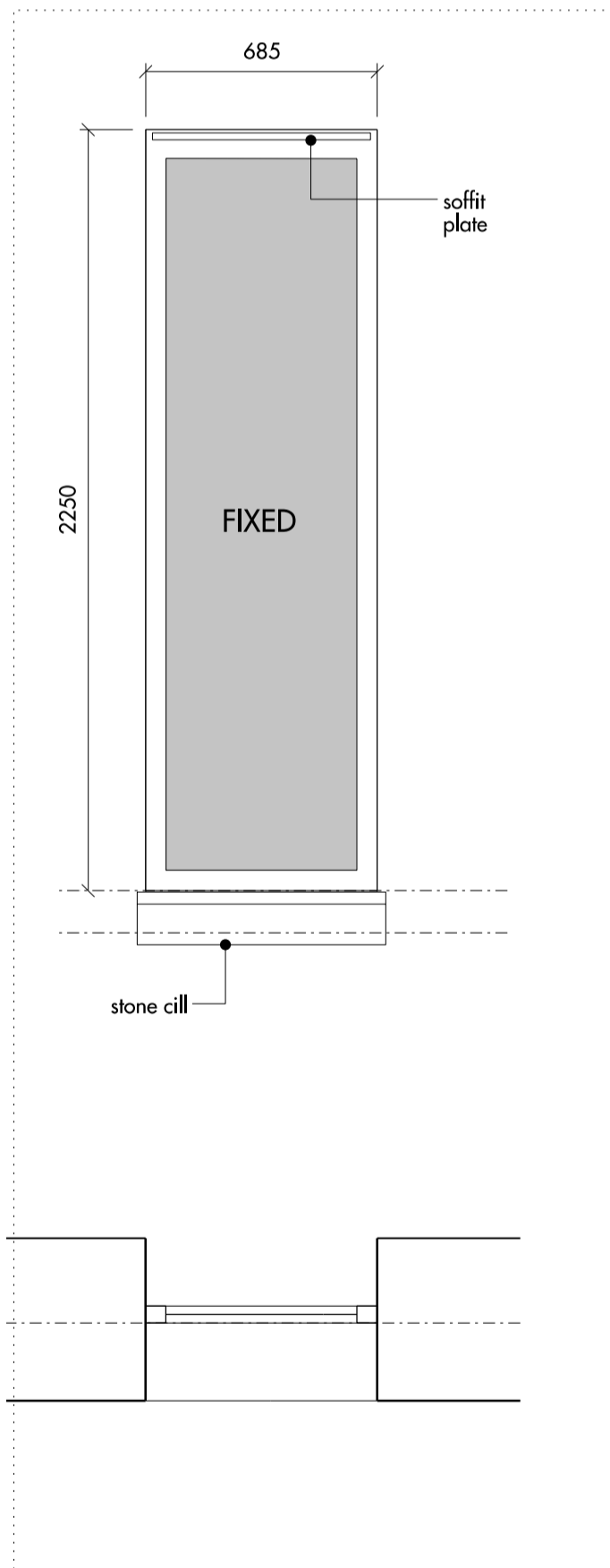

05 WIN - 604

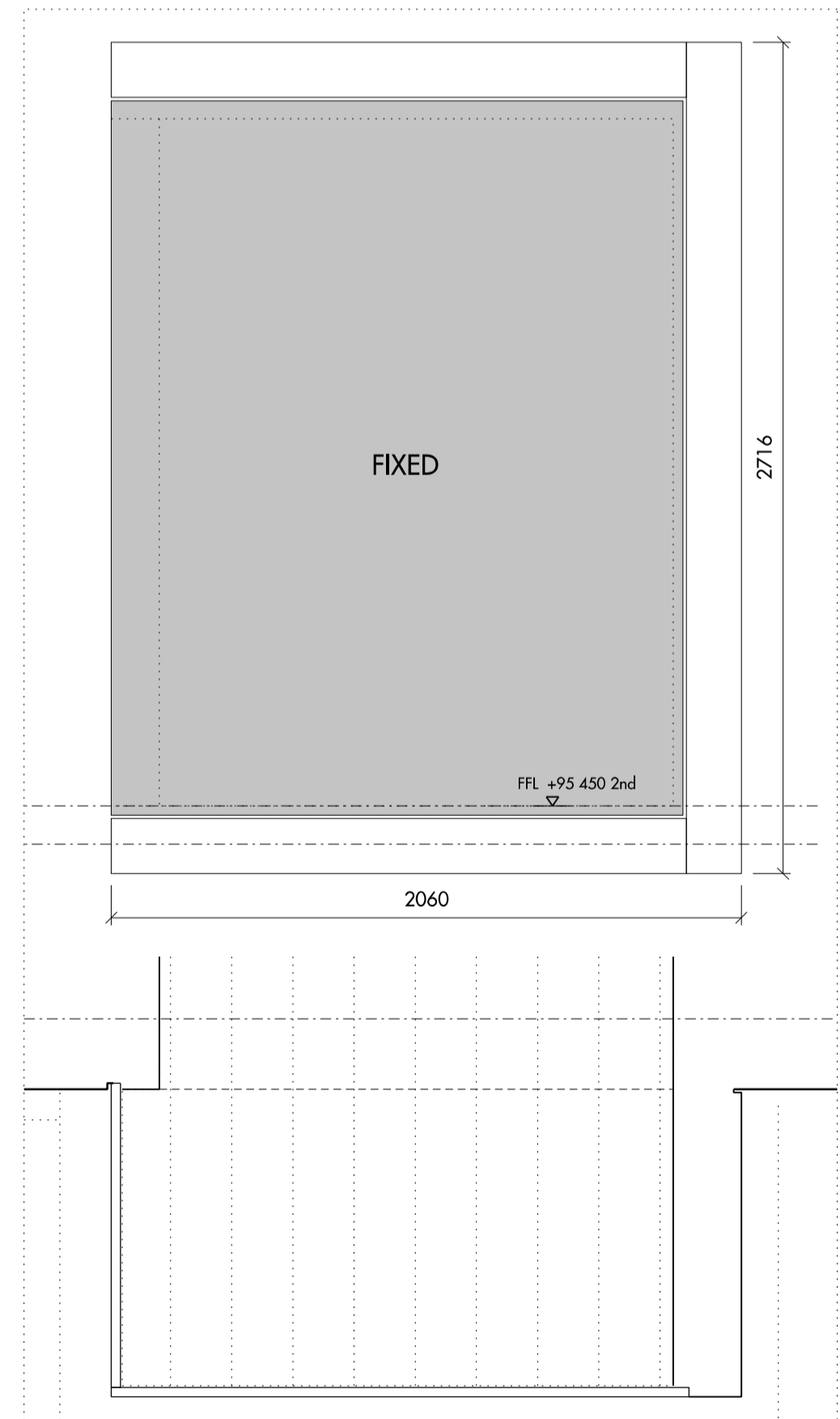

06 WIN - 605

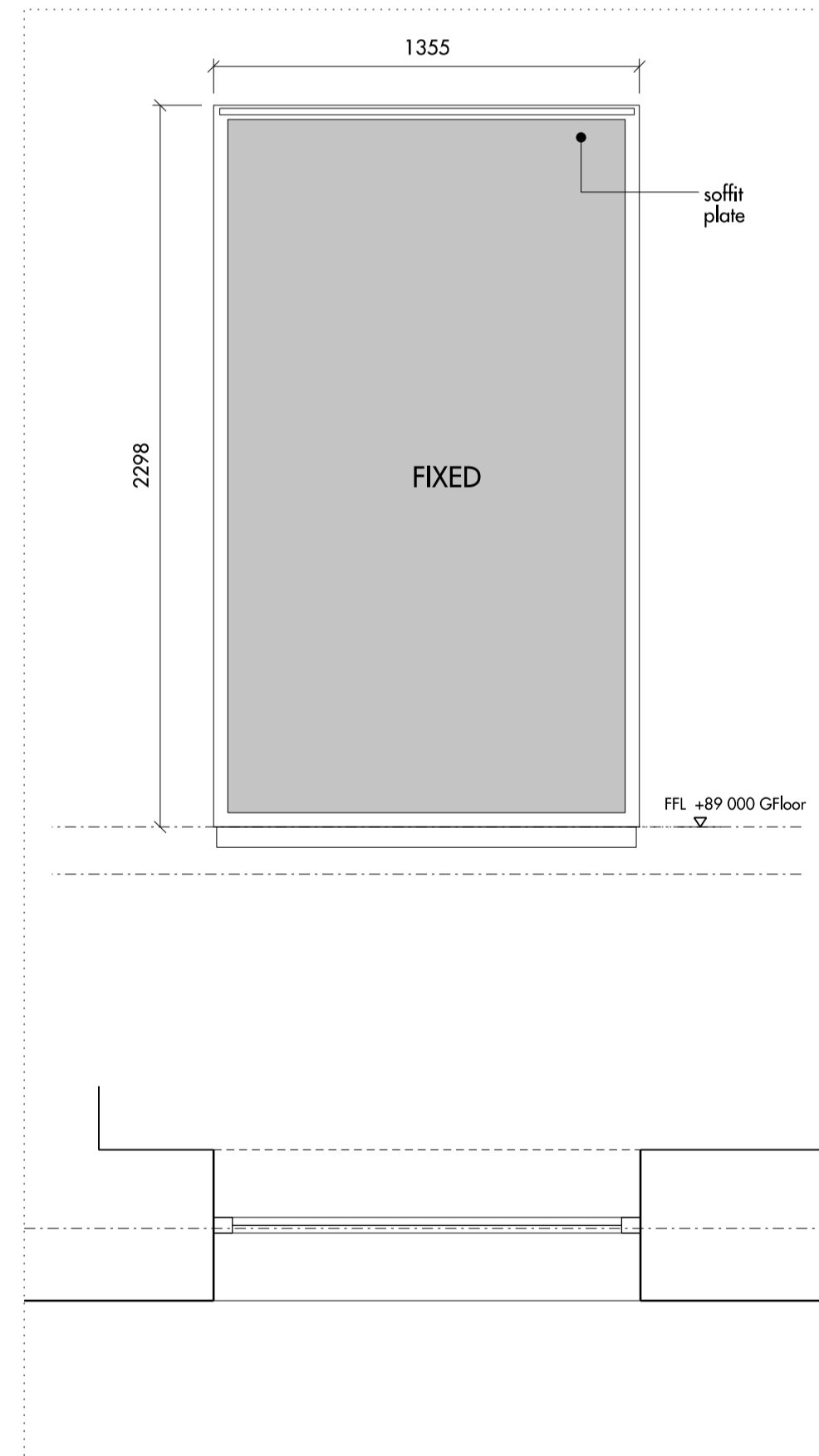

07 WIN - 606

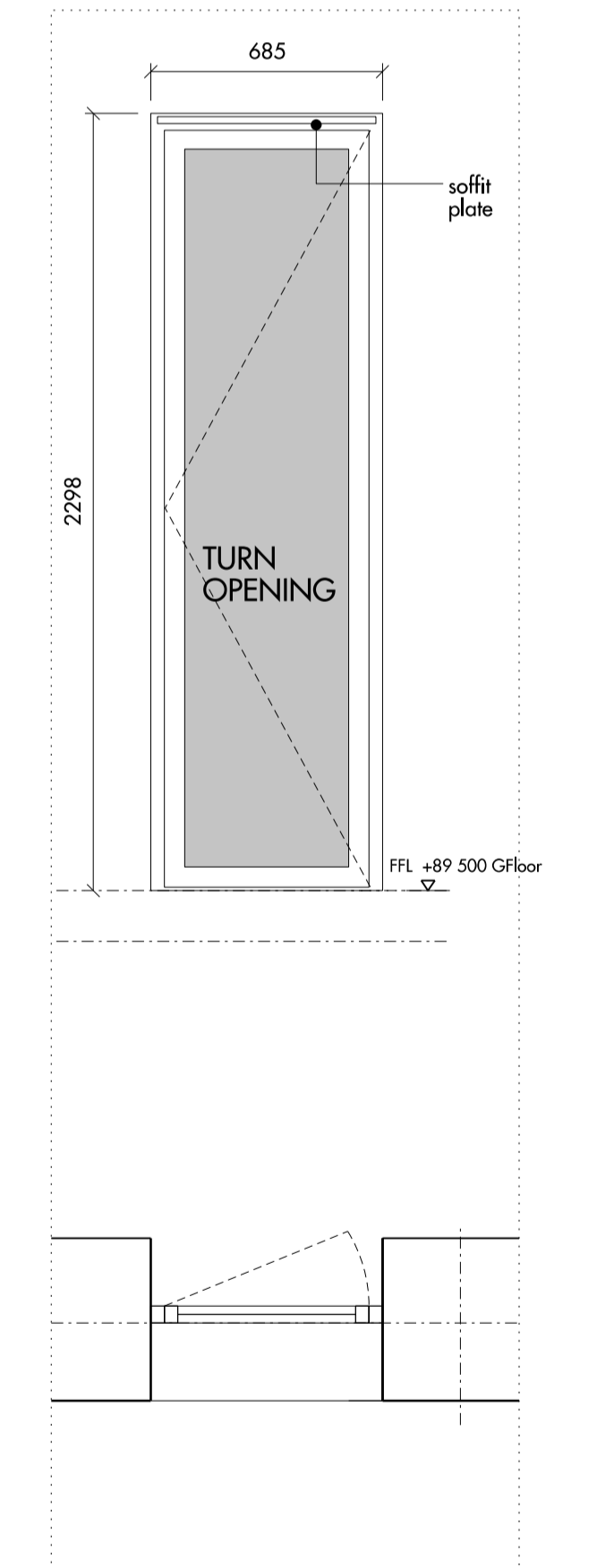

08 WIN - 607

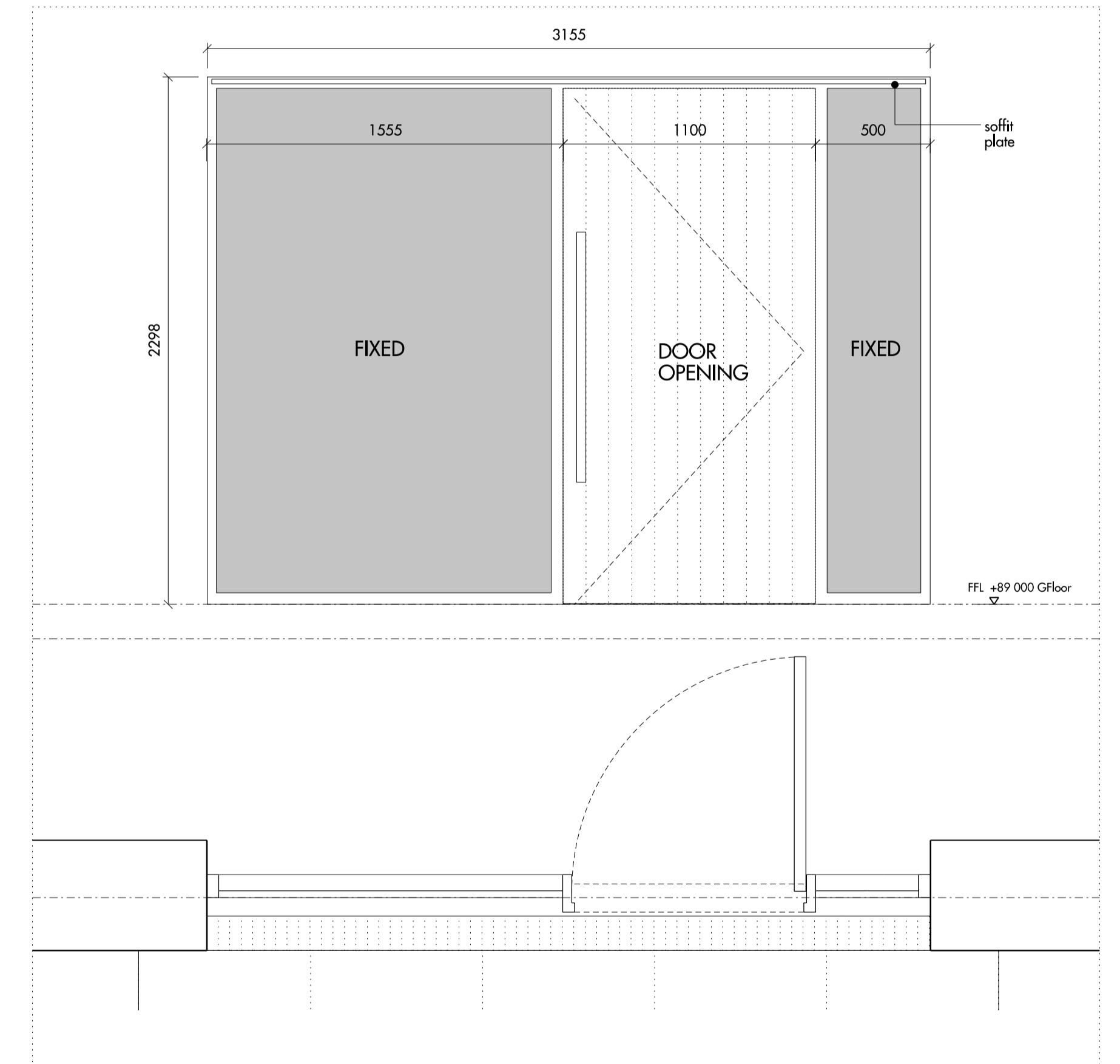

09 EDR - 600

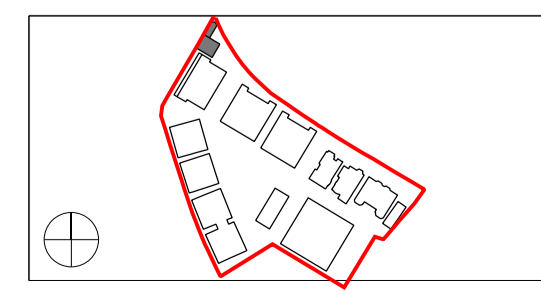

Do not scale from this drawing. Use figured dimensions only. Figured dimensions are in millimetres. All levels are in metres. All dimensions and levels shall be verified on site before proceeding with works. Detailed site survey to be carried out to verify positions and level relationships with site features and ordnance survey. Boundaries are indicative only and are to be verified by others. The architect must be notified of any discrepancy. Where building components are described in the specification as contractor designed, "construction" information relating to those components on this drawing represents design intent only.

REV	DATE	DESCRIPTION	CKD	REV	DATE	DESCRIPTION	CKD
T1	24.07.2015	ISSUED FOR TENDER	NR				

Allies and Morrison
 85 Southwark Street
 London SE1 0HX
 telephone 020 7921 0100
 facsimile 020 7921 0101
 email info@alliesandmorrison.co.uk
 A&M JOB NO: 809

KIDDERPORE AVENUE: BLOCK K2
 WINDOW TYPES
 EXTERNAL WALLS
 809_06_21_400
 SCALE 1:200 @A1 1:400 @A3