

General note: For Gate + Steps to Christchurch passage see specifications clause G30-200. To be read in conjunction with SE drawings + specifications.

Improvements to existing railing as part of separate condition works - extend railings over arches

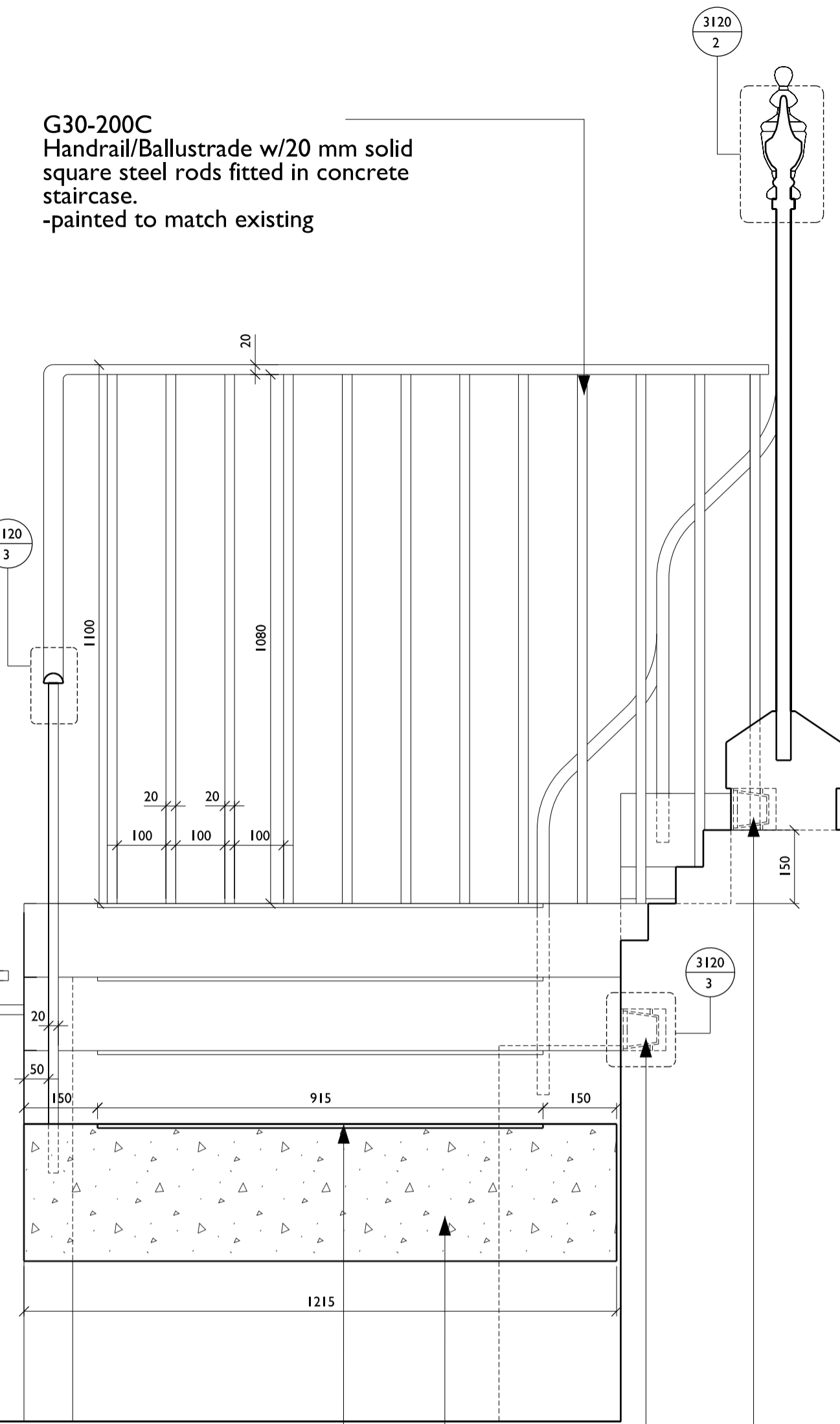
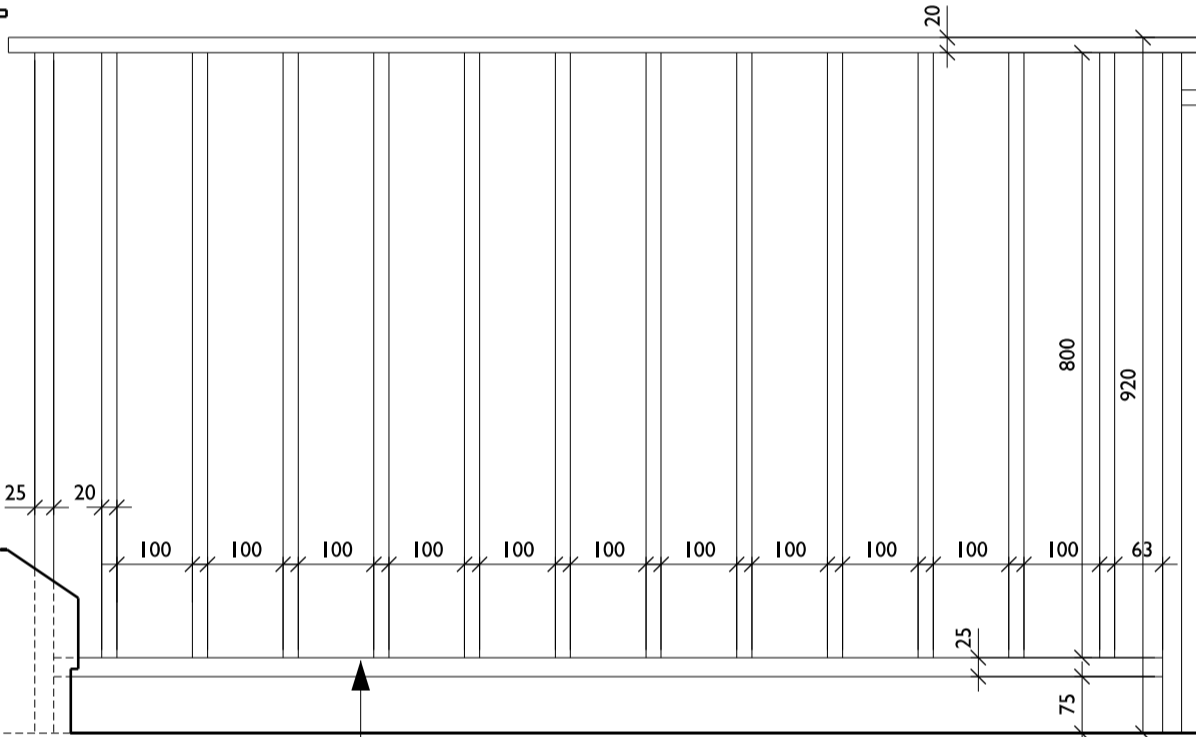
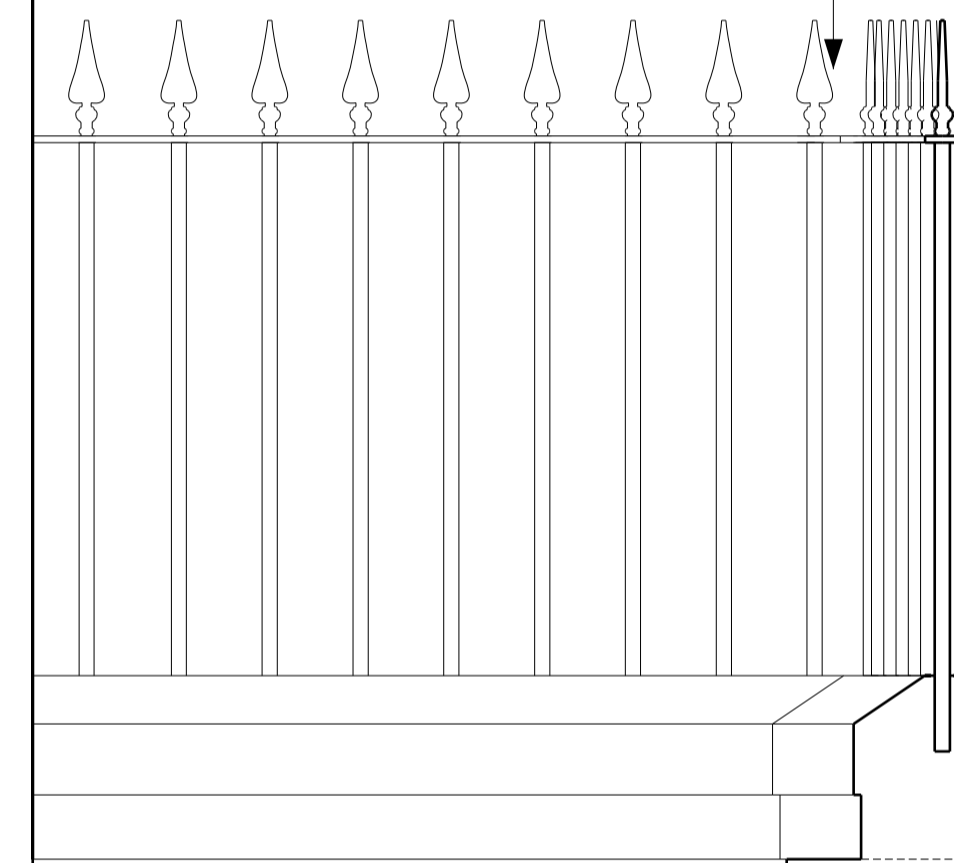

- G30-200B Stair nosing/ Slip-resistant strip
- G30-200B New in situ concrete staircase with exposed aggregate finish to treads
- G50-300 New recessed wall luminaires with LED lamps to steps in brick retaining wall
- G30-200D New steel railing to separate school entrance from private flats 20mm square steel rods / balustrade - painted to match existing

G30-200C Handrail/Balustrade w/20 mm solid square steel rods fitted in concrete staircase. -painted to match existing

1 Passage Stair -Section looking South  
3120 Scale 1:10 / 1:20

5 Step detail  
3120 Scale 1:10 / 1:20

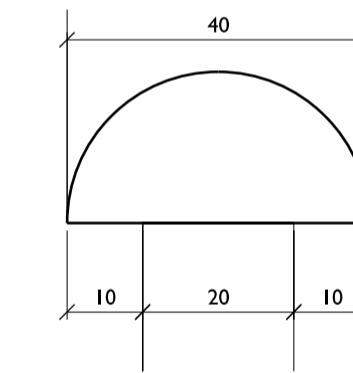

3 Handrailing detail  
3120 Scale 1:1 / 1:2

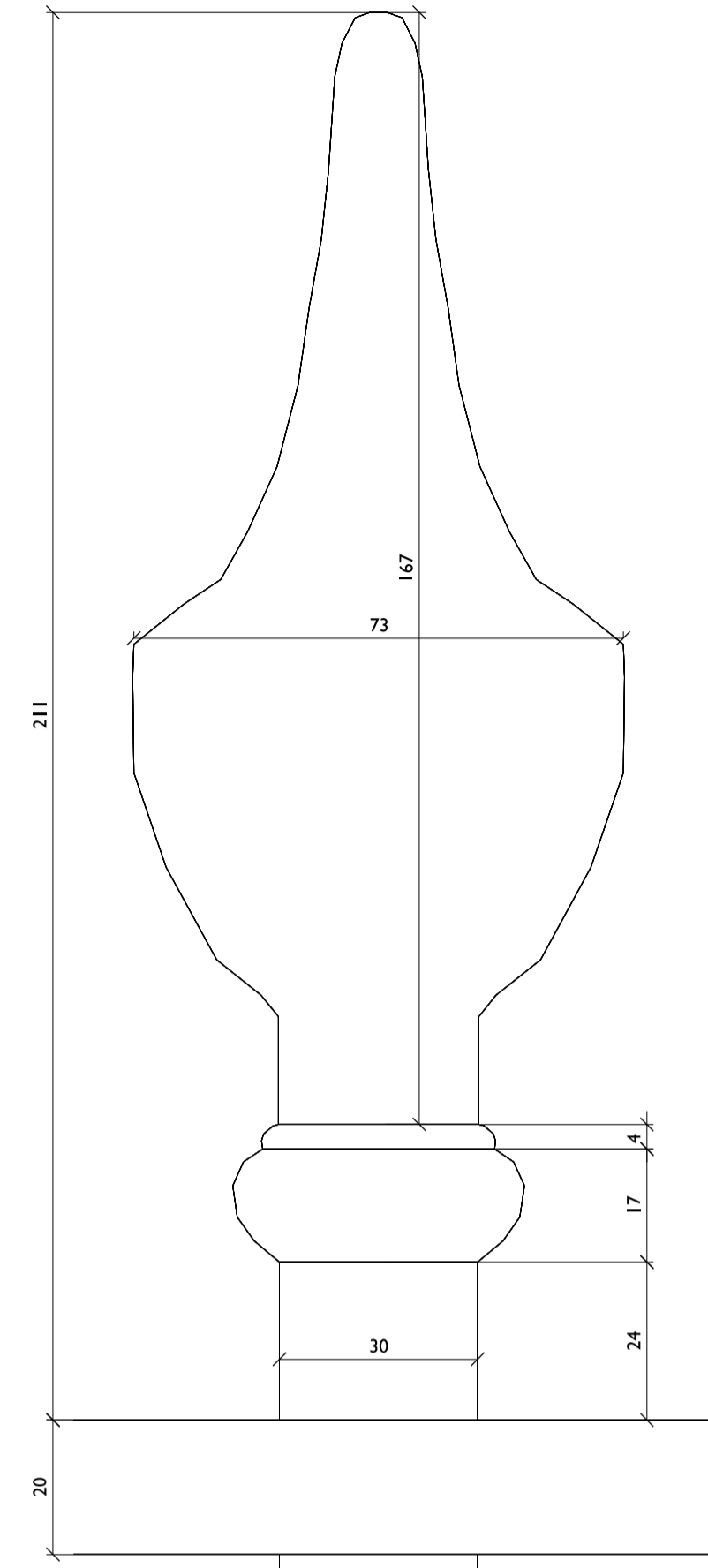

2 Railing finial detail  
3120 Scale 1:1 / 1:2

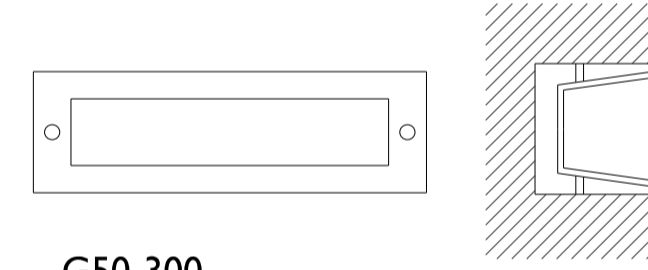

G50-300 Recessed wall luminaires with LED lamps in back of brick piers

4 Recessed wall luminaires detail  
3120 Scale 1:5 / 1:10

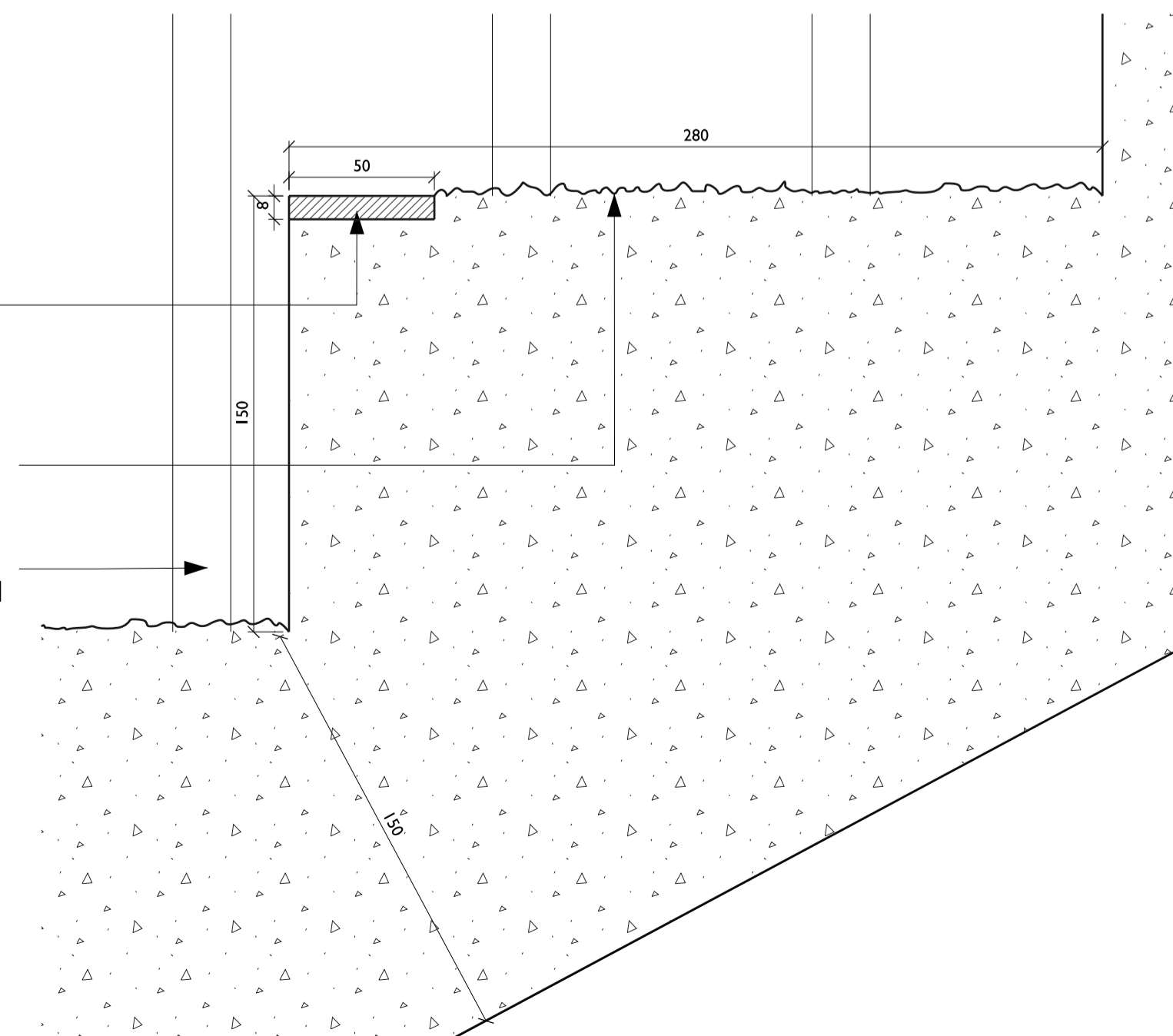

- G30-200B Stair nosing/ Slip-resistant strip
- G30-200B New in situ concrete staircase with exposed aggregate finish to treads
- G30-200C Handrail/Balustrade w/20 mm solid square steel rods fitted in concrete staircase. -painted to match existing

