

I	Ground Floor Proposed Floor Finishes
1250	Scale 1:100/200

Note:
 - refer to Refurbishment Schedule for details of scope of individual room refurb
 - Floor finishes to be renewed in all internal areas throughout the school with a replacement of the existing type of material in accordance with the specification (except where shown otherwise)
 - see DWG 2200 Detail 2 for Hall timber floor build up - Insulate between joists
 - allow for setting in of barrier matting into flooring substrate

Note:
 - for details of new floor finishes to Work Section 6 (Northernmost Block) and Work Section 8 (First Floor) refer to Schedules 6 and 8.

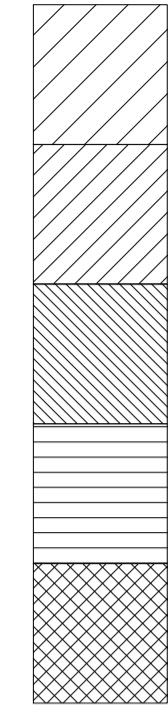

- Carpet - Spec D10/225 (to South Wing Circulation Spaces)
- Carpet - Spec D10/200
- Rubber Floor - Spec D10/100 (140 WCs)
- Timber Hall Floor - Spec D10/500 (refer to Detail 2 DWG 2200)
- Barrier Carpet - Spec D10/300

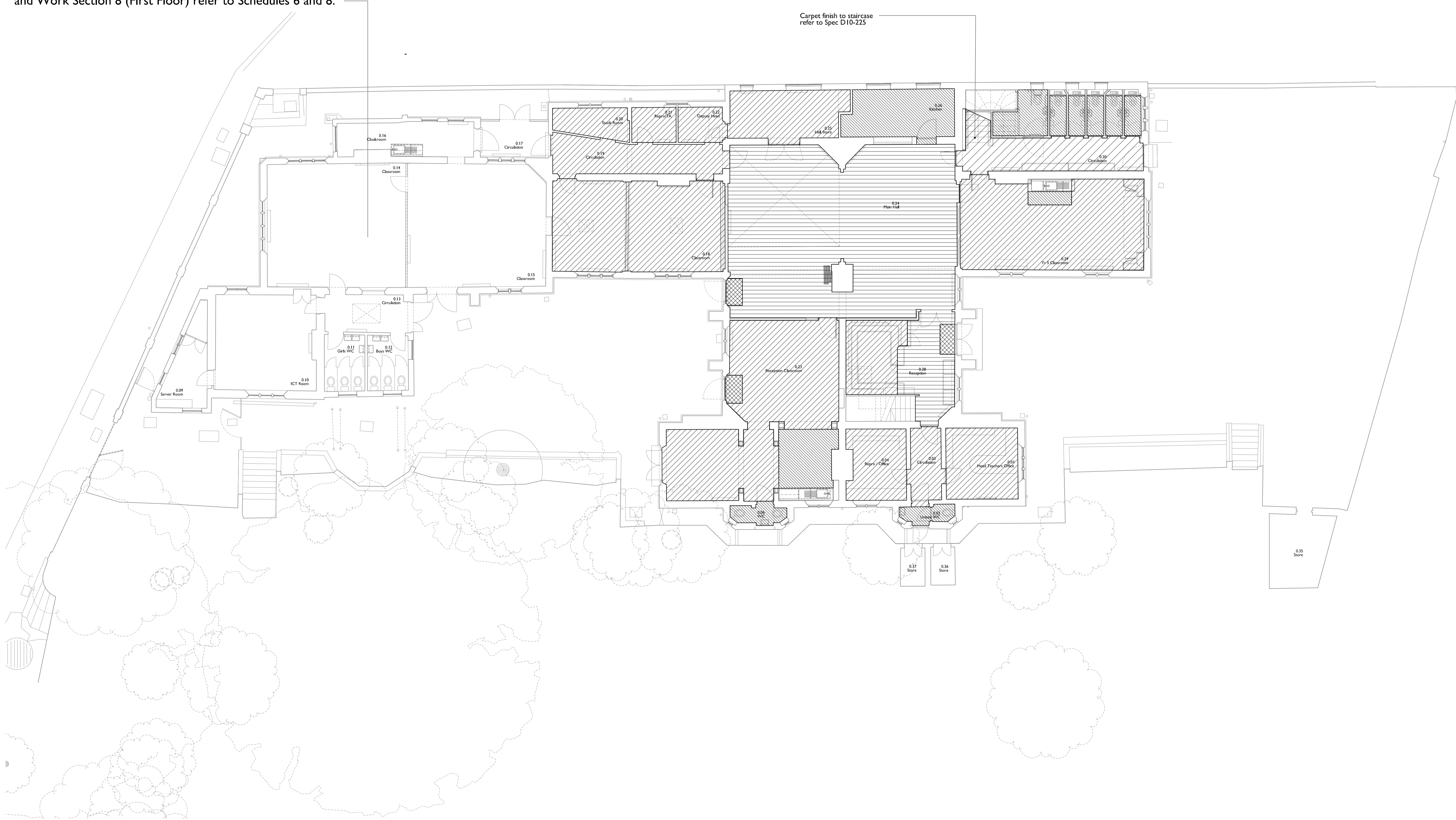

Project
CHRIST CHURCH PRIMARY SCHOOL
 Christchurch Hill, London NW3 1JH

GROUND FLOOR - FLOOR FINISHES PLAN - PROPOSED

Project Number
1250

Status
Construction E

Date
17.06.15

Revision Notes
 Write a description of what has changed here and here if needed

STUDIO SULLINAN AND ARCHITECTS LTD. © 25 Hatton Garden London EC1N 8BQ UK
 t: +44 (0) 20 7033 8788
 e: team@scabal.net

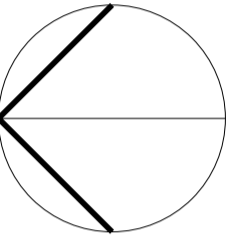

COPYRIGHT ©

All dimensions to be checked on site prior to commencement of work
 Discrepancies between drawings and information to be referred to CA without delay