

EXISTING SECTION A

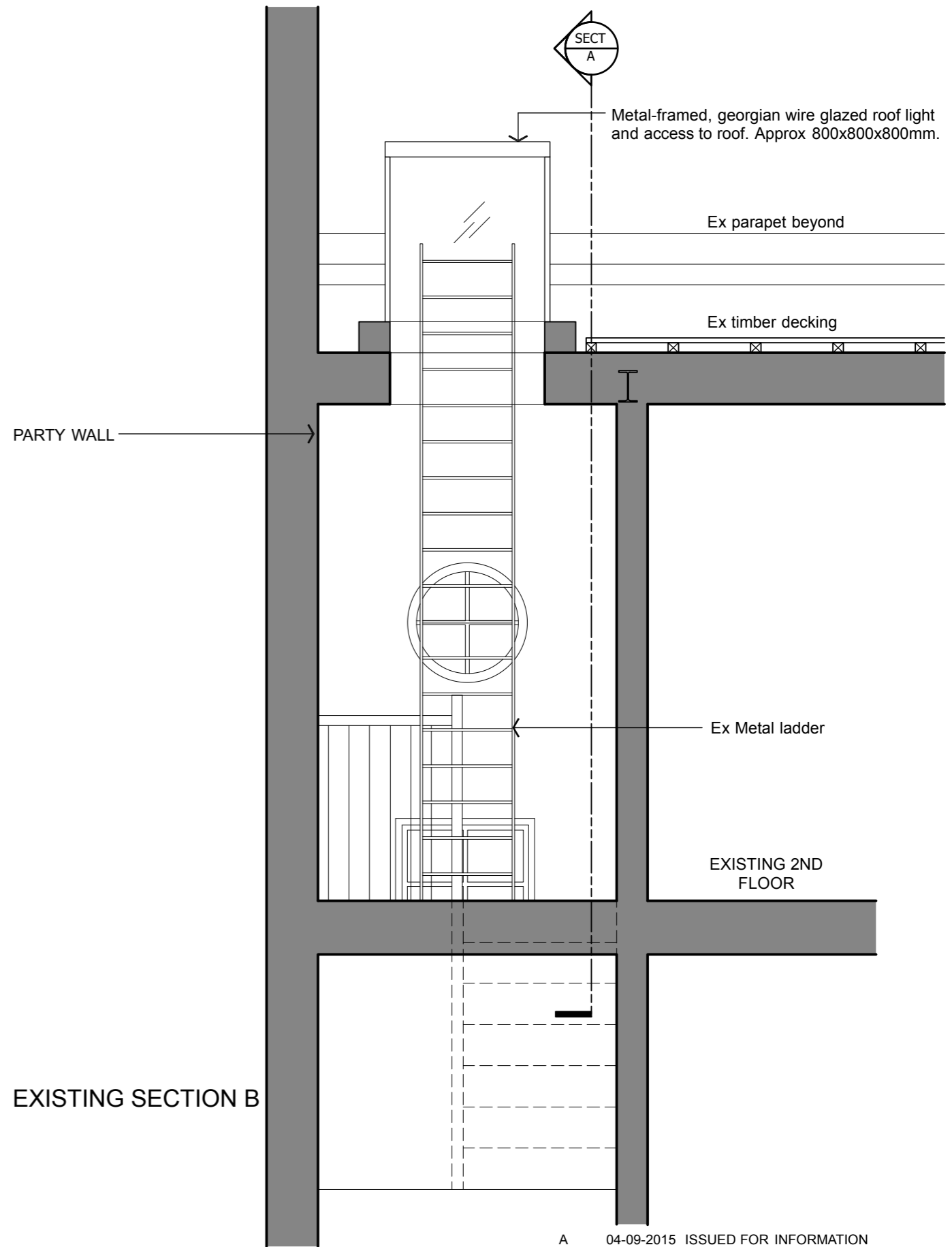

EXISTING SECTION B

A 04-09-2015 ISSUED FOR INFORMATION

revision	date	notes

and-associates limited
architecture and design

client
JENKIN

drawing no
3476-306-09

revision
A

LINTON HOUSE
39 Highgate Road, London. NW5 1RS
T +44 (0) 20 7284 5894 F +44 (0) 20 7284 5889
studio@aleximarmot.com

project
157 ARLINGTON ROAD, LONDON

date
04-09-2015

scale
1:25 @A3

drawing title
EXISTING ROOFLIGHT SECTIONS

drawn
LP

checked
DJ



© this drawing is copyright of and-associates limited, and is not to be reproduced or copied without the written permission of and-associates limited. Do not scale from drawing, all dimensions to be checked on site. If in doubt, ask.