

AREA KEY

| | |
|---------------------|--------------|
| RESIDENTIAL | [Light Blue] |
| RETAIL | [Yellow] |
| PLANT | [Green] |
| CIRCULATION | [Grey] |
| CAR PARK | [Light Blue] |
| BACK OF HOUSE | [Dark Grey] |
| OFFICE | [Brown] |
| RESIDENTIAL AMENITY | [Purple] |

KEY

| | |
|--|--------------|
| DEMOLITION | [Hatched] |
| EXISTING STRUCTURE | [Black] |
| PARTITION | [Dark Grey] |
| PROPOSED STRUCTURE | [Light Blue] |
| BUILDERSWORK OPENING THROUGH EXISTING SLAB | [Blue] |
| BUILDERSWORK OPENING THROUGH UPPER AND LOWER SLAB (USED ON 1ST FLOOR ONLY) | [Blue] |
| BUILDERSWORK OPENING THROUGH UPPER SLAB (USED ON 1ST FLOOR ONLY) | [Blue] |

Survey Information Prepared by Plowman Craven.
 Original Drawing: 25411F-14 A-Level 14
 Drawing is indicative and reflects typical details only. Location and sizing of internal structural openings vary on floors.

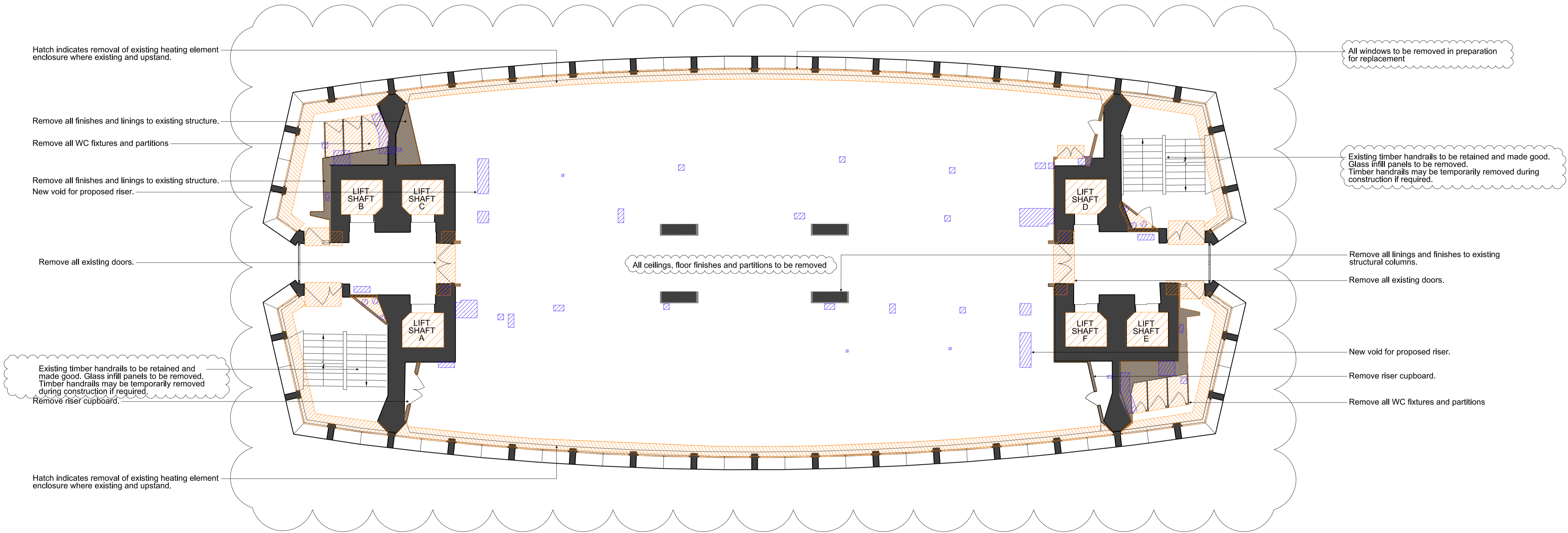

NOTE:
 Existing lift cars to be removed.
 All blocked doors to be opened up.
 All non-original floor finishes to be removed.

1 TYPICAL FLOOR PLAN DEMOLITIONS 1:100

REVISIONS

| REV | DATE | DESCRIPTION |
|-----|----------|--|
| PL3 | AUG 15 | PLANNING ISSUE: Escape stair note updated. Revision clouds from PL2 retained to clarify changes since PL1. |
| PL2 | FEB 15 | PLANNING ISSUE: Internal scope and notation of demolition updated, including updates to escape stair demo. Existing structure removed and builderswork openings added. |
| PL1 | 01.04.13 | PLANNING ISSUE |

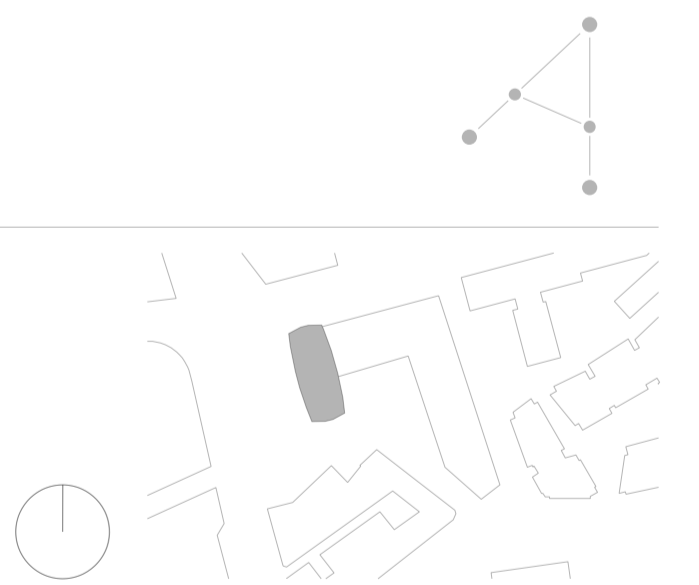

STATUS: **PLANNING**

CONRAN+ PARTNERS
 Architects Designers
 22 Shad Thames London SE1 2YU
 T: 020 7403 8899
 cp@conran.com www.conranandpartners.com

JOB: **Centre Point**
 101-103 New Oxford Street
 London, WC1A 1DD

TITLE: **EXISTING TYPICAL FLOOR PLAN CENTRE POINT TOWER**

| | | | | | | | |
|---------|----|-------|-------|-------|-----------|----------|--------|
| DRAWN | AJ | JOB # | 552 | DRG # | 19306-CPT | REV | PL3 |
| CHECKED | NE | SCALE | 1:100 | SIZE | A1 | DATE | APR13 |
| | | | | | | REV DATE | AUG 15 |

