

Opening above door to be fitted with wire mesh insert - powdercoated black to upper section only



New external door painted 'Black' to match adjacent doors - see photo below

Wire mesh inserts to be powdercoated white - see image of proposed mesh below

Existing door frame surround to be painted white

01

Proposed Rear Elevation  
1:50@A3

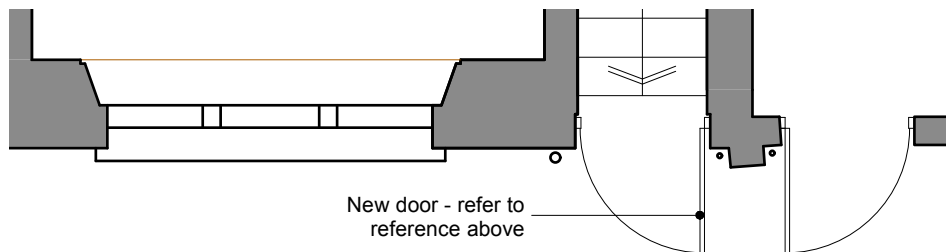

New door - refer to reference above

02

Plan of Rear Elevation  
1:50@A3



05

Existing Image of  
Rear Elevation

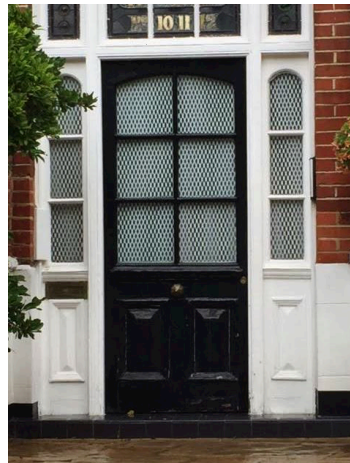

06

Proposed Image of  
Rear Door with Mesh

03

Section B  
1:50@A3

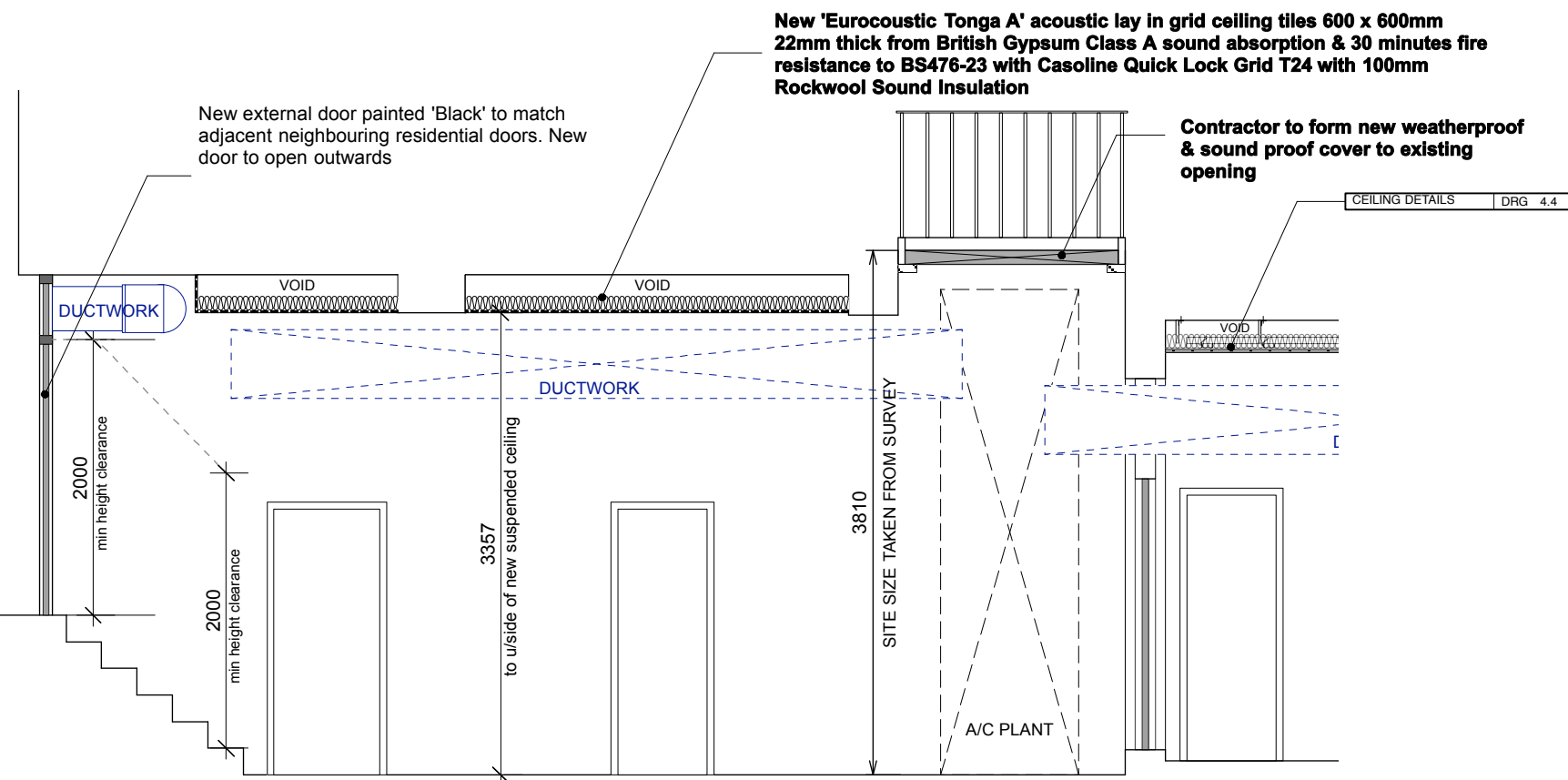

New external door painted 'Black' to match adjacent neighbouring residential doors. New door to open outwards

New 'Eurocoustic Tonga A' acoustic lay in grid ceiling tiles 600 x 600mm 22mm thick from British Gypsum Class A sound absorption & 30 minutes fire resistance to BS476-23 with Casoline Quick Lock Grid T24 with 100mm Rockwool Sound Insulation

Contractor to form new weatherproof & sound proof cover to existing opening

CEILING DETAILS DRG 4.4

Asbestos confirmed within to this area - PM to confirm works to this area

New stacked A/C Plant location - A/C consultant to confirm size & specification

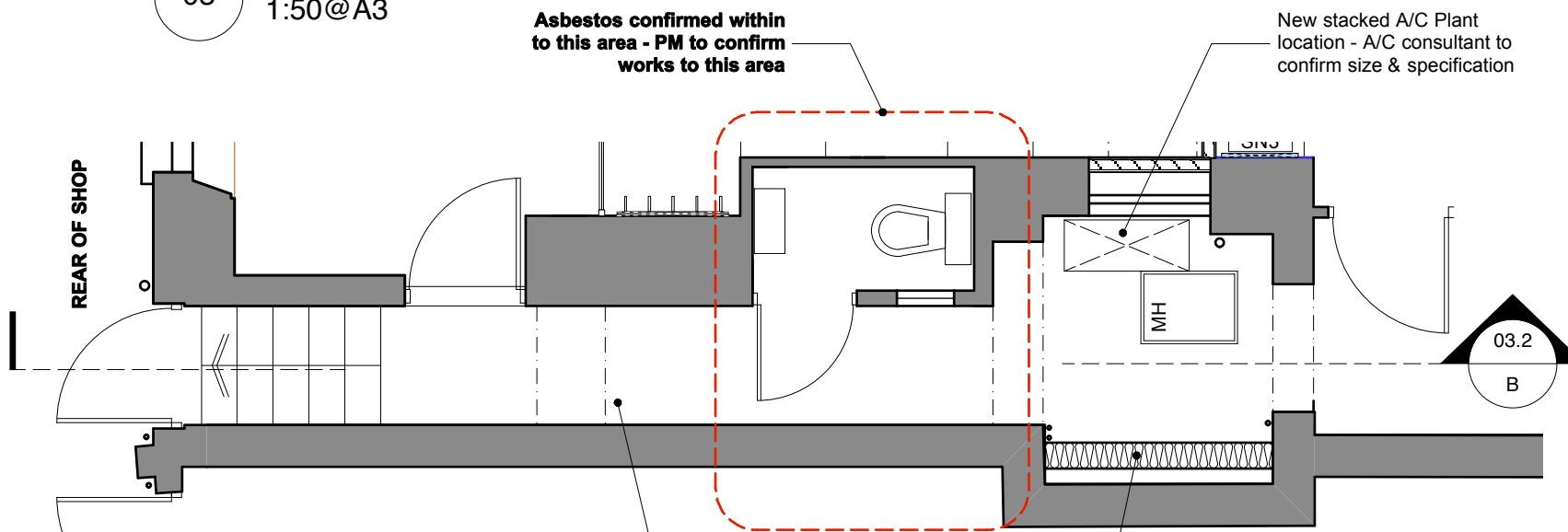

04

Plan of Corridor  
1:50@A3

Refer to drawing 558.03.3 RCP for ceiling specification read in conjunction with the ceiling details 558.04.4

Contractor to install sound insulation & board over with plywood & Soundblock board to form new sound proof demise to adjacent property

B 01.09.15 Louvred door omitted & replaced with new hardwood door

A 21.07.15 D5 CONSTRUCTION ISSUE

DESCRIPTION

Proposed Rear Elevation

CLIENT  
Barkers

PROJECT  
HAMPSTEAD

ADDRESS  
57 Southend Road, NW3

JOB No. DWG No. REV.

558 03.3 B

DATE STATUS  
APR 2015 CONSTRUCTION

DWN BY  
EC  
SCALE  
1:50@ A3

PATH

Unit 5, 7 Wenlock Road, London N1 7SL  
T +44 (0)20 7253 9005 F +44 (0)20 72539004  
www.pathdesign.co.uk info@pathdesign.co.uk

THIS DRAWING IS FOR DESIGN INTENT PURPOSES ONLY. DO NOT SCALE THIS DRAWING  
• This drawing is issued on condition that it is not copied or disclosed to any other unauthorised person without the prior consent of PATH DESIGN.  
• Contractors should provide their own setting out drawings for reference by PATH DESIGN.  
• This drawing is the property of PATH DESIGN and copyright is reserved by them.  
• All structural works are to be detailed / confirmed and approved by structural engineer.  
• All dimensions to be verified on site prior to work commencing.