

Notes:

1. This drawing is for the purpose of Planning Application only. It is not to be used for construction.
2. Copyright of this drawing is the property of Francis Hur Architecture Ltd (FHA) and may not be reproduced without their permission.
3. Do not scale from this drawing. Written dimensions to be used in preference to scaled dimensions at all times. Dimensions marked with +/- are indicatively approximate only. All dimensions and levels to be verified on site and any discrepancies to be reported to FHA.
4. Drawings are based on the assumption that adequate load bearing capacity stratum will be encountered at the depths indicated. If this is found not to be the case, the depths must be increased to the satisfaction of the building inspector and building regulation requirements.

Rev:	Date:	Description:

Status:
Planning Application

Project:
King William IV Public House

Project Address:
 77 Hampstead High Street
 London, NW3 1RE

Drawing Title:
Site / Roof Plan

Project no: 1523	Drawn by: FH	Date: 1 Sep 2015
---------------------	-----------------	---------------------

Page size: A3	Page no: 1 of 7	Drawing no. A-001
------------------	--------------------	-----------------------------

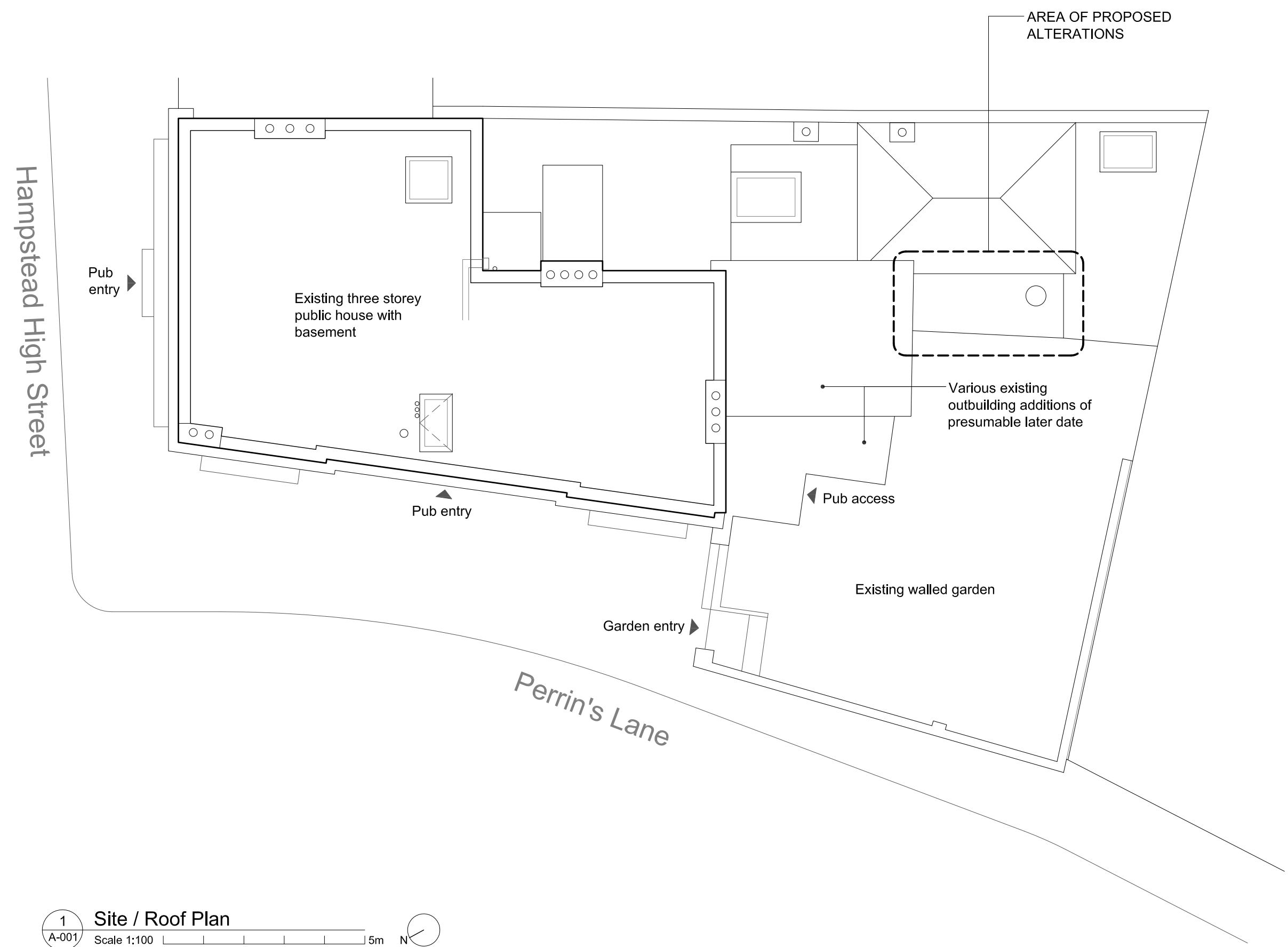

1 Site / Roof Plan
 A-001 Scale 1:100 5m N