

PROPOSED ANTENNA DETAILS								
ID No.	ITEM	TYPE / SIZE	BEARING	MEAN HEIGHT	FEEDER LENGTH	FEEDER TYPE	No. OF FEEDERS	LNA
351612	A1	JAYBEAM 75867XX	0°ETN	34.1m	50.0m	LDF5-50	1	1
TBC	A2	TRIMBLE BULLET III GPS	0°ETN	22.9m	2.0m	CNT400	1	N/A

©2010 Arqiva  
 All rights reserved. No part of this publication may be reproduced, stored in a retrieval system or transmitted in any form or by any means (Electronic, Mechanical, Photocopying, Recording or otherwise), without the prior written consent of the Company.

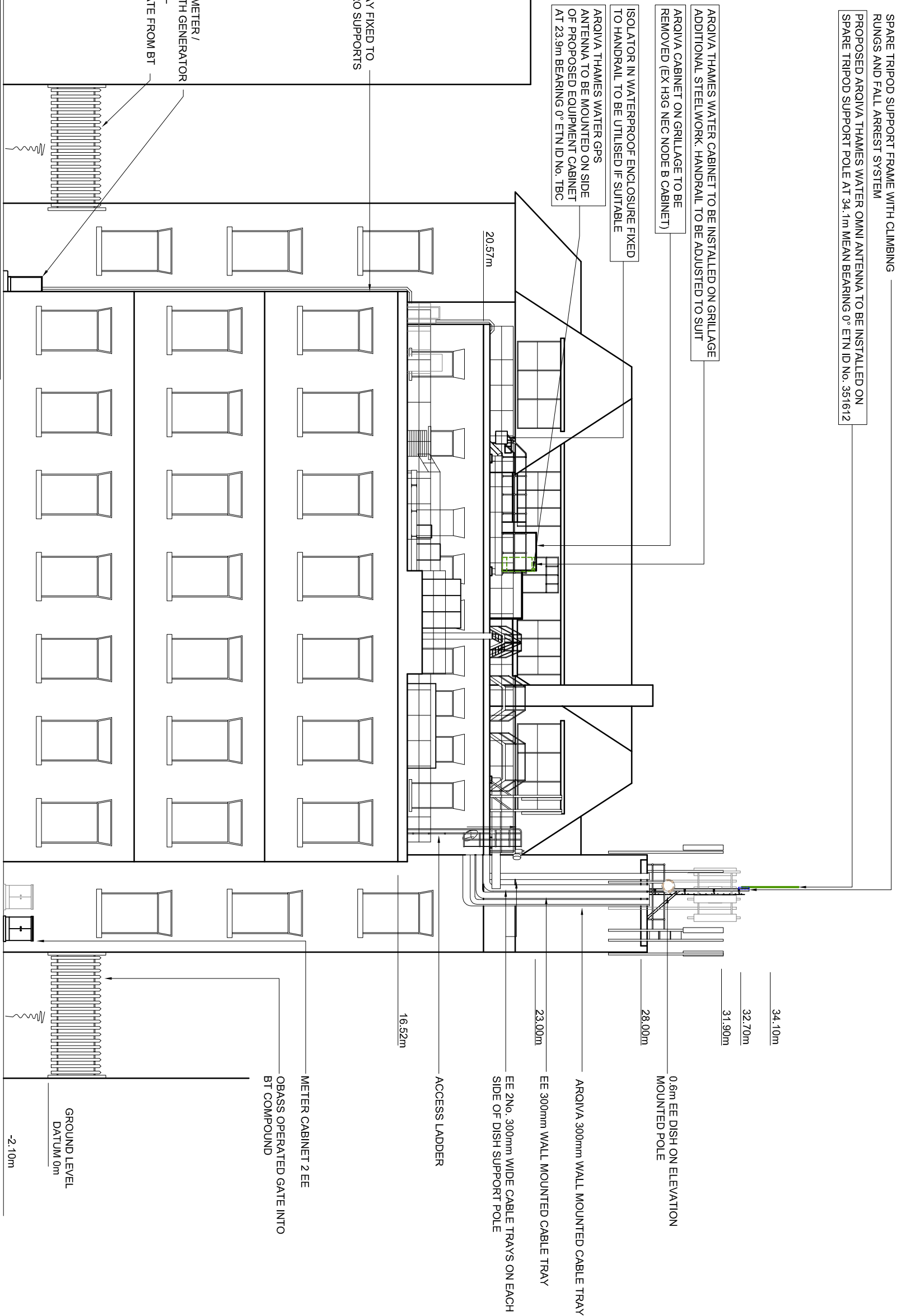

NOTE: PROPOSED ARQIVA THAMES WATER FEEDER TO USE EXISTING CABLE MANAGEMENT ALONG MAIN ROOF LEVEL FROM EXISTING GRILLAGE. PROPOSED FEEDER IS THEN TO BE ROUTED ON EXISTING VERTICAL MOUNTED CABLE TRAY FIXED TO PLANT ROOM WALL TO UPPER ROOF LEVEL

NOTE: PROPOSED ARQIVA THAMES WATER POWER TO BE TAKEN FROM ARQIVA METER CABINET 1 AT GROUND LEVEL. CURRENT 100A MCB (MARKED 3) TO BE REUSED. SUB MAIN CABLE (4x25mm) TO 125A ISOLATOR IN WEATHERPROOF ENCLOSURE TO BE INSPECTED AND TESTED AND IF SUITABLE REUSED. INSTALL NEW SUB MAIN CABLE TO PROPOSED CABINET LOCATION FROM ISOLATOR LOCATION. IF NEW CABLE IS REQUIRED IT IS TO BE ROUTED UTILISING THE SAME ROUTE AS CURRENT CABLE AND IS TO BE CLIPPED TO CURRENT STEELWORK

NOTE: PROPOSED ARQIVA THAMES WATER BT SUPPLY TO BE OBTAINED FROM TELEPHONE EXCHANGE. BT TO CONFIRM ROUTE TO PROPOSED EQUIPMENT CABINET LOCATION

**SOUTH WEST ELEVATION**

FEINT DETAILS INDICATE LOCATIONS RESERVED FOR OTHER PROPOSALS WHICH MAY BE THE SUBJECT OF SEPARATE APPLICATIONS

<p>BT SKYLINE No. <b>NW0001</b></p>		<p>CONTRACTOR:- HF COMMS          CONSULTANT:- HARLEQUIN GROUP          INNOVATION CENTRE          MADSTONE ROAD          CHATHAM, KENT          ME5 9FD</p>		<p>ENGINEER:-          BREN ANIN          01634 661562          B.AMIN@HARLEQUIN-GROUP.COM</p>		<p>DRAWING          MANAGER:-          PAUL FERGUSON          01414 299361          PAUL.FERGUSON@HFCOMMS.COM</p>	
PROJ No	143050	HAR	PROJ No	167816	HAR		
8.A	PLANNING ISSUE		8	PLANNING			
PROJ No	140424	3/08/13DALCGF	PROJ No	140424	24/03/14		
7	MASTER UPDATE	PD HF	7	MASTER UPDATE	24/03/14		
PROJ No	140424	09/12/13	6	MASTER UPDATE	09/12/13		
6	MASTER UPDATE	PD JW	6	MASTER UPDATE	09/12/13		
PROJ No	N/A	20/10/13	5	MASTER UPDATE	20/10/13		
5	MASTER UPDATE	SH AQ	5	MASTER UPDATE	20/10/13		
ISS	REVISION	DATE	ISS	REVISION	DATE		

Crawley Court, Winchester, Hampshire, SO21 20A  
 Tel. 01962 823434. Fax. 01962 823278

**arqiva**

SITE No **166642**  
 HAMPSTEAD TE  
 FINCHLEY ROAD  
 CAMDEN  
 GREATER LONDON 3  
 NW3 6EX

NGR	TQ 25930 85170
OS GRID	525930 185170
TITLE	ARQIVA THAMES WATER
ELEVATION	PROPOSED
SCALE	1:200
DRAWN	IM 01/06/11
APPROVED	CGP 31/07/15
DRG No.	Sheet 1 of 1 Rev
	<b>166642-01-150-MD008 8.A</b>