

DO NOT SCALE OFF THIS DRAWING
ALL AMBIGUITIES OR DISCREPANCIES
TO BE REPORTED TO ARCHITECT
BEFORE COMMENCING

Notes

Revisions

Date:	Rev:	Details:
24/08/15	A	Site boundary line revised.

STUDIO MACKERETH
ARCHITECTS
7B ST PANCRAS WAY
LONDON
NW1 0PB
TELEPHONE + 4 4 (0)20 7042 8335
EMAIL: INFO@STUDIOMACKERETH.COM

Project
30 Leighton Road

Drawing Title
Existing Site Plan

Scale:	Creation Date:	Status:
1:200 @ A3	April 2015	Plan

Project No.:	Drawing No.:	Revision:
015	010	A

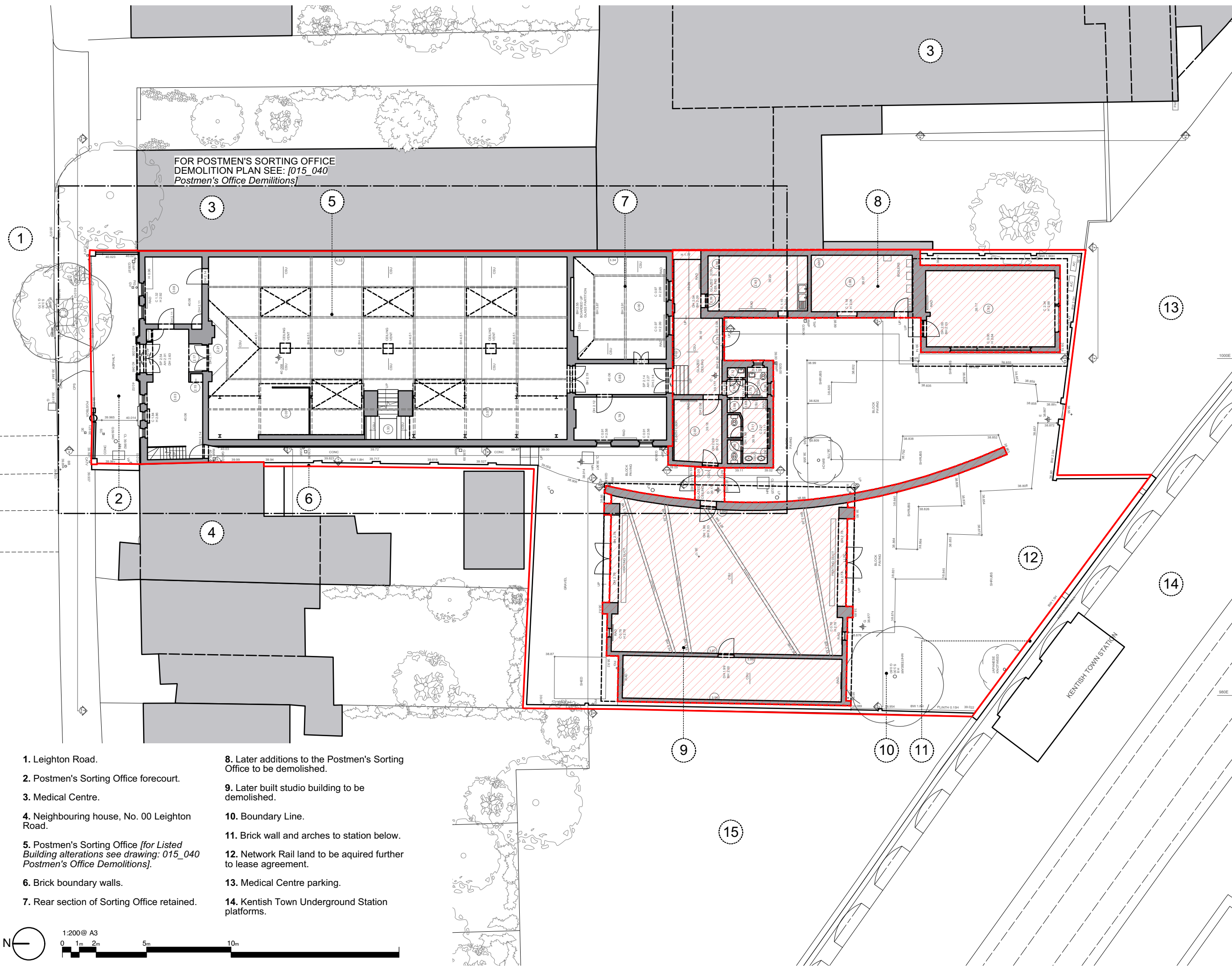

FOR POSTMEN'S SORTING OFFICE
DEMOLITION PLAN SEE: [015_040
Postmen's Office Demolitions]

- 1. Leighton Road.
- 2. Postmen's Sorting Office forecourt.
- 3. Medical Centre.
- 4. Neighbouring house, No. 00 Leighton Road.
- 5. Postmen's Sorting Office [for Listed Building alterations see drawing: 015_040 Postmen's Office Demolitions].
- 6. Brick boundary walls.
- 7. Rear section of Sorting Office retained.
- 8. Later additions to the Postmen's Sorting Office to be demolished.
- 9. Later built studio building to be demolished.
- 10. Boundary Line.
- 11. Brick wall and arches to station below.
- 12. Network Rail land to be aquired further to lease agreement.
- 13. Medical Centre parking.
- 14. Kentish Town Underground Station platforms.

