

This drawing is Copyright © of GVA Grimley Limited.
 All dimensions to be checked on schedules and Consultants
 confirmation with any specifications, schedules and details,
 drawings and details.

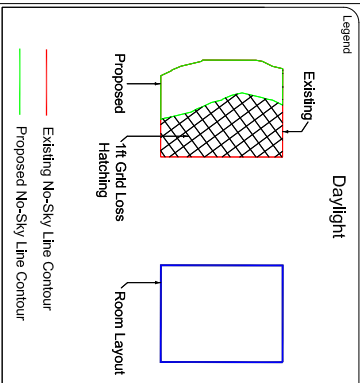

Source of Information

Existing And Surrounding Buildings
 Hawkins Brown 3d Survey Information sent on 23 April 2014
 12960-0P Ramsey Hall ROL

Proposed Scheme

Hawkins Brown Drawings sent on 15 June 2015

- 1438-HB-X-01-M2-A-P-Bldg.dwg
- 1438-HB-X-02-M2-A-P-Bldg.dwg
- 1438-HB-X-03-M2-A-P-Bldg.dwg
- 1438-HB-X-04-M2-A-P-Bldg.dwg
- 1438-HB-X-05-M2-A-P-Bldg.dwg
- 1438-HB-X-06-M2-A-P-Bldg.dwg
- 1438-HB-X-07-A-E-Bldg.dwg
- 1438-HB-X-08-A-E-Bldg.dwg
- 1438-HB-X-09-A-E-Bldg.dwg
- 1438-HB-X-10-A-E-Bldg.dwg
- 1438-HB-X-11-M2-A-P-Bldg.dwg

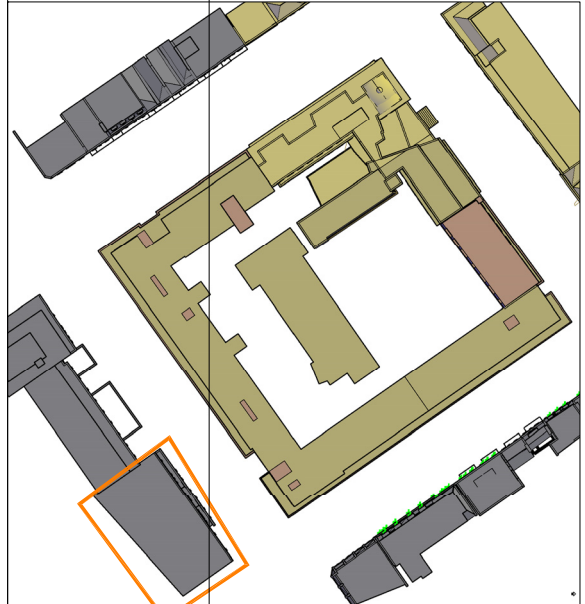
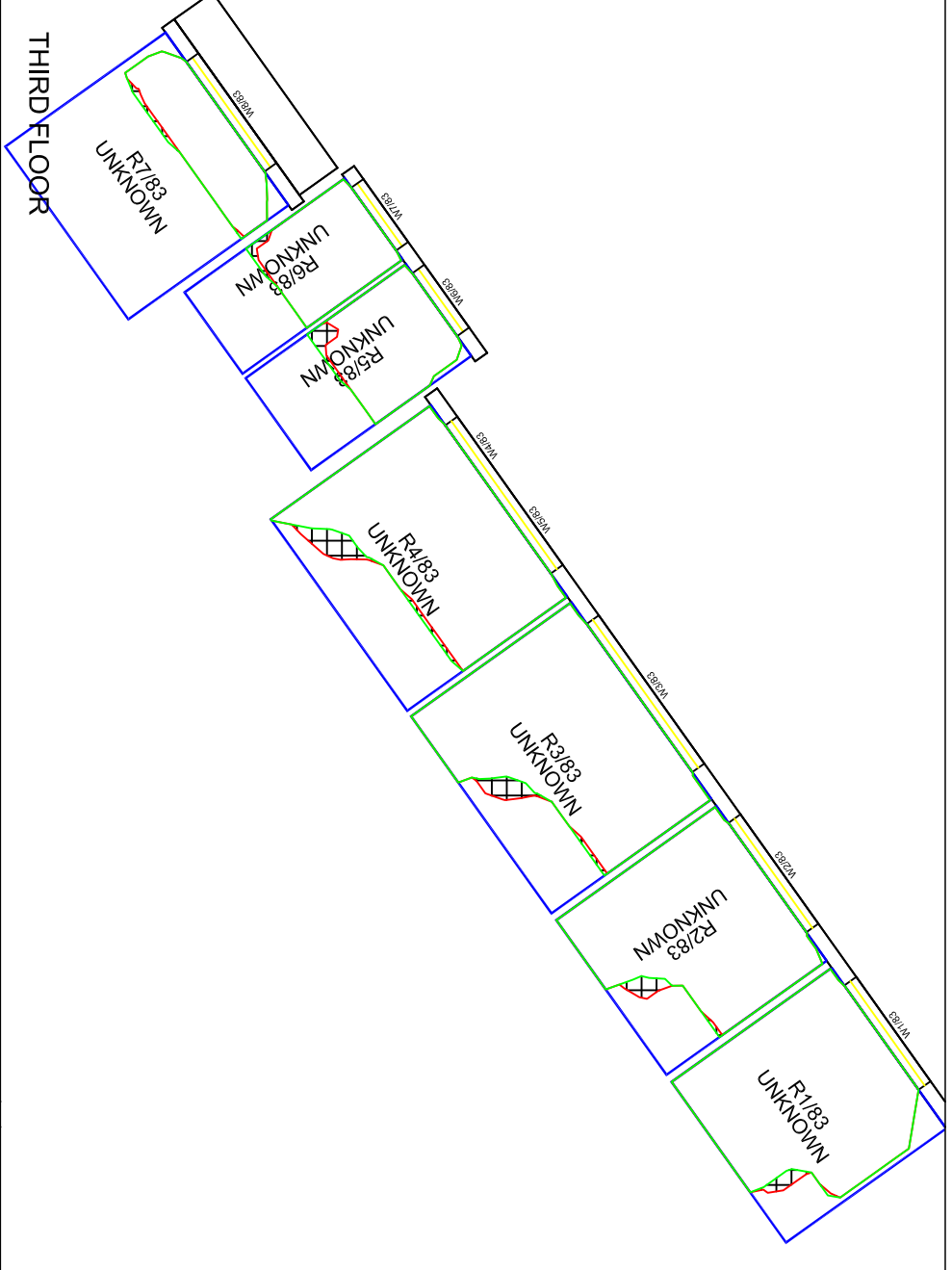
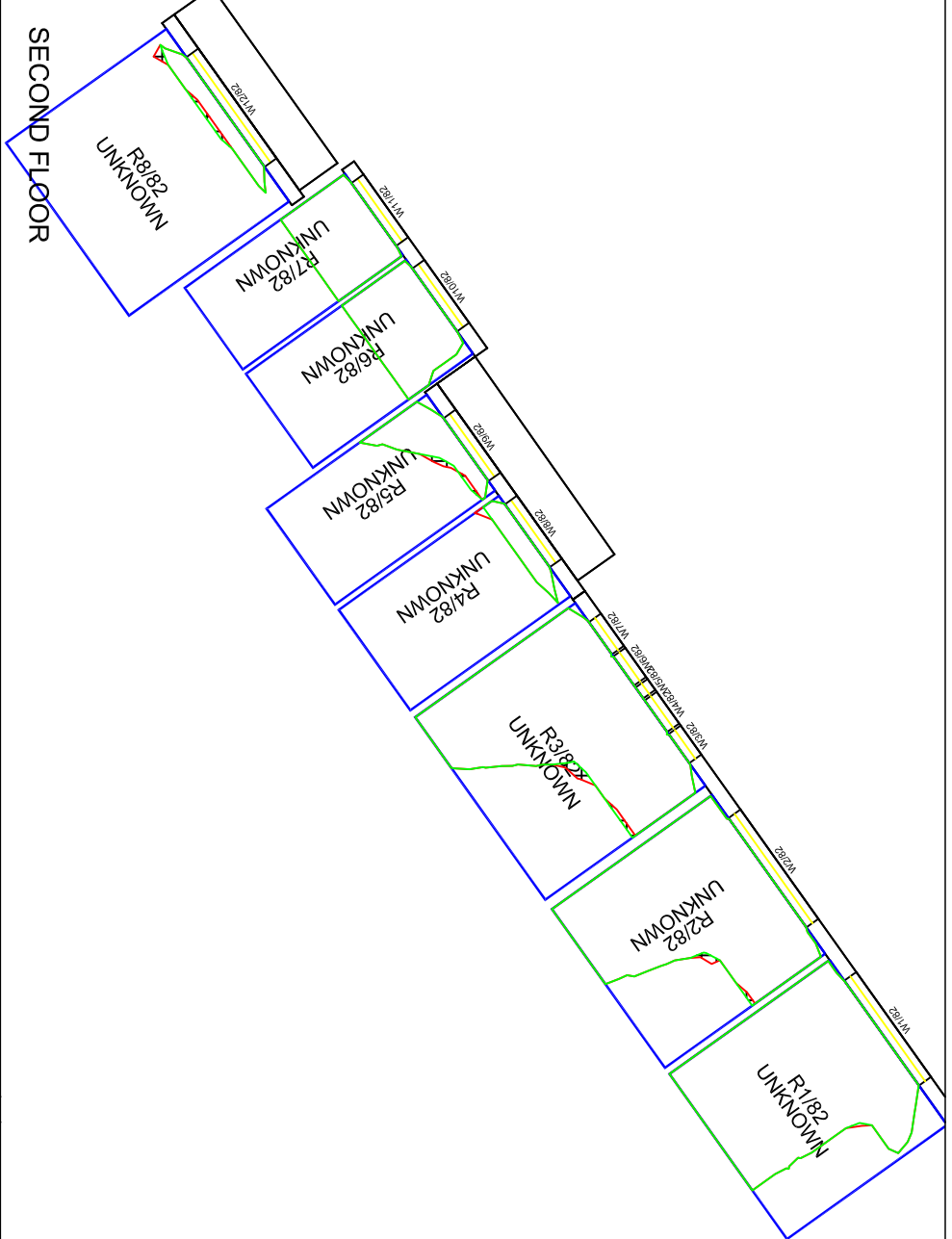

Project Name
 UCL Ramsey Hall
 London, W1

Client
 University College London

Drawing Title
 No-Skyline Contours for
 109-113 Montagu House

Project No.
 RA41-07

Drawing No.
 BRE 104

Revision
 -

GVA

08449 02 03 04
 GVA Schatunowski Brooks
 10 Stratton Street, London, W1J 8JR
 www.gva.co.uk

Drawn By
 MCO

Checked By
 -

Scale
 @ A3
 1/150

Date
 31/07/2015

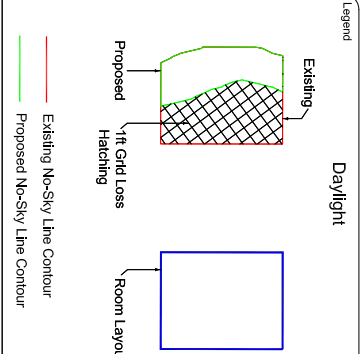

Source of Information

Existing And Surrounding Buildings
 Hawkins Brown 3d Survey Information sent on 23 April 2014
 12960-0P Ramsey Hall ROL

- Proposed Scheme**
- Hawkins Brown Drawings sent on 15 June 2015
- 1438-HB-X-01-M2-A-P-Bldg.dwg
 - 1438-HB-X-02-M2-A-P-Bldg.dwg
 - 1438-HB-X-03-M2-A-P-Bldg.dwg
 - 1438-HB-X-04-M2-A-P-Bldg.dwg
 - 1438-HB-X-05-M2-A-P-Bldg.dwg
 - 1438-HB-X-B1-M2-A-P-Bldg.dwg
 - 1438-HB-X-E-01-A-E-Bldg.dwg
 - 1438-HB-X-E-05-A-E-Bldg.dwg
 - 1438-HB-X-E-06-A-E-Bldg.dwg
 - 1438-HB-X-E-08-A-E-Bldg.dwg
 - 1438-HB-X-RF-M2-A-P-Bldg.dwg

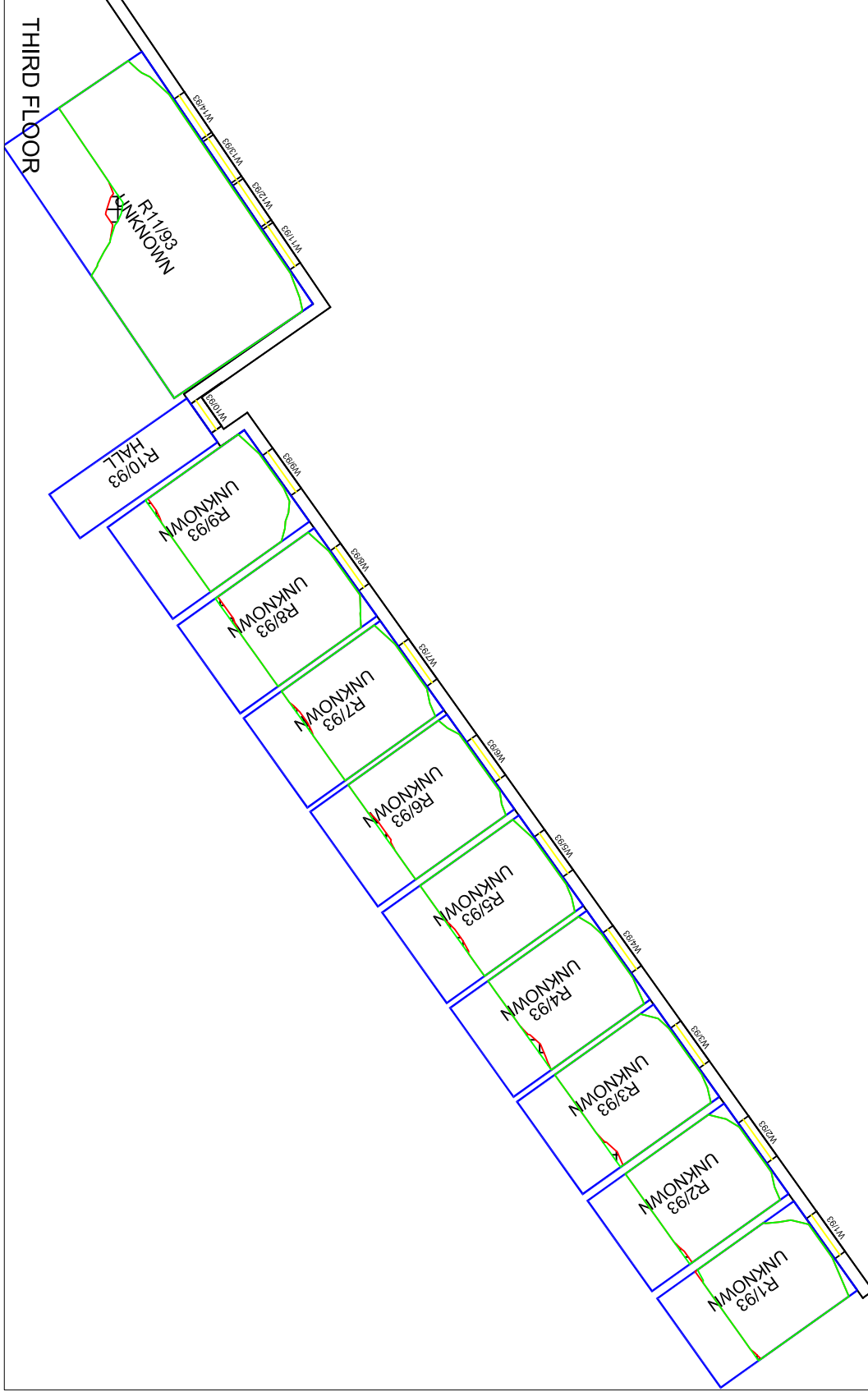
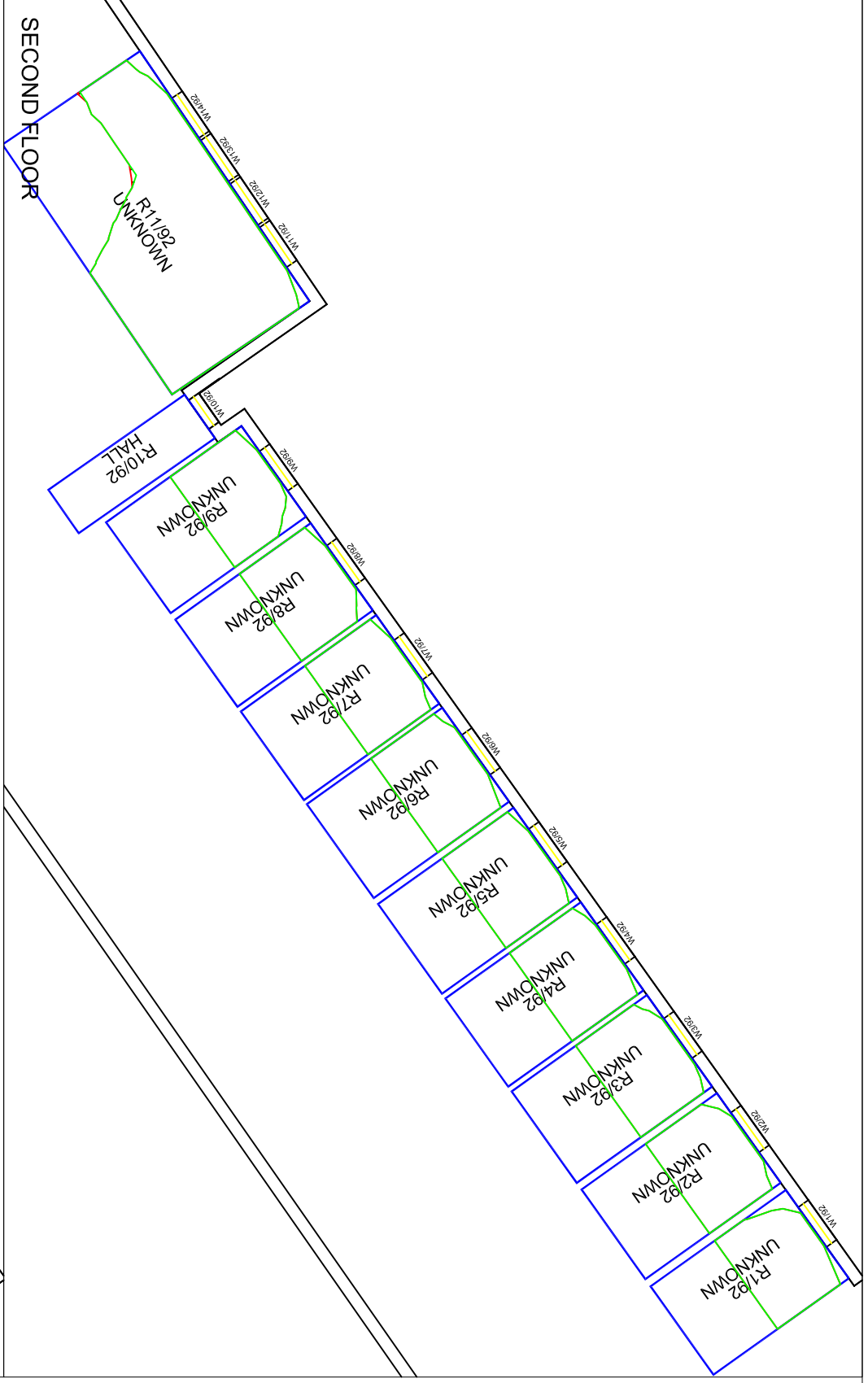
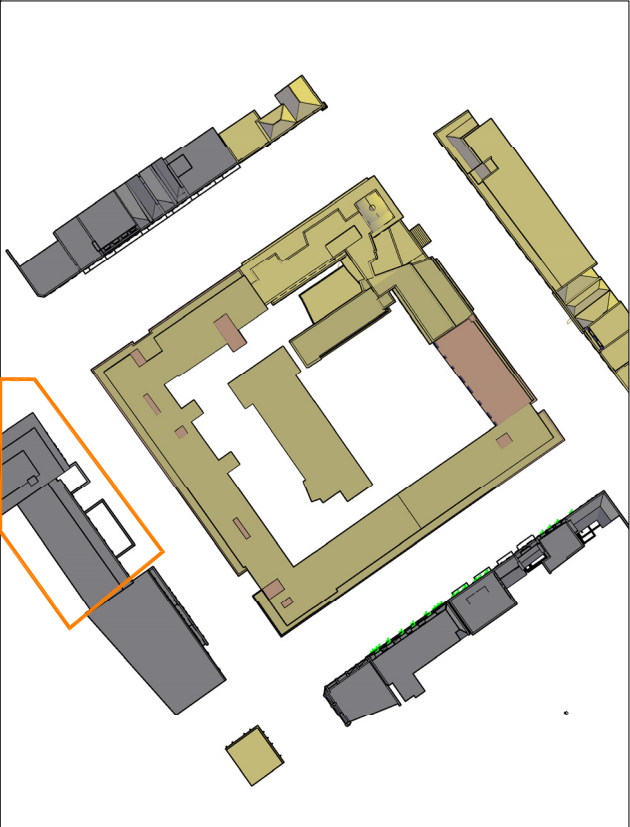

GVA

08449 02 03 04
 GVA Schatunowski Brooks
 10 Stratton Street, London, W1J 8JR
 www.gva.co.uk

Project Name
 UCL, Ramsey Hall
 London, W1

Client
 University College London

Drawing Title
 No-Skyline Contours For
 18-24 Carr Saunders Hall

Drawn By
 MCO

Scale
 @ A3
 1/150

Date
 31/07/2015

Project No.
 RA41-07

Drawing No.
 BRE 105

Revision
 -

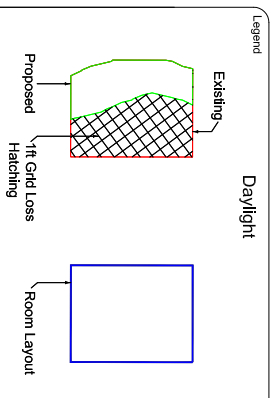

Existing No-Sky Line Contour
 Proposed No-Sky Line Contour

Source of Information

Existing And Surrounding Buildings
 Hawkins Brown 3d Survey Information sent on 23 April 2014
 12960-0P Ramsey Hall ROL

Proposed Scheme

Hawkins Brown Drawings sent on 15 June 2015

- 1438-HB-X-01-M2-A-P-Bldg.dwg
- 1438-HB-X-02-M2-A-P-Bldg.dwg
- 1438-HB-X-03-M2-A-P-Bldg.dwg
- 1438-HB-X-04-M2-A-P-Bldg.dwg
- 1438-HB-X-05-M2-A-P-Bldg.dwg
- 1438-HB-X-B1-M2-A-P-Bldg.dwg
- 1438-HB-X-E-01-A-E-Bldg.dwg
- 1438-HB-X-E-05-A-E-Bldg.dwg
- 1438-HB-X-E-06-A-E-Bldg.dwg
- 1438-HB-X-E-08-A-E-Bldg.dwg
- 1438-HB-X-RF-M2-A-P-Bldg.dwg

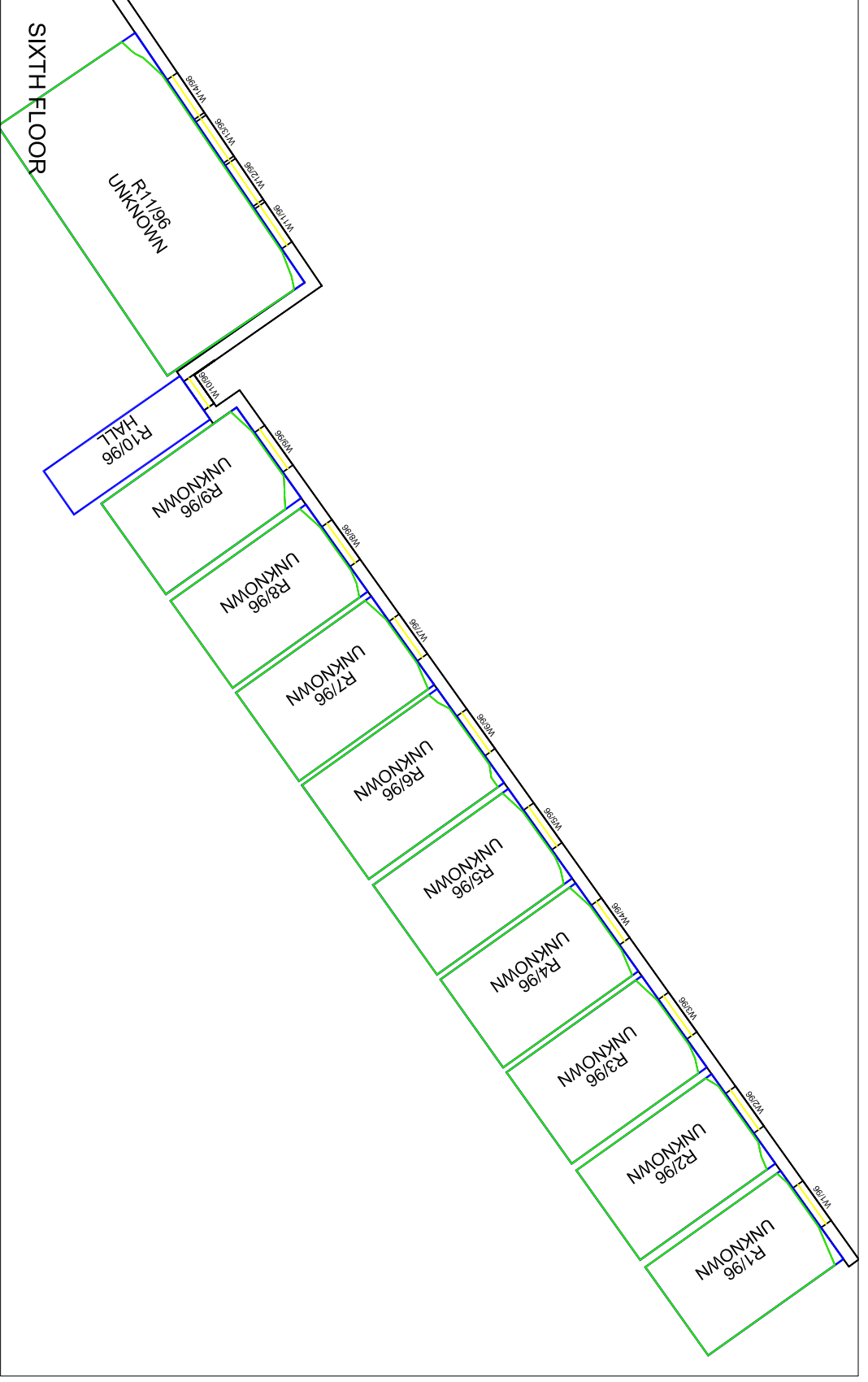
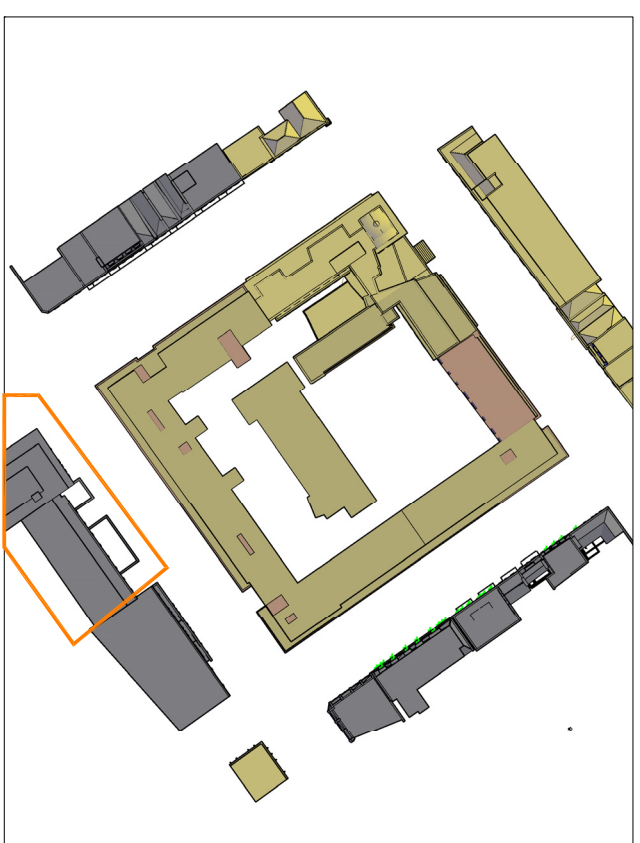

GVA

08449 02 03 04
 GVA Schatunowski Brooks
 10 Stratton Street, London, W1J 8JR
 www.gva.co.uk

Project Name
 UCL, Ramsey Hall
 London, W1

Client
 University College London

Drawing Title
 No-Skyline Contours For
 18-24 Carr Saunders Hall

Drawn By
 MCO

Scale
 1/150

Date
 31/07/2015

Project No.
 RA41-07

Drawing No.
 BRE 107

Revision
 -

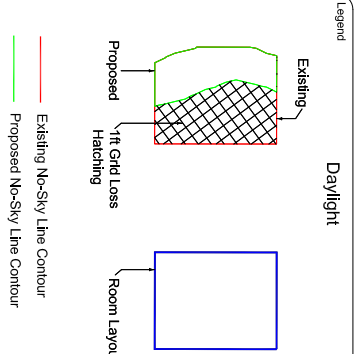

Sources of Information

Existing And Surrounding Buildings
 Hawkins Brown 3d Survey Information sent on 23 April 2014
 12960-0P Ramsey Hall ROL

Proposed Scheme
 Hawkins Brown Drawings sent on 15 June 2015
 1438-HB-X-01-MZ-A-P-Bldg.dwg
 1438-HB-X-02-MZ-A-P-Bldg.dwg
 1438-HB-X-03-MZ-A-P-Bldg.dwg
 1438-HB-X-04-MZ-A-P-Bldg.dwg
 1438-HB-X-05-MZ-A-P-Bldg.dwg
 1438-HB-X-B1-MZ-A-P-Bldg.dwg
 1438-HB-X-E-01-A-E-Bldg.dwg
 1438-HB-X-E-05-A-E-Bldg.dwg
 1438-HB-X-E-06-A-E-Bldg.dwg
 1438-HB-X-E-08-A-E-Bldg.dwg
 1438-HB-X-RF-MZ-A-P-Bldg.dwg

FIRST FLOOR

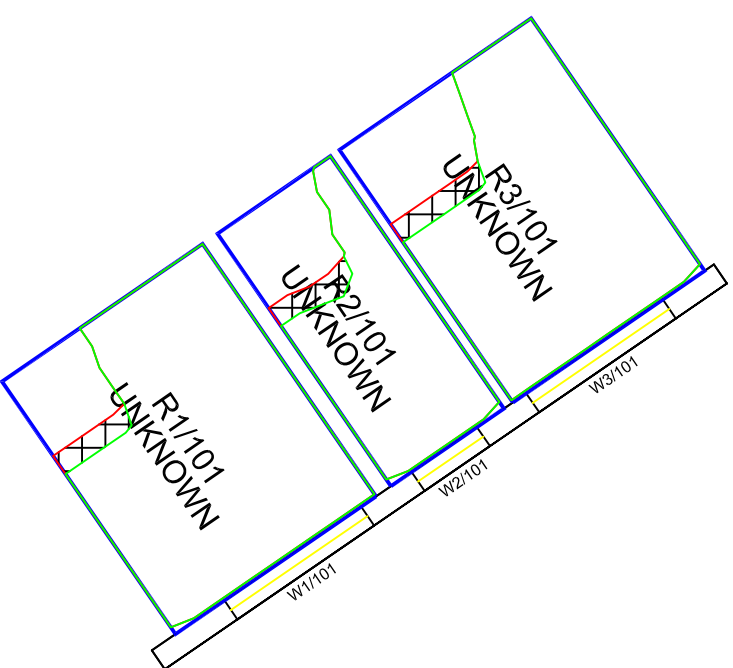

SECOND FLOOR

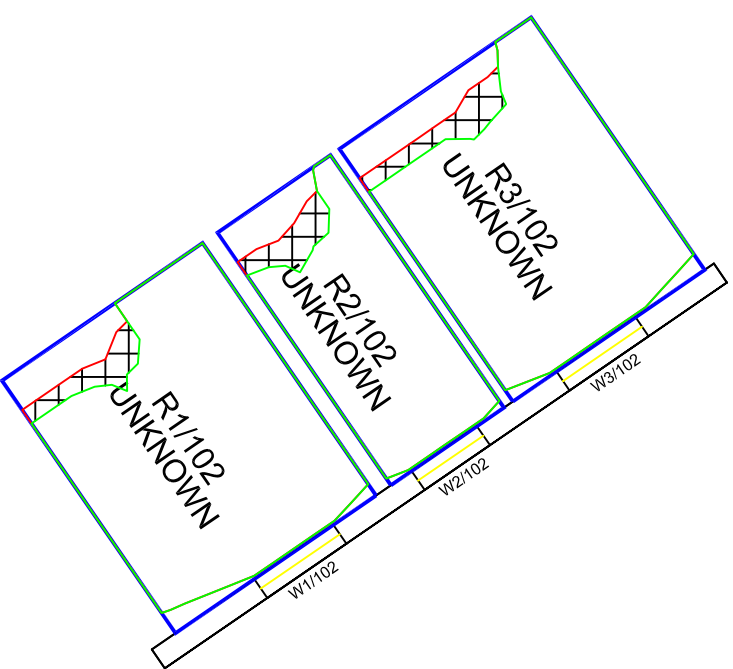

THIRD FLOOR

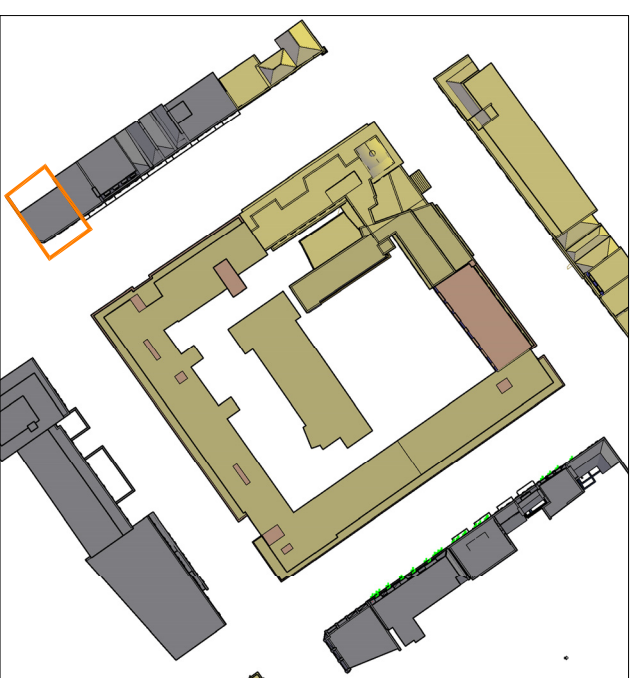
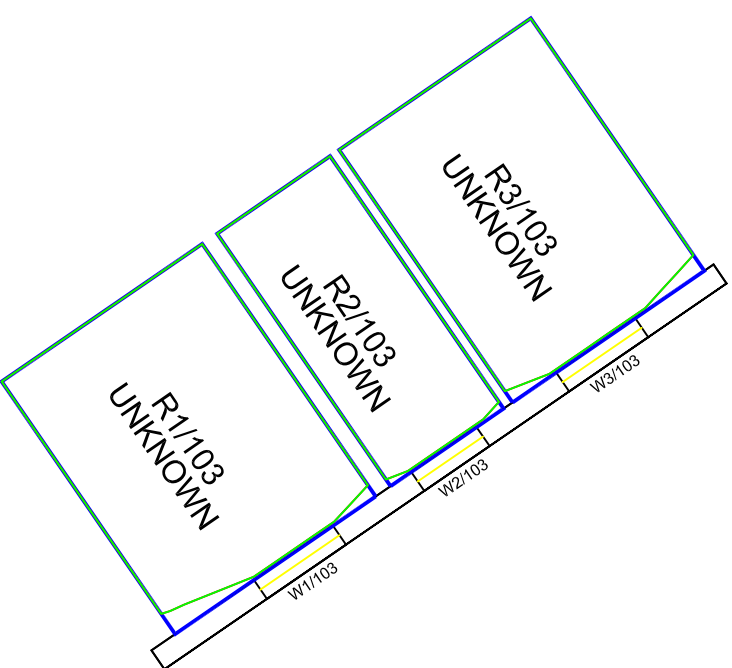

08449 02 03 04
 GVA Schatunowski Brooks
 10 Stratton Street, London, W1J 8JF
 www.gva.co.uk

Project Name
 UCL, Ramsey Hall
 London, W1

Client
 University College London

Drawing Title
 No-Skyline Contours For
 28 Maple Street

Drawn By MCO
Scale @ A3
 1/100
Checked By -
Date 31/07/2015

Project No. RA41-07
Drawing No. BRE 108
Revision -

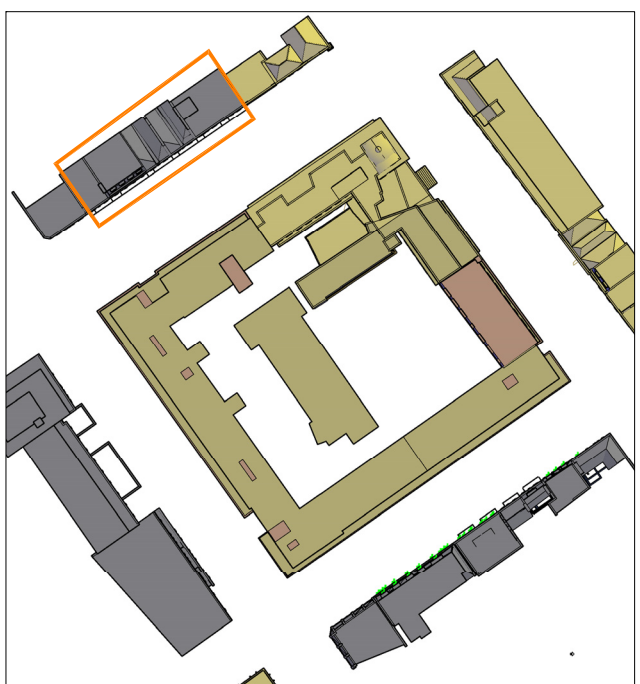
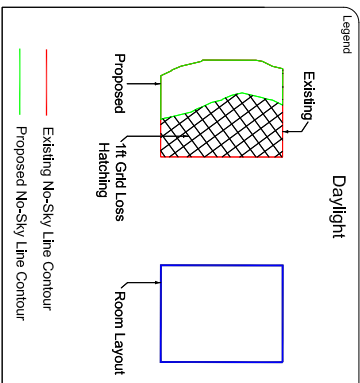

Sources of Information

Existing And Surrounding Buildings
 Hawkins Brown 3d Survey Information sent on 23 April 2014
 12960-0P Ramsey Hall ROL

- Proposed Scheme**
- Hawkins Brown Drawings sent on 15 June 2015
- 1438-HB-X-01-MZ-A-P-Bldg.dwg
 - 1438-HB-X-02-MZ-A-P-Bldg.dwg
 - 1438-HB-X-03-MZ-A-P-Bldg.dwg
 - 1438-HB-X-04-MZ-A-P-Bldg.dwg
 - 1438-HB-X-05-MZ-A-P-Bldg.dwg
 - 1438-HB-X-B1-MZ-A-P-Bldg.dwg
 - 1438-HB-X-E-01-A-E-Bldg.dwg
 - 1438-HB-X-E-05-A-E-Bldg.dwg
 - 1438-HB-X-E-06-A-E-Bldg.dwg
 - 1438-HB-X-E-08-A-E-Bldg.dwg
 - 1438-HB-X-RF-MZ-A-P-Bldg.dwg



SECOND FLOOR

FIRST FLOOR

08449 02 03 04
 GVA Schatunowski Brooks
 10 Stratton Street, London, W1J 8JR
 www.gva.co.uk

Project Name
 UCL, Ramsey Hall
 London, W1

Client
 University College London

Drawing Title
 No-Skyline Contours for
 25-37 FITZROY STREET

Drawn By MCO
Checked By -
Scale @ A3 1/150
Date 31/07/2015

Project No. RA41-07
Drawing No. BRE 110
Revision -

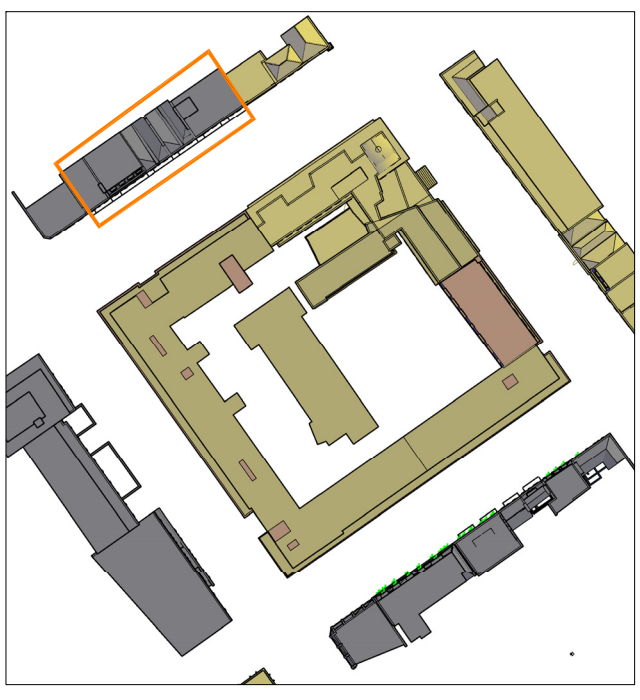
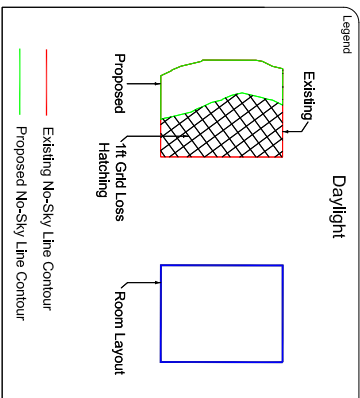

- Sources of Information**
- Existing And Surrounding Buildings**
 Hawkins Brown 3d Survey Information sent on 23 April 2014
 12960-0P Ramsey Hall ROL
- Proposed Scheme**
 Hawkins Brown Drawings sent on 15 June 2015
- 1438-HB-X-01-MZ-A-P-Bldg.dwg
 - 1438-HB-X-02-MZ-A-P-Bldg.dwg
 - 1438-HB-X-03-MZ-A-P-Bldg.dwg
 - 1438-HB-X-04-MZ-A-P-Bldg.dwg
 - 1438-HB-X-05-MZ-A-P-Bldg.dwg
 - 1438-HB-X-B1-MZ-A-P-Bldg.dwg
 - 1438-HB-X-E-01-A-E-Bldg.dwg
 - 1438-HB-X-E-05-A-E-Bldg.dwg
 - 1438-HB-X-E-06-A-E-Bldg.dwg
 - 1438-HB-X-E-08-A-E-Bldg.dwg
 - 1438-HB-X-RF-MZ-A-P-Bldg.dwg

FOURTH FLOOR

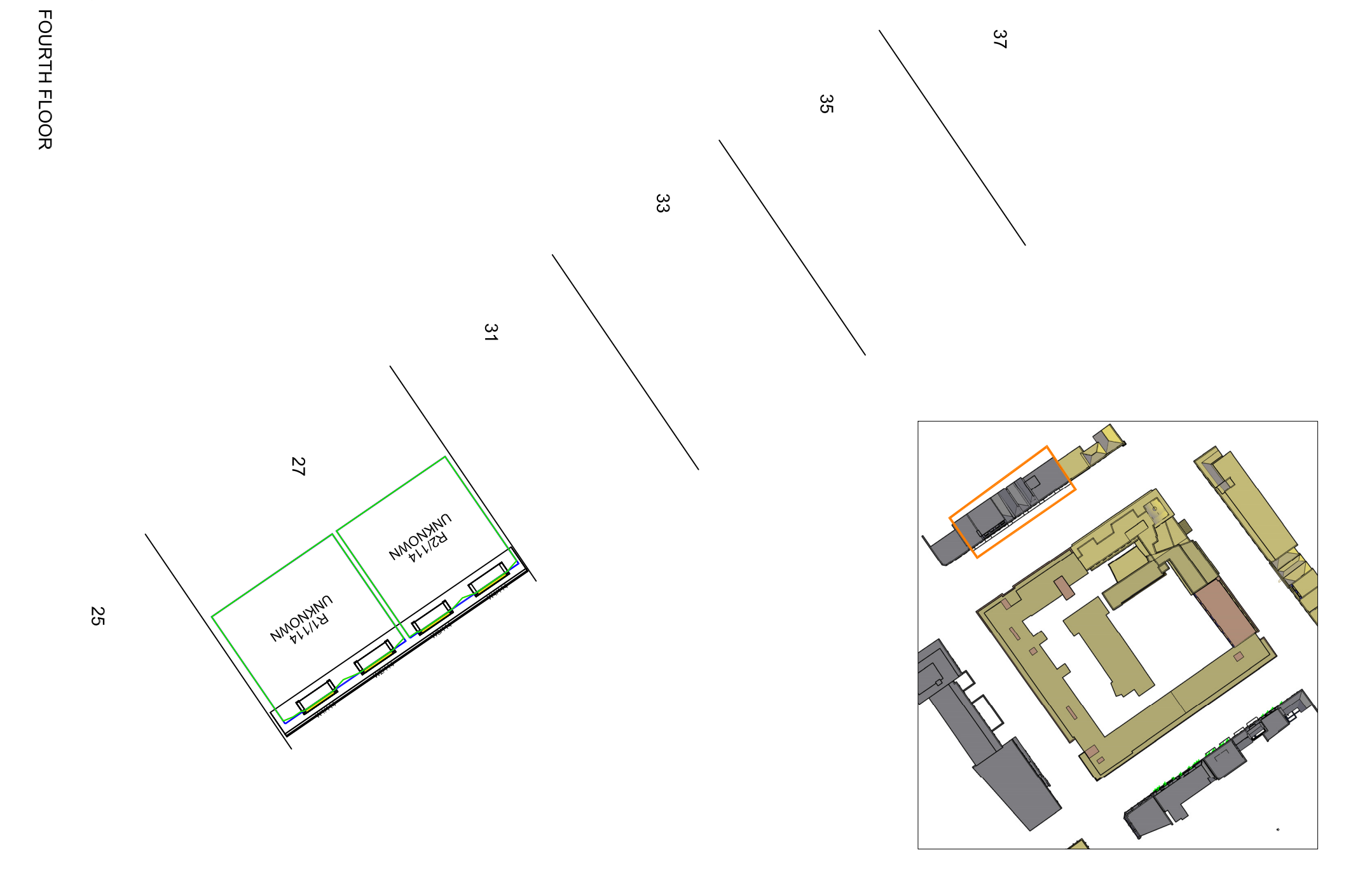

THIRD FLOOR

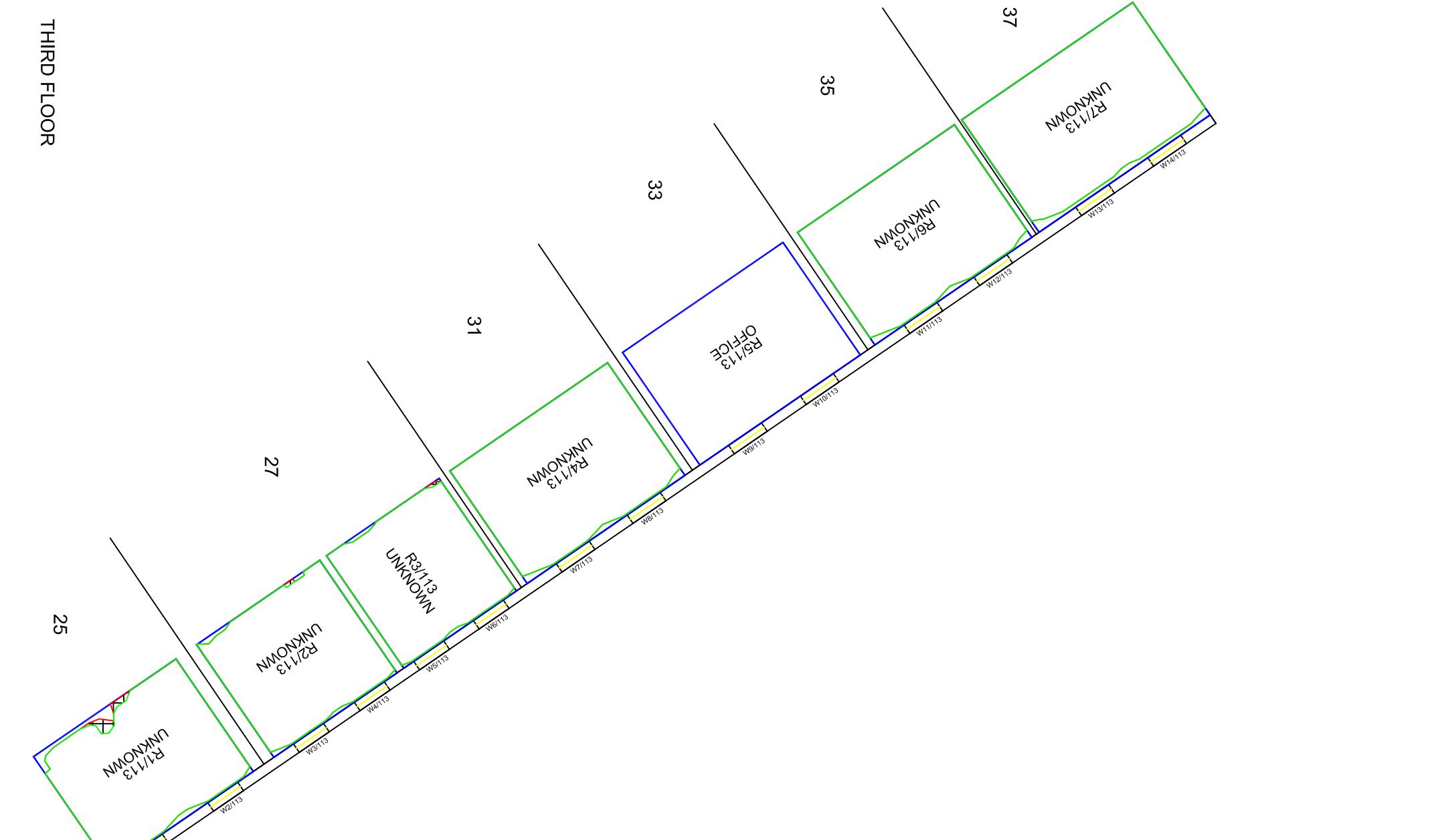

GVA

08449 02 03 04
 GVA Schatunowski Brooks
 10 Stratton Street, London, W1J 8UR
 www.gva.co.uk

Project Name
 UCL, Ramsey Hall
 London, W1

Client
 University College London

Drawing Title
 No-Skyline Contours For
 25-37 FITZROY STREET

Drawn By
 MCO

Checked By
 -

Scale
 @ A3
 1/150

Date
 31/07/2015

Project No.
 RA41-07

Drawing No.
 BRE 111

Revision
 -



Appendix III

**Daylight Analysis
Ramsey Hall
31-Jul-15**

Room/Floor	Room Use	Window	%VSC			% Daylight Factor			Proposed No Sky	
			Exist	Prop	% Loss	Exist	Prop	% Loss	% of Room Area	% Loss of Existing
112 WHITFIELD STREET										
1st Floor										
R3/11	BEDROOM	W4/11	20.09	20.13	-0.20%	1.45	1.46	-0.34%	38.24%	0.14%
2nd Floor										
R3/12	BEDROOM	W4/12	24.07	24.46	-1.62%	1.14	1.16	-1.40%	36.40%	1.06%
3rd Floor										
R3/13	BEDROOM	W4/13	28.03	28.63	>27	0.99	1.01	-1.82%	41.18%	1.20%
110 WHITFIELD STREET										
1st Floor										
R1/21	UNKNOWN	W1/21	18.75	18.75	0.00%	1.46	1.47	-0.34%	42.64%	-1.35%
R2/21	UNKNOWN	W2/21	18.31	18.33	-0.11%	1.90	1.91	-0.37%	53.51%	1.22%
		W3/21	18.00	18.02	-0.11%					
2nd Floor										
R1/22	UNKNOWN	W1/22	22.46	22.87	-1.83%	1.30	1.33	-1.76%	47.83%	-3.05%
R2/22	UNKNOWN	W2/22	22.07	22.52	-2.04%	1.71	1.74	-1.81%	57.05%	1.53%
		W3/22	21.83	22.31	-2.20%					
3rd Floor										
R1/23	UNKNOWN	W1/23	27.05	27.75	>27	1.73	1.77	-1.90%	80.04%	-8.93%
R2/23	UNKNOWN	W2/23	26.76	27.55	>27	2.34	2.39	-2.14%	81.68%	1.45%
		W3/23	26.50	27.31	>27					
102-104 WHITFIELD STREET										
Base Floor										
R1/49	LKD	W1/49	10.38	9.79	5.68%	1.01	0.95	6.34%	26.68%	2.97%
		W2/49	10.33	9.74	5.71%					
R2/49	LKD	W3/49	9.84	9.30	5.49%	1.53	1.46	4.38%	32.26%	7.25%
		W4/49	10.17	9.58	5.80%					
Gnd Floor										
R1/50	LKD	W1/50	14.16	13.70	3.25%	2.28	2.23	2.32%	38.40%	5.31%
		W2/50	14.12	13.66	3.26%					
R2/50	LKD	W4/50	14.06	13.59	3.34%	1.97	1.93	2.38%	44.93%	1.42%
		W5/50	14.04	13.57	3.35%					
1st Floor										
R1/51	LKD	W1/51	17.53	17.47	0.34%	2.38	2.38	0.00%	58.73%	-0.10%
		W2/51	17.49	17.40	0.51%					
R2/51	LKD	W3/51	17.48	17.37	0.63%	2.39	2.39	0.21%	60.35%	0.00%
		W4/51	17.47	17.35	0.69%					
2nd Floor										
R1/52	LKD	W1/52	21.73	21.97	-1.10%	2.12	2.14	-0.90%	60.25%	-0.19%
		W2/52	21.73	21.91	-0.83%					
R2/52	LKD	W3/52	21.75	21.88	-0.60%	2.13	2.14	-0.52%	60.70%	0.00%
		W4/52	21.75	21.85	-0.46%					

Room/Floor	Room Use	Window	%VSC			% Daylight Factor			Proposed No Sky	
			Exist	Prop	% Loss	Exist	Prop	% Loss	% of Room Area	% Loss of Existing
3rd Floor										
R1/53	LKD	W1/53	25.91	26.26	-1.35%	2.83	2.86	-1.06%	75.42%	0.00%
		W2/53	25.95	26.22	-1.04%					
R2/53	LKD	W3/53	26.05	26.25	-0.77%	2.34	2.35	-0.64%	75.95%	0.00%
		W4/53	26.09	26.25	-0.61%					
94-100 WHITFIELD STREET										
Gnd Floor										
R1/60		W1/60	13.27	12.75	3.92%	2.67	2.60	2.69%	25.76%	6.25%
		W2/60	13.26	12.75	3.85%					
R2/60		W3/60	13.26	12.77	3.70%	1.71	1.67	2.69%	28.04%	1.01%
R3/60		W4/60	13.23	12.77	3.48%	1.44	1.40	2.57%	23.73%	6.31%
R4/60		W5/60	13.25	12.81	3.32%	1.46	1.42	2.33%	23.70%	6.36%
R5/60		W6/60	13.32	12.94	2.85%	1.36	1.33	2.13%	23.32%	6.65%
1st Floor										
R1/61	LIVINGROOM	W1/61	15.98	15.68	1.88%	2.13	2.10	1.22%	30.75%	0.66%
		W2/61	15.97	15.68	1.82%					
R2/61	BEDROOM	W3/61	15.97	15.68	1.82%	1.38	1.36	1.31%	32.57%	0.00%
R3/61	BEDROOM	W4/61	15.95	15.66	1.82%	1.38	1.36	1.38%	32.28%	0.59%
R4/61	BEDROOM	W5/61	15.96	15.69	1.69%	1.38	1.36	1.30%	31.94%	0.89%
R5/61	BEDROOM	W6/61	16.05	15.79	1.62%	1.39	1.37	1.23%	32.29%	0.87%
R6/61	LIVINGROOM	W7/61	16.16	15.91	1.55%	2.17	2.15	1.10%	37.92%	0.00%
		W8/61	16.26	16.02	1.48%					
2nd Floor										
R1/62	LIVINGROOM	W1/62	19.15	19.19	-0.21%	1.54	1.54	-0.19%	37.82%	0.00%
R2/62	BEDROOM	W2/62	19.15	19.17	-0.10%	2.00	2.00	-0.10%	43.17%	0.00%
R3/62	BEDROOM	W3/62	19.14	19.14	0.00%	2.00	2.00	0.05%	43.36%	0.00%
R4/62	BEDROOM	W4/62	19.15	19.12	0.16%	2.00	2.00	0.10%	43.95%	0.00%
R5/62	BEDROOM	W5/62	19.20	19.16	0.21%	2.00	2.00	0.25%	42.45%	0.67%
R6/62	LIVINGROOM	W6/62	19.33	19.25	0.41%	1.56	1.56	0.32%	37.10%	2.17%
3rd Floor										
R1/63	LIVINGROOM	W1/63	23.01	23.08	-0.30%	1.76	1.77	-0.28%	52.11%	0.00%
R2/63	BEDROOM	W2/63	23.01	23.06	-0.22%	2.29	2.29	-0.17%	59.69%	0.00%
R3/63	BEDROOM	W3/63	23.01	23.03	-0.09%	2.29	2.29	-0.04%	60.27%	0.00%
R4/63	BEDROOM	W4/63	23.03	23.01	0.09%	2.29	2.29	0.04%	59.49%	0.00%
R5/63	BEDROOM	W5/63	23.07	23.03	0.17%	2.29	2.28	0.22%	59.26%	0.00%
R6/63	LIVINGROOM	W6/63	23.19	23.11	0.34%	1.79	1.78	0.28%	51.27%	0.27%
4th Floor										
R1/64	LIVINGROOM	W1/64	27.42	27.53	>27	4.10	4.12	-0.39%	81.02%	0.00%
		W2/64	27.43	27.52	>27					
R2/64	BEDROOM	W3/64	27.44	27.51	>27	2.66	2.67	-0.23%	88.73%	0.00%
R3/64	BEDROOM	W4/64	27.45	27.49	>27	2.67	2.67	-0.11%	89.97%	0.00%
R4/64	BEDROOM	W5/64	27.48	27.48	>27	2.67	2.67	0.00%	89.90%	0.00%
R5/64	BEDROOM	W6/64	27.52	27.49	>27	2.67	2.66	0.15%	88.13%	0.00%
R6/64	LIVINGROOM	W7/64	27.61	27.56	>27	4.16	4.15	0.24%	81.45%	0.34%
		W8/64	27.69	27.61	>27					
5th Floor										
R1/65		W1/65	33.17	33.33	>27	3.02	3.03	-0.40%	99.90%	0.00%
R2/65		W2/65	33.02	33.12	>27	2.47	2.48	-0.28%	43.47%	0.00%
R3/65		W3/65	33.05	33.14	>27	2.67	2.68	-0.22%	43.65%	0.00%
R4/65		W4/65	33.04	33.14	>27	2.51	2.52	-0.24%	44.49%	0.00%
R5/65		W5/65	33.07	33.18	>27	2.40	2.40	-0.25%	44.46%	0.66%

Room/Floor	Room Use	Window	%VSC			% Daylight Factor			Proposed No Sky	
			Exist	Prop	% Loss	Exist	Prop	% Loss	% of Room Area	% Loss of Existing
109-113 MONTAGU HOUSE										
Gnd Floor										
R1/80	UNKNOWN	W1/80	20.69	20.57	0.58%	3.90	3.90	0.20%	88.32%	0.10%
		W2/80	15.96	15.92	0.25%					
R2/80	UNKNOWN	W3/80	16.03	15.87	1.00%	2.56	2.55	0.51%	61.33%	0.08%
		W4/80	15.47	15.32	0.97%					
1st Floor										
R1/81	UNKNOWN	W1/81	23.55	23.60	-0.21%	4.19	4.20	-0.31%	83.96%	-0.15%
R2/81	UNKNOWN	W2/81	19.48	19.64	-0.82%	3.83	3.85	-0.63%	69.48%	0.35%
R3/81	UNKNOWN	W3/81	18.87	19.00	-0.69%	2.62	2.64	-0.73%	34.08%	-1.21%
R4/81	UNKNOWN	W4/81	18.31	18.49	-0.98%	2.62	2.65	-0.95%	33.94%	-0.96%
R5/81	UNKNOWN	W5/81	0.00	0.00	#DIV/0!	0.00	0.00	#DIV/0!	0.00%	100.00%
R6/81	UNKNOWN	W6/81	0.10	0.10	0.00%	0.21	0.21	0.00%	14.87%	0.67%
R7/81	UNKNOWN	W7/81	17.48	17.61	-0.74%	2.39	2.41	-0.75%	28.29%	-1.40%
R8/81	UNKNOWN	W8/81	17.38	17.48	-0.58%	2.67	2.68	-0.56%	30.44%	-1.94%
R9/81	UNKNOWN	W9/81	0.00	0.00	#DIV/0!	0.00	0.00	#DIV/0!	0.00%	100.00%
2nd Floor										
R1/82	UNKNOWN	W1/82	26.53	26.73	-0.75%	3.48	3.50	-0.69%	77.35%	0.15%
R2/82	UNKNOWN	W2/82	24.55	24.93	-1.55%	4.34	4.39	-1.08%	75.81%	0.23%
R3/82	UNKNOWN	W3/82	23.08	23.59	-2.21%	3.56	3.65	-2.36%	68.77%	0.52%
		W4/82	22.53	23.08	-2.44%					
		W5/82	21.83	22.41	-2.66%					
		W6/82	20.74	21.33	-2.84%					
		W7/82	17.27	17.90	-3.65%					
R4/82	UNKNOWN	W8/82	0.02	0.07	-250.00%	0.00	0.00	#DIV/0!	8.15%	3.30%
R5/82	UNKNOWN	W9/82	0.24	0.27	-12.50%	0.33	0.33	0.00%	17.65%	1.62%
R6/82	UNKNOWN	W10/82	20.97	21.57	-2.86%	2.77	2.83	-2.17%	38.02%	0.00%
R7/82	UNKNOWN	W11/82	20.92	21.47	-2.63%	3.03	3.09	-1.98%	40.07%	0.00%
R8/82	UNKNOWN	W12/82	0.00	0.00	#DIV/0!	0.00	0.00	#DIV/0!	6.90%	-3.23%
3rd Floor										
R1/83	UNKNOWN	W1/83	30.14	30.42	>27	4.69	4.73	-0.81%	86.75%	1.38%
R2/83	UNKNOWN	W2/83	28.27	28.79	>27	4.95	5.02	-1.33%	83.89%	1.83%
R3/83	UNKNOWN	W3/83	26.85	27.65	>27	5.35	5.47	-2.13%	80.88%	1.95%
R4/83	UNKNOWN	W4/83	22.01	22.87	-3.91%	4.98	5.12	-2.67%	72.30%	2.93%
		W5/83	25.65	26.52	-3.39%					
R5/83	UNKNOWN	W6/83	25.13	26.02	-3.54%	3.21	3.30	-2.74%	59.31%	-5.21%
R6/83	UNKNOWN	W7/83	25.13	25.95	-3.26%	3.48	3.57	-2.44%	60.46%	-2.72%
R7/83	UNKNOWN	W8/83	2.32	3.03	-30.60%	0.47	0.60	-28.17%	27.03%	-2.87%
4th Floor										
R1/84	UNKNOWN	W1/84	33.41	33.75	>27	4.19	4.23	-0.95%	91.46%	0.37%
R2/84	UNKNOWN	W2/84	32.15	32.74	>27	5.31	5.39	-1.47%	99.70%	-1.36%
R3/84	UNKNOWN	W3/84	30.99	31.93	>27	5.93	6.07	-2.31%	99.81%	0.00%
R4/84	UNKNOWN	W4/84	30.42	31.44	>27	5.94	6.09	-2.56%	99.81%	0.00%
R5/84	UNKNOWN	W5/84	30.33	31.25	>27	4.36	4.47	-2.45%	99.71%	-5.36%
R6/84	UNKNOWN	W6/84	30.41	31.25	>27	4.34	4.44	-2.23%	99.69%	-6.24%
R7/84	UNKNOWN	W7/84	30.56	31.28	>27	4.47	4.55	-1.86%	96.87%	0.00%
5th Floor										
R1/85	UNKNOWN	W1/85	36.77	37.17	>27	4.57	4.62	-1.07%	98.79%	0.00%
R2/85	UNKNOWN	W2/85	35.97	36.63	>27	4.79	4.87	-1.65%	99.69%	0.00%
R3/85	UNKNOWN	W3/85	35.00	35.99	>27	6.72	6.88	-2.41%	99.85%	0.00%
R4/85	UNKNOWN	W4/85	34.62	35.66	>27	6.50	6.67	-2.58%	99.86%	0.00%
R5/85	UNKNOWN	W5/85	34.69	35.58	>27	6.00	6.13	-2.22%	99.81%	0.00%
R6/85	UNKNOWN	W6/85	34.89	35.62	>27	5.16	5.25	-1.82%	98.26%	0.00%



Room/Floor	Room Use	Window	%VSC			% Daylight Factor			Proposed No Sky	
			Exist	Prop	% Loss	Exist	Prop	% Loss	% of Room Area	% Loss of Existing
18-24 CARR SAUNDERS HALL										
2nd Floor										
R1/92	UNKNOWN	W1/92	15.46	15.47	-0.06%	1.24	1.25	-0.08%	48.13%	0.00%
R2/92	UNKNOWN	W2/92	19.34	19.62	-1.45%	1.41	1.43	-1.06%	49.87%	0.00%
R3/92	UNKNOWN	W3/92	21.33	21.55	-1.03%	1.48	1.49	-0.88%	50.17%	0.00%
R4/92	UNKNOWN	W4/92	22.40	22.56	-0.71%	1.56	1.57	-0.64%	50.76%	0.00%
R5/92	UNKNOWN	W5/92	22.89	23.01	-0.52%	1.55	1.56	-0.52%	50.79%	0.00%
R6/92	UNKNOWN	W6/92	23.08	23.17	-0.39%	1.51	1.51	-0.33%	50.38%	0.00%
R7/92	UNKNOWN	W7/92	22.86	22.90	-0.17%	1.58	1.59	-0.25%	50.53%	0.00%
R8/92	UNKNOWN	W8/92	21.83	21.86	-0.14%	1.58	1.58	-0.19%	50.00%	0.00%
R9/92	UNKNOWN	W9/92	18.40	18.42	-0.11%	1.37	1.37	-0.29%	48.70%	0.00%
R11/92	UNKNOWN	W11/92	22.63	22.55	0.35%	2.44	2.43	0.33%	74.07%	0.17%
		W12/92	22.88	22.80	0.35%					
		W13/92	23.15	23.05	0.43%					
		W14/92	23.47	23.35	0.51%					
3rd Floor										
R1/93	UNKNOWN	W1/93	18.40	18.47	-0.38%	1.40	1.41	-0.29%	67.97%	0.00%
R2/93	UNKNOWN	W2/93	23.04	23.45	-1.78%	1.60	1.62	-1.25%	69.50%	-0.51%
R3/93	UNKNOWN	W3/93	25.11	25.44	-1.31%	1.67	1.68	-1.08%	70.10%	-1.12%
R4/93	UNKNOWN	W4/93	26.10	26.38	-1.07%	1.74	1.76	-0.86%	70.47%	-1.28%
R5/93	UNKNOWN	W5/93	26.52	26.74	-0.83%	1.73	1.74	-0.75%	70.40%	-0.75%
R6/93	UNKNOWN	W6/93	26.65	26.83	-0.68%	1.68	1.69	-0.60%	70.21%	-0.84%
R7/93	UNKNOWN	W7/93	26.39	26.53	-0.53%	1.76	1.77	-0.51%	70.21%	-0.76%
R8/93	UNKNOWN	W8/93	25.26	25.37	-0.44%	1.76	1.76	-0.40%	69.64%	-0.78%
R9/93	UNKNOWN	W9/93	21.52	21.61	-0.42%	1.53	1.53	-0.52%	68.28%	-0.51%
R11/93	UNKNOWN	W11/93	26.39	26.34	0.19%	2.76	2.75	0.22%	79.85%	0.95%
		W12/93	26.61	26.55	0.23%					
		W13/93	26.84	26.76	0.30%					
		W14/93	27.21	27.13	>27					
4th Floor										
R1/94	UNKNOWN	W1/94	21.83	22.04	-0.96%	1.57	1.58	-0.64%	96.09%	0.00%
R2/94	UNKNOWN	W2/94	27.21	27.65	>27	1.79	1.81	-1.34%	97.63%	0.00%
R3/94	UNKNOWN	W3/94	29.25	29.61	>27	1.86	1.88	-1.08%	98.02%	-0.26%
R4/94	UNKNOWN	W4/94	30.06	30.38	>27	1.93	1.95	-0.83%	98.22%	-0.82%
R5/94	UNKNOWN	W5/94	30.36	30.62	>27	1.91	1.93	-0.78%	98.07%	-0.45%
R6/94	UNKNOWN	W6/94	30.43	30.64	>27	1.85	1.87	-0.70%	97.91%	-0.69%
R7/94	UNKNOWN	W7/94	30.15	30.31	>27	1.94	1.95	-0.51%	98.05%	-0.36%
R8/94	UNKNOWN	W8/94	28.94	29.06	>27	1.94	1.95	-0.36%	97.30%	-0.75%
R9/94	UNKNOWN	W9/94	24.88	24.97	-0.36%	1.69	1.70	-0.41%	96.19%	-0.09%
R11/94	UNKNOWN	W11/94	30.41	30.36	>27	3.09	3.08	0.26%	93.20%	0.07%
		W12/94	30.60	30.52	>27					
		W13/94	30.80	30.70	>27					
		W14/94	31.10	30.99	>27					
5th Floor										
R1/95	UNKNOWN	W1/95	25.95	26.15	-0.77%	1.76	1.77	-0.51%	97.33%	0.00%
R2/95	UNKNOWN	W2/95	31.77	32.23	>27	2.01	2.03	-1.30%	98.07%	0.00%
R3/95	UNKNOWN	W3/95	33.39	33.77	>27	2.05	2.07	-1.02%	98.11%	0.00%
R4/95	UNKNOWN	W4/95	33.96	34.29	>27	2.12	2.14	-0.94%	98.22%	0.00%
R5/95	UNKNOWN	W5/95	34.13	34.42	>27	2.10	2.11	-0.86%	98.07%	0.00%
R6/95	UNKNOWN	W6/95	34.16	34.39	>27	2.03	2.05	-0.64%	97.99%	0.00%
R7/95	UNKNOWN	W7/95	33.92	34.10	>27	2.13	2.14	-0.52%	98.23%	0.00%
R8/95	UNKNOWN	W8/95	32.78	32.90	>27	2.13	2.14	-0.38%	98.02%	0.00%
R9/95	UNKNOWN	W9/95	28.45	28.53	>27	1.86	1.86	-0.32%	96.36%	0.00%

Room/Floor	Room Use	Window	%VSC			% Daylight Factor			Proposed No Sky	
			Exist	Prop	% Loss	Exist	Prop	% Loss	% of Room Area	% Loss of Existing
R11/95	UNKNOWN	W11/95	34.48	34.37	>27	3.44	3.42	0.35%	98.05%	0.00%
		W12/95	34.63	34.49	>27					
		W13/95	34.78	34.63	>27					
		W14/95	34.98	34.79	>27					
6th Floor										
R1/96	UNKNOWN	W1/96	35.22	35.38	>27	2.20	2.20	-0.32%	97.95%	0.00%
R2/96	UNKNOWN	W2/96	36.72	37.10	>27	2.23	2.26	-0.94%	98.07%	0.00%
R3/96	UNKNOWN	W3/96	37.08	37.36	>27	2.22	2.23	-0.72%	98.11%	0.00%
R4/96	UNKNOWN	W4/96	37.26	37.43	>27	2.28	2.30	-0.48%	98.22%	0.00%
R5/96	UNKNOWN	W5/96	37.34	37.42	>27	2.26	2.27	-0.35%	98.07%	0.00%
R6/96	UNKNOWN	W6/96	37.38	37.41	>27	2.19	2.20	-0.09%	97.99%	0.00%
R7/96	UNKNOWN	W7/96	37.26	37.27	>27	2.29	2.30	-0.04%	98.23%	0.00%
R8/96	UNKNOWN	W8/96	36.48	36.47	>27	2.31	2.31	0.04%	98.11%	0.00%
R9/96	UNKNOWN	W9/96	32.52	32.49	>27	2.06	2.06	0.10%	97.31%	0.00%
R11/96	UNKNOWN	W11/96	37.82	37.67	>27	3.72	3.71	0.40%	98.05%	0.00%
		W12/96	37.89	37.72	>27					
		W13/96	37.96	37.80	>27					
		W14/96	38.05	37.89	>27					
28 MAPLE STREET										
1st Floor										
R1/101	UNKNOWN	W1/101	24.52	24.23	1.18%	3.60	3.57	0.92%	85.66%	2.82%
R2/101	UNKNOWN	W2/101	23.81	23.47	1.43%	2.33	2.30	1.12%	71.43%	6.30%
R3/101	UNKNOWN	W3/101	23.41	23.04	1.58%	3.59	3.55	1.17%	80.18%	3.85%
2nd Floor										
R1/102	UNKNOWN	W1/102	27.64	27.33	>27	2.04	2.02	0.88%	86.76%	4.74%
R2/102	UNKNOWN	W2/102	27.09	26.74	1.29%	2.41	2.38	0.96%	82.73%	8.08%
R3/102	UNKNOWN	W3/102	26.71	26.33	1.42%	2.06	2.04	1.07%	84.16%	6.14%
3rd Floor										
R1/103	UNKNOWN	W1/103	30.75	30.50	>27	2.22	2.21	0.68%	97.37%	0.00%
R2/103	UNKNOWN	W2/103	30.41	30.13	>27	2.64	2.62	0.68%	98.83%	0.00%
R3/103	UNKNOWN	W3/103	30.17	29.87	>27	2.27	2.25	0.75%	97.93%	0.00%
25 FITZROY STREET										
Base Floor										
R1/109	UNKNOWN	W1/109	9.81	9.81	0.00%	1.74	1.74	0.00%	39.33%	2.39%
		W2/109	9.33	9.33	0.00%					
Gnd Floor										
R2/110	UNKNOWN	W2/110	19.39	19.02	1.91%	2.56	2.52	1.45%	55.05%	3.28%
		W3/110	19.20	18.84	1.87%					
1st Floor										
R1/111	UNKNOWN	W1/111	22.85	22.47	1.66%	3.86	3.81	1.22%	90.08%	5.99%
		W2/111	22.63	22.27	1.59%					
2nd Floor										
R1/112	UNKNOWN	W1/112	27.34	27.01	>27	2.35	2.33	0.93%	92.79%	3.86%
		W2/112	27.18	26.86	1.18%					
3rd Floor										
R1/113	UNKNOWN	W1/113	30.68	30.41	>27	1.76	1.74	0.68%	93.80%	1.69%
		W2/113	30.61	30.36	>27					
27 FITZROY STREET										
Base Floor										
R2/109	UNKNOWN	W3/109	10.16	10.16	0.00%	2.05	2.05	0.00%	33.71%	2.93%
		W4/109	10.84	10.84	0.00%					
		W5/109	9.51	9.51	0.00%					

Room/Floor	Room Use	Window	%VSC			% Daylight Factor			Proposed No Sky	
			Exist	Prop	% Loss	Exist	Prop	% Loss	% of Room Area	% Loss of Existing
Gnd Floor										
R4/110	UNKNOWN	W5/110	18.83	18.49	1.81%	2.28	2.25	1.27%	47.86%	4.37%
R5/110	UNKNOWN	W6/110	18.76	18.45	1.65%	3.35	3.31	1.17%	51.20%	3.73%
		W7/110	18.73	18.44	1.55%					
1st Floor										
R2/111	UNKNOWN	W3/111	22.72	22.40	1.41%	3.81	3.77	1.02%	88.63%	6.76%
		W4/111	22.62	22.32	1.33%					
R3/111	UNKNOWN	W5/111	22.57	22.32	1.11%	4.06	4.03	0.79%	89.26%	6.34%
		W6/111	22.58	22.36	0.97%					
2nd Floor										
R2/112	UNKNOWN	W3/112	27.07	26.79	1.03%	2.64	2.62	0.76%	89.80%	3.81%
		W4/112	27.00	26.75	0.93%					
R3/112	UNKNOWN	W5/112	26.97	26.75	0.82%	2.88	2.86	0.59%	91.17%	2.91%
		W6/112	26.94	26.75	0.71%					
3rd Floor										
R2/113	UNKNOWN	W3/113	30.65	30.43	>27	2.17	2.15	0.60%	97.50%	0.16%
		W4/113	30.62	30.41	>27					
R3/113	UNKNOWN	W5/113	30.61	30.42	>27	2.33	2.31	0.47%	97.85%	0.24%
		W6/113	30.58	30.41	>27					
4th Floor										
R1/114	UNKNOWN	W1/114	34.47	34.35	>27	2.53	2.52	0.32%	99.43%	0.00%
		W2/114	34.50	34.38	>27					
R2/114	UNKNOWN	W3/114	34.49	34.37	>27	2.75	2.74	0.29%	99.54%	0.00%
		W4/114	34.46	34.35	>27					
31 FITZROY STREET										
Base Floor										
R3/109	UNKNOWN	W6/109	10.16	10.16	0.00%	1.74	1.74	0.00%	30.22%	2.15%
		W7/109	9.84	9.84	0.00%					
Gnd Floor										
R7/110	UNKNOWN	W9/110	19.00	18.78	1.16%	2.93	2.91	0.82%	56.34%	3.10%
		W10/110	19.02	18.82	1.05%					
1st Floor										
R4/111	UNKNOWN	W7/111	22.44	22.27	0.76%	3.93	3.91	0.58%	96.10%	1.51%
		W8/111	22.44	22.29	0.67%					
2nd Floor										
R4/112	UNKNOWN	W7/112	27.05	26.89	0.59%	3.07	3.06	0.49%	97.93%	0.00%
		W8/112	27.09	26.95	0.52%					
3rd Floor										
R4/113	UNKNOWN	W7/113	30.81	30.66	>27	2.14	2.14	0.37%	97.93%	0.00%
		W8/113	30.84	30.70	>27					
35 FITZROY STREET										
Base Floor										
R5/109	UNKNOWN	W10/109	9.80	9.80	0.00%	1.80	1.80	0.00%	31.12%	0.37%
		W11/109	9.77	9.77	0.00%					
Gnd Floor										
R11/110	UNKNOWN	W15/110	19.14	19.06	0.42%	2.96	2.95	0.20%	58.62%	0.00%
		W16/110	19.20	19.14	0.31%					
1st Floor										
R6/111	UNKNOWN	W11/111	22.57	22.52	0.22%	4.02	4.02	0.10%	98.28%	0.00%
		W12/111	22.64	22.61	0.13%					
2nd Floor										
R6/112	UNKNOWN	W11/112	27.27	27.21	>27	3.13	3.12	0.16%	97.75%	0.00%
		W12/112	27.32	27.27	>27					

Room/Floor	Room Use	Window	%VSC			% Daylight Factor			Proposed No Sky	
			Exist	Prop	% Loss	Exist	Prop	% Loss	% of Room Area	% Loss of Existing
3rd Floor										
R6/113	UNKNOWN	W11/113	31.00	30.90	>27	2.11	2.11	0.19%	97.92%	0.00%
		W12/113	31.04	30.96	>27					
37 FITZROY STREET										
Base Floor										
R6/109	UNKNOWN	W12/109	9.74	9.74	0.00%	1.65	1.65	0.00%	34.24%	0.00%
		W13/109	9.75	9.75	0.00%					
Gnd Floor										
R13/110	UNKNOWN	W18/110	19.33	19.28	0.26%	2.78	2.78	0.11%	58.53%	0.00%
		W19/110	19.39	19.35	0.21%					
1st Floor										
R7/111	UNKNOWN	W13/111	22.74	22.72	0.09%	3.76	3.75	0.05%	97.93%	0.00%
		W14/111	22.82	22.81	0.04%					
2nd Floor										
R7/112	UNKNOWN	W13/112	27.41	27.37	>27	2.92	2.92	0.07%	97.55%	0.00%
		W14/112	27.47	27.43	>27					
3rd Floor										
R7/113	UNKNOWN	W13/113	31.18	31.12	>27	1.98	1.97	0.20%	96.48%	0.00%
		W14/113	31.23	31.17	>27					



Appendix IV



**Sunlight Analysis
Ramsey Hall
31-Jul-15**

Available sunlight as a percentage of
annual unobstructed total (1486.0 Hrs)

Room use	Window Ref	Existing %			Proposed %			% Loss of Summer	% Loss of Winter	% Loss of Total
		Summer	Winter	Total	Summer	Winter	Total			
112 WHITFIELD STREET										
1st Floor										
BEDROOM	W4/11	27.00	8.00	35.00	29.00	8.00	37.00	-7.41%	0.00%	-5.71%
2nd Floor										
BEDROOM	W4/12	35.00	10.00	45.00	37.00	11.00	48.00	-5.71%	-10.00%	-6.67%
3rd Floor										
BEDROOM	W4/13	42.00	14.00	56.00	42.00	14.00	56.00	0.00%	0.00%	0.00%
110 WHITFIELD STREET										
1st Floor										
UNKNOWN	W1/21	25.00	8.00	33.00	25.00	8.00	33.00	0.00%	0.00%	0.00%
UNKNOWN	W2/21	24.00	8.00	32.00	24.00	8.00	32.00	0.00%	0.00%	0.00%
UNKNOWN	W3/21	24.00	8.00	32.00	24.00	8.00	32.00	0.00%	0.00%	0.00%
2nd Floor										
UNKNOWN	W1/22	34.00	11.00	45.00	36.00	11.00	47.00	-5.88%	0.00%	-4.44%
UNKNOWN	W2/22	31.00	11.00	42.00	34.00	11.00	45.00	-9.68%	0.00%	-7.14%
UNKNOWN	W3/22	31.00	11.00	42.00	33.00	11.00	44.00	-6.45%	0.00%	-4.76%
3rd Floor										
UNKNOWN	W1/23	40.00	14.00	54.00	41.00	14.00	55.00	-2.50%	0.00%	-1.85%
UNKNOWN	W2/23	38.00	14.00	52.00	39.00	14.00	53.00	-2.63%	0.00%	-1.92%
UNKNOWN	W3/23	38.00	14.00	52.00	38.00	14.00	52.00	0.00%	0.00%	0.00%
102-104 WHITFIELD STREET										
Base Floor										
LKD	W1/49	16.00	3.00	19.00	15.00	3.00	18.00	6.25%	0.00%	5.26%
LKD	W2/49	13.00	0.00	13.00	12.00	0.00	12.00	7.69%	0.00%	7.69%
LKD	W3/49	16.00	3.00	19.00	15.00	3.00	18.00	6.25%	0.00%	5.26%
LKD	W4/49	13.00	0.00	13.00	12.00	0.00	12.00	7.69%	0.00%	7.69%
Gnd Floor										
LKD	W1/50	19.00	6.00	25.00	18.00	6.00	24.00	5.26%	0.00%	4.00%
LKD	W2/50	19.00	6.00	25.00	18.00	6.00	24.00	5.26%	0.00%	4.00%
LKD	W4/50	19.00	6.00	25.00	18.00	6.00	24.00	5.26%	0.00%	4.00%
LKD	W5/50	19.00	6.00	25.00	18.00	6.00	24.00	5.26%	0.00%	4.00%
1st Floor										
LKD	W1/51	25.00	8.00	33.00	24.00	8.00	32.00	4.00%	0.00%	3.03%
LKD	W2/51	25.00	8.00	33.00	24.00	8.00	32.00	4.00%	0.00%	3.03%
LKD	W3/51	25.00	8.00	33.00	24.00	8.00	32.00	4.00%	0.00%	3.03%
LKD	W4/51	25.00	8.00	33.00	24.00	8.00	32.00	4.00%	0.00%	3.03%
2nd Floor										
LKD	W1/52	30.00	11.00	41.00	31.00	11.00	42.00	-3.33%	0.00%	-2.44%
LKD	W2/52	31.00	11.00	42.00	31.00	11.00	42.00	0.00%	0.00%	0.00%
LKD	W3/52	31.00	11.00	42.00	31.00	11.00	42.00	0.00%	0.00%	0.00%
LKD	W4/52	31.00	12.00	43.00	31.00	11.00	42.00	0.00%	8.33%	2.33%
3rd Floor										
LKD	W1/53	35.00	14.00	49.00	36.00	14.00	50.00	-2.86%	0.00%	-2.04%
LKD	W2/53	35.00	14.00	49.00	36.00	14.00	50.00	-2.86%	0.00%	-2.04%
LKD	W3/53	35.00	14.00	49.00	36.00	14.00	50.00	-2.86%	0.00%	-2.04%
LKD	W4/53	35.00	14.00	49.00	36.00	14.00	50.00	-2.86%	0.00%	-2.04%



Room use	Window Ref	Existing %			Proposed %			% Loss of Summer	% Loss of Winter	% Loss of Total
		Summer	Winter	Total	Summer	Winter	Total			
94-100 WHITFIELD STREET										
Gnd Floor										
	W1/60	18.00	6.00	24.00	18.00	6.00	24.00	0.00%	0.00%	0.00%
	W2/60	18.00	6.00	24.00	18.00	6.00	24.00	0.00%	0.00%	0.00%
	W3/60	18.00	6.00	24.00	18.00	6.00	24.00	0.00%	0.00%	0.00%
	W4/60	18.00	6.00	24.00	18.00	6.00	24.00	0.00%	0.00%	0.00%
	W5/60	18.00	5.00	23.00	18.00	5.00	23.00	0.00%	0.00%	0.00%
	W6/60	18.00	6.00	24.00	18.00	6.00	24.00	0.00%	0.00%	0.00%
1st Floor										
LIVINGROOM	W1/61	21.00	6.00	27.00	21.00	6.00	27.00	0.00%	0.00%	0.00%
LIVINGROOM	W2/61	21.00	6.00	27.00	21.00	6.00	27.00	0.00%	0.00%	0.00%
BEDROOM	W3/61	21.00	6.00	27.00	21.00	6.00	27.00	0.00%	0.00%	0.00%
BEDROOM	W4/61	21.00	6.00	27.00	21.00	6.00	27.00	0.00%	0.00%	0.00%
BEDROOM	W5/61	21.00	7.00	28.00	21.00	7.00	28.00	0.00%	0.00%	0.00%
BEDROOM	W6/61	21.00	9.00	30.00	21.00	8.00	29.00	0.00%	11.11%	3.33%
LIVINGROOM	W7/61	21.00	8.00	29.00	21.00	7.00	28.00	0.00%	12.50%	3.45%
LIVINGROOM	W8/61	21.00	9.00	30.00	21.00	9.00	30.00	0.00%	0.00%	0.00%
2nd Floor										
LIVINGROOM	W1/62	26.00	9.00	35.00	26.00	9.00	35.00	0.00%	0.00%	0.00%
BEDROOM	W2/62	26.00	9.00	35.00	26.00	9.00	35.00	0.00%	0.00%	0.00%
BEDROOM	W3/62	26.00	9.00	35.00	26.00	8.00	34.00	0.00%	11.11%	2.86%
BEDROOM	W4/62	26.00	9.00	35.00	26.00	9.00	35.00	0.00%	0.00%	0.00%
BEDROOM	W5/62	26.00	10.00	36.00	26.00	10.00	36.00	0.00%	0.00%	0.00%
LIVINGROOM	W6/62	26.00	10.00	36.00	26.00	10.00	36.00	0.00%	0.00%	0.00%
3rd Floor										
LIVINGROOM	W1/63	32.00	12.00	44.00	32.00	12.00	44.00	0.00%	0.00%	0.00%
BEDROOM	W2/63	31.00	12.00	43.00	31.00	12.00	43.00	0.00%	0.00%	0.00%
BEDROOM	W3/63	31.00	12.00	43.00	31.00	12.00	43.00	0.00%	0.00%	0.00%
BEDROOM	W4/63	31.00	12.00	43.00	31.00	12.00	43.00	0.00%	0.00%	0.00%
BEDROOM	W5/63	31.00	12.00	43.00	31.00	12.00	43.00	0.00%	0.00%	0.00%
LIVINGROOM	W6/63	31.00	13.00	44.00	31.00	12.00	43.00	0.00%	7.69%	2.27%
4th Floor										
LIVINGROOM	W1/64	37.00	15.00	52.00	37.00	15.00	52.00	0.00%	0.00%	0.00%
LIVINGROOM	W2/64	37.00	15.00	52.00	37.00	15.00	52.00	0.00%	0.00%	0.00%
BEDROOM	W3/64	37.00	15.00	52.00	37.00	15.00	52.00	0.00%	0.00%	0.00%
BEDROOM	W4/64	37.00	15.00	52.00	37.00	15.00	52.00	0.00%	0.00%	0.00%
BEDROOM	W5/64	37.00	15.00	52.00	37.00	15.00	52.00	0.00%	0.00%	0.00%
BEDROOM	W6/64	37.00	16.00	53.00	37.00	16.00	53.00	0.00%	0.00%	0.00%
LIVINGROOM	W7/64	37.00	16.00	53.00	37.00	15.00	52.00	0.00%	6.25%	1.89%
LIVINGROOM	W8/64	37.00	16.00	53.00	37.00	15.00	52.00	0.00%	6.25%	1.89%
5th Floor										
	W1/65	41.00	20.00	61.00	42.00	20.00	62.00	-2.44%	0.00%	-1.64%
	W2/65	41.00	20.00	61.00	42.00	20.00	62.00	-2.44%	0.00%	-1.64%
	W3/65	41.00	20.00	61.00	42.00	20.00	62.00	-2.44%	0.00%	-1.64%
	W4/65	41.00	20.00	61.00	42.00	20.00	62.00	-2.44%	0.00%	-1.64%
	W5/65	42.00	19.00	61.00	42.00	20.00	62.00	0.00%	-5.26%	-1.64%