

POST OFFICE  
SENDING GUNS & DOWN HOUSE RD.



RAILWAY LAND

- RESIDENTIAL
- COMMERCIAL
- OPEN SPACES



LISSENDEN GARDENS WEST SIDE

PRESENTED TO  
20 JUL 1952  
TOWN PLANNING  
COMMITTEE



LISSENDEN GARDENS EAST SIDE



GORDON HOUSE ROAD NORTH SIDE

# LISSENDEN GARDENS GARAGE N.W.5

SCALE 16 FEET TO 1 INCH

MUNICIPAL L.C.C.	
No.	1103
SHOW	
21 APR 1950	
SEC.	REF TO
ACK'D	

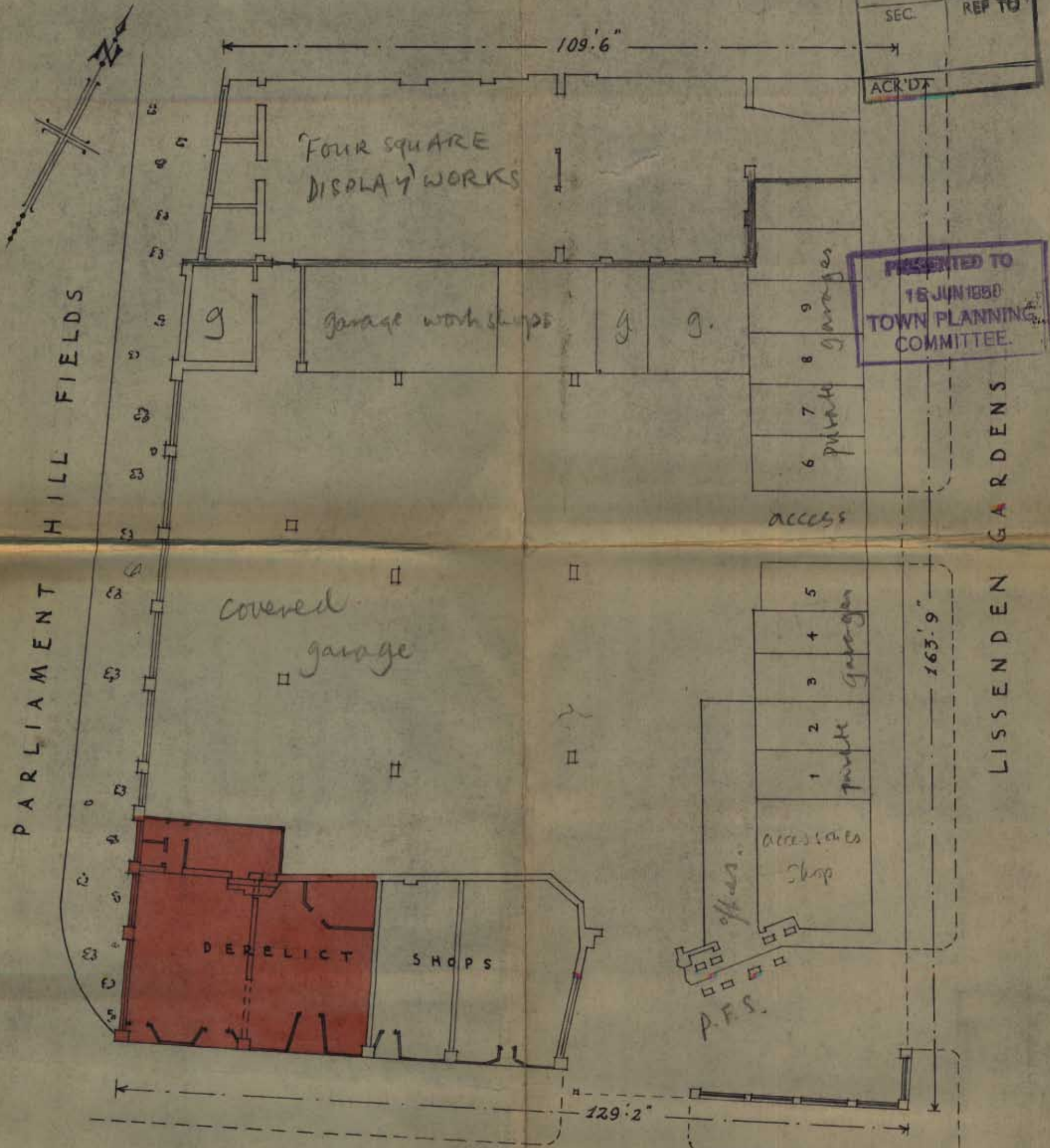

PRESENTED TO  
18 JUN 1950  
TOWN PLANNING  
COMMITTEE.

163.9"

129.2"

GORDON HOUSE ROAD

ROGERS CHAPMAN & THOMAS  
CHARTERED SURVEYORS  
36 SOUTHAMPTON STREET  
STRAND, W.C.2. 15. 4. 1950