

- The system design conforms to the requirements of the BS9251:2005
- All pipework to be Barzmaster CPVC unless stated on the drawing
- Piping above/downstream of installation valves
- All pipework to be Barzmaster CPVC unless stated on the drawing
- Piping joints and fittings
- Fittings to be Barzmaster CPVC
- Valves
- Drain and test valves up to 50mm bore to BS EN 1171
- All drain valves to have brass plugs fitted
- Sprinkler heads
- Sprinkler detector heads must be parallel with the ceiling
- The clear space below the level of the sprinkler detector to be not less than 0.5m
- Piping drainage
- Pipes must fall in the direction of the water source to enable the system to drain
- General
- Slope - Wet systems level
- Drains valves are to be installed not more than 3m above finished floor level
- Pipework to remain set colour
- Levels to contain fire of pipe except where noted
- All pipework to be bonded and earthed in accordance with the requirements of the IEE regulations
- All Builders Work requirements including cutting holes in floor, walls and floor slab by others
- All Electrical Work requirements including power supply and control wiring
- By others
- Residential Sprinklers do not accept any responsibility for damage caused by flooding conditions. Clients should take adequate precautions to prevent water in pipework, valves and equipment from freezing during severe weather
- WARNING: Sprinklers, nozzles and multiple controls MUST NOT BE PAINTED
- In accordance with BS9251:2005
- IF IN DOUBT - ASK

**General Notes**

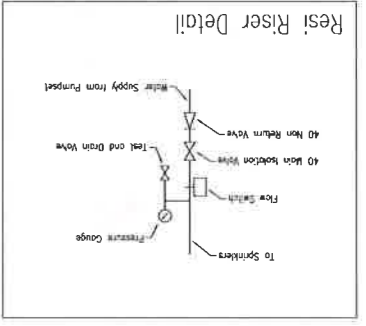
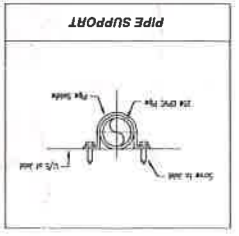

APPROVAL								
Authority	Date							
Checked by	Approved by							
Contracting Engineers								
Insurance Co.								
Fire Authority								
Building Control Officer								
SCHEDULE OF SPRINKLERS / NOZZLES								
Protected Area	Type of Area	Model	FM	Size	Temp	No. of		
Basement, Gnd, First	NFP	181	Conical	W47	15	Td	24	
EQUIPMENT SCHEDULE		Total	181					
Item		Manufacturer / Supplier	Model ref.	W47 - White	White			
Design Survey By:		REFERENCE DOCUMENTS / DRAWINGS / CALCULATIONS					Drawn By	
Checked by		Checked by					Checked by	
Checked by		Checked by					Checked by	

NEW LAYOUT

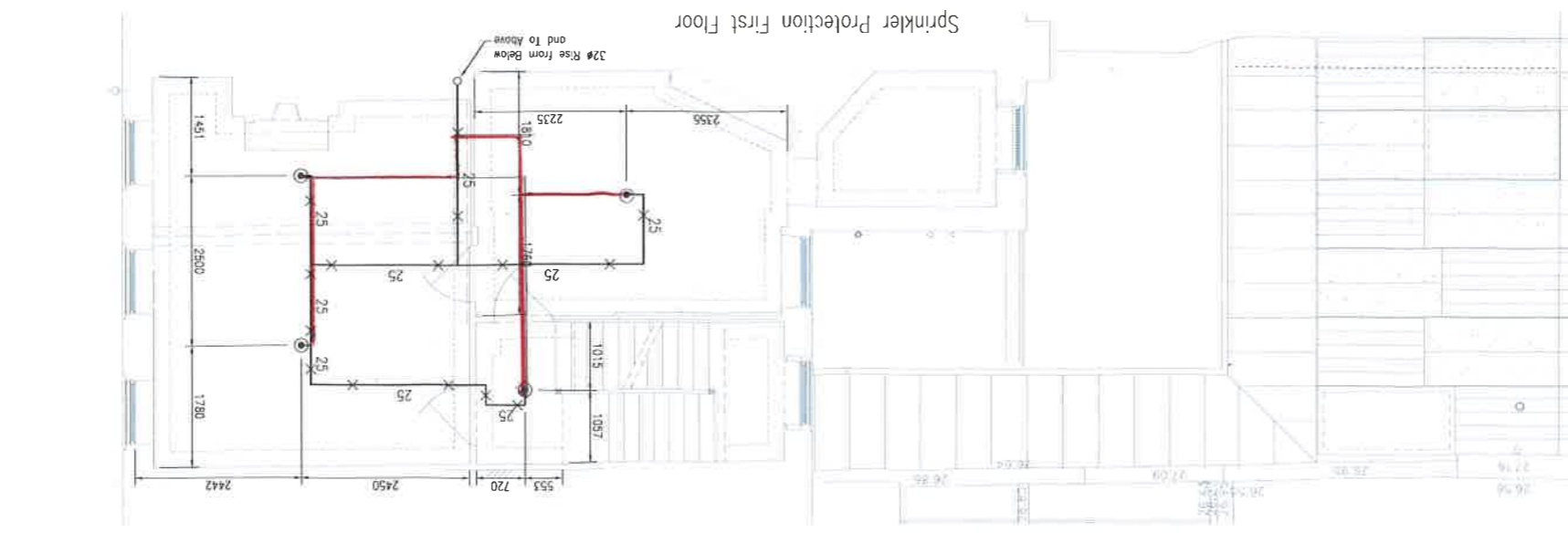
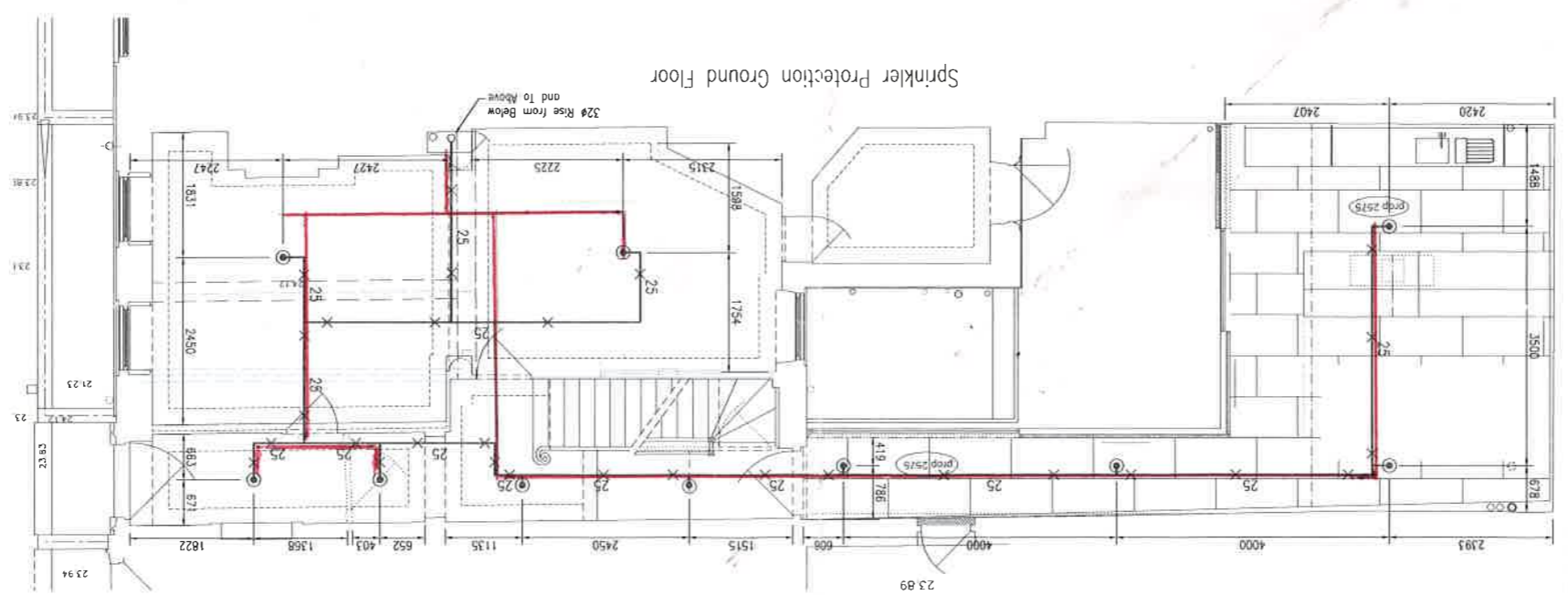
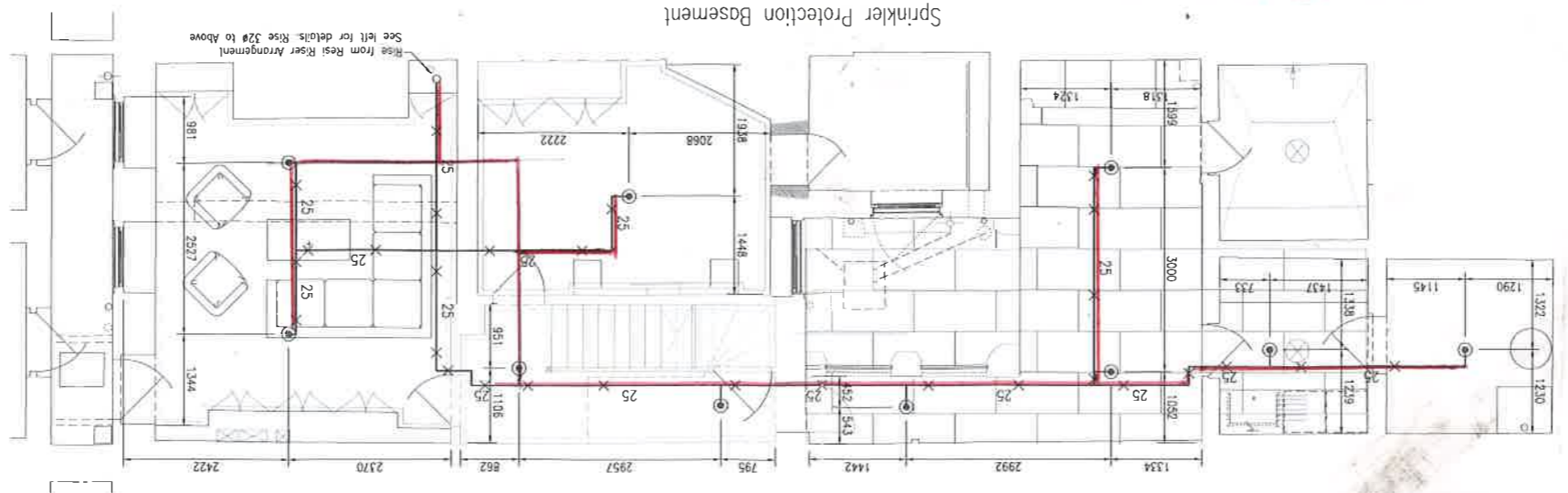

Drawing Number  
**RSS361/142-FP01**  
 Date  
 15th December 2013  
 Sheet No.  
**A1**

Drawing Title:  
 Sprinkler Protection Layout to  
 Basement, Ground and First Floors  
 Project Name and Address:  
 21 Great James Street  
 London

Residential Sprinklers Limited  
**RESIDENTIAL SPRINKLERS**  
 Ba Copthall Farm, Breakspere Road South  
 Ickenham, Middlessex, UB11 8HB  
 Telephone: 020 8864 3914  
 email: info@residential-sprinklers.co.uk

No.	Revision/Issue	DFM	CKD	DFM
A	Issued for Comment	CMW	PLM	12.13

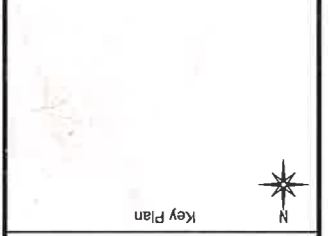

- Legend
- New Pipework
  - - - Existing Pipework
  - ⊕ Vitalluc Coupling
  - ⊕ Rise or Drop
  - ⊕ Bracket position
  - Direction of drainage
  - ⊕ Drain Valve and brass plug
  - ⊕ Centre line of pipe above soffit.
  - ⊕ Centre line of pipe below soffit.
  - ⊕ FFL or SSL (as noted)
  - ⊕ Hydraulic design point
  - Sprinkler head in upright position
  - Sprinkler head in pendant position
  - Sprinkler head on D.C rise or drop
  - Sidewall sprinkler head
  - Sprinkler head under duct/obstruction
  - Sprinkler head under duct/obstruction
  - Rate ceiling sprinkler head
  - Dry pendent sprinkler head
  - ⊕ Multiple jet control
  - ⊕ Plug

Design Data

Designed in accordance with:  
 BS9251:2005 Domestic

Building Occupancy:  
 Installation size and type:  
 Hazard classification:  
 Property/Life Safety:  
 Design Density:  
 Area of operation (AMA):  
 Category of goods:  
 Storage height/Stack type:  
 Pipe tables:  
 Design flow rate:  
 Height of highest sprinkler above 'C' gauge:

- General Notes**
- The system design conforms to the requirements of the BS9251:2005
  - Piping above/downstream of installation valves
  - All pipework to be Blazemaster CPVC unless stated on the drawing
  - Fittings to be Blazemaster CPVC
  - Fittings to be Blazemaster CPVC as per Blazemaster Guidelines
  - Valves
  - Drain and test valves up to 50mm bore to BS EN 1171
  - All drain valves to have brass plugs fitted
  - Sprinkler heads
  - Sprinkler deflector plates must be parallel with the ceiling
  - The clear space below the level of the sprinkler deflector to be not less than 0.5m
  - Piping drainage
  - Pipes must fall to drain in the direction of the water source to enable the system drain valves to be tested not more than 2m above finished floor level
  - Slope - Wet systems level
  - General
  - Pipework to remain set colour
  - All pipework to be bonded and earthed in accordance with the requirements of the IEE regulations
  - Levels to centre line of pipe except where noted
  - Residential Sprinklers do not accept any responsibility for damage caused by firework, valves and equipment from freezing during severe weather
  - WARNING: Sprinklers, nozzles and multiple controls MUST NOT BE PAINTED
  - In accordance with BS9251:2005
  - IF IN DOUBT - ASK

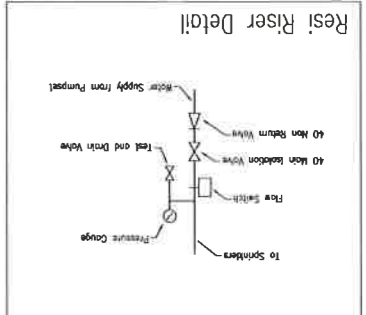
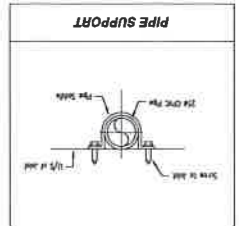

APPROVAL	
Authority	Date
Client	Approved by
Architect	Contracting Engineers
Insurance Co.	Manufacturer / Supplier
Fire Authority	Water Authority
Building Control Officer	Sprinkler Head
Item	Manufacturer / Supplier
Equipment Schedule	Manufacturer / Supplier
Quantity	Value
Basement, Gnl. First	Value
Second	Value
Third	Value
Total	Total
1257002	rev A
1257003	rev A
1257002	rev A
1257003	rev A

NEW LAYOUT

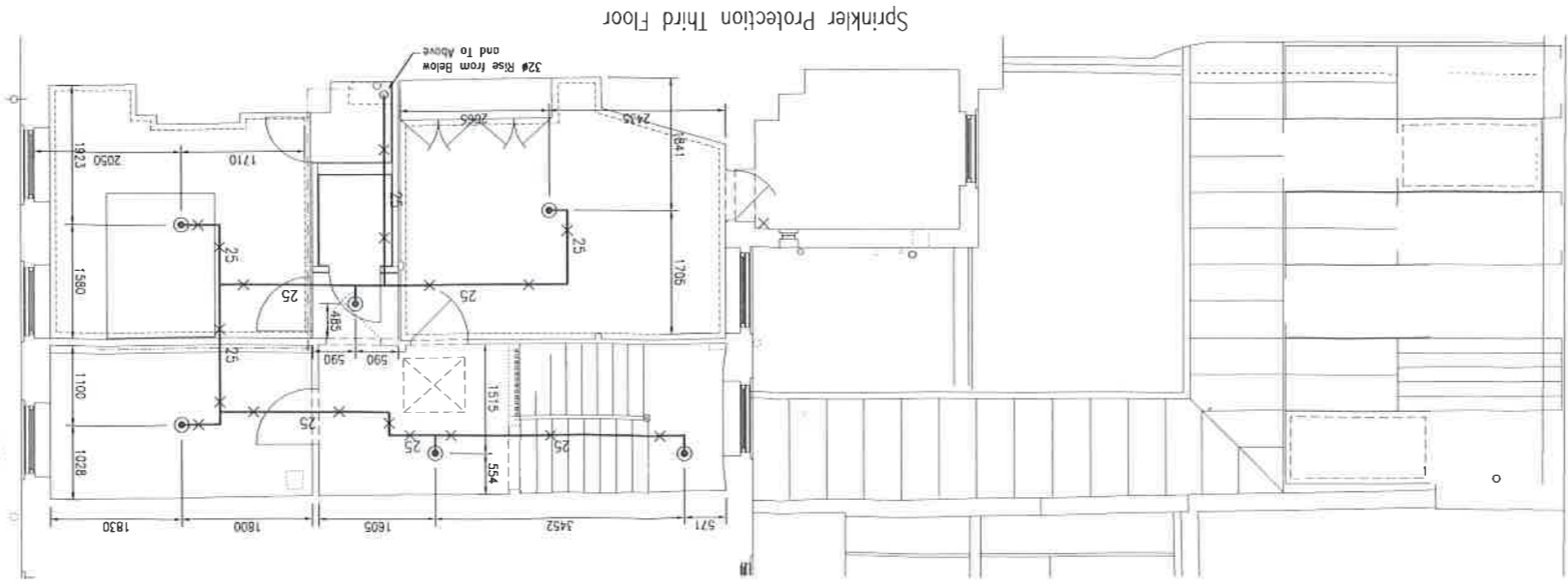
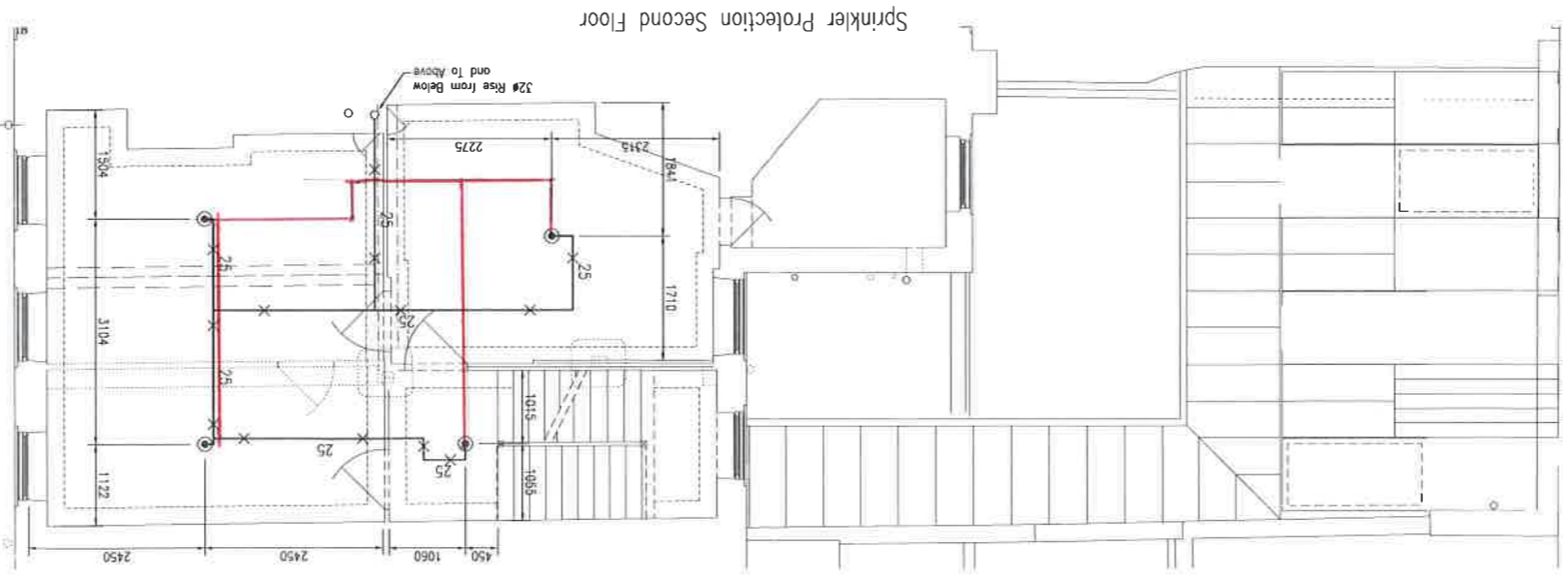

LAYOUT OK

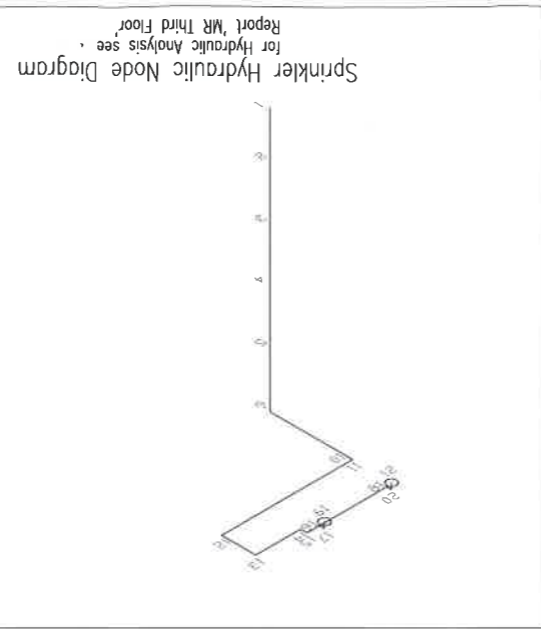

**Design Data**  
Designed in accordance with: BS9251:2005 Domestic

**Legend**

- New Pipework
- Existing Pipework
- Victualic Coupling
- Rise or Drop
- Bracket position
- Direction of drainage
- Drain Valve and brass plug
- Centre line of pipe below
- 180
- 4130
- Centre line of pipe above
- F.L. or S.L. (as noted)
- Hydraulic design point
- Sprinkler head in upright position
- Sprinkler head in pendant position
- Sprinkler head on DC rise or drop
- Sidewall sprinkler head
- Sprinkler head under duct/obstruction
- Dry pendant sprinkler head
- Multiple jet control
- Plug

**Design Data**  
Building Occupancy: Domestic  
Installation Number:  
Installation size and type:  
Hazard classification:  
Property/Life Safety:  
Design Density:  
Area of operation (AMAO):  
Category of goods:  
Storage height/Stack type:  
Pipe labels:  
Design flow rate:  
Height of highest sprinkler above 'C' gauge:

**Key Plan**

Project Name and Address:  
21 Great James Street  
London

Drawing Title:  
Sprinkler Protection Layout to Second and Third Floors

Scale: 1:50  
Date: 15th December 2013  
Sheet Size: A1

Project Number: RSS361/142-FP02

Residential Sprinklers Limited  
6a Copthall Farm, Breakspear Road South  
Ickenham, Middlesex, UB10 8HB  
Telephone: 020 8864 3914  
email: info@residential sprinklers.co.uk

No.	Revised/Issue	DFR	CKD	DMG
A	Issued for Comment	CMW	PM	12.13