

Demolition : Typical Lightwell Rooflight | Ground Floor Plan

01 597-19442

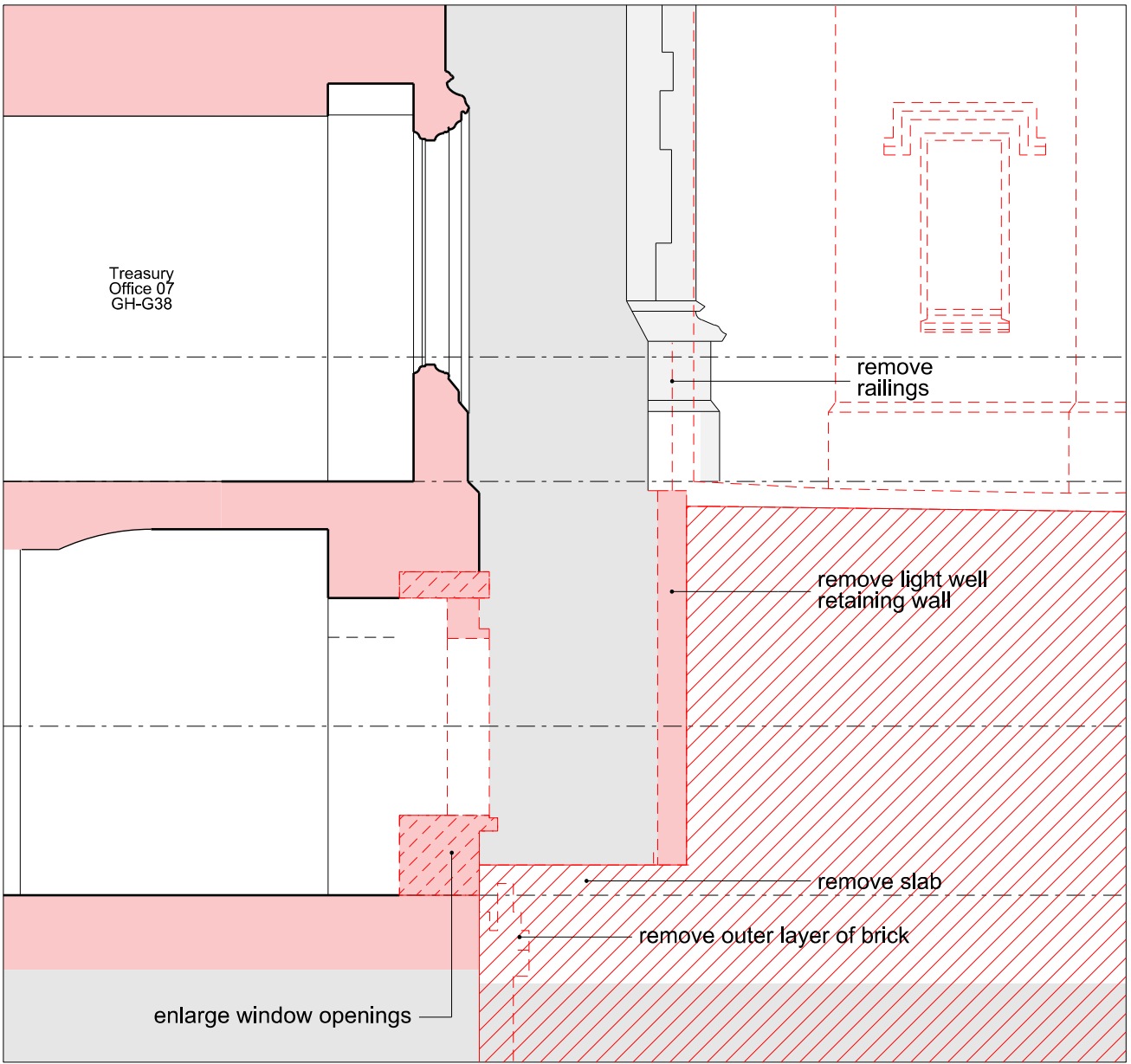

Demolition: Typical Lightwell Rooflight | Short Section

02 597-19442

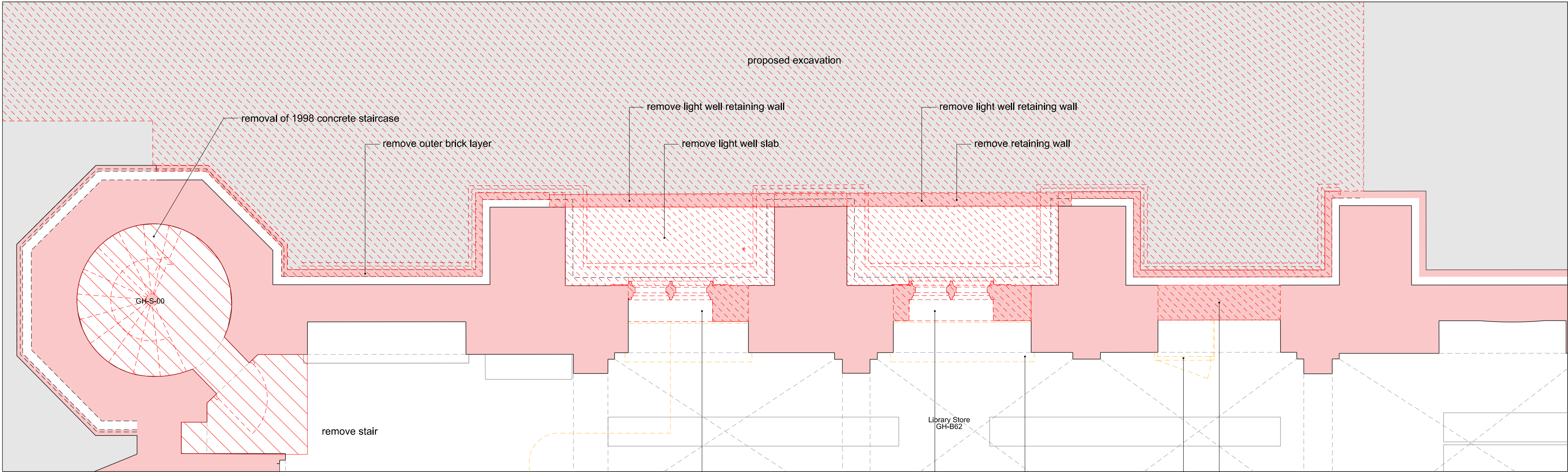

Demolition: Connections to Existing Library Storage | Basement Plan

03 597-19442

NOTES

DO NOT SCALE FROM THIS DRAWING.
CONTRACTOR TO CHECK ALL DIMENSIONS ON SITE.
ANY DISCREPANCIES TO BE REPORTED TO THE ARCHITECT IMMEDIATELY.

COPYRIGHT RICK MATHER ARCHITECTS LLP ©

Existing Walls
Demolition
Demolition of slab
Soft Strip/ Removal of Finishes
Accompanying planning applications

REVISIONS			
REV	DATE	DESCRIPTION	
PL1	28.07.15	PLANNING & LISTED BUILDING CONSENT	

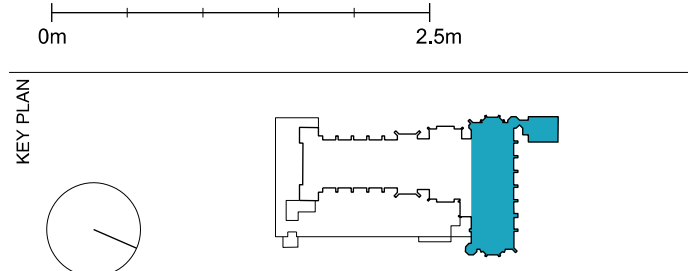

STATUS

PLANNING

RICK MATHER ARCHITECTS ©

123 Camden High Street London N1M 1JH
T: 020 7244 1121 F: 020 7244 1122
info@rickmather.com www.rickmather.com

JOB

**THE HONOURABLE SOCIETY OF LINCOLN'S INN
GREAT HALL AND LIBRARY**

TITLE

**EXISTING LIBRARY + UT HOUSE
CONNECTION TO EXISTING LIBRARY STORAGE
WITH PROPOSED DEMOLITION**

DRAWN	MT	JOB #	597	DRG #	19442	REV	PL1
CHECKED	TP	SCALE@A1	1:50 1:100	SIZE	A1 A3	DATE	JUL 15' 28.07.15