

01 | 597-19314
C - C

01 | 597-19315
D - D

NOTES
DO NOT SCALE FROM THIS DRAWING.
CONTRACTOR TO CHECK ALL DIMENSIONS ON SITE.
ANY DISCREPANCIES TO BE REPORTED TO THE ARCHITECT IMMEDIATELY.
COPYRIGHT RICK MATHER ARCHITECTS LLP ©

- Existing Walls
- Demolition/Excavation

(Outline of Great Hall Above)

Area of excavation for
East Terrace Development

C-C
01 | 597-19314

D - D
01 | 597-19315

REVISIONS			
REV	DATE	DESCRIPTION	
PL1	28.07.15	PLANNING & LISTED BUILDING CONSENT	

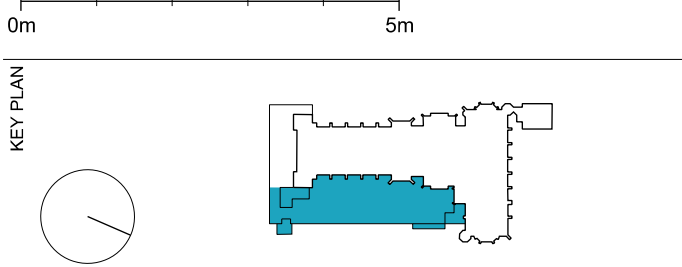

PLANNING

RICK MATHER ARCHITECTS ©			
123 Camden 14th Street London NW1 2JB T: 020 7244 1121 F: 020 7244 1122 info@rickmather.com www.rickmather.com			
JOB			
THE HONOURABLE SOCIETY OF LINCOLN'S INN GREAT HALL AND LIBRARY			
TITLE			
EXISTING EAST TERRACE LOWER BASEMENT FLOOR PLAN WITH PROPOSED DEMOLITION			
DRAWN	JOB #	DRG #	REV
CB	597	19310	PL1
CHECKED	SCALE	SIZE	DATE
TP	1:200 1:400	A1 A3	JUL15
		REV/DATE	REV
			28.07.15

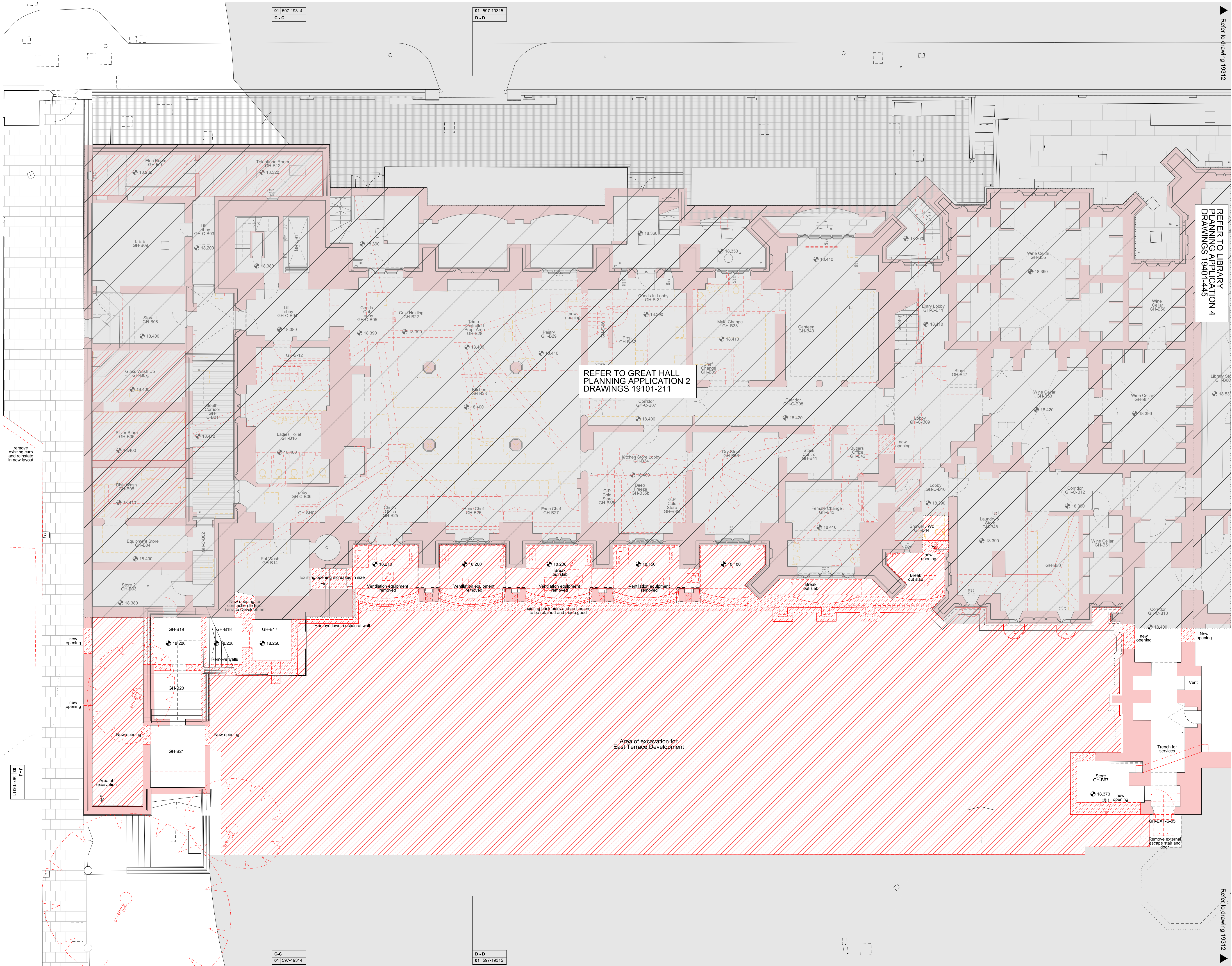

NOTES

DO NOT SCALE FROM THIS DRAWING.
CONTRACTOR TO CHECK ALL DIMENSIONS ON SITE.
ANY DISCREPANCIES TO BE REPORTED TO THE ARCHITECT IMMEDIATELY.

COPYRIGHT RICK MATHER ARCHITECTS LLP ©

Existing Walls

Accompanying planning applications

Demolition

Demolition of slab

Soft Strip

REFER TO LIBRARY
PLANNING APPLICATION 4
DRAWINGS 19401-445

REFER TO GREAT HALL
PLANNING APPLICATION 2
DRAWINGS 19101-211

Refer to drawing 19312

Refer to drawing 19312

REVISIONS

PL1	28.07.15	PLANNING & LISTED BUILDING CONSENT
REV	DATE	DESCRIPTION

KEY PLAN

0m 5m

Area of excavation for East Terrace Development

STATUS

PLANNING

RICK MATHER ARCHITECTS ©

123 Camden High Street London N1W 7SR
T: 020 7264 1121 F: 020 7264 1122
info@rickmather.com www.rickmather.com

JOB

THE HONOURABLE SOCIETY OF LINCOLN'S INN
GREAT HALL AND LIBRARY

TITLE

EXISTING EAST TERRACE
BASEMENT FLOOR PLAN - SOUTH
WITH PROPOSED DEMOLITION

DRAWN	C-B	JOB #	597	DRG #	19311	REV	PL1
CHECKED	TP	SCALE@A1	1:100 1:200	SIZE	A1 A3	DATE	JUL 15'
						REV DATE	28.07.15

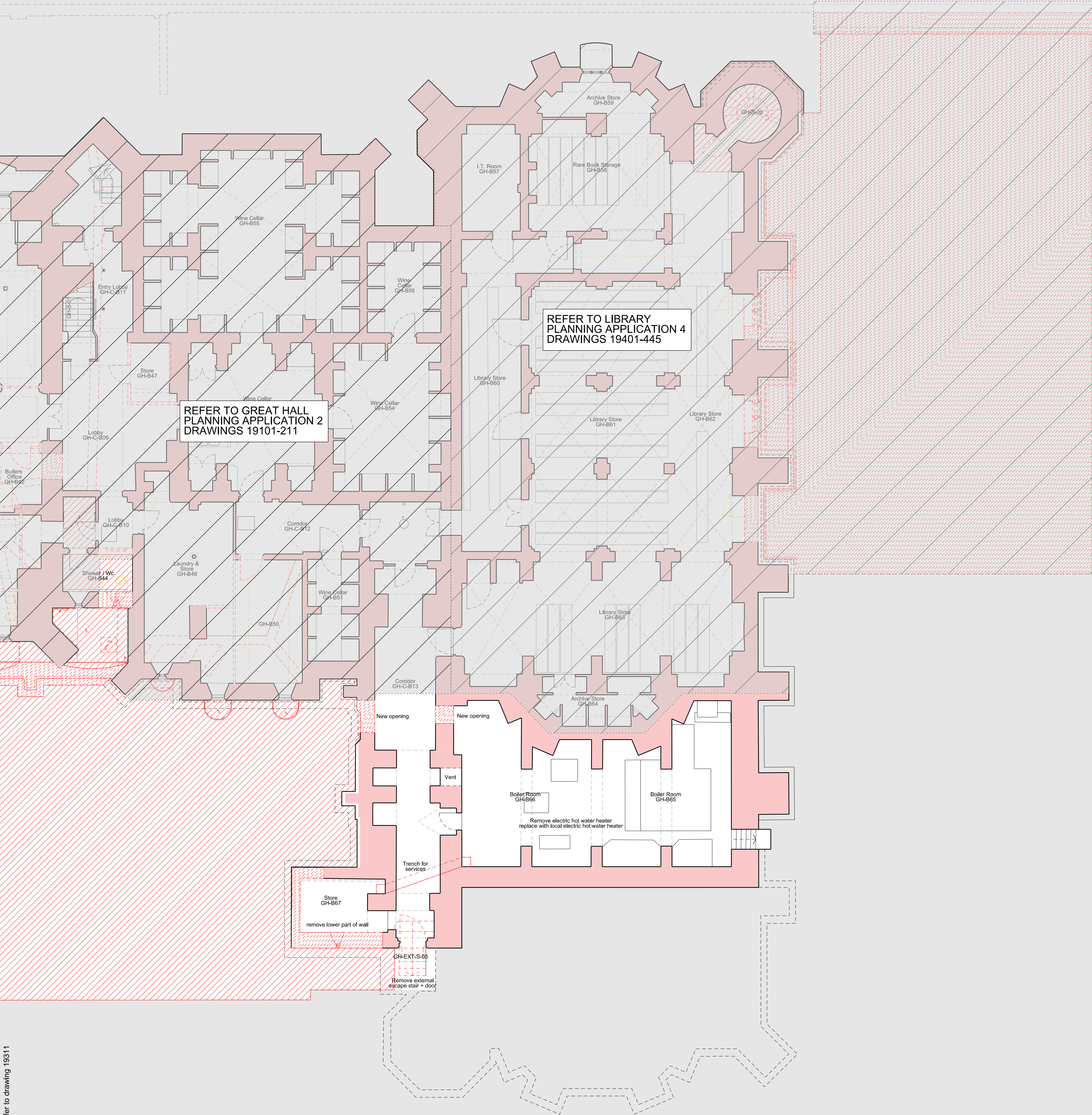

NOTES
DO NOT SCALE FROM THIS DRAWING.
CONTRACTOR TO CHECK ALL DIMENSIONS ON SITE.
ANY DISCREPANCIES TO BE REPORTED TO THE ARCHITECT IMMEDIATELY.
COPYRIGHT RICK MATHER ARCHITECTS LLP ©

- Existing Walls
- Demolition
- Demolition of slab
- Soft Strip/ Removal of Finishes
- Accompanying planning applications

REVISIONS		
REV	DATE	DESCRIPTION
PL1	28.07.15	PLANNING & LISTED BUILDING CONSENT

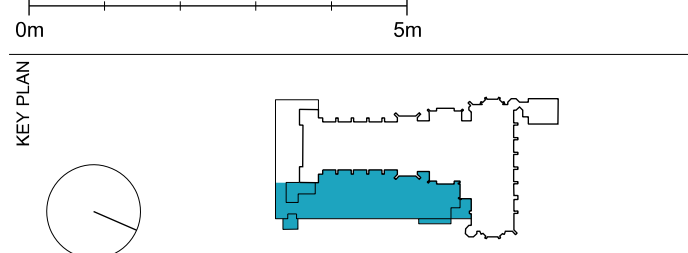

PLANNING

RICK MATHER ARCHITECTS ©				
123 Camden High Street London NW1 2JB T: 020 7261 1234 F: 020 7261 1235 info@rickmather.com www.rickmather.com				
JOB # THE HONOURABLE SOCIETY OF LINCOLN'S INN GREAT HALL AND LIBRARY				
TITLE EXISTING EAST TERRACE BASEMENT FLOOR PLAN - NORTH WITH PROPOSED DEMOLITION				
DRAWN CB	JOB # 597	DRG # 19312	REV PL1	
CHECKED TP	SCALE@A1 1:100 1:200	SIZE A1 A3	DATE JUL 15'	REV/DATE 28.07.15

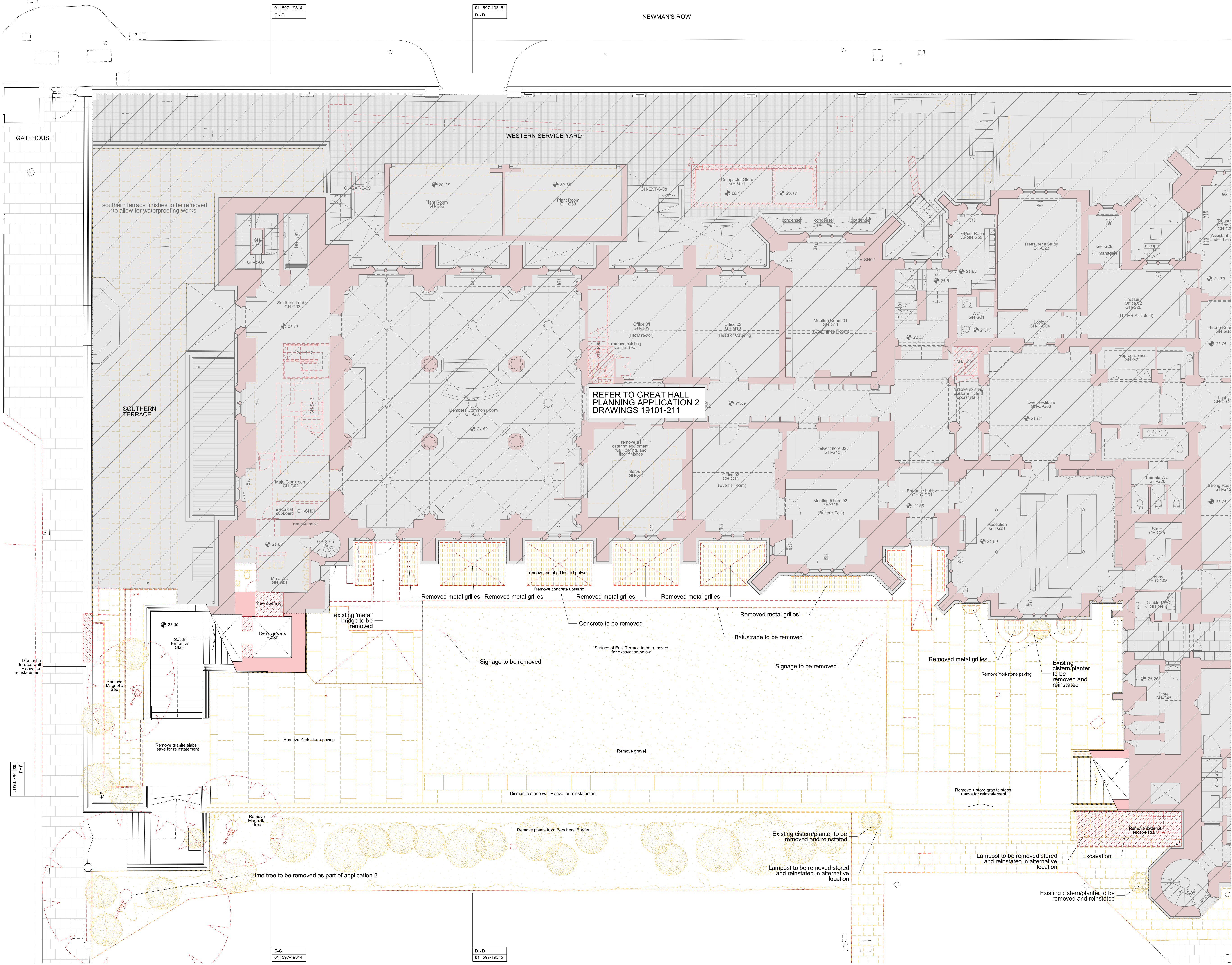

NOTES
DO NOT SCALE FROM THIS DRAWING.
CONTRACTOR TO CHECK ALL DIMENSIONS ON SITE.
ANY DISCREPANCIES TO BE REPORTED TO THE ARCHITECT IMMEDIATELY.
COPYRIGHT RICK MATHER ARCHITECTS LLP ©

- Existing Walls
- Accompanying planning applications
- Demolition
- Demolition of slab
- Soft Strip

REVISIONS			
PL1	REV	DATE	DESCRIPTION
PL1	28.07.15	PLANNING & LISTED BUILDING CONSENT	

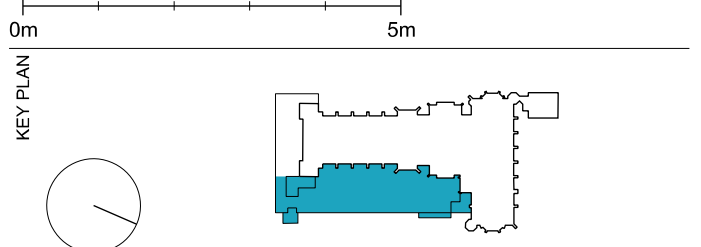

PLANNING

RICK MATHER ARCHITECTS ©			
123 Camden High Street London NW1 2RN T: 020 7244 1234 F: 020 7244 1235 info@rickmather.com www.rickmather.com			
THE HONOURABLE SOCIETY OF LINCOLN'S INN GREAT HALL AND LIBRARY			
EXISTING EAST TERRACE GROUND FLOOR PLAN - SOUTH WITH PROPOSED DEMOLITION			
DRAWN	JOB #	DRG #	REV
CB	597	19313	PL1
CHECKED	SCALE	SIZE	DATE
TP	1:100 1:200	A1 A3	JUL 15'
		REV/DATE	REV
		28.07.15	

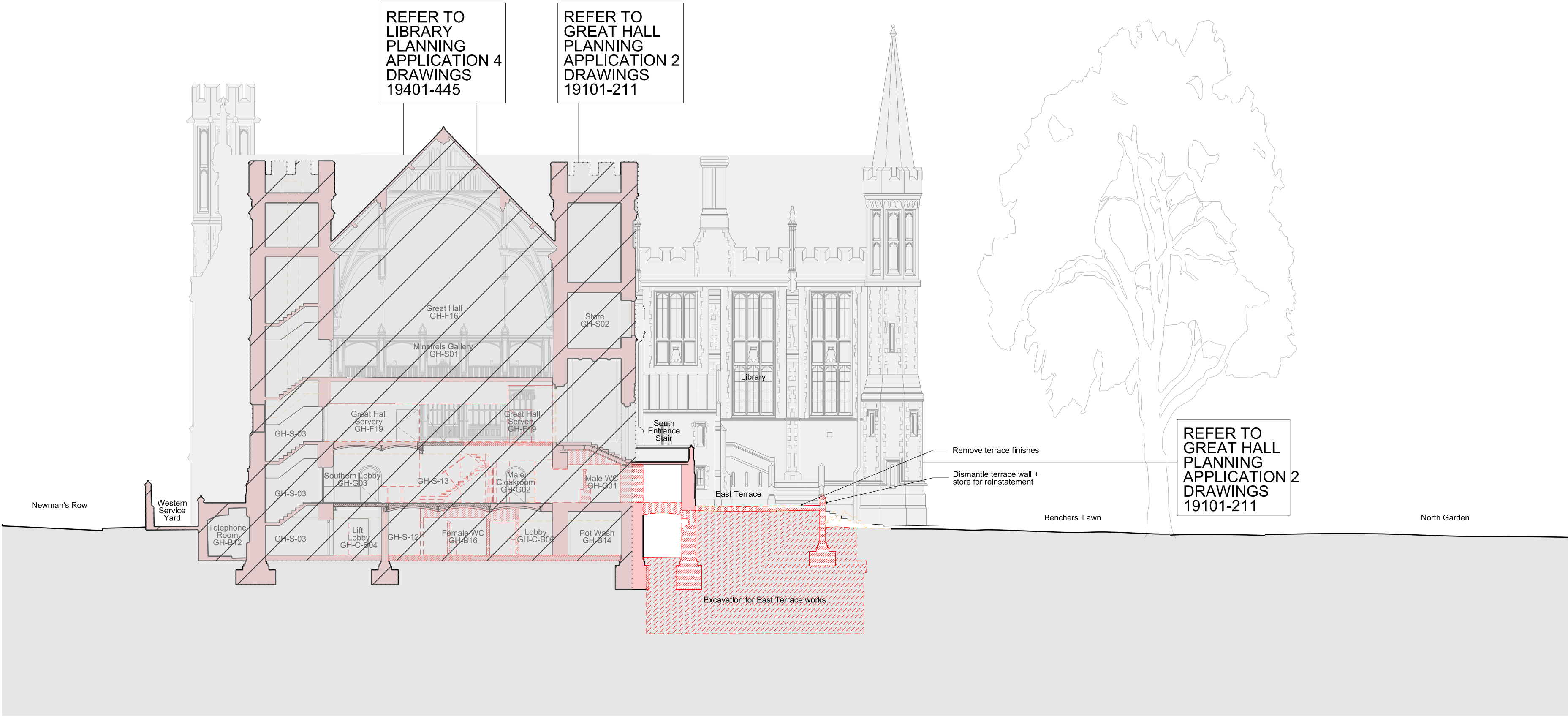

- NOTES
- DO NOT SCALE FROM THIS DRAWING.
CONTRACTOR TO CHECK ALL DIMENSIONS ON SITE.
ANY DISCREPANCIES TO BE REPORTED TO THE ARCHITECT IMMEDIATELY.
- COPYRIGHT RICK MATHER ARCHITECTS LLP ©
Text
- Existing
 - Accompanying planning applications
 - Demolition
 - Demolition of slab
 - Soft Strip

Existing Section C-C with Proposed Demolition

01 597-19314

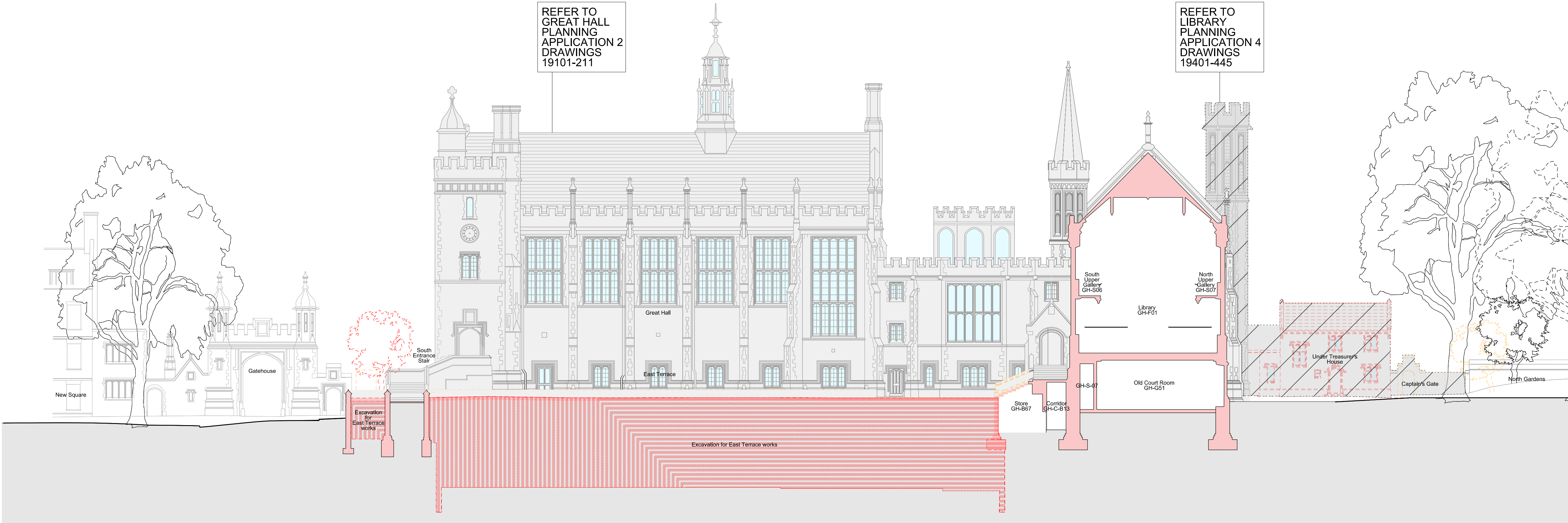

Existing Section J-J with Proposed Demolition

02 597-19314

REVISIONS

PL1	28.07.15	PLANNING & LISTED BUILDING CONSENT
REV	DATE	DESCRIPTION

KEY PLAN

STATUS

PLANNING

RICK MATHER ARCHITECTS ©

123 Camden High Street London N1W 7SR
T: 020 7244 1121 F: 020 7244 1122
info@rickmather.com www.rickmather.com

JOB

THE HONOURABLE SOCIETY OF LINCOLN'S INN
GREAT HALL AND LIBRARY

TITLE

EXISTING EAST TERRACE
SECTIONS CC & JJ
WITH PROPOSED DEMOLITION

DRAWN	JOB #	DRG #	REV
CB	597	19314	PL1

CHECKED	SCALE	SIZE	DATE	REV/DATE
TP	1:200 1:400	A1 A3	JUL 15	28.07.15

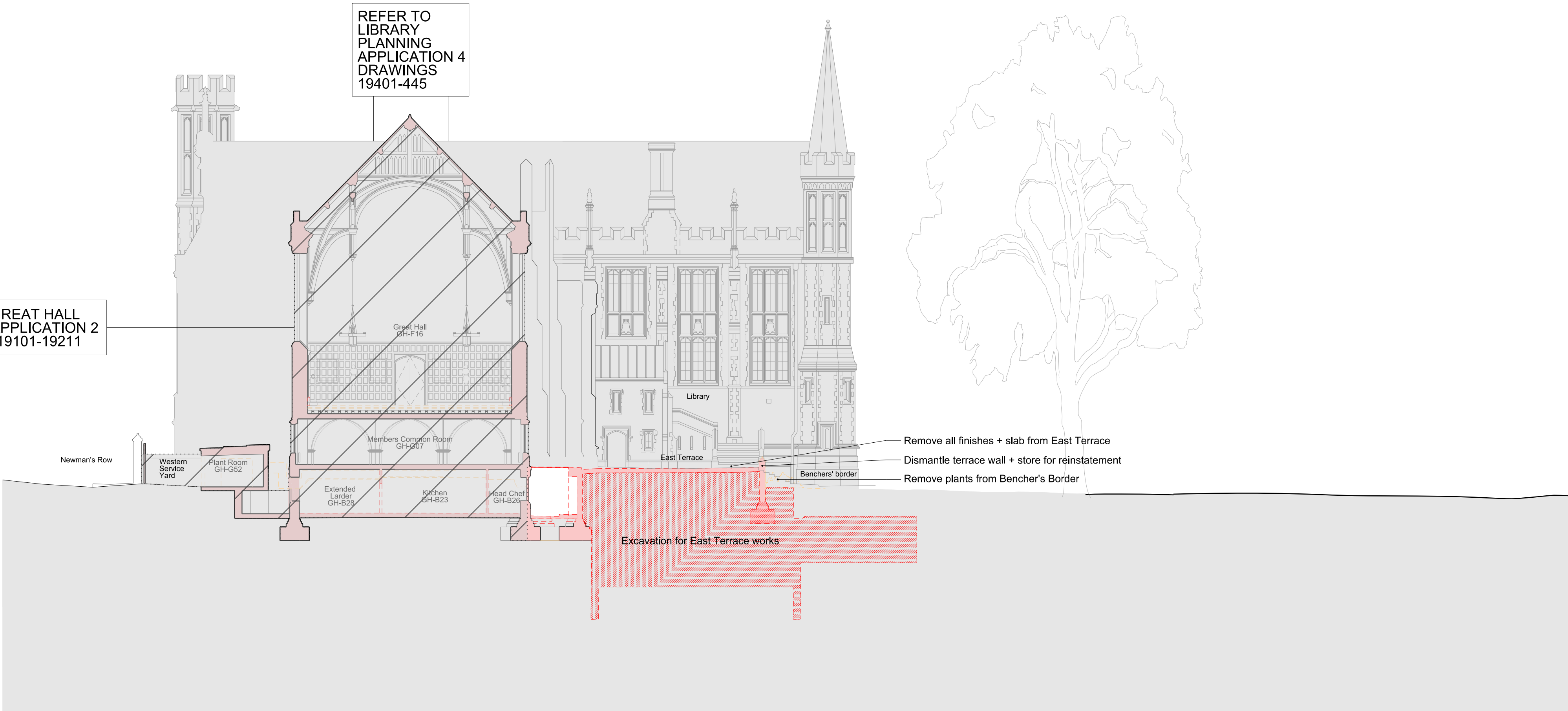

NOTES
DO NOT SCALE FROM THIS DRAWING.
CONTRACTOR TO CHECK ALL DIMENSIONS ON SITE.
ANY DISCREPANCIES TO BE REPORTED TO THE ARCHITECT IMMEDIATELY.
COPYRIGHT RICK MATHER ARCHITECTS LLP ©

- Existing
- Demolition
- Demolition of slab
- Soft Strip/ Removal of Finishes
- Accompanying Planning Applications

REVISIONS			
REV	DATE	DESCRIPTION	
PL1	28.07.15	PLANNING & LISTED BUILDING CONSENT	

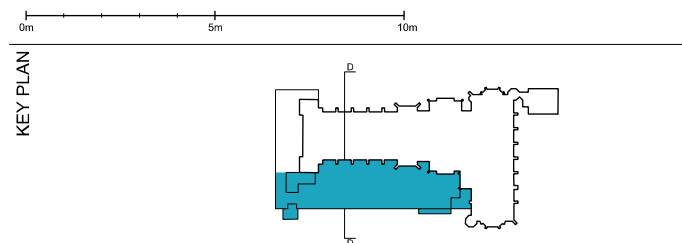

PLANNING

RICK MATHER ARCHITECTS ©					
123 Camden 14th Street London NW1 1JH T: 020 7244 1121 F: 020 7244 1122 info@rickmather.com www.rickmather.com					
JOB THE HONOURABLE SOCIETY OF LINCOLN'S INN GREAT HALL AND LIBRARY					
TITLE EXISTING EAST TERRACE SECTION D-D WITH PROPOSED DEMOLITION					
DRAWN CB	JOB # 597	DRG # 19315	REV PL1		
CHECKED KO	SCALE@A1 1:200 1:400	SIZE A1 A3	DATE JUL 15'	REV DATE 28.07.15	

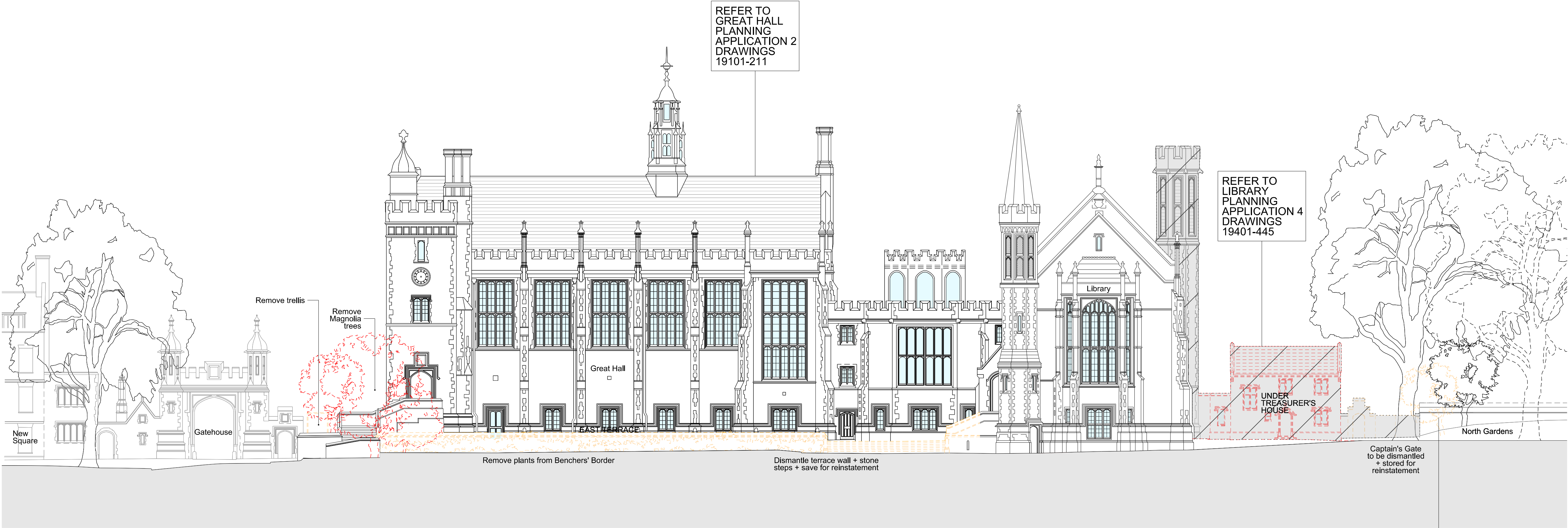

Existing East Elevation with Proposed Demolition

01 597-19316

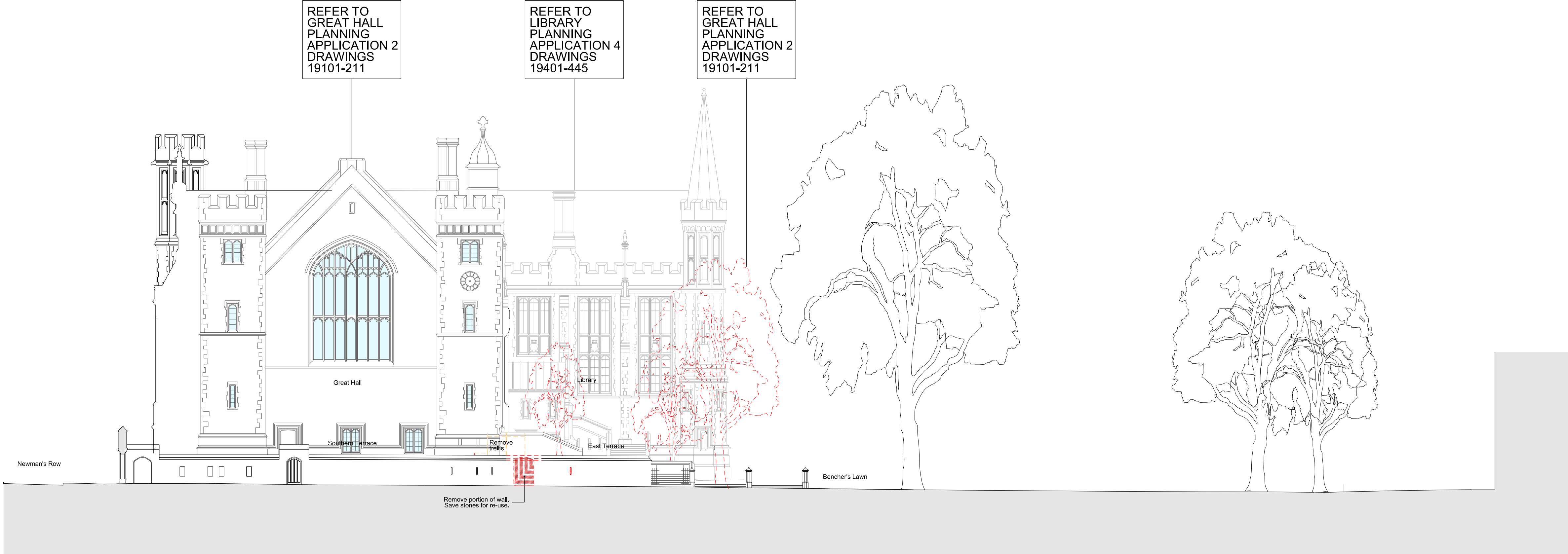

Existing South Elevation with Proposed Demolition

02 597-19316

NOTES
DO NOT SCALE FROM THIS DRAWING.
CONTRACTOR TO CHECK ALL DIMENSIONS ON SITE.
ANY DISCREPANCIES TO BE REPORTED TO THE ARCHITECT IMMEDIATELY.
COPYRIGHT RICK MATHER ARCHITECTS LLP ©

- Existing
- Demolition
- Demolition of slab
- Soft Strip/ Removal of Finishes
- Accompanying Planning Applications

REVISIONS			
REV	DATE	DESCRIPTION	
PL1	28.07.15	PLANNING & LISTED BUILDING CONSENT	

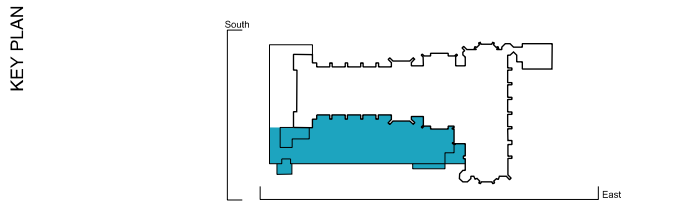

PLANNING

RICK MATHER ARCHITECTS ©

123 Camden High Street London N1W 7JH
T: 020 7244 1121 F: 020 7244 1122
info@rickmather.com www.rickmather.com

JOB
THE HONOURABLE SOCIETY OF LINCOLN'S INN
GREAT HALL AND LIBRARY

TITLE
EXISTING EAST TERRACE
EAST + SOUTH ELEVATIONS
WITH PROPOSED DEMOLITION

DRAWN	TP	JOB #	597	DRG #	19316	REV	PL1
CHECKED	CB	SCALE@A1	1:200	SIZE	A1	DATE	JUL 15'
			1:400		A3	REV DATE	28.07.15