

PLATFORM 9 3/4 EXTENSION
INTERIOR SECTIONS
 SCALE 1:20

A VERIFICATION OF ALL SITE DIMENSIONS IS RECOMMENDED PRIOR TO COMMENCEMENT OF ANY WORKS.
CONTRACTOR MUST REPORT ANY DISCREPANCIES TO LUMSDEN DESIGN & PRODUCE SETTING OUT DRAWINGS FOR APPROVAL BY LUMSDEN DESIGN.

IMPORTANT NOTE:

NOTES
 DO NOT SCALE FROM DRAWING
 ALL DIMENSIONS TO BE CHECKED AND VERIFIED ON SITE PRIOR TO MANUFACTURE OR CONSTRUCTION. CONTRACTOR TO REPORT ANY DISCREPANCIES TO LUMSDEN DESIGN IMMEDIATELY.
 CONTRACTOR TO PRODUCE SETTING OUT DRAWINGS OF ALL COMPONENTS FOR APPROVAL BY LUMSDEN DESIGN, PRIOR TO MANUFACTURE.
 ALL CONSTRUCTION, FIT OUT MATERIALS AND ELECTRICAL WORKS TO COMPLY WITH THE RELEVANT BUILDING REGULATIONS, CURRENT BRITISH STANDARDS AND CODES OF PRACTICE.
 THE DRAWING AND THE WORKS DEPICTED ARE THE COPYRIGHT OF LUMSDEN DESIGN LTD AND MAY NOT BE REPRODUCED EXCEPT BY WRITTEN PERMISSION.

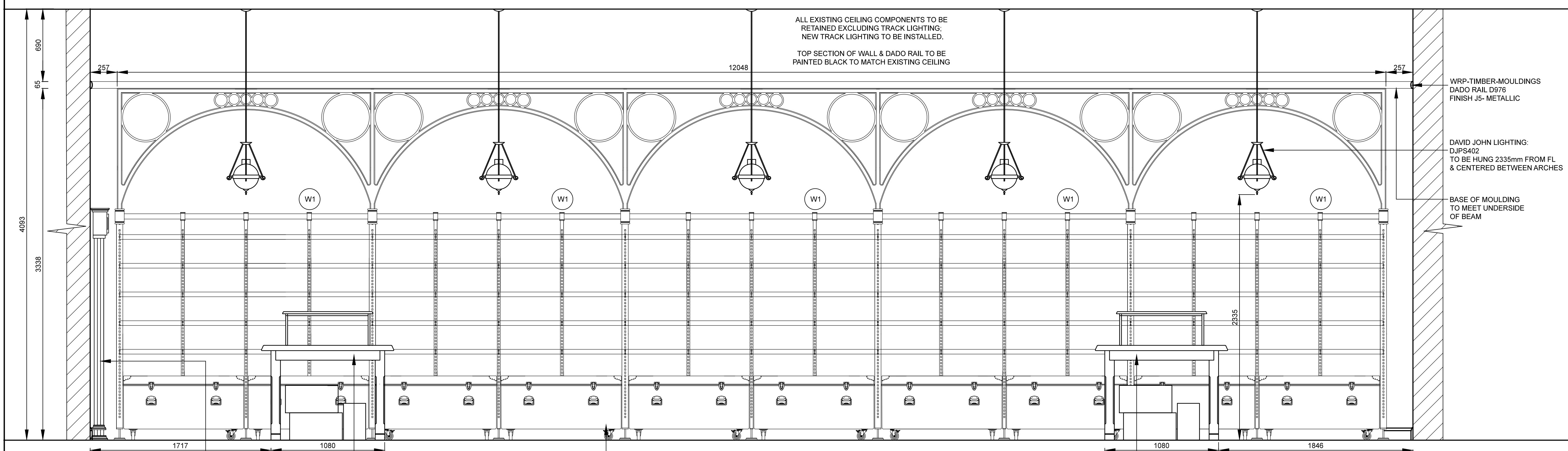

SECTION AA

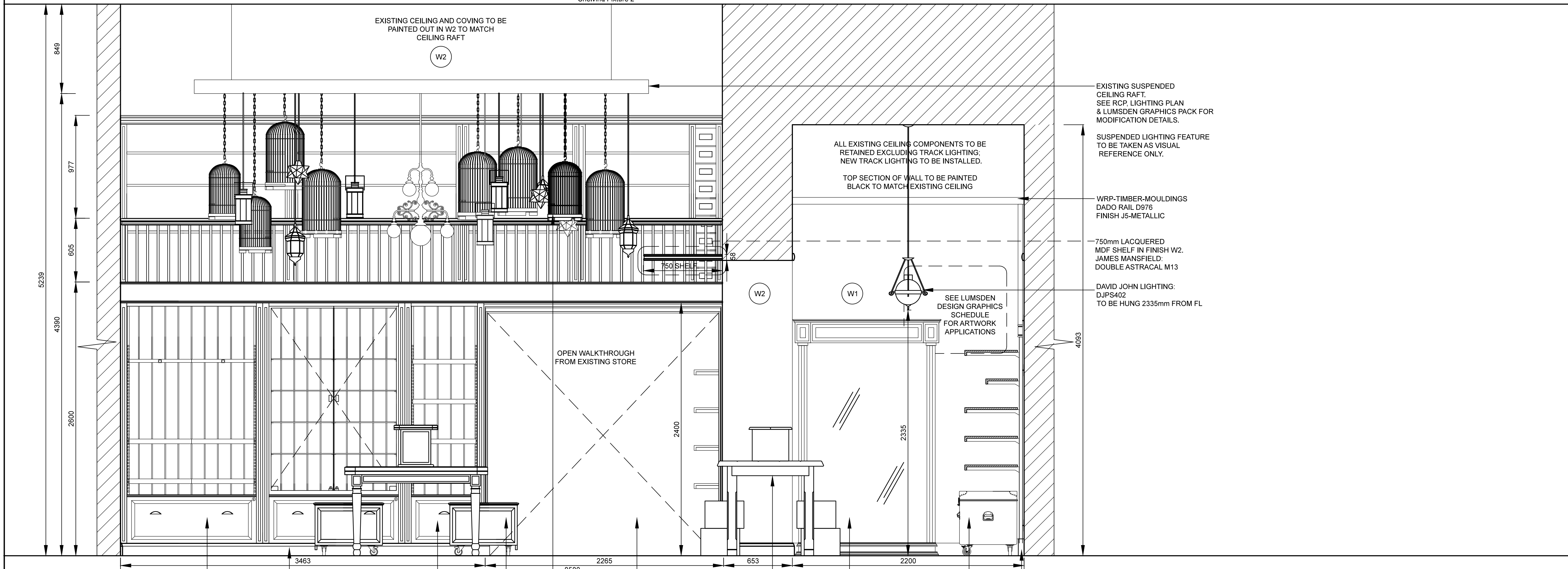

SECTION BB

MATERIALS LEGEND:

PLEASE NOTE:
 CONTRACTOR TO ADVISE & PROVIDE SAMPLES OF ALL MATERIALS FOR APPROVAL BY LUMSDEN DESIGN PRIOR TO CONSTRUCTION.

- JOINERY FINISHES**
- (J1) Blue Stained Timber
Colour to match
Dulux 90 BG 08/075
 - (J2) Reclaimed Timber
Scaffold Shelving
 - (J3) Green Stained Timber
Colour to match
Dulux 30GY 50/195
 - (J4) Dark Blue Stained Timber
Colour to match
Dulux 30BB 05/022
(Metallic effect where stated)
 - (J5) Blue Stained Timber
With Metallic Effect
Colour to match
RAL 7031
 - (J6) Red Stained Timber
Burgundy
Dulux RR50
98RR 06/206
 - (J7) Gold Leaf Distressed
Hardwood
(See ref. image
where applicable)

- METALWORK FINISHES**
- (M1) Powder coat finish to match
Grey RAL 7043
 - (M2) Powder coat finish to match
Pale Green RAL 6021
 - (M3) Mild Steel
 - (M4) Powder coat finish to match
Blue Grey RAL 7031

- WALL FINISHES**
- (W1) Brick Slips- Fast Clad:
Smeed Dean Orchard Blend.
Contact: Shaun Crosskey
shaun.crosskey@fastclad.co.uk
07966 418645
 - (W2) Dark Blue
Dulux 30BB 05/022
 - (W3) Green
Dulux 30GY 50/195

REV	DATE	DESCRIPTION	BY
A	06/24/15	EXISTING CEILINGS ADDED ELEMENTS MODIFIED	SS

Lumsden 2 Cowcross Street
 London EC1M 6DR UK
 T +44(0)20 3384 1400

CLIENT LONDON FILM MUSEUM
 PROJECT PLATFORM 9 3/4 EXTENSION
 DRG INTERIOR SECTIONS

DRG No. 076-ELE-05-0 REV A
 SCALE 1:20 @ A1 DATE JUN 15

DRAWN BY SS

INFORMATION