

notes:
Do not scale from this drawing
All dimensions to be checked on site and any discrepancies reported to the Architect/Contract Administrator before proceeding with the works on site, or off-site fabrication

**EXISTING
GROUND FLOOR
COMMERCIAL
162 SQM**

**EXISTING
UPPER FLOORS
RESIDENTIAL
160 SQM**

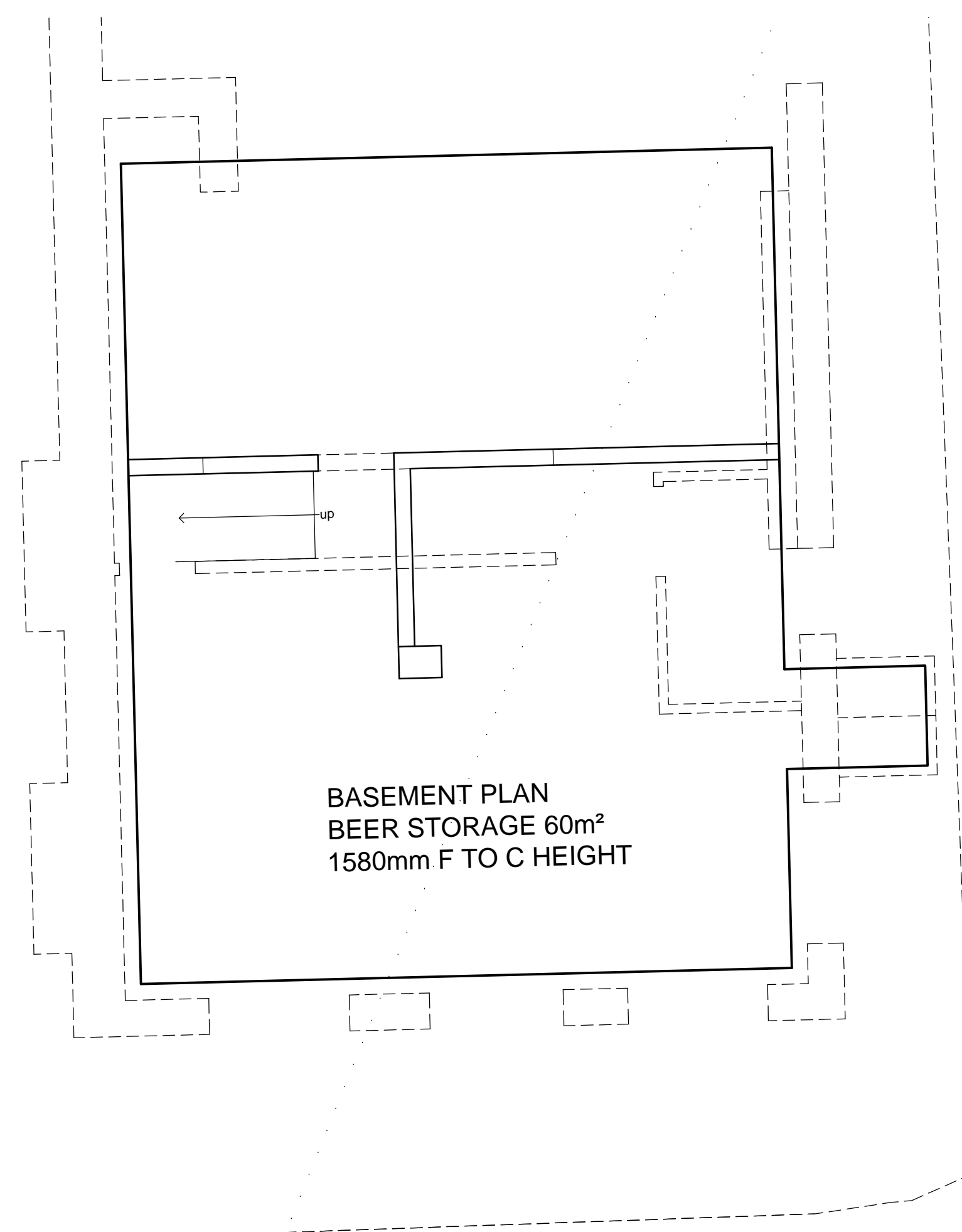

BASEMENT PLAN 1:50

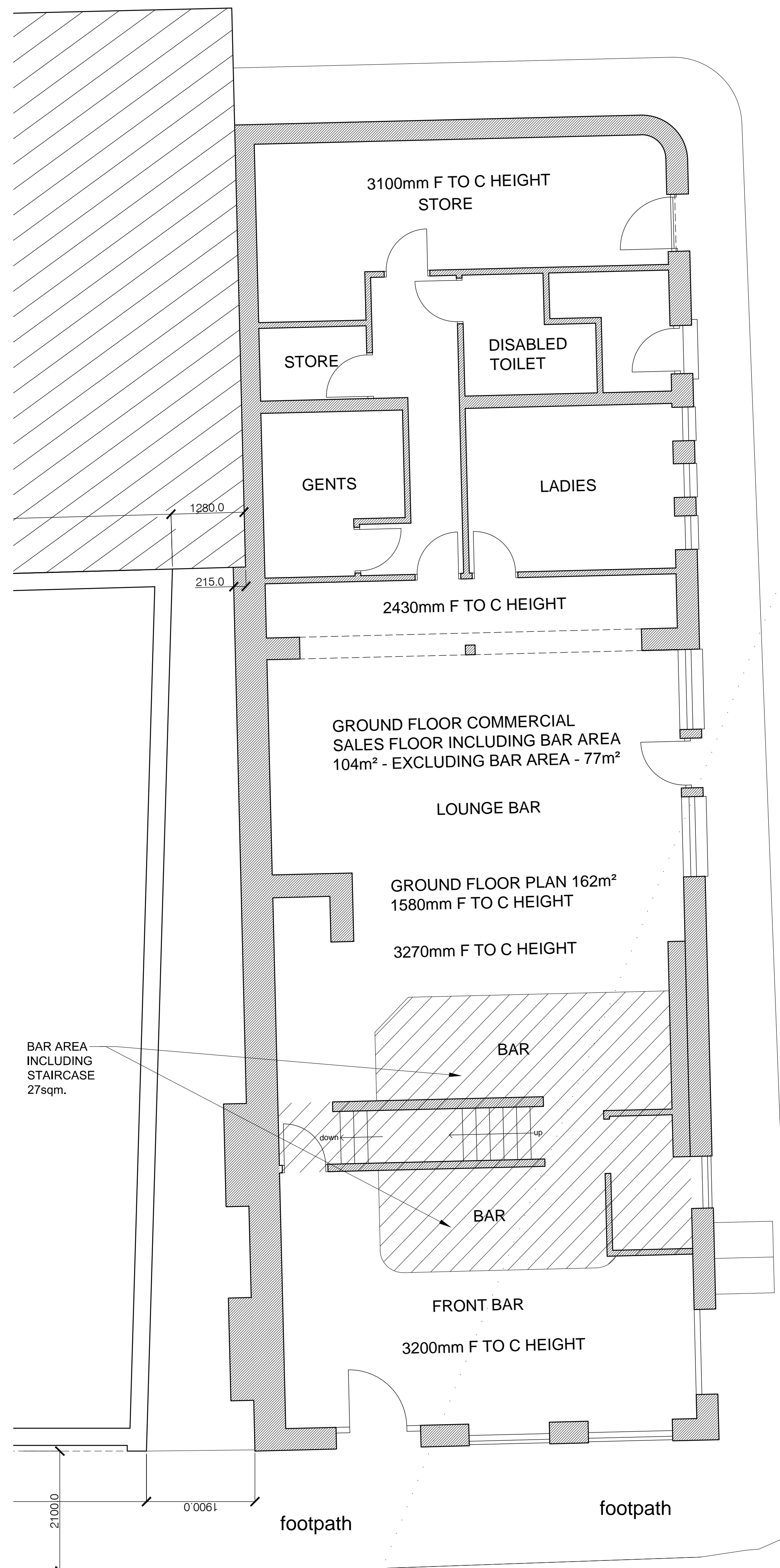

GROUND FLOOR PLAN 1:50

For Information

revision	description	date
<p>GENESIS ARCHITECTS LTD 7 St Margarets Road, Staines Abbotts Ware Hertfordshire SG12 8EP T: 01920 879908 F: 01920 879908 E: genesisarchitects@btconnect.com W: www.genesisarchitects.ltd.uk</p>		
<p>client Woodham Properties Ltd</p>		
<p>project THE ADMIRAL MANN PH LONDON N7 0BP</p>		
<p>info EXISTING BASEMENT AND GROUND FLOOR PLANS</p>		
date	scale	drawn
AUG 14	AS SHOWN	IRMB
drawing no	revision	
GAL 220 (PC) 003 /		