

ALL DIMENSIONS ARE IN MILLIMETRES UNLESS STATED OTHERWISE.

ALL DIMENSIONS ARE TO BE VERIFIED ON SITE AND CONFIRMED, BY THE CONTRACTOR, BEFORE COMMENCEMENT OF CONSTRUCTION.

IF THIS DRAWING EXCEEDS THE QUANTITIES TAKEN, IN ANY WAY, THE ARCHITECTS ARE TO BE INFORMED BEFORE THE WORK IS PUT IN HAND.

Rev	Date	Revision	By	CHK
A	20.07.15	- Partition between Kitchen/ Hall removed	AM	LM
		- Kitchen/ Living room door revised		

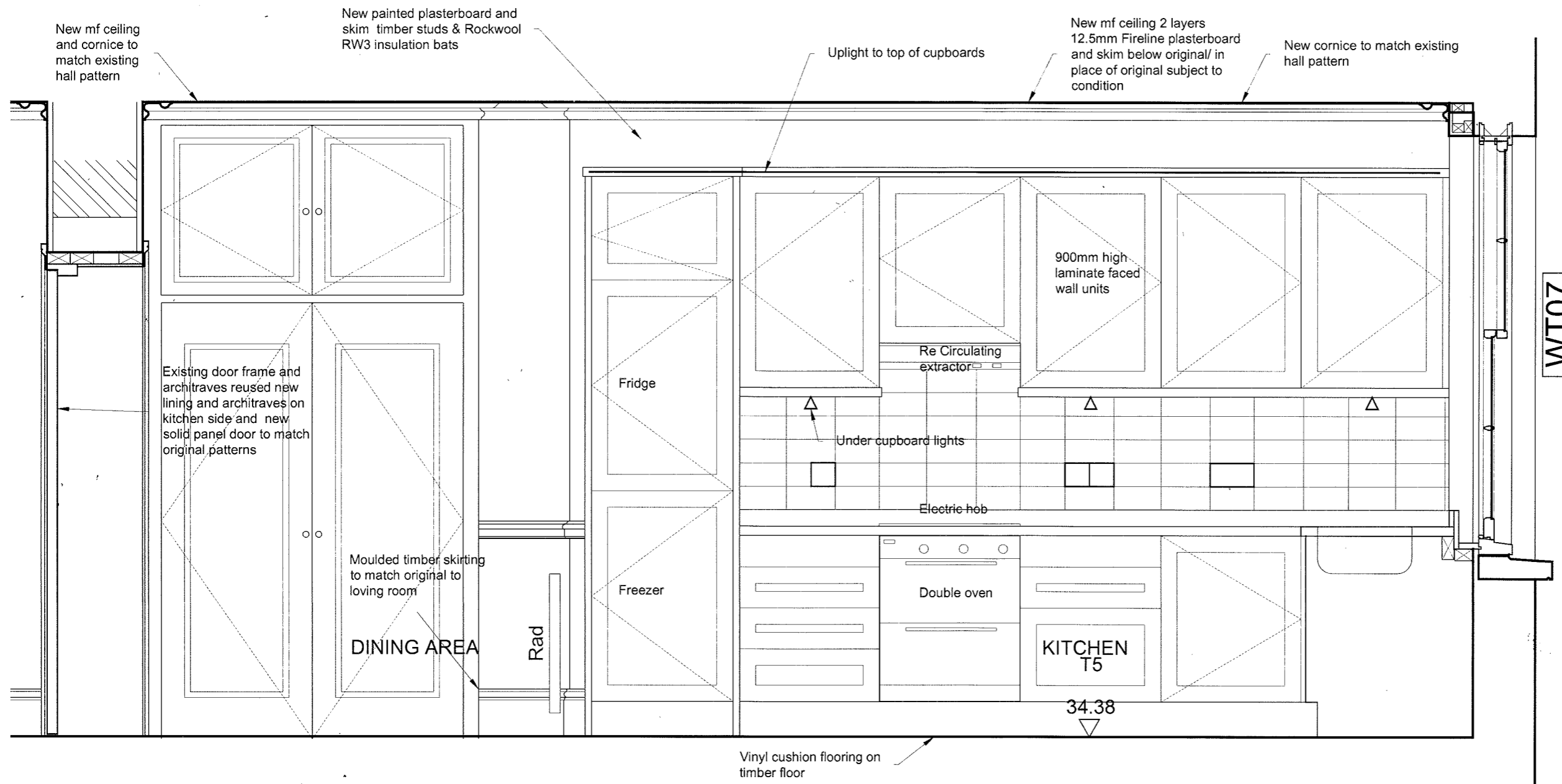

WT07

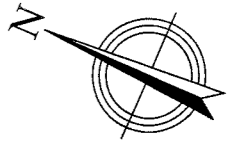

Notes

⊙0000 Denotes ceiling height

GHK ARCHITECTS

Architects · Designers · Historic Building Specialists
 Gilmore Hankey Kirke Limited ©
 Heckfield Place, 530 Fulham Road, London SW6 5NR
 Tel: +44 (0)20 7471 8000

Email: mail@ghkarchitects.co.uk
 Web: http://www.architects.co.uk
 Client
 The Honourable Society of Gray's Inn

Project Name
 No 3 Raymond Buildings
 Third Floor Flat North
 Drawing
 Proposed Kitchen
 South Elevation
 Scale
 1:20 @ A3

Drawn by
 AM 18/02/2015
 Checked by
 LM 18/02/2015
 Project No. Drawing No Revision

HK 2154 01.136 A

PROPOSED KITCHEN SOUTH ELEVATION

