

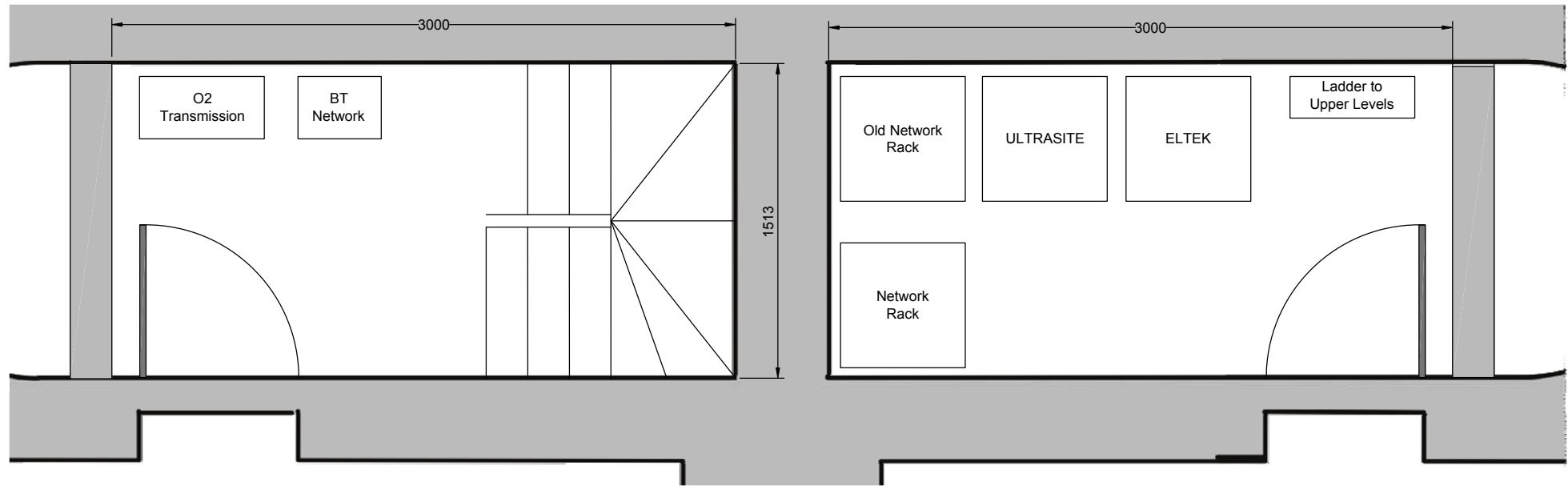

Phase 1 Equipment Room Scale 1/20



Example Photo of proposed Rack Layout

New 900, 1800, LTE800 and LTE2600 to be Located Within New 42" Rack (Two Sectors)

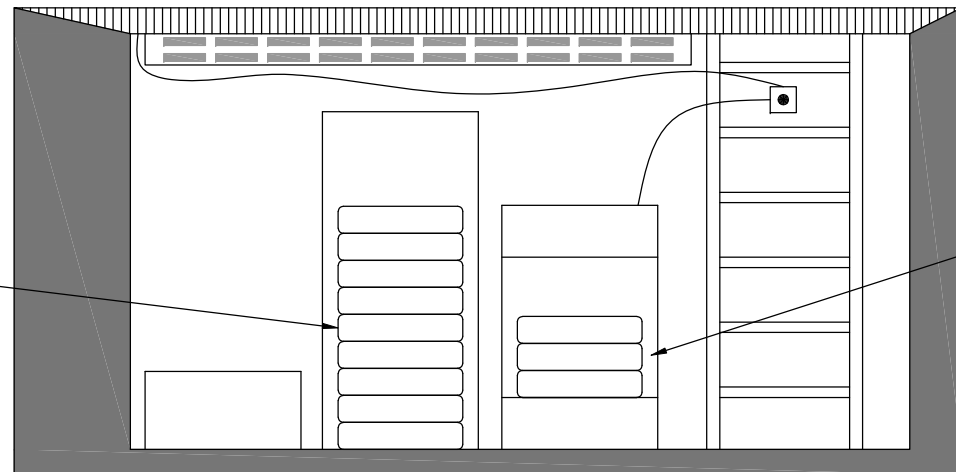

Proposed Equipment Layout Clock Tower

3G Equipment to Remain Within Eltek Rack (Two Sectors)

01	07.07.15	Issued for Comment/Approval	EO	DC	MS
Rev	Date	Description	Eng	Chk	Drn

Client	
Contract	CSR 3163 Kings Cross Station London N1C 4TB

Engineer	Eoin O'Neill	Signed	
Checked By	David Connolly	Signed	
Drawn By	Mark Sharman	Sheet Size	A3
		Scale	1:20

Title	In-Building Distributed Antenna System Ground & Mezzanine Infrastructure Drawing Equipment Room Layout
Status	Comment/Approval
Issue Date	12/06/15

Drawing No	Telefonica/STS/IB/KC/0020	Revision	01
------------	---------------------------	----------	----