

C107.1

TYPICAL COPING DETAIL OVER CLASSROOM BLOCK ALONG GRIDLINES A + A1

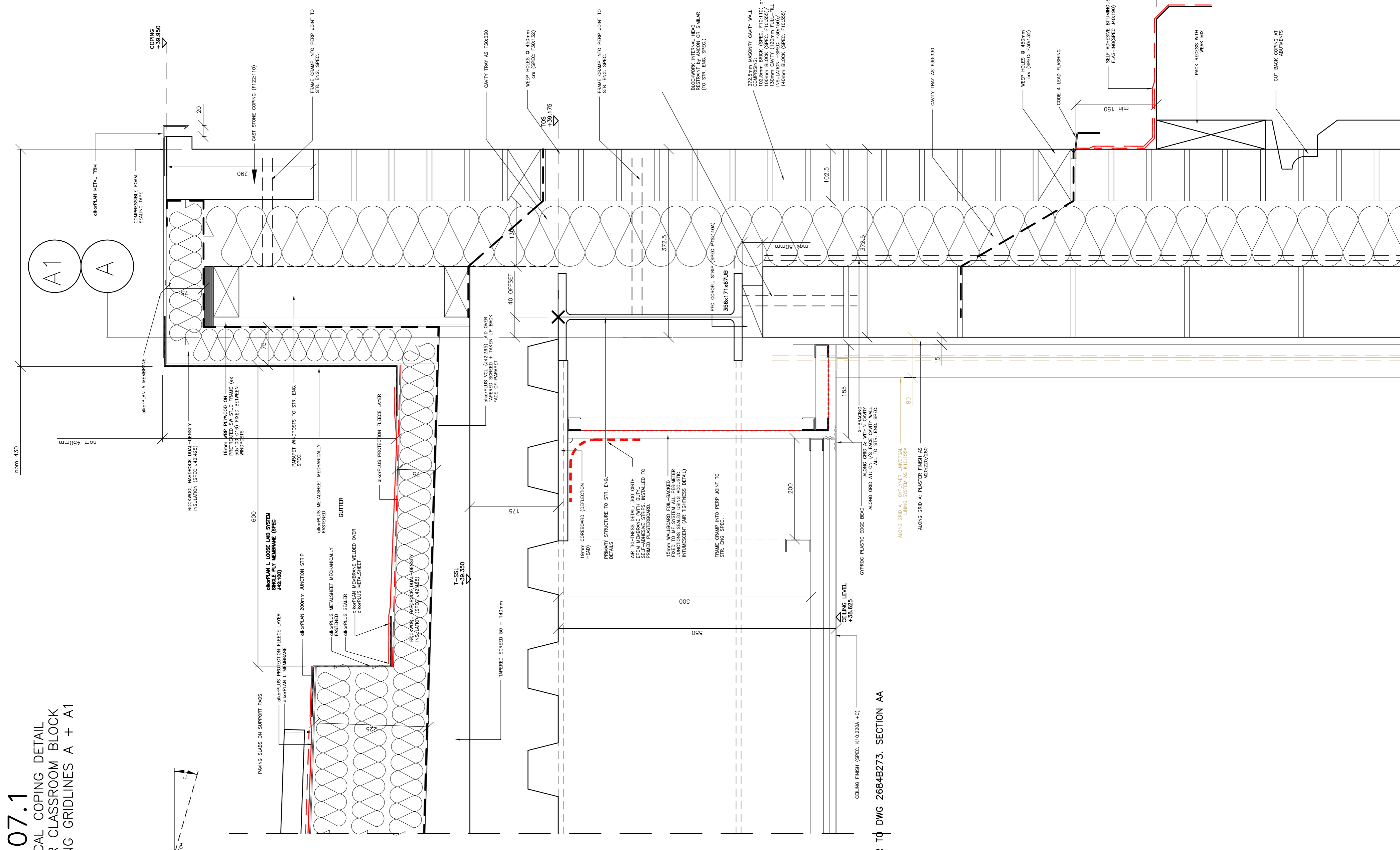

REFER TO DWG 2684B273, SECTION AA

C107.3

FIRST FLOOR/ 2ND FLOOR JUNCTION DETAIL BETWEEN WINDOW HEADS ALONG FRONT ELEVATION

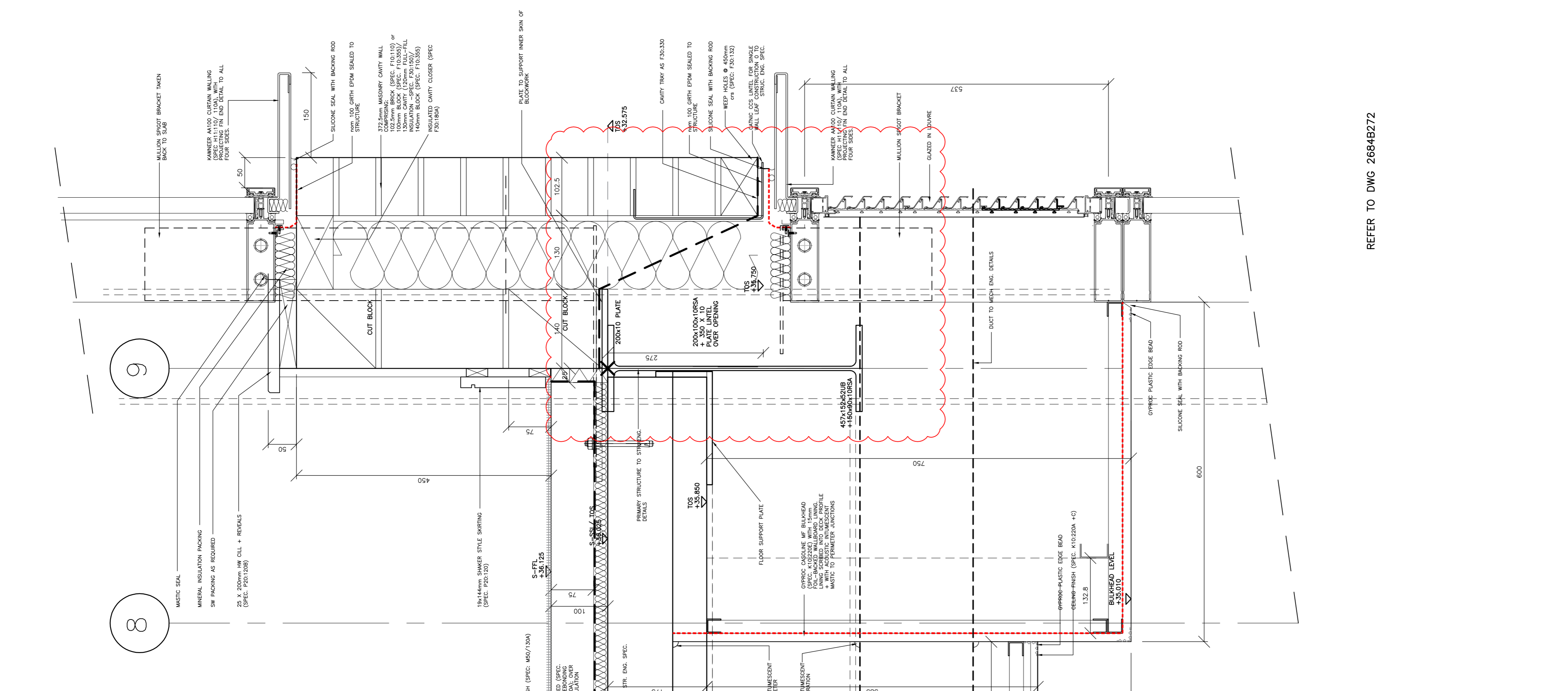

REFER TO DWG 2684B272

Revisions	
ISSUED FOR BILLING	A
C107.1: ADDITIONAL INFORMATION	NJB 02.10.14
ADDED: ISSUED FOR BILLING	B
ISSUED FOR TENDER	NJB 13.10.14
Date 08.12.14	Checked CD
ISSUED FOR CONSTRUCTION	C
YK 28.04.15	
ISSUED FOR CONSTRUCTION	D
Date 28.04.15	Checked CD
C107.3 STEEL ON GL AMENDED:	
SLAB THICKNESS AMENDED TO 175MM	CD 12.08.15

PLANNING SCHEME
CURRENT GA PLANS

Note
Do not scale from this drawing.
All dimensions to be checked on site.
Report any discrepancies to the Architect.

2684 C107 D

THE CAVENTISH SCHOOL
NEW HALL AND CLASSROOM BLOCK

CONSTRUCTION SECTION DETAILS

Scale 1:5@A1 Checked
Date SEP 14 Drawn NJB

BH & M
BARNESLEY HEWETT & MALLINSON
CHARTERED ARCHITECTS
1 White Hart Lane, London SW13 0BA
Telephone: 0181 878 4667 Fax: 0181 878 8907
e-mail: mail@bhnm.co.uk http://www.bhnm.co.uk