

Revisions	
ISSUED FOR BILLING	A
HALL GUTTER SETTING-OUT AMENDED	NJB 02.10.14
ISSUED FOR BILLING	B
COLUMNS ON GRID A1 AMENDED	NJB 13.10.14
ISSUED FOR BILLING	C
ISSUED FOR TENDER	Checked CD
Date 08.12.14	
STEEL POSITIONS UPDATED TO STRUCTURAL ENGINEERS REQUIREMENTS. PIER ADDED AF/5a.	D
ISSUED FOR CONSTRUCTION	YK
ISSUED FOR CONSTRUCTION	Checked CD
Date 28.04.15	
DEPTH OF RISER INCREASED TO ACCOMMODATE BEAM	E
ISSUED FOR CONSTRUCTION	CD 12.06.15

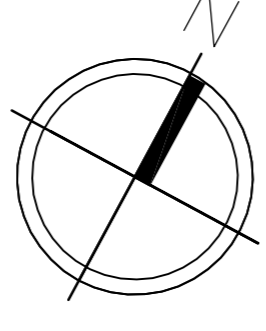

Note
Do not scale from this drawing.
All dimensions to be checked on site.
Report any discrepancies to the Architect.

2684 B212	E
THE CAVENDISH SCHOOL NEW HALL AND CLASSROOM BLOCK	
GENERAL ARRANGEMENT SECOND FLOOR PLAN PROPOSED	
Scale 1:50@A1	Checked
Date SEP 14	Drawn AB

BH & M
BARNSELY HEWETT
& MALLINSON
CHARTERED ARCHITECTS
1 White Hart Lane, London SW13 0BA
Telephone: 0181 878 4667 Fax: 0181 878 8907
e-mail: mail@bhnm.co.uk http://www.bhnm.co.uk

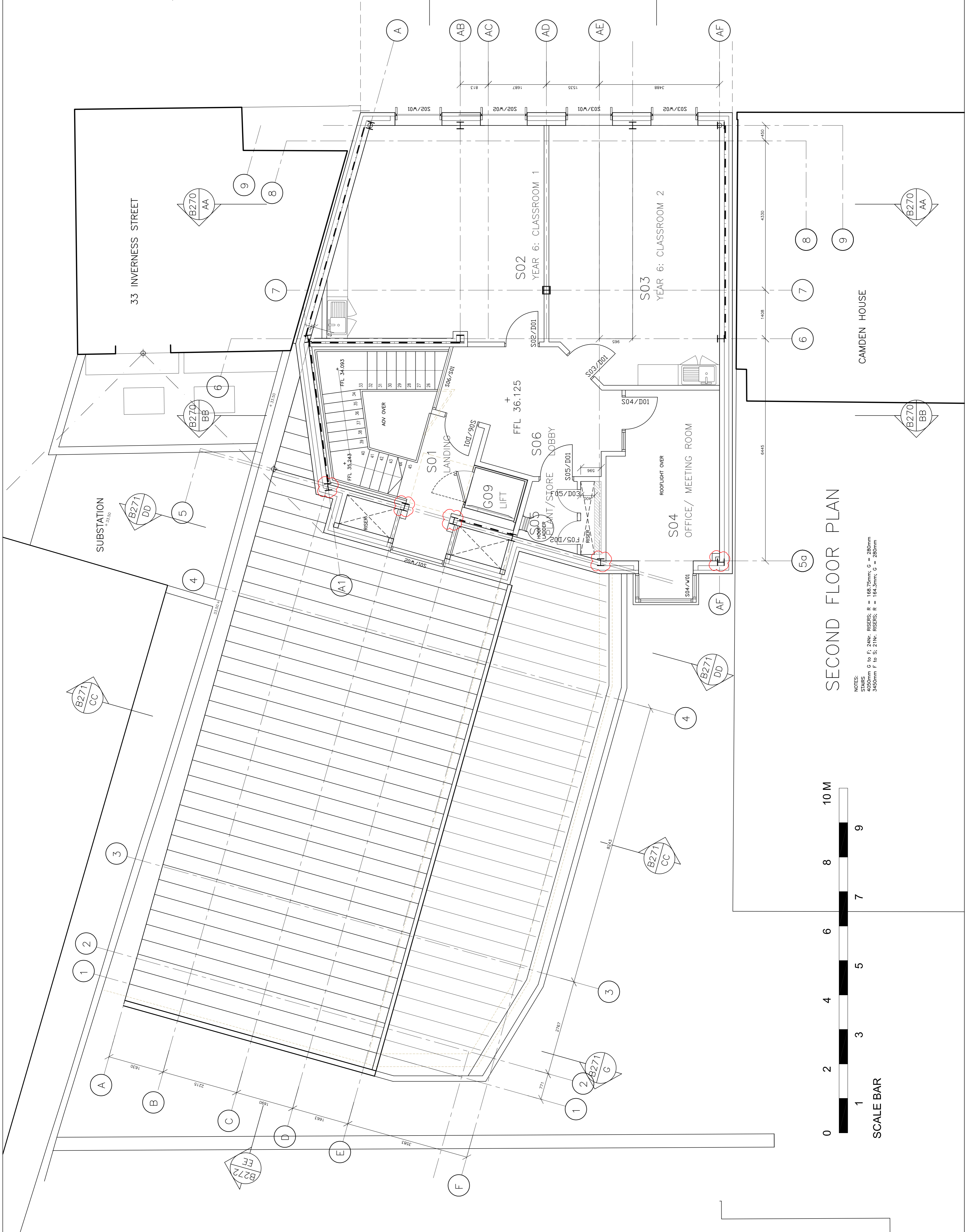

SECOND FLOOR PLAN

NOTES:
STAIRS
4050mm G to F, 24N; RISERS; R = 168.75mm; G = 280mm
3450mm F to S, 21N; RISERS; R = 164.3mm; G = 280mm

