

Stone Chambers 4 Field Court
For The Honourable Society of Gray's Inn
Existing Plan + Elevation of
Bay to North End of The
Basement Photocopy Room

Drawing No: HK2188/01.103

Scale: 1:20 @ A3

Date: 26th July 2015

Drawn: LM.

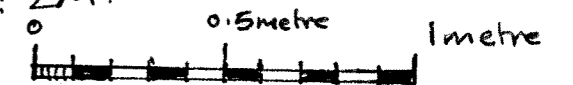

Section B-B Through Bay to North end of Photocopy Room (Existing)
Scale 1:20 @ A3

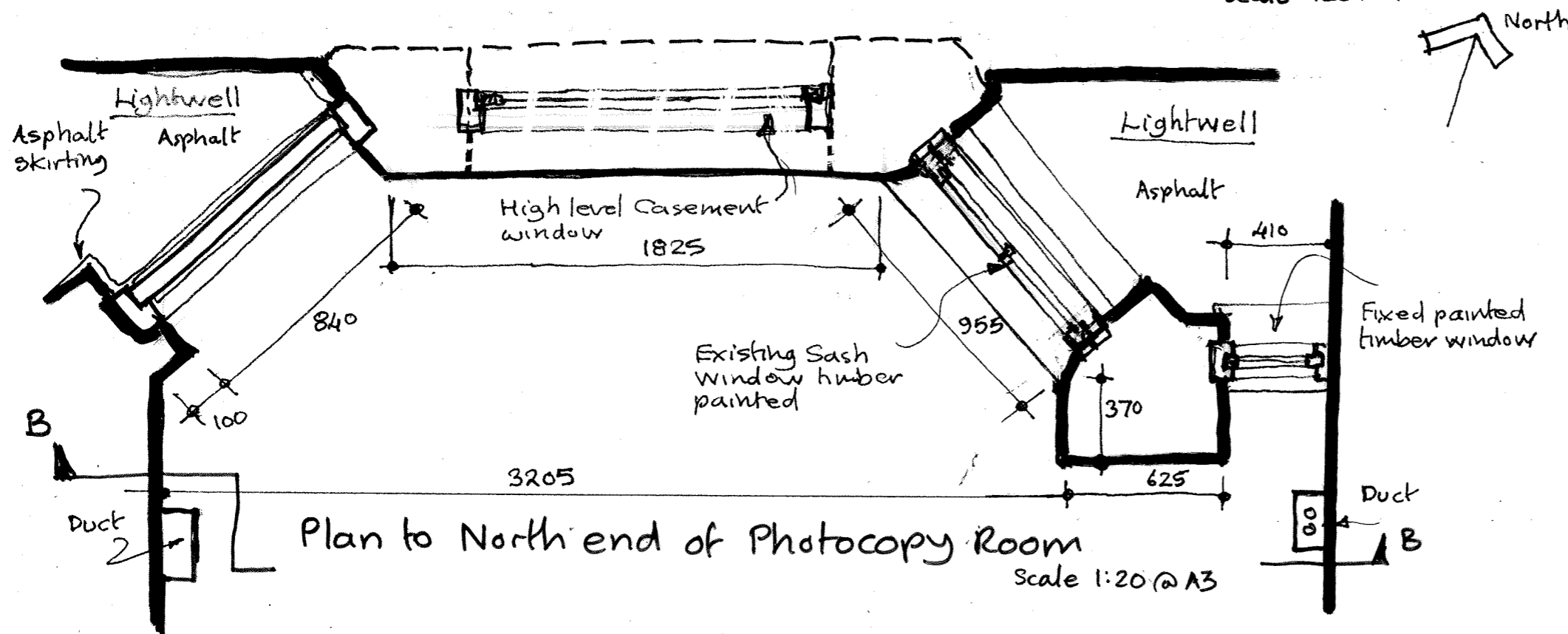

Plan to North end of Photocopy Room
Scale 1:20 @ A3