



KEY:

-  SEDUM ROOF
-  BIODIVERSE ROOF

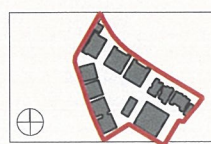

20.03.15

809_S16_GREEN
ROOF
SCOPE

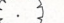

Do not scale from this drawing. Use figured dimensions only. Figured dimensions are in millimetres. All levels are in metres. All dimensions and levels shall be verified on site before proceeding with works. Detailed site survey to be carried out to verify positions and level relationships with site features and ordnance survey. Boundaries are indicative only and are to be verified by others. The architect must be notified of any discrepancy. Where building components are described in the specification as contractor designed, "construction" information relating to those components on this drawing represents design intent only.

REV	DATE	DESCRIPTION	CD	REV	DATE	DESCRIPTION	CD
P1	07.02.2014	ISSUED FOR COORDINATION	NR				
P2	02.04.2014	ISSUED FOR BARRATT/NEWCOM DEVELOPMENT AGREEMENT	NR				
P3	24.11.2014	ISSUED FOR COORDINATION	NR				
P4	29.01.2015	ISSUED FOR COORDINATION	NR				
P5	05.02.2015	ISSUED FOR COORDINATION	NR				
P6	24.02.2015	ISSUED FOR COORDINATION	NR				
P7	13.03.2015	ISSUED FOR INFORMATION	NR				

-  SITE BOUNDARY
-  RETAINED TREES
-  PROPOSED TREES (INDICATIVE)

Allies and Morrison
85 Southwark Street
London SE1 0HX
telephone 020 7921 0100
facsimile 020 7921 0101
email info@alliesandmorrison.co.uk
A&M JOB NO: 809

KIDDERPORE AVENUE
SITE ROOF PLAN
SITE DRAWINGS
~~809-S16-02-107~~
SCALE 1:250 @A1 1:500@A3

Revision