

**SITE LOCATION**  
(Scale 1:50000)

Ordnance Survey map extract based upon Landranger map series with the permission of the controller of Her Majesty's Stationery Office Licence No. 100035093 Crown copyright.

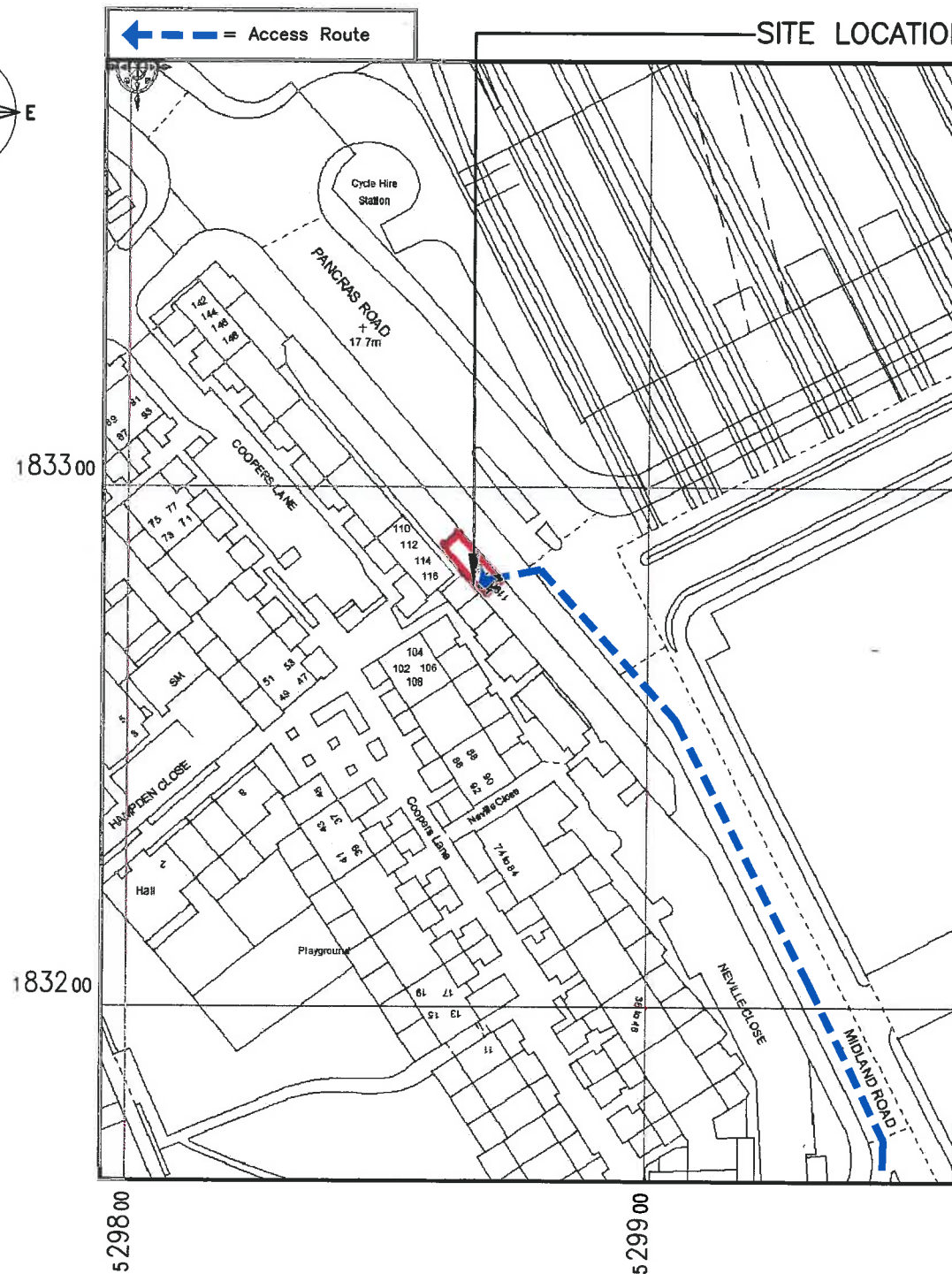

**SITE PHOTOGRAPH**

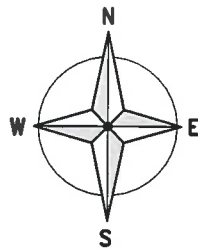

**DETAILED SITE LOCATION**  
(Scale 1:1250)

Based upon Ordnance Survey map extract with the permission of the Controller of Her Majesty's Stationery Office. Crown copyright. Licence No. 100035093

ALL DIMENSIONS ARE IN mm UNLESS NOTED OTHERWISE

N.G.R E: 529880 N: 183271

CONCESSION REQUIRED NO

DIRECTIONS TO SITE:

NOTES:

REV	MODIFICATION	BY	CH	DATE
B	Antenna fixing detail added	GW	MS	11.06.15
A	Issued for Approval	NTA	GW	09.04.15



Cell Name

Opt.

RELIC ANTIQUES

A

CTIL Reference

O2 CSR

149070

(TEF) 070836

Site Address / Contact Details

RELIC ANTIQUES  
133-135 PANCRAS ROAD  
LONDON  
NW1 1UN

Drawing Title:

SITE LOCATION MAPS

Purpose of issue:

SURVEY DETAIL

Drawing Number:

100

Surveyed By:

TM

Original Sheet Size:

A3

Issue:

Drawn:

NTA

Date:

09.04.15

Checked:

GW

Date:

09.04.15

B