



ARTEMIS
TREE
SERVICES

Tree Type & Number	Location	Work Required	Price/T
		reason	
		reason	
		reason	
		reason	

Which Kit is required?

Notes To Team On Day Of Work: WORK TO BE CARRIED OUT THROUGH
SILKY & SECATEURS ALLEYWAY USING LADDERS.

14" Bar	<input checked="" type="checkbox"/> Rayco Grinder 66cm	
16" or 18" Bar	<input type="checkbox"/> Predator 82cm	
25" Bar	<input type="checkbox"/> Wheel Barrow	
36" Bar	<input type="checkbox"/> Sack Barrow	
48" Bar	<input type="checkbox"/> Rigging Kit	
Small hedge trimmers	<input checked="" type="checkbox"/> Dust sheets/Bags	
Medium Hedge trimmers	<input type="checkbox"/> Stump Treatment	
Pole Trimmers	<input type="checkbox"/> Chainsaw Attachment	
Brushcutter	<input type="checkbox"/> Trimmer Attachment	
Access for Ranger 1.6m?	<input checked="" type="checkbox"/> Access for 7.5t 2.15m?	<input checked="" type="checkbox"/>
Access for 3.5t 1.90m?	<input checked="" type="checkbox"/> Access for Grab 2.60m?	<input checked="" type="checkbox"/>

MAP:

	Comments
TPO or CA?	?
OBSTACLES?	N
Parking Restrictions? Did you take a photo of bays that need suspending?	
How many loads? % of 3.5t	0.2
REMOVE THETFORD?	

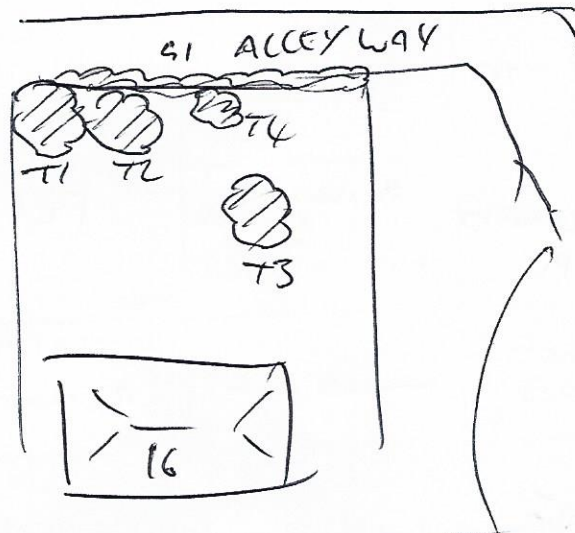

Cunningham
9589

HOLLY MOUNT

Total

P.N. = Please Note: (note to client)
N.B. = (note to Artemis office when booking in work)