

Existing Lower Ground Floor

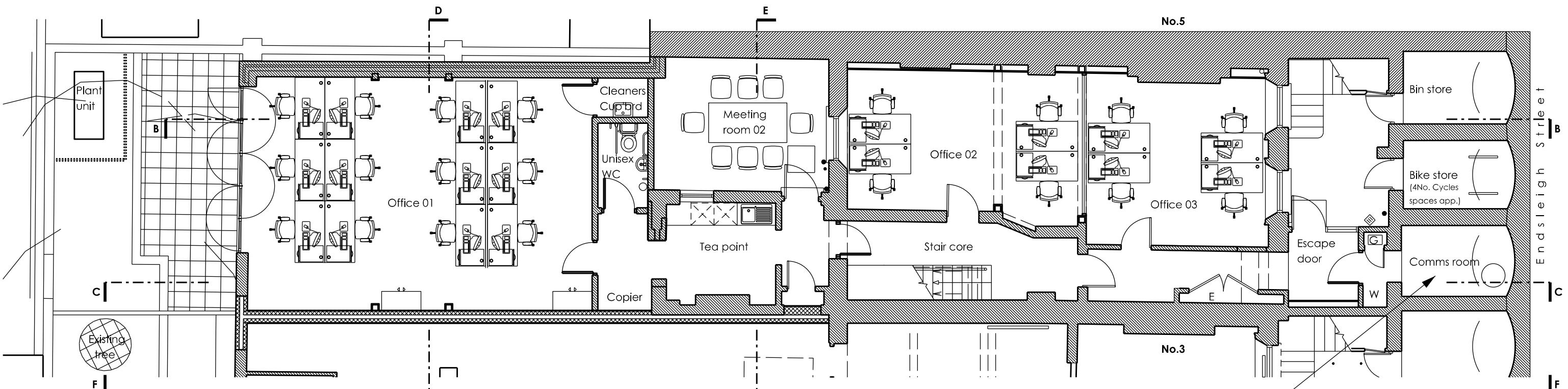

Comms room: Existing vault to have existing floor removed with new slab and DPM laid and cast.  
 Existing walls and roof to vault to have proprietary mechanically fixed waterproofing installed by specialist.  
 Wall and ceiling waterproofing to be joined with DPM to new floor and suitably drained accordingly.

Proposed Lower Ground Floor

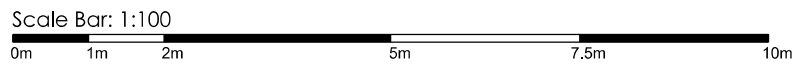

Rev/Date	Revision description	Initial	Checked
A	26.03.15 Glazed partition and office furniture added	MA	HJ
B	14.04.15 Section lines added	MA	HJ
C	06.05.15 Planning application submission	MA	HJ
D	14.05.15 Planning application submission	MA	HJ
E	16.07.15 Comms room note added, General store changed to bike store.	MA	HJ

**Notes**

This drawing is copyright and must not be reproduced or disclosed to third parties without the prior written permission of Rio architects Limited.

Do not scale this drawing. Responsibility is not accepted by Rio architects limited for errors made by others in scaling from this drawing.

Use only written dimensions. Contractor must verify all dimensions before commencing work and any discrepancies are to be notified in writing to Rio architects limited immediately.

This drawing is to be read in conjunction with all relevant project drawings and specifications prepared by Rio architects limited and other relevant consultants, specialists etc.

All survey information incorporated within this drawing cannot be guaranteed as accurate unless confirmed by a fixed dimension.

All dimensions are in millimetres unless noted otherwise.

CDM notes are provided to assist the contractor in managing residual hazards identified during the design stage. Any such notes do not relieve the contractor of his duties and he must provide a safe system of work of work based on method statements, risk assessments etc.

<b>DRAWING TITLE</b> Lower Ground Floor Plans Existing and Proposed		
Job No: 0235	Drawing No: AL_01	Rev: E
Scale: 1:100@A3	Drawn By: MA	Checked By: HJ
Drawn Date: 25/03/15	Checked Date: 25/03/15	
Drawing Status <b>PLANNING</b>		

<b>CLIENT</b> Endsleigh Street 4 Limited
<b>PROJECT NAME</b> 4 Endsleigh Street London

**RIO architects** www.rioarchitects.com

Y Sllwddio, 21a Allensbank Road, Cardiff, CF14 3PN

tel 44 (0) 2920 250066  
 email studio@rioarchitects.com  
 facebook www.facebook.com/RioArchitectsLtd  
 linkedIn www.linkedin.com/company/rio-architects