

STANDARD NOTES

1. GENERAL:
 1.1 NO DIMENSIONS ARE TO BE SCALED FROM THIS DRAWING, ALL DIMENSIONS ARE TO BE ESTABLISHED ON SITE.
 1.2 THIS DRAWING IS TO BE READ WITH ALL RELEVANT ARCHITECTS AND SERVICES ENGINEERS DRAWINGS AND SPECIFICATIONS FOR CONSTRUCTION DETAIL, PLUMBING, DRAINAGE, ELECTRICAL WORK, HEATING WORK, INSULATION, DAMP PROOF DETAILS, VENTILATION, FINISHES, JOINERY ETC.
 1.3 THE CONTRACTOR IS TO NOTIFY THE CONTRACT ADMINISTRATION (C.A.) OF ANY DISCREPANCIES BETWEEN THIS DRAWING AND SITE CONDITIONS BEFORE IMPLEMENTING THE WORK.
 1.4 ANY TEMPORARY WORKS NECESSARY SHALL BE THE SOLE RESPONSIBILITY OF THE CONTRACTOR.

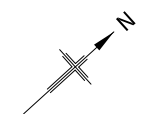

LEGEND:

- EXISTING WALL
- NEW WALL
- WALL TO BE DEMOLISHED
- LOAD BEARING WALL UNDER
- P.1 100x100 EXISTING TIMBER POST

NOTE 'A'

- FOR CRACK REPAIRS REFER TO ELEVATIONS.
- FOR REPAIRS TO INTERNAL AND EXTERNAL DRAIN RUNS, REFER TO SPECIALIST'S REPORT.
- FOR DPC AND INTERNAL WATERPROOF RENDER SPECIFICATION, REFER TO SPECIALIST'S REPORT.

NOTE 'B'

- FOR REMEDIAL WORKS TO INADEQUATE SUPPORTS, REFER TO DRAWING 4289/S.06

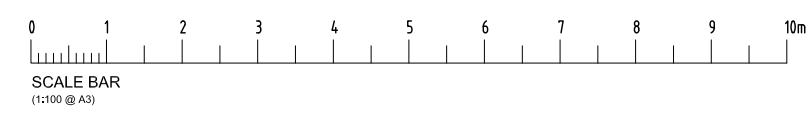
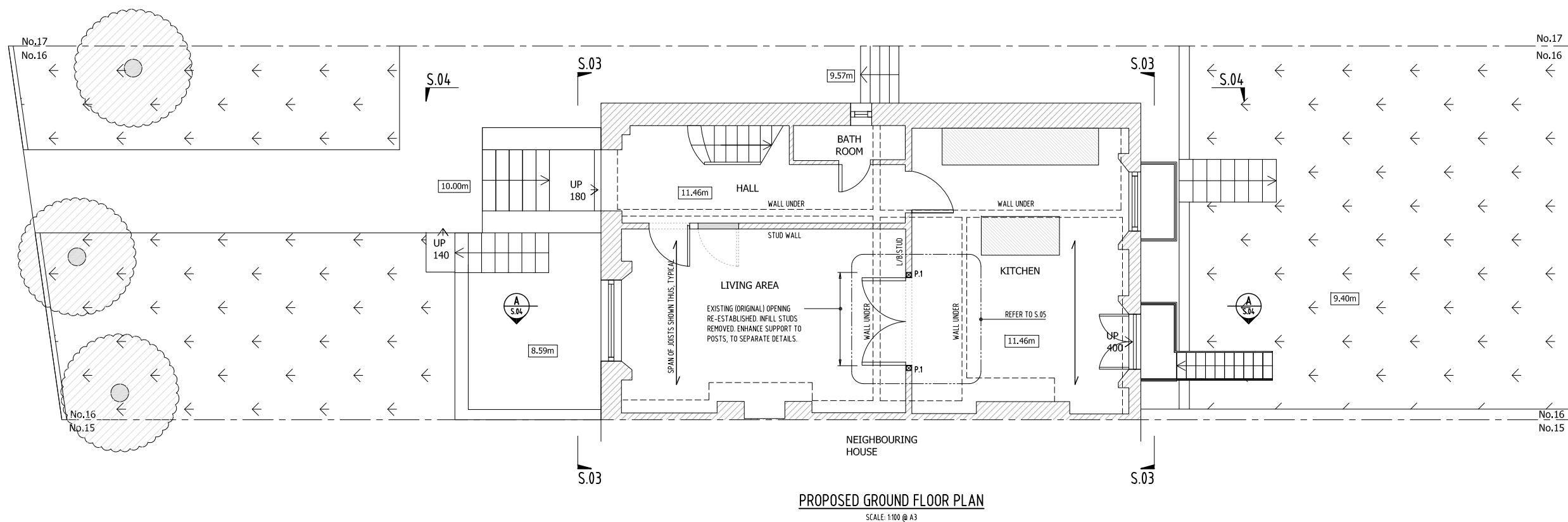
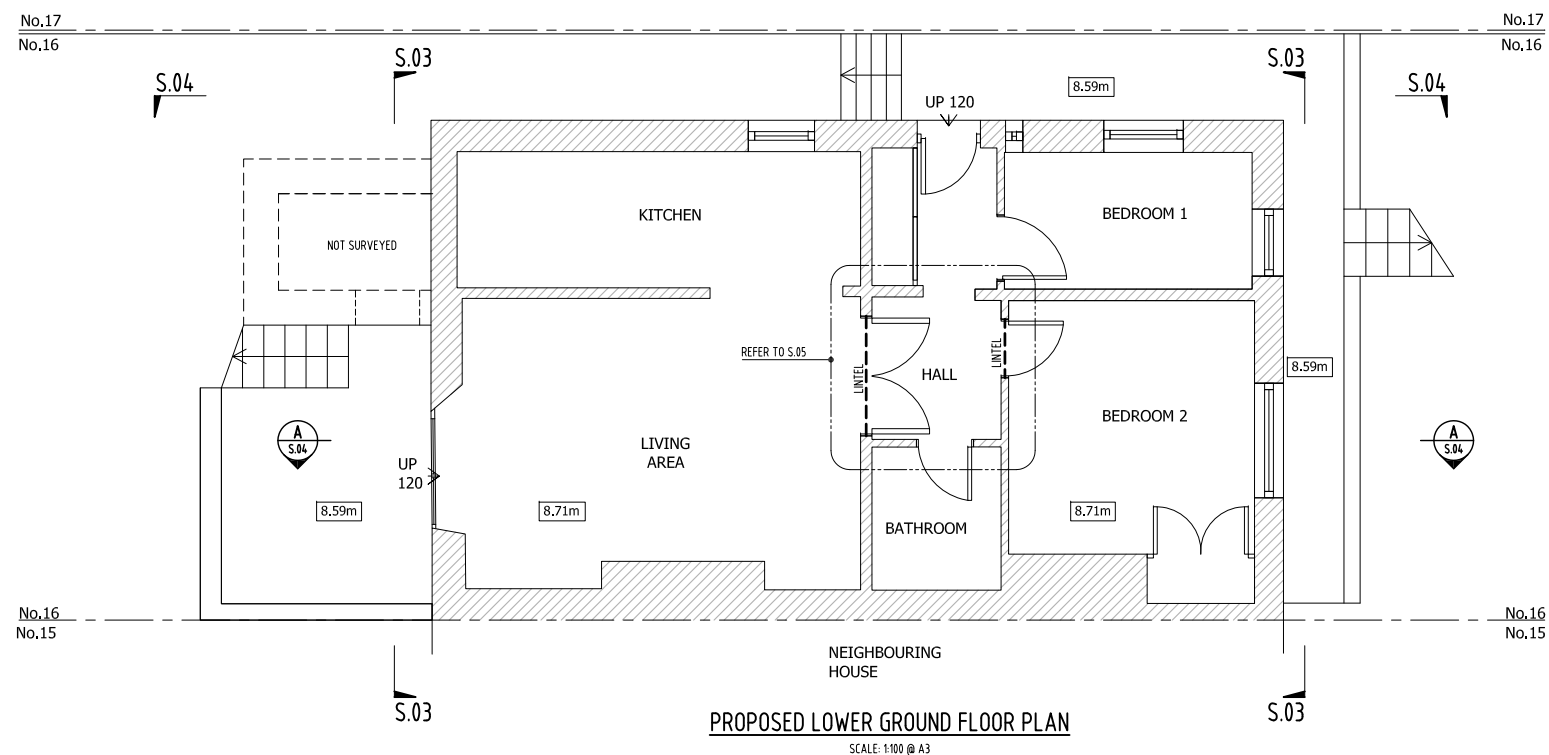

REV	DATE	DESCRIPTION	BY
DRG STATUS PRELIMINARY			
CLIENT JOSEPH BEKHOR			
JOB TITLE 16 ETON VILLAS LONDON, NW3			
DRG TITLE PROPOSED LOWER GROUND AND GROUND FLOOR PLANS			
		HARLING HOUSE 47-51 GREAT SUFFOLK ST. LONDON SE1 0BS TEL: 020-7401 8100 FAX: 020-7401 8845	
JOB NO 4289	DRG NO S.01	REV /	SCALE 1:100 @ A3 DATE 06/2015