

**ELEVATION 1:50**

**NB** Work to proceed in sections (hit one, miss two), each bay to span between existing PCC posts (nominal 1800mm). All panels to be completed before next phase commenced: 2,5 8,11 etc; 1,4,7,10 etc; 3,6,9,12 etc

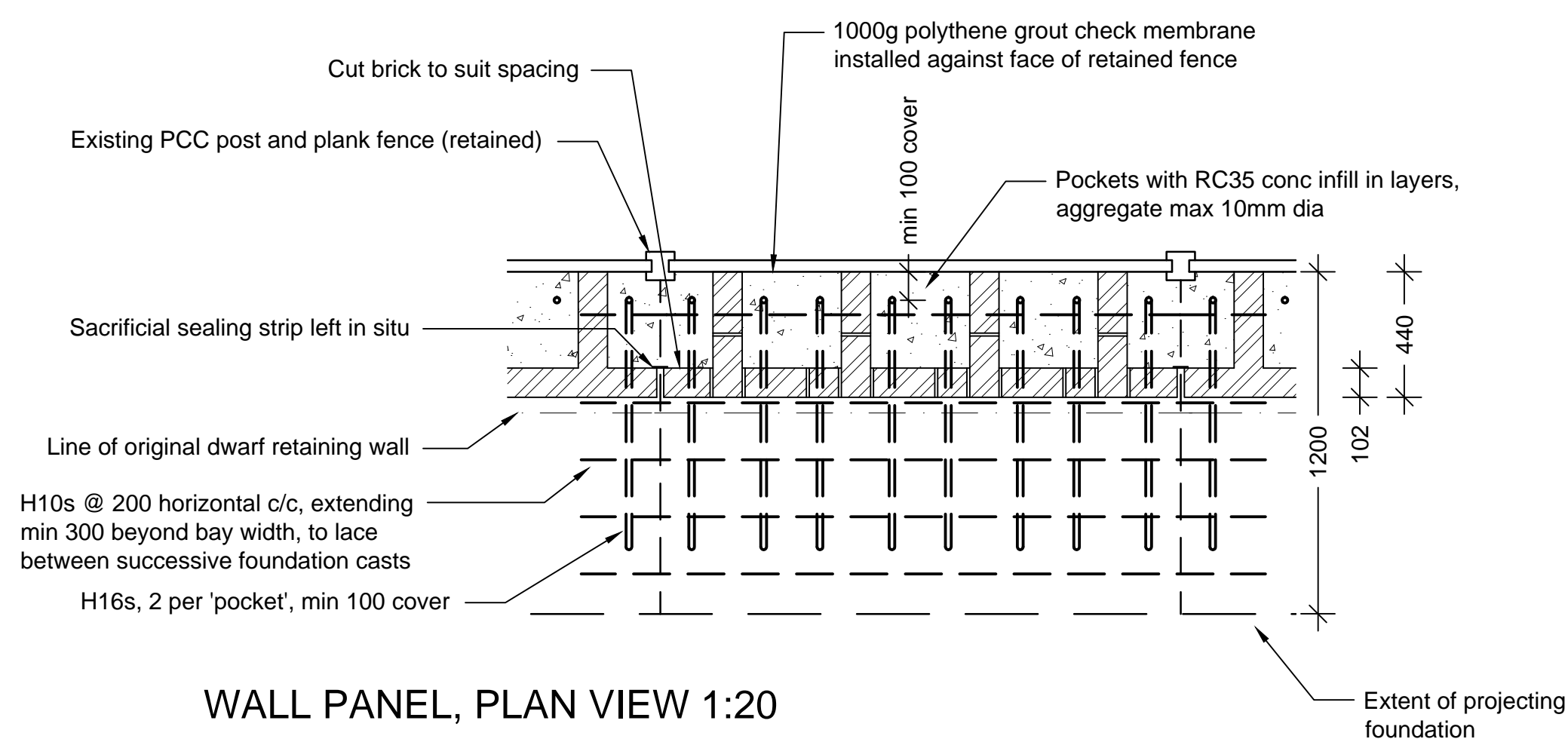

**WALL PANEL, PLAN VIEW 1:20**

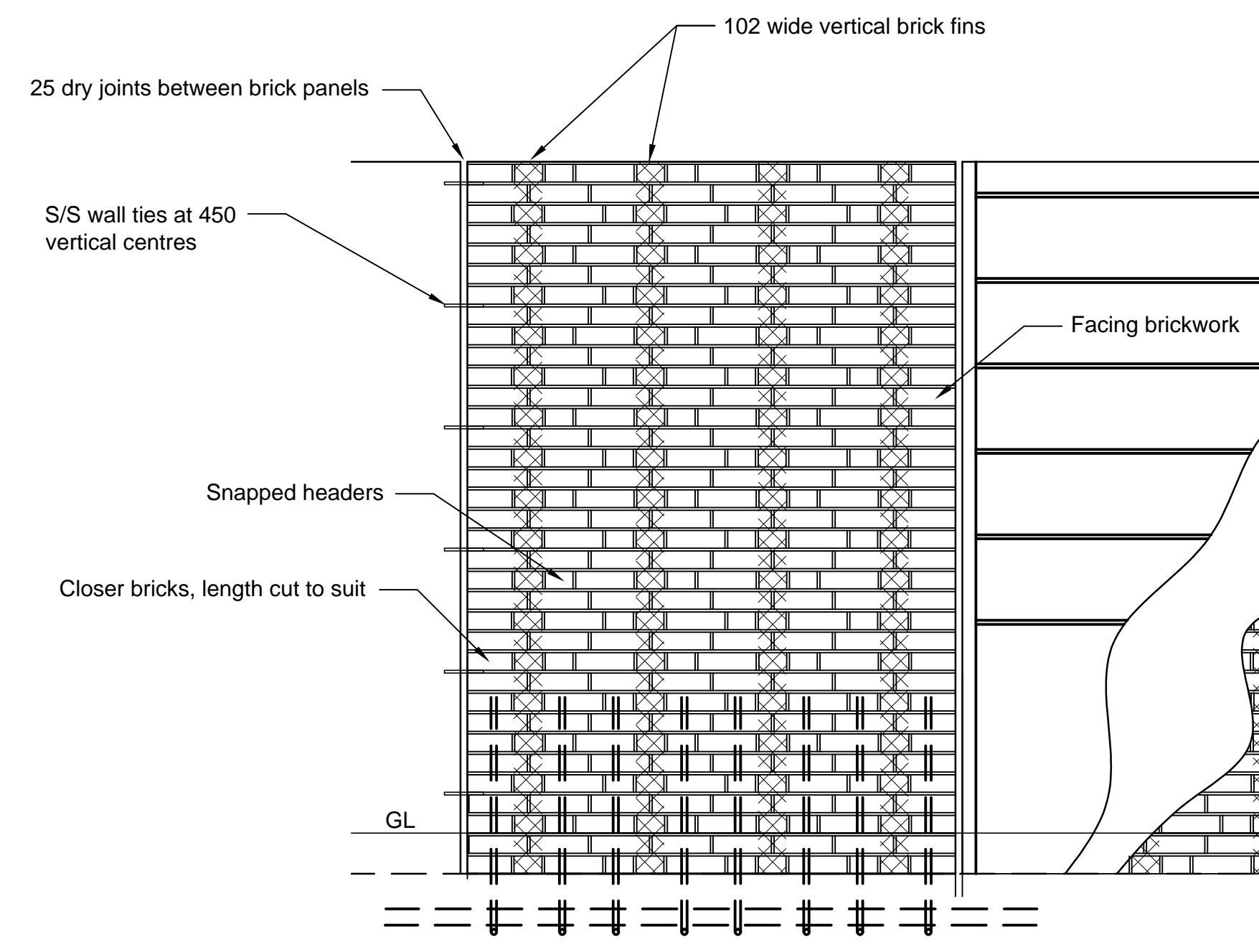

**ELEVATION 1:20**

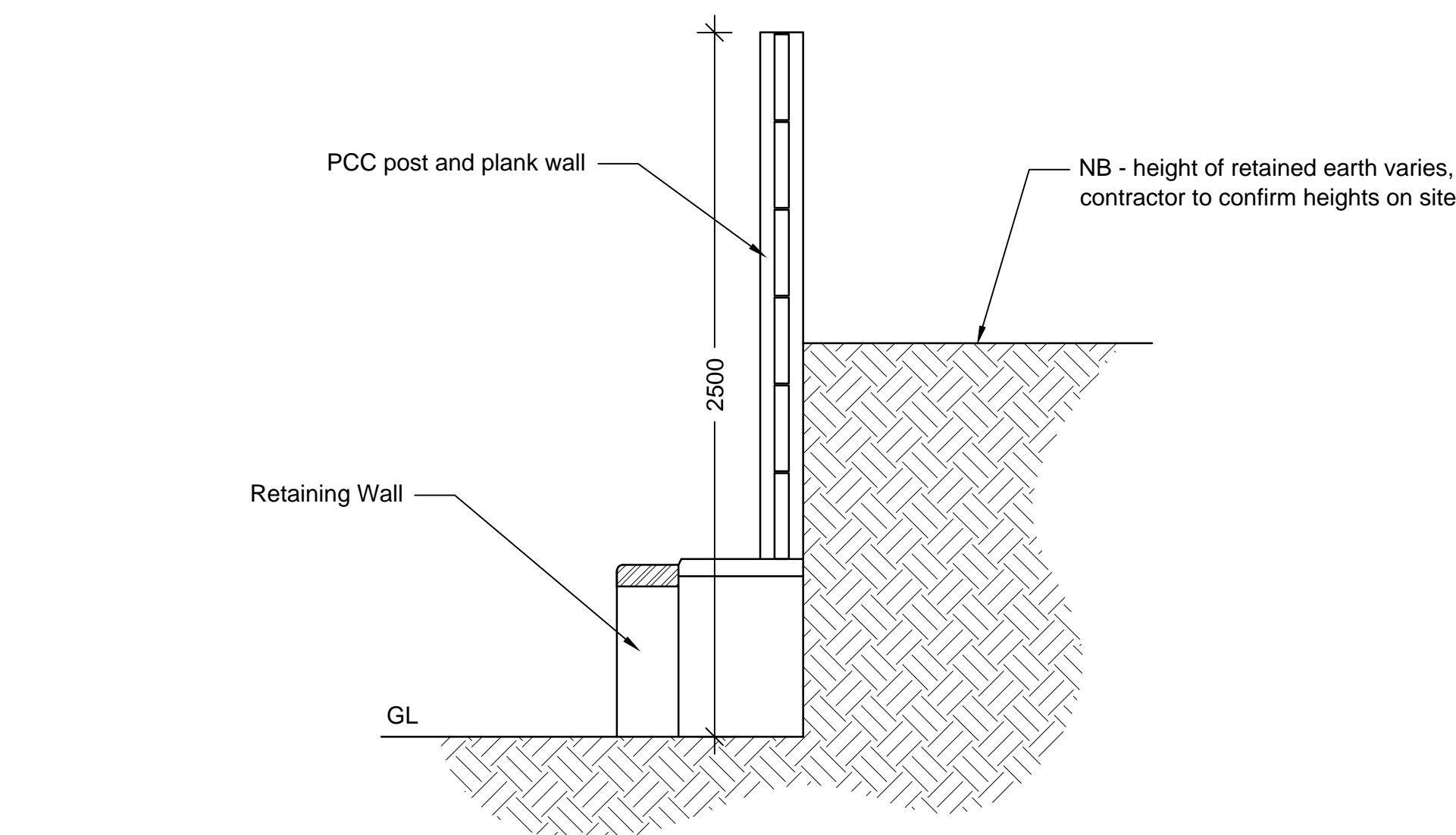

**Existing**

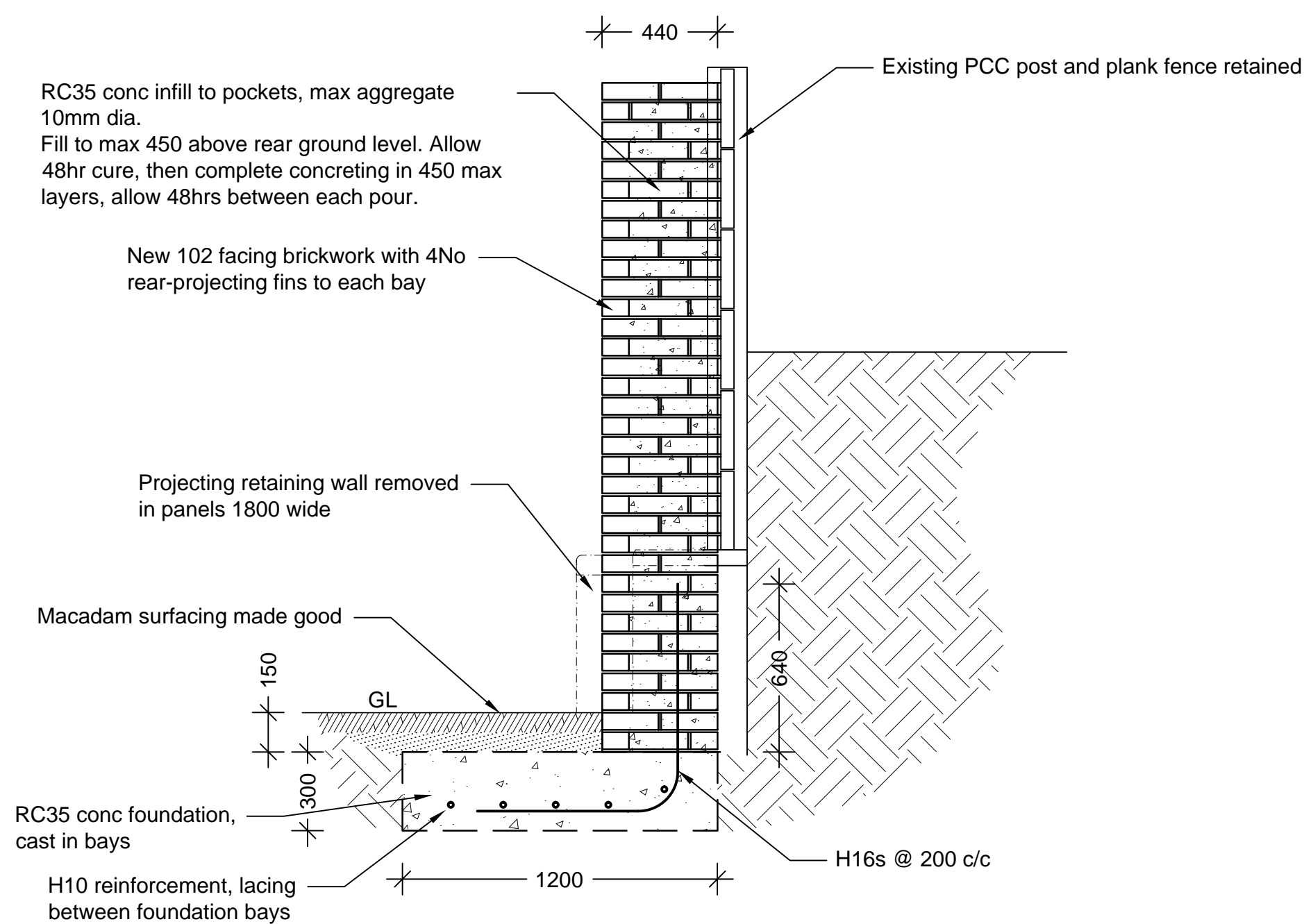

**Proposed**

**SECTIONS 1:20**

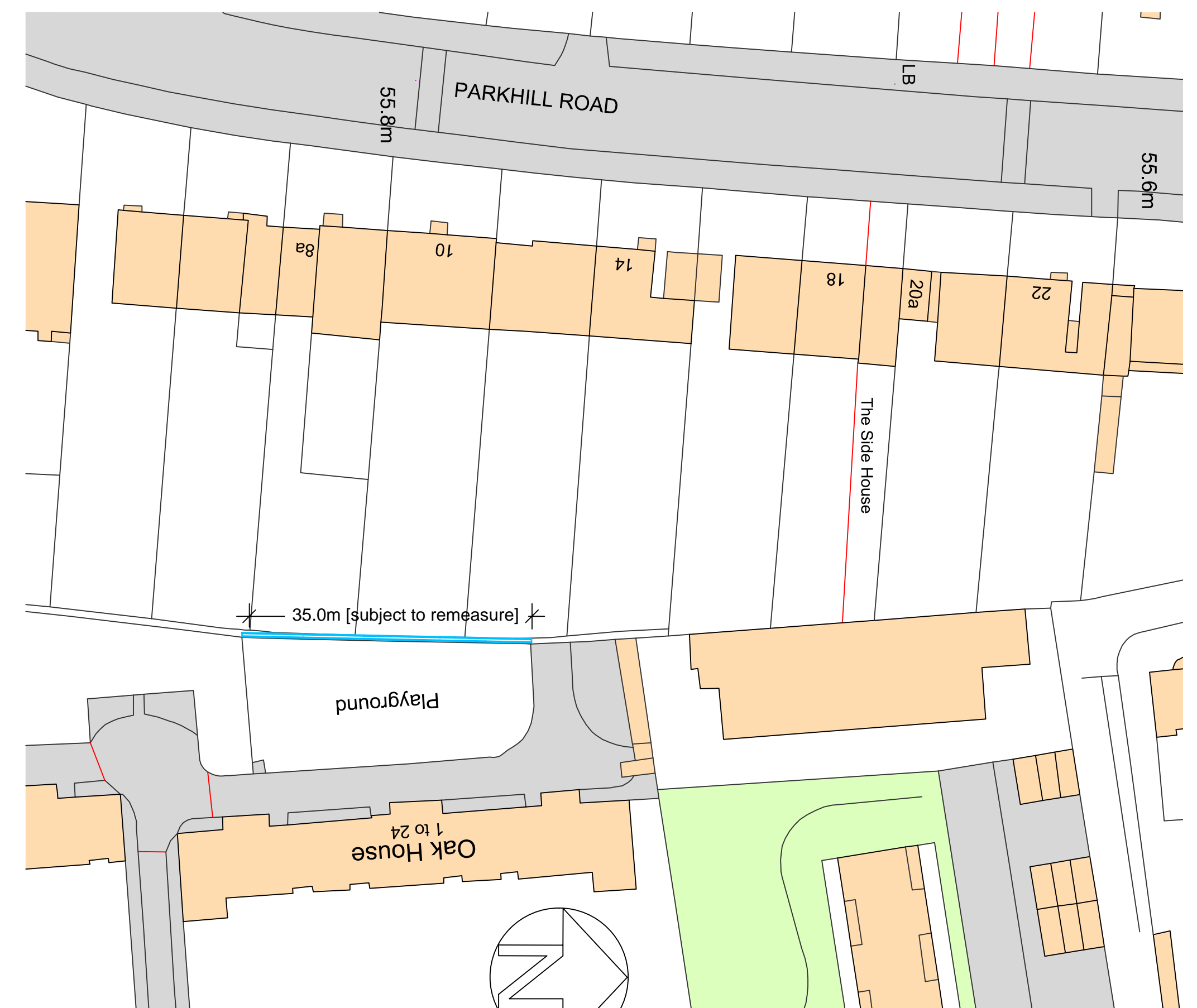

**LOCATION 1:500**

**Supplementary Reinforced Boundary Retaining Wall**  
1-24 Oak House,  
Maitland Park Estate  
London. NW3 2ED

**Wall Construction - Proposed**

Scale 1:20, 1:50, 1:100, 1:500 Date MAY 2015  
Drawing No 14/149-02



**WHYMARK & MOULTON**  
Chartered Surveyors & Building Engineers  
20 North Street, Sudbury Suffolk. CO10 1RB. Tel: 01787 371371 Fax: 01787 319966

